

# EXMAR

## 艾克斯玛

20

Dichtkegel-  
verschraubungen

Tapered seal  
fittings

带锥度密封接  
头

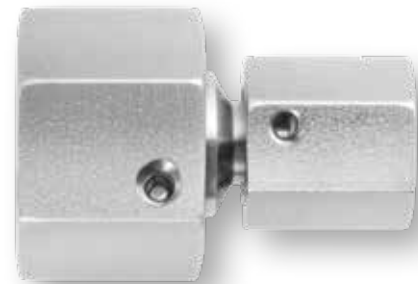

Dichtkegelverschraubungen

Tapered seal fittings

带锥度密封接头

Seite / Page / 页

Seite / Page / 页

**Dichtkegelverschraubungen**  
**Tapered seal fittings**  
带锥度密封接头

**20.24-20.31**

Reduzierschraubungen mit Dichtkegel  
Reducing fittings with taper  
直通变径接头总成 (带24度旋转螺母及O型圈)



**GRKO**

Gerade Zwischenstutzen mit Dichtkegel  
Straight unions with taper  
直通组合接头带锥体

**20.4**



**NC-Dichtkegelverschraubungen**  
**NC Tapered seal fittings**  
NC带锥度密封接头

**VKO**

Gerade Zwischenreduzierstutzen mit Dichtkegel  
Straight reducing unions with taper  
直通变径组合接头带锥体与O型圈

**20.5**



Gerade Verschraubungen mit Dichtkegel  
Straight fittings with taper  
直通接头总成

**20.32**



**VKOR**

**NC-GKO**

Gerade Verschraubungen mit Dichtkegel  
Straight fittings with taper  
直通接头总成

**20.6-20.7**



Einstellbare Winkelversch. mit Dichtkegel  
Adjustable elbow fittings with taper  
可调式直角组合接头总成

**20.33-20.36**



**GKO**

**NC-EWKO 45° / NC-EWKO**

Gerade Einschraubstutzen mit Dichtkegel  
Straight male adaptor unions with taper  
英制外螺纹可调向端直通接头 (带24度锥旋转螺母)

**20.9-20.11**



Einstellbare T/L-Versch. mit Dichtkegel  
Adjustable T/L fittings with taper  
可调式三通组合接头总成 (带24度锥旋转螺母)

**20.37-20.38**



**EGKO**

**NC-ETKO/NC-ELKO**

Einstellbare Winkelversch. mit Dichtkegel  
Adjustable elbow fittings with taper  
可调式直角组合接头总成

**20.12-20.17**



Reduzierschraubungen mit Dichtkegel  
Reducing fittings with taper  
直通变径接头总成 (带24度旋转螺母)

**20.39-20.42**



**EWKO 45° / EWKO**

**NC-GRKO**

Einstellbare T/L-Versch. mit Dichtkegel  
Adjustable T/L fittings with taper  
可调式三通组合接头总成 (带24度锥旋转螺母)

**20.18-20.21**



**ETKO/ELKO**

Einstellbare Manometerverschraubungen  
Adjustable manometer fittings  
可调式压力表接头

**20.22**



**EMAKO**

## Dichtkegelverschraubungen

## Tapered seal fittings

## 带锥度密封接头

## Technische Information

## Technical information

## 技术信息

## Dichtkegelverschraubungen

## Tapered seal fittings

## 带锥度密封接头

## Baumaße

- Baumaße entsprechend Verschraubungen nach DIN 2353 und ISO 8434-1
- passend für alle Gewindestutzen mit 24° Innenkonen (Bohrungsform W DIN 3861)

## Dicht- und Halteprinzip

Bei den EXMAR Dichtkegelverschraubungen ist die Überwurfmutter drehbar auf den Stutzen montiert. Durch den zusätzlich im Kegel eingelegten O-Ring kommt eine metallisch/elastomere Abdichtung zustande, die eine hohe Leckagesicherheit gewährleistet.

## Vorteile

- richtungseinstellbar durch drehbare Überwurfmutter
- einfache und schnelle Montage durch fixierten Anzugsweg mit geringem Drehmoment
- hohe Belastbarkeit bei Druckschwankungen und Schwingungen im System

## Werkstoff

Edelstahl 1.4571  
Legierung X 6 CrNiMoTi 17 12 2  
≈ AISI 316Ti

## Druckbereiche für Dichtkegelverschraubungen (ohne NC)

Baureihe	Rohr	Nennndruck
L: leicht	6 - 10 mm	PN 500 (bar)
	12 - 18 mm	PN 400 (bar)
	22 - 42 mm	PN 250 (bar)
S: schwer	6 - 10 mm	PN 800 (bar)
	12 - 14 mm	PN 630 (bar)
	16 - 25 mm	PN 420 (bar)
	30 - 38 mm	PN 320 (bar)

Sicherheitsfaktor: siehe Kapitel i (gemäß DNV)

## Druckauswertungsgrad in % des PN

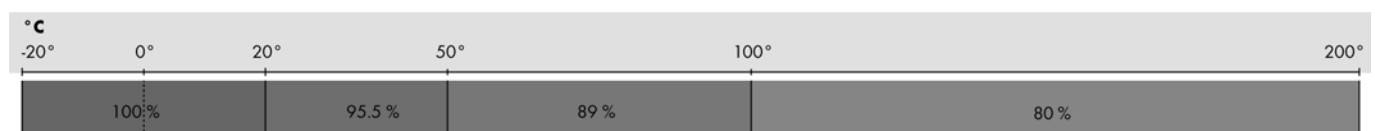

## Temperaturbereich

-20°C bis +200°C  
Dichtungsmaterial FKM (andere Werkstoffe auf Anfrage)

## Werkzeugnis

Werden Bescheinigungen über Materialprüfungen nach DIN EN 10 204 gewünscht, so ist dies bei Bestellung anzugeben (Abnahmeprüfzeugnis 3.1 gegen Berechnung).

## Dimensions

- dimensions are consistent with DIN 2353 and ISO 8434 fittings
- compatible with all threaded connectors according to DIN 3858 with 24° inner cones (bore form W DIN 3861)

## Sealing and fastening principle

On the EXMAR tapered seal fittings, a rotatable nut is mounted on the connector. With the additional O-ring in the cone, a metal/elastomere seal is created that guarantees leak-tightness.

## Benefits

- direction adjustable with the rotatable nut
- easy and fast assembly due to fixed tightening procedure with low torque
- highly resilient against pressure fluctuation and vibration in the system

## Material

Stainless steel 1.4571  
alloy X 6 CrNiMoTi 17 12 2  
≈ AISI 316Ti

## Pressure range for Tapered seal fittings (without NC)

Serie	Tube	Pressure nom.
L: light	6 - 10 mm	PN 500 (bar)
	12 - 18 mm	PN 400 (bar)
	22 - 42 mm	PN 250 (bar)
S: heavy	6 - 10 mm	PN 800 (bar)
	12 - 14 mm	PN 630 (bar)
	16 - 25 mm	PN 420 (bar)
	30 - 38 mm	PN 320 (bar)

Safety factor: see chapter i (acc. to DNV)

## Pressure range for Cutting ring fittings

## 尺寸

- 尺寸与DIN2353和ISO8434标准的接头一致。
- 兼容所有依照 DIN 3858 且配 24° 内锥的螺纹连接器 (W DIN 3861 孔形)

## 密封与紧固原理

在EXMAR带锥度密封接头上, 接头体上安装了一个可旋转的螺母。锥体上带有O型圈形成的金属/弹性密封可以保证零泄漏。

## 优点

- 旋转连接螺母使接头的连接方向可调节
- 装配因低扭矩固定上紧流程而方便快捷
- 对系统中的压力波动及振动有极强的适应能力

## 材质

不锈钢 1.4571  
合金 X 6 CrNiMoTi 17 12 2  
≈ AISI 316Ti

## 锥形密封压力范围 (无NC螺钉连接)

系列	管件	公称压力
L: 轻	6 - 10 mm	PN 500 (巴)
	12 - 18 mm	PN 400 (巴)
	22 - 42 mm	PN 250 (巴)
S: 重	6 - 10 mm	PN 800 (巴)
	12 - 14 mm	PN 630 (巴)
	16 - 25 mm	PN 420 (巴)
	30 - 38 mm	PN 320 (巴)

安全系数: 见第I章 (根据 DNV)

## 卡套式接头的压力范围

## 温度范围

-20°C 至 +200°C  
密封材料: FKM (其他材料可咨询)

## 材质认证

如需按照 DIN EN 10204 进行材料测试认证, 请在订单中告知 (将收取检查认证 3.1 或更高版本的相关费用)。

**Gerade Zwischenstutzen mit Dichtkegel und O-Ring**

**Straight unions with taper and O-ring**

**直通组合接头带锥体与 O 型圈**

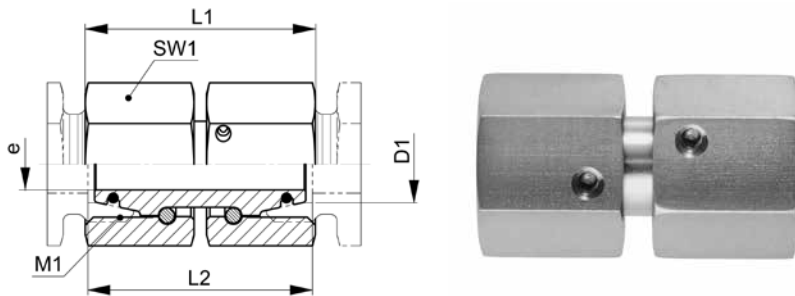

**VKO-..L/S**

Type -D1	Mat.-Nr.	PN	M1	L1	L2	SW1	e	g/Stk
VKO-06L	708.1070.060.21	500	12x1.5	36.0	35.0	14	3.0	48
VKO-08L	708.1070.080.21	500	14x1.5	36.0	35.0	17	4.0	42
VKO-10L	708.1070.100.21	500	16x1.5	37.0	35.0	19	6.0	56
VKO-12L	708.1070.120.21	400	18x1.5	36.0	35.0	22	8.0	78
VKO-15L	708.1070.150.21	400	22x1.5	44.0	40.0	27	10.0	128
VKO-18L	708.1070.180.21	400	26x1.5	38.0	39.0	32	13.0	182
VKO-22L	708.1070.220.21	250	30x2.0	49.0	45.0	36	17.0	254
VKO-28L	708.1070.280.21	250	36x2.0	55.0	49.0	41	23.0	440
VKO-35L	708.1070.350.21	250	45x2.0	56.0	54.0	50	28.0	486
VKO-42L	708.1070.420.21	250	52x2.0	61.0	59.0	60	34.0	712
VKO-06S	708.1070.060.31	800	14x1.5	36.0	35.0	17	3.0	44
VKO-08S	708.1070.080.31	800	16x1.5	37.0	36.0	19	4.0	60
VKO-10S	708.1070.100.31	800	18x1.5	36.0	36.0	22	6.0	84
VKO-12S	708.1070.120.31	630	20x1.5	38.0	39.0	24	8.0	110
VKO-14S	708.1070.140.31	630	22x1.5	45.0	43.0	27	9.0	142
VKO-16S	708.1070.160.31	420	24x1.5	45.0	44.0	30	10.0	182
VKO-20S	708.1070.200.31	420	30x2.0	51.0	50.0	36	13.0	300
VKO-25S	708.1070.250.31	420	36x2.0	55.0	55.0	46	18.0	481
VKO-30S	708.1070.300.31	320	42x2.0	59.0	63.5	50	20.0	646
VKO-38S	708.1070.380.31	320	52x2.0	61.0	68.5	60	28.0	936

L1=Abstand Mutter-Mutter in montiertem Zustand  
L2=Abstand Rohranschlag-Rohrerschlag

Baumaße sind Ungefährmaße bei angezogener Überwurfmutter.

Dichtungsmaterial: FKM (andere Werkstoffe auf Anfrage)

L1=Distance nut-nut in assembled state  
L2=Distance tube stop-tube stop

Sizes are approximate dimensiones at tightened nut.

Sealing material: FKM (other materials on request)

L1=装配状态下螺母间间距  
L2=两边管材止动处间距

尺寸为上紧螺母处的概略大小。

密封材料: FKM (其他材料可咨询)

D1=Rohr außen-Ø  
M1=metrisches Anschlussgewinde  
e=kleinster Innen-Ø

D1=tube outside diameter  
M1=metric connecting thread  
e=minimum inside diameter

D1=管外径  
M1=公制连接管螺纹  
e=最小内径

**Gerade Zwischenreduzierstutzen mit Dichtkegel und O-Ring**

**Straight reducing unions with taper and O-ring**

**直通变径组合接头带锥体与O型圈**

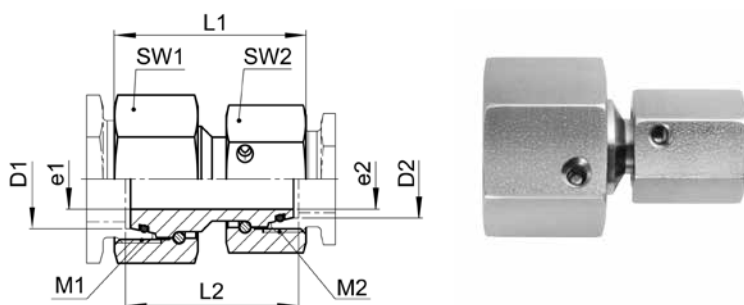

20

**VKOR-..L**

Type-D1 /D2	Mat.-Nr.	PN	M1	M2	L1	L2	SW1	SW2	e1	e2	g/Stk
VKOR-10/08L	708.1074.190.21	500	16x1.5	14x1.5	35.0	32.5	19	17	6.0	4.0	52
VKOR-12/06L	708.1074.215.21	400	18x1.5	12x1.5	34.0	33.0	22	14	3.0	3.0	56
VKOR-12/08L	708.1074.225.21	400	18x1.5	14x1.5	36.5	33.0	22	17	3.0	3.0	66
VKOR-15/10L	708.1074.410.21	400	22x1.5	16x1.5	39.0	38.0	27	19	10.0	6.0	101
VKOR-18/10L	708.1074.575.21	400	26x1.5	16x1.5	37.5	36.0	32	19	6.0	6.0	125
VKOR-18/12L	708.1074.580.21	400	26x1.5	18x1.5	37.5	36.0	32	22	8.0	8.0	132
VKOR-18/15L	708.1074.610.21	400	26x1.5	22x1.5	39.5	37.5	32	27	10.0	10.0	175
VKOR-22/12L	708.1074.730.21	250	30x2.0	18x1.5	45.5	40.5	36	22	13.0	8.0	182
VKOR-22/15L	708.1074.745.21	250	30x2.0	22x1.5	43.5	42.0	36	27	13.0	10.0	215
VKOR-22/18L	708.1074.755.21	250	30x2.0	26x1.5	44.0	42.0	36	32	13.0	13.0	228
VKOR-28/18L	708.1074.870.21	250	36x2.0	26x1.5	48.0	46.0	46	32	13.0	13.0	298
VKOR-28/22L	708.1074.900.21	250	36x2.0	30x2.0	48.0	46.0	46	36	17.0	17.0	309
VKOR-35/28L	708.1074.949.21	250	45x2.0	36x2.0	51.0	48.0	50	46	22.0	22.0	415

L1=Abstand Mutter-Mutter in montiertem Zustand  
L2=Abstand Rohranschlag-Rohranschlag

L1=Distance nut-nut in assembled state  
L2=Distance tube stop-tube stop

L1=装配状态下螺母间间距  
L2=两边管材止动处间距

Baumaße sind Ungefährmaße bei angezogener Überwurfmutter.

Sizes are approximate dimensions at tightened nut.

尺寸为上紧螺母处的概略大小。

Dichtungsmaterial: FKM (andere Werkstoffe auf Anfrage)

Sealing material: FKM (other materials on request)

密封材料: FKM (其他材料可咨询)

D1/D2=Rohraußen-Ø  
M1/M2=metrische Anschlussgewinde  
e1/e2=kleinste Innen-Ø

D1/D2=tube outside diameters  
M1/M2=metric connecting threads  
e1/e2=minimum inside diameters

D1/D2=管外径  
M1/M2=公制连接管螺纹  
e1/e2=最小内径

**Gerade Stutzen mit Dichtkegel und O-Ring**

dichtkegelseitig vormontiert

**Straight connectors with taper and O-ring**

pre-assembled on tapered nipple side

**直连接头体 (带24度锥旋转螺母及O型圈)**

24°旋转螺母已预装

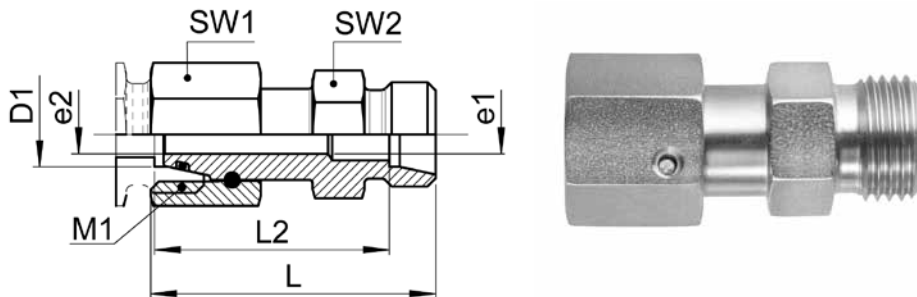

**XGKO-..L M**

Type-D1	Mat.-Nr.	PN	M1	L	L2	SW1	SW2	e1	e2	g/Stk
XGKO-06L M	707.1050.060.20	315	12x1.5	43.0	36.0	14	12	2.5	4.0	33
XGKO-08L M	707.1050.080.20	315	14x1.5	43.0	36.0	17	14	4.0	6.0	44
XGKO-10L M	707.1050.100.20	315	16x1.5	43.0	36.0	19	17	6.0	8.0	57
XGKO-12L M	707.1050.120.20	315	18x1.5	43.0	36.0	22	19	8.0	8.0	70
XGKO-15L M	707.1050.150.20	315	22x1.5	43.0	36.0	27	24	10.0	10.0	125
XGKO-18L M	707.1050.180.20	315	26x1.5	43.5	36.0	32	27	13.0	15.0	156
XGKO-22L M	707.1050.220.20	160	30x2.0	47.5	40.0	36	32	17.0	17.0	227
XGKO-28L M	707.1050.280.20	160	36x2.0	47.5	40.0	41	41	22.0	22.0	366
XGKO-35L M	707.1050.350.20	160	45x2.0	60.5	50.0	50	46	28.0	30.0	450
XGKO-42L M	707.1050.420.20	160	52x2.0	71.0	60.0	60	55	34.0	36.0	735

D1=Rohr außen-Ø  
M1=metrisches Anschlussgewinde  
e=kleinster Innen-Ø

D1=tube outside diameter  
M1=metric connecting thread  
e=minimum inside diameter

D1=管外径  
M1=公制连接管螺纹  
e=最小内径

**Gerade Verschraubungen mit Dichtkegel und O-Ring**

**Straight fittings with taper and O-ring**

直通接头总成 (带24度锥旋转螺母及O型圈)

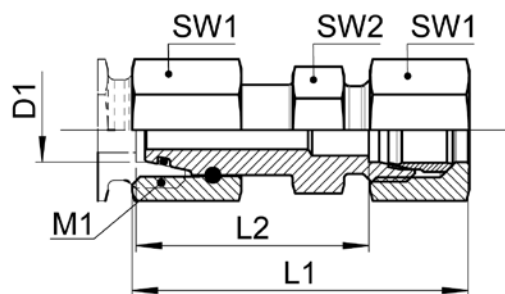

20

**GKO-..L**

Type-D1	Mat.-Nr.	PN	M1	L1	L2	SW1	SW2	g/Stk
GKO-06L	708.1050.060.20	500	12x1.5	51.5	36.0	14	12	44
GKO-08L	708.1050.080.20	500	14x1.5	51.5	36.0	17	14	62
GKO-10L	708.1050.100.20	500	16x1.5	51.5	36.0	19	17	79
GKO-12L	708.1050.120.20	400	18x1.5	51.5	36.0	22	19	98
GKO-15L	708.1050.150.20	400	22x1.5	51.5	36.0	27	24	170
GKO-18L	708.1050.180.20	400	26x1.5	52.5	36.0	32	27	224
GKO-22L	708.1050.220.20	250	30x2.0	56.5	40.0	36	32	317
GKO-28L	708.1050.280.20	250	36x2.0	57.0	40.0	41	41	465
GKO-35L	708.1050.350.20	250	45x2.0	72.0	50.0	50	46	612
GKO-42L	708.1050.420.20	250	52x2.0	83.0	60.0	60	55	988

Baumaße sind Ungefährmaße bei angezogener Überwurfmutter.

Sizes are approximate dimensions at tightened nut.

尺寸为上紧螺母处的概略大小。

Dichtungsmaterial: FKM (andere Werkstoffe auf Anfrage)

Sealing material: FKM (other materials on request)

密封材料: FKM (其他材料可咨询)

D1=Rohr außen-Ø  
M1=metrisches Anschlussgewinde

D1=tube outside diameter  
M1=metric connecting thread

D1=管外径  
M1=公制连接管螺纹

Dichtkegelverschraubungen

Tapered seal fittings

带锥度密封接头

Übersicht Typen

Overview of types

类型概述

Sortiment: Einstellbare Verschraubung mit Dichtkegel und O-Ring

Product range: Adjustable fittings with taper and O-ring

配锥体与 O 型圈的可调式接头

EGKO

Gerade Einschraubstutzen  
Straight male adaptor unions  
公制外螺纹端直通组合接头

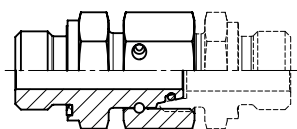

VKO

Gerade Zwischenstutzen  
Straight unions  
直通组合接头

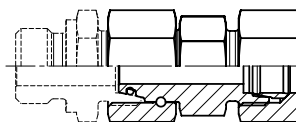
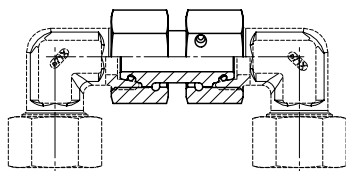

GKO

Gerade Verschraubungen  
Straight fittings  
直通接头总成

VKOR

Gerade Zwischenreduzierstutzen  
Straight reducing unions  
直通变径组合接头

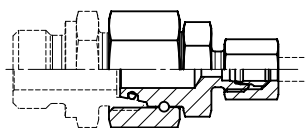
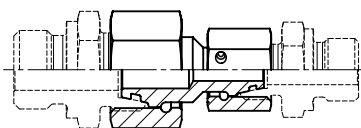

GRKO

Reduzierschraubungen  
Reducing fittings  
直通变径接头总成

EWKO

Einstellbare Winkelverschraubungen  
Adjustable elbow fittings  
可调式直角组合接头总成

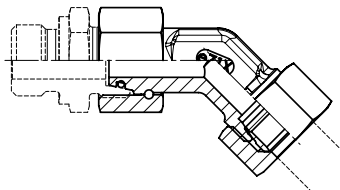
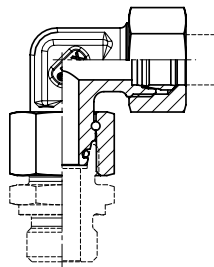

EWKO 45°

Einstellbare Winkelverschraubungen 45°  
Adjustable elbow fittings 45°  
可调式45度弯头总成

ETKO

Einstellbare T-Verschraubungen  
Adjustable T fittings  
可调式三通组合接头总成

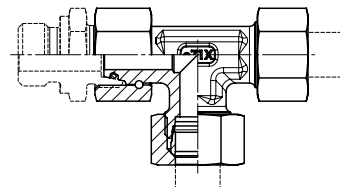
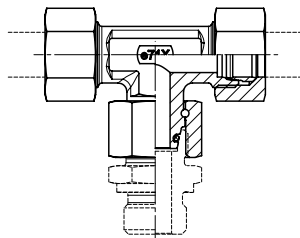

ELKO

Einstellbare L-Verschraubungen  
Adjustable L fittings  
可调式外螺纹三通主路组合接头总成



### Gerade Einschraubstutzen mit Dichtkegel und O-Ring

Abdichtung durch Profildichtring Form E nach ISO 1179-2

### Straight male adaptor unions with taper and O-ring

profile sealing ring form E acc. ISO 1179-2

### 英制外螺纹可调向端直通接头 (带24度锥旋转螺母及O型圈)

带符合ISO1179-2标准的ED圈密封

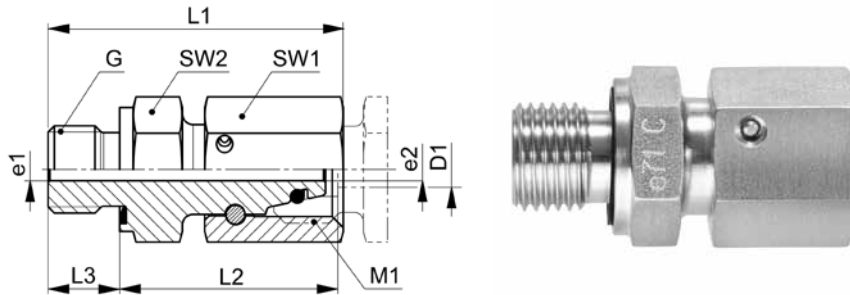

20

### EGKO-..LR WD/SR WD

Type-D1 G	Mat.-Nr.	PN	G	M1	L1	L2	L3	SW1	SW2	e1	e2	g/Stk
G=Rohrgewinde (zylindrisch)		G=BSP thread (parallel)			G=英制平行管螺纹标准							
EGKO-06LR 1.8 WD	708.1670.100.21	500	1/8	12x1.5	33.0	24.5	8.0	14	14	2.5	2.5	36
EGKO-08LR 1.4 WD	708.1670.170.21	500	1/4	14x1.5	42.0	29.5	12.0	17	19	4.0	4.0	57
EGKO-08LR 3.8 WD	708.1670.180.21	500	3/8	14x1.5	42.0	29.5	12.0	17	22	9.0	4.0	65
EGKO-10LR 1.4 WD	708.1670.270.21	500	1/4	16x1.5	40.5	27.5	12.0	19	19	6.0	6.0	58
EGKO-10LR 3.8 WD	708.1670.280.21	500	3/8	16x1.5	42.0	29.0	12.0	19	22	6.0	6.0	78
EGKO-12LR 1.4 WD	708.1670.380.21	400	1/4	18x1.5	40.0	27.5	12.0	22	19	7.0	7.0	68
EGKO-12LR 3.8 WD	708.1670.390.21	400	3/8	18x1.5	46.5	34.0	12.0	22	22	8.0	8.0	95
EGKO-12LR 1.2 WD	708.1670.400.21	400	1/2	18x1.5	44.0	29.5	14.0	22	27	8.0	8.0	110
EGKO-15LR 1.2 WD	708.1670.534.21	400	1/2	22x1.5	48.0	32.0	14.0	27	27	10.0	10.0	144
EGKO-18LR 1.2 WD	708.1670.646.21	400	1/2	26x1.5	45.0	31.5	14.0	32	27	13.0	13.0	152
EGKO-18LR 3.4 WD	708.1670.648.21	400	3/4	26x1.5	45.0	29.5	16.0	32	32	13.0	13.0	190
EGKO-22LR 1.2 WD	708.1670.764.21	250	1/2	30x2.0	50.5	34.5	14.0	36	27	14.0	14.0	206
EGKO-22LR 3.4 WD	708.1670.768.21	250	3/4	30x2.0	50.5	32.5	16.0	36	32	17.0	17.0	202
EGKO-22LR 1.1 WD	708.1670.770.21	250	1	30x2.0	53.5	33.5	18.0	36	41	22.0	17.0	297
EGKO-28LR 1.1 WD	708.1670.850.21	250	1	36x2.0	56.0	35.0	18.0	41	41	22.0	22.0	311
EGKO-35LR 5.4 WD	708.1670.944.21	250	1 1/4	45x2.0	63.5	42.5	20.0	50	50	28.0	28.0	507
EGKO-42LR 3.2 WD	708.1670.992.21	250	1 1/2	52x2.0	69.5	46.5	22.0	60	55	34.0	34.0	664
EGKO-06SR 1.4 WD	708.1670.110.31	800	1/4	14x1.5	39.5	27.0	12.0	17	19	2.5	2.5	56
EGKO-08SR 1.4 WD	708.1670.170.31	800	1/4	16x1.5	42.0	29.5	12.0	19	19	4.0	4.0	62
EGKO-10SR 1.4 WD	708.1670.270.31	800	1/4	18x1.5	38.0	26.0	12.0	22	19	6.0	6.0	68
EGKO-10SR 3.8 WD	708.1670.280.31	800	3/8	18x1.5	44.0	32.0	12.0	22	22	6.0	6.0	92
EGKO-12SR 1.4 WD	708.1670.380.31	630	1/4	20x1.5	45.0	33.5	12.0	24	19	6.0	8.0	97
EGKO-12SR 3.8 WD	708.1670.390.31	630	3/8	20x1.5	45.5	34.0	12.0	24	22	8.0	8.0	110
EGKO-12SR 1.2 WD	708.1670.400.31	630	1/2	20x1.5	58.5	35.0	14.0	24	27	8.0	8.0	153
EGKO-14SR 1.2 WD	708.1670.504.31	630	1/2	22x1.5	51.5	36.5	14.0	27	27	8.0	8.0	170
EGKO-16SR 1.2 WD	708.1670.566.31	420	1/2	24x1.5	51.5	37.0	14.0	30	27	11.0	11.0	230
EGKO-20SR 1.2 WD	708.1670.706.31	420	1/2	30x2.0	49.5	35.0	14.0	36	27	14.0	14.0	242
EGKO-20SR 3.4 WD	708.1670.704.31	420	3/4	30x2.0	59.5	43.0	16.0	36	32	14.0	14.0	286
EGKO-25SR 1.1 WD	708.1670.810.31	420	1	36x2.0	66.0	48.0	18.0	46	41	18.0	18.0	494
EGKO-30SR 5.4 WD	708.1670.902.31	320	1 1/4	42x2.0	68.5	50.5	20.0	50	50	23.0	23.0	674
EGKO-38SR 3.2 WD	708.1670.953.31	320	1 1/2	52x2.0	78.0	59.5	22.0	60	55	30.0	30.0	931

Baumaße sind Ungefährmaße bei angezogener Überwurfmutter.  
Dichtungsmaterial: FKM (andere Werkstoffe auf Anfrage)

Sizes are approximate dimensions at tightened nut.  
Sealing material: FKM (other materials on request)

尺寸为上紧螺母处的概略大小。  
密封材料: FKM (其他材料可咨询)

#### ISO 8434-1-SWODS

D1=Rohr außen-Ø  
M1=metrisches Anschlussgewinde  
e1/e2=kleinste Innen-Ø

D1=tube outside diameter  
M1=metric connecting thread  
e1/e2=minimum inside diameters

D1=管外径  
M1=公制连接管螺纹  
e1/e2=最小内径

## Gerade Einschraubstutzen mit Dichtkegel und O-Ring

Abdichtung durch Profildichtring Form E nach ISO 9974-2

## Straight male adaptor unions with taper and O-ring

profile sealing ring form E acc. ISO 9974-2

## 公制外螺纹端直通组合接头 (带24度锥旋转螺母及O型圈)

带符合ISO9974-2标准的ED圈密封

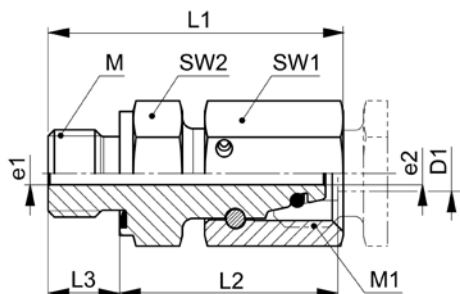

### EGKO-..LM WD/SM WD

Type-D1 M	Mat.-Nr.	PN	M	M1	L1	L2	L3	SW1	SW2	e1	e2	g/Stk
EGKO-06LM 10x1,0 WD	708.1671.180.21	500	10x1.0	12x1.5	33.0	24.5	8.0	14	14	2.5	2.5	36
EGKO-08LM 12x1,5 WD	708.1671.240.21	500	12x1.5	14x1.5	39.0	26.5	12.0	17	17	4.0	4.0	57
EGKO-10LM 14x1,5 WD	708.1671.280.21	500	14x1.5	16x1.5	40.5	27.5	12.0	19	19	6.0	6.0	58
EGKO-12LM 16x1,5 WD	708.1671.330.21	400	16x1.5	18x1.5	43.0	30.5	12.0	22	22	8.0	8.0	75
EGKO-15LM 18x1,5 WD	708.1671.390.21	400	18x1.5	22x1.5	45.5	31.5	12.0	27	24	10.0	10.0	144
EGKO-18LM 22x1,5 WD	708.1671.460.21	400	22x1.5	26x1.5	45.0	31.5	14.0	32	27	13.0	13.0	152
EGKO-22LM 26x1,5 WD	708.1671.535.21	250	26x1.5	30x2.0	50.5	32.5	16.0	36	32	17.0	17.0	202
EGKO-28LM 33x2,0 WD	708.1671.570.21	250	33x2.0	36x2.0	56.0	35.0	18.0	41	41	22.0	22.0	356
EGKO-35LM 42x2,0 WD	708.1671.600.21	250	42x2.0	45x2.0	63.5	42.5	20.0	50	50	28.0	28.0	507
EGKO-42LM 48x2,0 WD	708.1671.992.21	250	48x2.0	52x2.0	69.5	46.5	22.0	60	55	34.0	34.0	664
EGKO-06SM 12x1,5 WD	708.1671.195.31	800	12x1.5	14x1.5	39.5	27.0	12.0	17	17	2.5	2.5	56
EGKO-08SM 14x1,5 WD	708.1671.245.31	800	14x1.5	16x1.5	42.0	29.5	12.0	19	19	4.0	4.0	62
EGKO-10SM 16x1,5 WD	708.1671.285.31	800	16x1.5	18x1.5	44.0	32.0	12.0	22	22	6.0	6.0	92
EGKO-12SM 18x1,5 WD	708.1671.333.31	630	18x1.5	20x1.5	45.5	34.0	12.0	24	24	8.0	8.0	110
EGKO-14SM 20x1,5 WD	708.1671.382.31	630	20x1.5	22x1.5	51.5	36.5	14.0	27	27	8.0	8.0	170
EGKO-16SM 22x1,5 WD	708.1671.410.31	420	22x1.5	24x1.5	51.5	37.0	14.0	30	27	11.0	11.0	230
EGKO-20SM 27x2,0 WD	708.1671.506.31	420	27x2.0	30x2.0	59.5	43.0	16.0	36	32	14.0	14.0	286
EGKO-25SM 33x2,0 WD	708.1671.550.31	420	33x2.0	36x2.0	66.0	48.0	18.0	46	41	18.0	18.0	494
EGKO-30SM 42x2,0 WD	708.1671.590.31	320	42x2.0	42x2.0	68.5	50.5	20.0	50	50	23.0	23.0	674
EGKO-38SM 48x2,0 WD	708.1671.954.31	320	48x2.0	52x2.0	78.0	59.5	22.0	60	55	30.0	30.0	931

Baumaße sind Ungefährmaße bei angezogener Überwurfmutter.

Sizes are approximate dimensions at tightened nut.

尺寸为上紧螺母处的概略大小。

Dichtungsmaterial: FKM (andere Werkstoffe auf Anfrage)

Sealing material: FKM (other materials on request)

密封材料: FKM (其他材料可咨询)

### ISO 8434-1-SWODS

D1=Rohr außen-Ø  
M1=metrisches Anschlussgewinde  
e1/e2=kleinste Innen-Ø

D1=tube outside diameter  
M1=metric connecting thread  
e1/e2=minimum inside diameters

D1=管外径  
M1=公制连接管螺纹  
e1/e2=最小内径

**Gerade Einschraubstutzen NPT mit Dichtkegel und O-Ring**

**Straight male adaptor unions NPT with taper and O-ring**

**美制锥型外螺纹端直通组合接头 (带24度锥旋转螺母及O型圈)**

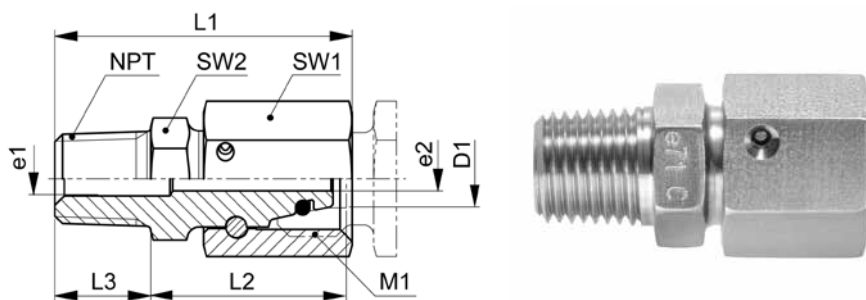

20

**EGKO-..LNPT/SNPT**

Type-D1 NPT	Mat.-Nr.	PN	NPT	M1	L1	L2	L3	SW1	SW2	e1	e2	g/Stk	
NPT=Einschraubgewinde NPT		NPT=tapered male adaptor thread NPT						NPT=美制一般用途圆锥管螺纹标准					
EGKO-06LNPT 1.8	708.1672.100.21	500	1/8	12x1.5	31.0	20.5	10.0	14	11	3.5	2.5	37	
EGKO-08LNPT 1.4	708.1672.170.21	500	1/4	14x1.5	38.0	23.5	14.0	17	14	6.5	4.0	69	
EGKO-10LNPT 1.4	708.1672.270.21	500	1/4	16x1.5	39.0	24.0	14.0	19	14	6.0	6.0	59	
EGKO-12LNPT 3.8	708.1672.390.21	400	3/8	18x1.5	40.5	23.0	17.0	22	19	8.0	8.0	102	
EGKO-12LNPT 1.2	708.1672.400.21	400	1/2	18x1.5	45.5	26.0	19.0	22	22	14.0	8.0	118	
EGKO-15LNPT 1.2	708.1672.534.21	400	1/2	22x1.5	51.5	30.5	19.0	27	22	14.0	10.0	159	
EGKO-18LNPT 1.2	708.1672.646.21	400	1/2	26x1.5	48.5	23.0	26.0	32	27	13.0	13.0	158	
EGKO-22LNPT 3.4	708.1672.768.21	250	3/4	30x2.0	54.0	32.0	20.0	36	27	19.0	17.0	216	
EGKO-28LNPT 1.1	708.1672.850.21	250	1	36x2.0	64.0	36.0	25.0	41	36	22.0	22.0	383	
EGKO-35LNPT 5.4	708.1672.944.21	250	1 1/4	45x2.0	66.5	39.5	26.0	50	46	28.0	28.0	505	
EGKO-42LNPT 3.2	708.1672.992.21	250	1 1/2	52x2.0	69.5	42.5	26.0	60	50	34.0	34.0	770	
EGKO-06SNPT 1.4	708.1672.110.31	800	1/4	14x1.5	38.0	23.5	14.0	17	14	6.5	2.5	61	
EGKO-08SNPT 1.4	708.1672.170.31	800	1/4	16x1.5	38.5	24.0	14.0	19	17	6.0	4.0	62	
EGKO-10SNPT 3.8	708.1672.280.31	800	3/8	18x1.5	40.5	14.5	26.0	22	19	6.0	6.0	90	
EGKO-12SNPT 3.8	708.1672.390.31	630	3/8	20x1.5	41.5	14.0	14.0	24	19	8.0	8.0	95	
EGKO-14SNPT 1.2	708.1672.504.31	630	1/2	22x1.5	51.5	31.5	19.0	27	22	12.0	8.0	177	
EGKO-16SNPT 1.2	708.1672.566.31	420	1/2	24x1.5	51.5	32.0	19.0	30	24	11.0	11.0	236	
EGKO-20SNPT 3.4	708.1672.708.31	420	3/4	30x2.0	54.5	28.0	26.0	36	27	16.0	14.0	283	
EGKO-25SNPT 1.1	708.1672.810.31	420	1	36x2.0	63.5	38.5	25.0	46	36	18.0	18.0	504	
EGKO-30SNPT 5.4	708.1672.902.31	320	1 1/4	42x2.0	68.0	44.0	26.0	50	46	23.0	23.0	650	
EGKO-38SNPT 3.2	708.1672.953.31	320	1 1/2	52x2.0	69.5	47.0	26.0	60	50	30.0	30.0	932	

Baumaße sind Ungefährmaße bei angezogener Überwurfmutter.

Sizes are approximate dimensions at tightened nut.

尺寸为上紧螺母处的概略大小。

Dichtungsmaterial: FKM (andere Werkstoffe auf Anfrage)

Sealing material: FKM (other materials on request)

密封材料: FKM (其他材料可咨询)

D1=Rohr außen-Ø  
M1=metrisches Anschlussgewinde  
e1/e2=kleinste Innen-Ø

D1=tube outside diameter  
M1=metric connecting thread  
e1/e2=minimum inside diameters

D1=管外径  
M1=公制连接管螺纹  
e1/e2=最小内径

**Einstellbare Winkelstutzen 45° mit Dichtkegel und O-Ring**

dichtkegelseitig vormontiert

**Adjustable elbow connectors 45° with taper and O-ring**

pre-assembled on tapered nipple side

**可调式45度弯头(带锥体及O型圈)**

预装在锥形螺纹接头侧

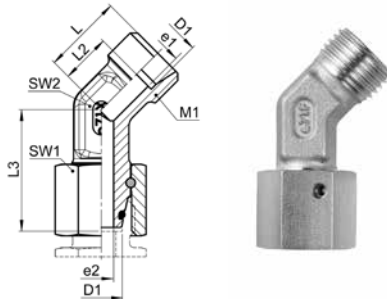

**XEWKO-..L M 45°**

Type-D1	Mat.-Nr.	PN	M1	L	L2	L3	SW1	SW2	e1	e2	g/Stk
XEWKO-06L 45° M	707.2660.060.20	500	12x1.5	16.0	9.0	26.0	14	12	4.0	3.0	33
XEWKO-08L 45° M	707.2660.080.20	500	14x1.5	19.0	12.0	27.5	17	12	6.0	4.0	45
XEWKO-10L 45° M	707.2660.100.20	500	16x1.5	19.0	12.0	29.0	19	14	8.0	6.0	60
XEWKO-12L 45° M	707.2660.120.20	400	18x1.5	21.0	14.0	29.5	22	17	10.0	8.0	80
XEWKO-15L 45° M	707.2660.150.20	400	22x1.5	24.0	17.0	32.5	27	19	12.0	10.0	131
XEWKO-18L 45° M	707.2660.180.20	400	26x1.5	24.0	16.5	35.5	32	24	15.0	13.0	180
XEWKO-22L 45° M	707.2660.220.20	250	30x2.0	26.0	18.5	38.5	36	27	19.0	17.0	243
XEWKO-28L 45° M	707.2660.280.20	250	36x2.0	30.5	23.0	41.5	41	36	24.0	22.0	378
XEWKO-35L 45° M	707.2660.350.20	250	45x2.0	37.0	26.5	51.0	50	41	30.0	28.0	565
XEWKO-42L 45° M	707.2660.420.20	250	52x2.0	37.0	26.0	56.0	60	50	36.0	34.0	848

Dichtungsmaterial: FKM (andere Werkstoffe auf Anfrage)

Sealing material: FKM (other materials on request)

密封材料: FKM (其他材料可咨询)

D1=Rohr außen-Ø  
M1=metrisches Anschlussgewinde  
e1/e2=kleinste Innen-Ø

D1=tube outside diameter  
M1=metric connecting thread  
e1/e2=minimum inside diameters

D1=管外径  
M1=公制连接管螺纹  
e1/e2=最小内径

**Einstellbare Winkelverschraubungen 45° mit Dichtkegel und O-Ring**  
**Adjustable elbow fittings 45° with taper and O-ring**  
 可调式45度弯头总成 (带锥体及O型圈)

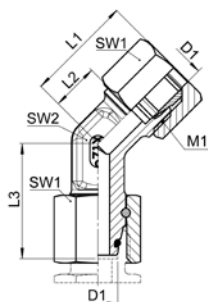

20

**EWKO-..L 45°**

Type -D1	Mat.-Nr.	PN	M1	L1	L2	L3	SW1	SW2	g/Stk
EWKO-06L 45°	708.2660.060.20	500	12x1.5	24.0	9.0	26.0	14	12	45
EWKO-08L 45°	708.2660.080.20	500	14x1.5	27.0	12.0	27.5	17	12	63
EWKO-10L 45°	708.2660.100.20	500	16x1.5	27.5	12.0	29.0	19	14	82
EWKO-12L 45°	708.2660.120.20	400	18x1.5	29.5	14.0	29.5	22	17	112
EWKO-15L 45°	708.2660.150.20	400	22x1.5	33.5	17.0	32.5	27	19	181
EWKO-18L 45°	708.2660.180.20	400	26x1.5	33.5	16.5	35.5	32	24	253
EWKO-22L 45°	708.2660.220.20	250	30x2.0	36.5	18.5	38.5	36	27	340
EWKO-28L 45°	708.2660.280.20	250	36x2.0	40.5	23.0	41.5	41	36	490
EWKO-35L 45°	708.2660.350.20	250	45x2.0	49.5	26.5	51.0	50	41	741
EWKO-42L 45°	708.2660.420.20	250	52x2.0	50.0	26.0	56.0	60	50	1117

Baumaße sind Ungefährmaße bei angezogener Überwurfmutter.

Sizes are approximate dimensions at tightened nut.

尺寸为上紧螺母处的概略大小。

Dichtungsmaterial: FKM (andere Werkstoffe auf Anfrage)

Sealing material: FKM (other materials on request)

密封材料: FKM (其他材料可咨询)

D1=Rohr außen-Ø  
 M1=metrisches Anschlussgewinde

D1=tube outside diameter  
 M1=metric connecting thread

D1=管外径  
 M1=公制连接管螺纹

Dichtkegelverschraubungen

Tapered seal fittings

带锥度密封接头

### Einstellbare Winkelstutzen mit Dichtkegel und O-Ring

dichtkegelseitig vormontiert

### Adjustable elbow connectors with taper and O-ring

pre-assembled on tapered nipple side

### 可调式直角组合接头体

锥形螺纹接头侧已预装

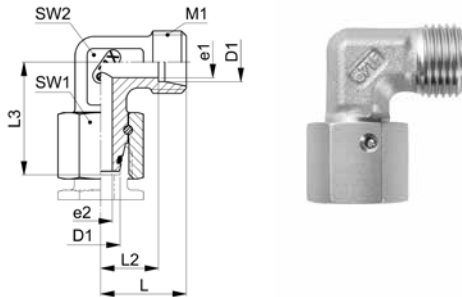

### XEWKO-..L/S M

Type-D1	Mat.-Nr.	PN	M1	L	L2	L3	SW1	SW2	e1	e2	g/Stk
XEWKO-06L M	707.2670.060.20	500	12x1.5	19.0	12.0	26.0	14	12	4.0	3.0	31
XEWKO-08L M	707.2670.080.20	500	14x1.5	21.0	14.0	27.5	17	12	6.0	4.0	42
XEWKO-10L M	707.2670.100.20	500	16x1.5	22.0	15.0	29.0	19	14	8.0	6.0	58
XEWKO-12L M	707.2670.120.20	400	18x1.5	24.0	17.0	29.5	22	17	10.0	8.0	77
XEWKO-15L M	707.2670.150.20	400	22x1.5	28.0	21.0	32.5	27	19	12.0	10.0	130
XEWKO-18L M	707.2670.180.20	400	26x1.5	31.0	23.5	35.5	32	24	15.0	13.0	180
XEWKO-22L M	707.2670.220.20	250	30x2.0	35.0	27.5	38.5	36	27	19.0	17.0	254
XEWKO-28L M	707.2670.280.20	250	36x2.0	38.0	30.5	41.5	41	36	24.0	22.0	371
XEWKO-35L M	707.2670.350.20	250	45x2.0	45.0	34.5	51.0	50	41	30.0	28.0	551
XEWKO-42L M	707.2670.420.20	250	52x2.0	51.0	40.0	56.0	60	50	36.0	34.0	868
XEWKO-06S M	707.2670.060.30	800	14x1.5	23.0	16.0	27.0	17	12	4.0	3.0	46
XEWKO-08S M	707.2670.080.30	800	16x1.5	24.0	17.0	27.5	19	14	5.0	4.0	65
XEWKO-10S M	707.2670.100.30	800	18x1.5	25.0	17.5	30.0	22	17	7.0	6.0	88
XEWKO-12S M	707.2670.120.30	630	20x1.5	29.0	21.5	31.0	24	17	8.0	8.0	106
XEWKO-14S M	707.2670.140.30	630	22x1.5	30.0	22.0	35.0	27	19	10.0	9.0	144
XEWKO-16S M	707.2670.160.30	420	24x1.5	33.0	24.5	36.5	30	24	12.0	11.0	196
XEWKO-20S M	707.2670.200.30	420	30x2.0	37.0	26.5	44.5	36	27	16.0	14.0	300
XEWKO-25S M	707.2670.250.30	420	36x2.0	42.0	30.0	50.0	46	36	20.0	18.0	539
XEWKO-30S M	707.2670.300.30	320	42x2.0	49.0	35.5	55.0	50	41	25.0	23.0	719
XEWKO-38S M	707.2670.380.30	320	52x2.0	57.0	41.0	63.0	60	50	32.0	30.0	1094

Dichtungsmaterial: FKM (andere Werkstoffe auf Anfrage)

Sealing material: FKM (other materials on request)

密封材料: FKM (其他材料可咨询)

ISO 8434-1-SWOE

D1=Rohr außen-Ø  
M1=metrisches Anschlussgewinde  
e1/e2=kleinste Innen-Ø

D1=tube outside diameter  
M1=metric connecting thread  
e1/e2=minimum inside diameters

D1=管外径  
M1=公制连接管螺纹  
e1/e2=最小内径

**Einstellbare Winkelverschraubungen mit Dichtkegel und O-Ring**

**Adjustable elbow fittings with taper and O-ring**

可调式直角组合接头总成 (带24度锥旋转螺母及O型圈)

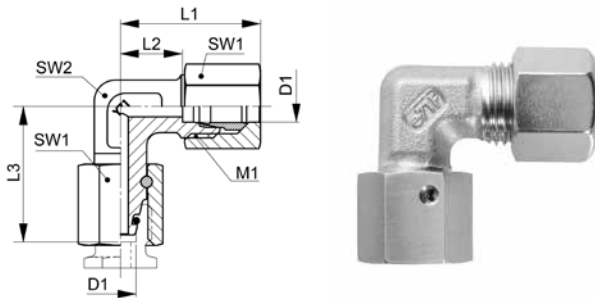

20

**EWKO-..L/S**

Type -D1	Mat.-Nr.	PN	M1	L1	L2	L3	SW1	SW2	g/Stk
EWKO-06L	708.2670.060.20	500	12x1.5	27.0	12.0	26.0	14	12	43
EWKO-08L	708.2670.080.20	500	14x1.5	29.0	14.0	27.5	17	12	59
EWKO-10L	708.2670.100.20	500	16x1.5	30.5	15.0	29.0	19	14	80
EWKO-12L	708.2670.120.20	400	18x1.5	32.0	17.0	29.5	22	17	105
EWKO-15L	708.2670.150.20	400	22x1.5	36.0	21.0	32.5	27	19	175
EWKO-18L	708.2670.180.20	400	26x1.5	40.0	23.5	35.5	32	24	248
EWKO-22L	708.2670.220.20	250	30x2.0	44.0	27.5	38.5	36	27	344
EWKO-28L	708.2670.280.20	250	36x2.0	47.0	30.5	41.5	41	36	476
EWKO-35L	708.2670.350.20	250	45x2.0	56.0	34.5	51.0	50	41	715
EWKO-42L	708.2670.420.20	250	52x2.0	63.0	40.0	56.0	60	50	1121
EWKO-06S	708.2670.060.30	800	14x1.5	31.0	16.0	27.0	17	12	64
EWKO-08S	708.2670.080.30	800	16x1.5	32.0	17.0	27.5	19	14	86
EWKO-10S	708.2670.100.30	800	18x1.5	34.0	17.5	30.0	22	17	120
EWKO-12S	708.2670.120.30	630	20x1.5	38.0	21.5	31.0	24	17	143
EWKO-14S	708.2670.140.30	630	22x1.5	40.0	22.0	35.0	27	19	188
EWKO-16S	708.2670.160.30	420	24x1.5	43.0	24.5	36.5	30	24	265
EWKO-20S	708.2670.200.30	420	30x2.0	48.0	26.5	44.5	36	27	412
EWKO-25S	708.2670.250.30	420	36x2.0	54.0	30.0	50.0	46	36	763
EWKO-30S	708.2670.300.30	320	42x2.0	62.0	35.5	55.0	50	41	968
EWKO-38S	708.2670.380.30	320	52x2.0	72.0	41.0	63.0	60	50	1458

Baumaße sind Ungefährmaße bei angezogener Überwurfmutter.

Sizes are approximate dimensions at tightened nut.

尺寸为上紧螺母处的概略大小。

Dichtungsmaterial: FKM (andere Werkstoffe auf Anfrage)

Sealing material: FKM (other materials on request)

密封材料: FKM (其他材料可咨询)

**ISO 8434-1-SWOEC**

D1=Rohr außen-Ø  
M1=metrisches Anschlussgewinde

D1=tube outside diameter  
M1=metric connecting thread

D1=管外径  
M1=公制连接管螺纹

## Einstellbare Winkel-Einschraubverschraubungen mit Dichtkegel und O-Ring

mit Einschraubstutzen, Abdichtung durch Dichtkante Form B nach ISO 1179-4

## Adjustable male adaptor elbow fittings with taper and O-ring

with male adaptor connector, sealing edge form B acc. ISO 1179-4

## 英制外螺纹可调式直角组合接头 (带24度锥旋转螺母及O型圈)

带螺柱适配器, 带符合ISO1179-4标准的金属面密封

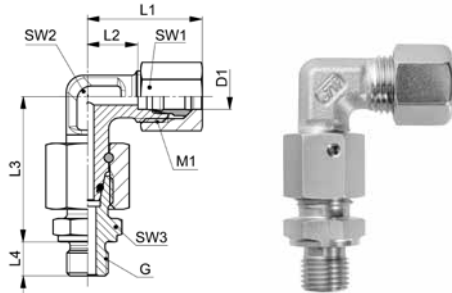

### EWKO-..LR/SR

Type-D1 G	Mat.-Nr.	PN	G	M1	L1	L2	L3	L4	SW1	SW2	SW3	g/Stk	
G=Rohrgewinde (zylindrisch)		G=BSP thread (parallel)					G=英制平行管螺纹标准						
EWKO-06LR 1.8	708.2671.100.20	500	1/8	12x1.5	27.0	12.0	34.5	8.0	14	12	14	57	
EWKO-08LR 1.4	708.2671.170.20	500	1/4	14x1.5	29.0	14.0	37.0	12.0	17	12	19	87	
EWKO-10LR 1.4	708.2671.270.20	500	1/4	16x1.5	30.5	15.0	39.5	12.0	19	14	19	109	
EWKO-12LR 1.4	708.2671.380.20	400	1/4	18x1.5	32.0	17.0	41.5	12.0	22	17	19	137	
EWKO-12LR 3.8	708.2671.390.20	400	3/8	18x1.5	32.0	17.0	42.0	12.0	22	17	22	147	
EWKO-12LR 1.2	708.2671.400.20	400	1/2	18x1.5	32.0	17.0	42.5	14.0	22	17	27	175	
EWKO-15LR 1.2	708.2671.534.20	400	1/2	22x1.5	36.0	21.0	46.5	14.0	27	19	27	248	
EWKO-18LR 1.2	708.2671.646.20	400	1/2	26x1.5	40.0	23.5	50.0	14.0	32	24	27	320	
EWKO-22LR 3.4	708.2671.768.20	250	3/4	30x2.0	44.0	27.5	55.0	16.0	36	27	32	450	
EWKO-28LR 1.1	708.2671.850.20	250	1	36x2.0	47.0	30.5	59.0	18.0	41	36	41	349	
EWKO-35LR 5.4	708.2671.944.20	250	1 1/4	45x2.0	56.0	34.5	68.5	20.0	50	41	50	996	
EWKO-42LR 3.2	708.2671.992.20	250	1 1/2	52x2.0	63.0	40.0	75.0	22.0	60	50	60	1482	
EWKO-06SR 1.4	708.2671.110.30	800	1/4	14x1.5	31.0	16.0	40.0	12.0	17	12	19	98	
EWKO-08SR 1.4	708.2671.170.30	800	1/4	16x1.5	32.0	17.0	42.0	12.0	19	14	19	128	
EWKO-10SR 3.8	708.2671.280.30	800	3/8	18x1.5	34.0	17.5	45.0	12.0	22	17	22	178	
EWKO-12SR 3.8	708.2671.390.30	630	3/8	20x1.5	38.0	21.5	48.0	12.0	24	17	22	207	
EWKO-12SR 1.2	708.2671.400.30	630	1/2	20x1.5	38.0	21.5	48.5	14.0	24	17	27	242	
EWKO-14SR 1.2	708.2671.504.30	630	1/2	22x1.5	40.0	22.0	54.0	14.0	27	19	27	287	
EWKO-16SR 1.2	708.2671.566.30	420	1/2	24x1.5	43.0	24.5	55.0	14.0	30	24	27	359	
EWKO-20SR 3.4	708.2671.704.30	420	3/4	30x2.0	48.0	26.5	65.0	14.0	36	27	32	567	
EWKO-25SR 1.1	708.2671.810.30	420	1	36x2.0	54.0	30.0	73.0	18.0	46	36	41	1036	
EWKO-30SR 5.4	708.2671.902.30	320	1 1/4	42x2.0	62.0	35.5	78.5	20.0	50	41	50	1398	
EWKO-38SR 3.2	708.2671.953.30	320	1 1/2	52x2.0	72.0	41.0	89.0	22.0	60	50	55	2037	

Baumaße sind Ungefährmaße bei angezogener Überwurfmutter.

Sizes are approximate dimensions at tightened nut.

尺寸为上紧螺母处的概略大小。

Dichtungsmaterial: FKM (andere Werkstoffe auf Anfrage)

Sealing material: FKM (other materials on request)

密封材料: FKM (其他材料可咨询)

D1=Rohr außen-Ø  
M1=metrisches Anschlussgewinde

D1=tube outside diameter  
M1=metric connecting thread

D1=管外径  
M1=公制连接管螺纹



## Einstellbare Winkel-Einschraubverschraubungen mit Dichtkegel und O-Ring

mit Einschraubstutzen, Abdichtung durch Profildichtring Form E nach ISO 1179-2

## Adjustable male adaptor elbow fittings with taper and O-ring

with male adaptor connector, profile sealing ring form E acc. ISO 1179-2

## 英制外螺纹可调式直角组合接头 (带24度锥旋转螺母及O型圈)

带螺柱适配器, 带符合ISO1179-2标准的ED圈密封

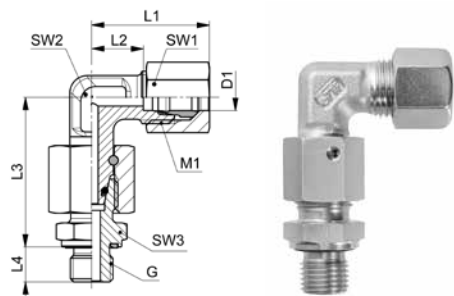

20

### EWKO-..LR WD/SR WD

Type-D1 G	Mat.-Nr.	PN	G	M1	L1	L2	L3	L4	SW1	SW2	SW3	g/Stk
G=Rohrgewinde (zylindrisch)		G=BSP thread (parallel)			G=英制平行管螺纹标准							
EWKO-06LR 1.8 WD	708.2672.100.20	500	1/8	12x1.5	27.0	12.0	34.0	8.0	14	12	14	57
EWKO-08LR 1.4 WD	708.2672.170.20	500	1/4	14x1.5	29.0	14.0	37.0	12.0	17	12	19	86
EWKO-10LR 1.4 WD	708.2672.270.20	500	1/4	16x1.5	30.5	15.0	40.0	12.0	19	14	19	108
EWKO-12LR 1.4 WD	708.2672.380.20	400	1/4	18x1.5	32.0	17.0	41.5	12.0	22	17	19	134
EWKO-12LR 3.8 WD	708.2672.390.20	400	3/8	18x1.5	32.0	17.0	42.0	12.0	22	17	22	147
EWKO-12LR 1.2 WD	708.2672.400.20	400	1/2	18x1.5	32.0	17.0	42.5	14.0	22	17	27	175
EWKO-15LR 1.2 WD	708.2672.534.20	400	1/2	22x1.5	36.0	21.0	43.5	14.0	27	19	27	248
EWKO-18LR 1.2 WD	708.2672.646.20	400	1/2	26x1.5	40.0	23.5	50.0	14.0	32	24	27	320
EWKO-22LR 3.4 WD	708.2672.768.20	250	3/4	30x2.0	44.0	27.5	55.0	16.0	36	27	32	448
EWKO-28LR 1.1 WD	708.2672.850.20	250	1	36x2.0	47.0	30.5	59.0	18.0	41	36	41	645
EWKO-35LR 5.4 WD	708.2672.944.20	250	1 1/4	45x2.0	56.0	34.5	68.0	20.0	50	41	50	995
EWKO-42LR 3.2 WD	708.2672.992.20	250	1 1/2	52x2.0	63.0	40.0	75.5	22.0	60	50	55	1477
EWKO-06SR 1.4 WD	708.2672.110.30	800	1/4	14x1.5	31.0	16.0	39.0	12.0	17	12	19	100
EWKO-08SR 1.4 WD	708.2672.170.30	800	1/4	16x1.5	32.0	17.0	41.5	12.0	19	14	19	127
EWKO-10SR 3.8 WD	708.2672.280.30	800	3/8	18x1.5	34.0	17.5	45.0	12.0	22	17	22	176
EWKO-12SR 3.8 WD	708.2672.390.30	630	3/8	20x1.5	38.0	21.5	48.0	12.0	24	17	22	207
EWKO-12SR 1.2 WD	708.2672.400.30	630	1/2	20x1.5	38.0	21.5	48.5	14.0	24	17	27	241
EWKO-14SR 1.2 WD	708.2672.504.30	630	1/2	22x1.5	40.0	22.0	54.0	14.0	27	19	27	287
EWKO-16SR 1.2 WD	708.2672.566.30	420	1/2	24x1.5	43.0	24.5	55.0	14.0	30	24	27	359
EWKO-20SR 3.4 WD	708.2672.704.30	420	3/4	30x2.0	48.0	26.5	65.0	18.0	36	27	32	564
EWKO-25SR 1.1 WD	708.2672.810.30	420	1	36x2.0	54.0	30.0	72.5	18.0	46	36	41	1033
EWKO-30SR 5.4 WD	708.2672.944.30	320	1 1/4	42x2.0	62.0	35.5	78.5	18.0	50	41	50	1394
EWKO-38SR 3.2 WD	708.2672.953.30	320	1 1/2	52x2.0	72.0	41.0	89.0	22.0	60	50	55	2033

Baumaße sind Ungefährmaße bei angezogener Überwurfmutter.

Sizes are approximate dimensiones at tightened nut.

尺寸为上紧螺母处的概略大小。

Dichtungsmaterial: FKM (andere Werkstoffe auf Anfrage)

Sealing material: FKM (other materials on request)

密封材料: FKM (其他材料可咨询)

D1=Rohr außen-Ø  
M1=metrisches Anschlussgewinde

D1=tube outside diameter  
M1=metric connecting thread

D1=管外径  
M1=公制连接管螺纹

Dichtkegelverschraubungen

Tapered seal fittings

带锥度密封接头

### Einstellbare T-Stutzen mit Dichtkegel und O-Ring

dichtkegelseitig vormontiert

### Adjustable T connectors with taper and O-ring

pre-assembled on tapered nipple side

### 可调式三通组合接头体 (带24度锥旋转螺母及O型圈)

锥形螺纹接头侧已预装

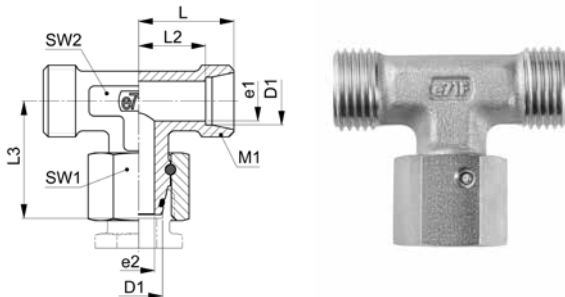

## XETKO-..L/S M

Type-D1	Mat.-Nr.	PN	M1	L	L2	L3	SW1	SW2	e1	e2	g/Stk
XETKO-06L M	707.3670.060.20	500	12x1.5	19.0	12.0	26.0	14	12	4.0	3.0	44
XETKO-08L M	707.3670.080.20	500	14x1.5	21.0	14.0	27.5	17	12	6.0	4.0	57
XETKO-10L M	707.3670.100.20	500	16x1.5	22.0	15.0	29.0	19	14	8.0	6.0	72
XETKO-12L M	707.3670.120.20	400	18x1.5	24.0	17.0	29.5	22	17	10.0	8.0	94
XETKO-15L M	707.3670.150.20	400	22x1.5	28.0	21.0	32.5	27	19	12.0	10.0	163
XETKO-18L M	707.3670.180.20	400	26x1.5	31.0	23.5	35.5	32	24	15.0	13.0	218
XETKO-22L M	707.3670.220.20	250	30x2.0	35.0	27.5	38.5	36	27	19.0	17.0	306
XETKO-28L M	707.3670.280.20	250	36x2.0	38.0	30.5	41.5	41	36	24.0	22.0	461
XETKO-35L M	707.3670.350.20	250	45x2.0	45.0	34.5	51.0	50	41	30.0	28.0	691
XETKO-42L M	707.3670.420.20	250	52x2.0	51.0	40.0	56.0	60	50	36.0	34.0	1052
XETKO-06S M	707.3670.060.30	800	14x1.5	23.0	16.0	27.0	17	12	4.0	3.0	67
XETKO-08S M	707.3670.080.30	800	16x1.5	24.0	17.0	27.5	19	14	5.0	4.0	88
XETKO-10S M	707.3670.100.30	800	18x1.5	25.0	17.5	30.0	22	17	7.0	6.0	115
XETKO-12S M	707.3670.120.30	630	20x1.5	29.0	21.5	31.0	24	17	8.0	8.0	147
XETKO-14S M	707.3670.140.30	630	22x1.5	30.0	22.0	35.0	27	19	10.0	9.0	190
XETKO-16S M	707.3670.160.30	420	24x1.5	33.0	24.5	36.5	30	24	12.0	11.0	244
XETKO-20S M	707.3670.200.30	420	30x2.0	37.0	26.5	44.5	36	27	16.0	14.0	383
XETKO-25S M	707.3670.250.30	420	36x2.0	42.0	30.0	50.0	46	36	20.0	18.0	685
XETKO-30S M	707.3670.300.30	320	42x2.0	49.0	35.5	55.0	50	41	25.0	23.0	916
XETKO-38S M	707.3670.380.30	320	52x2.0	57.0	41.0	63.0	60	50	32.0	30.0	1383

Dichtungsmaterial: FKM (andere Werkstoffe auf Anfrage)

Sealing material: FKM (other materials on request)

密封材料: FKM (其他材料可咨询)

ISO 8434-1-SWOBT

D1=Rohr außen-Ø  
M1=metrisches Anschlussgewinde  
e1/e2=kleinste Innen-Ø

D1=tube outside diameter  
M1=metric connecting thread  
e1/e2=minimum inside diameters

D1=管外径  
M1=公制连接管螺纹  
e1/e2=最小内径

**Einstellbare T-Verschraubungen mit Dichtkegel und O-Ring**

**Adjustable T fittings with taper and O-ring**

可调式三通组合接头总成 (带24度锥旋转螺母及O型圈)

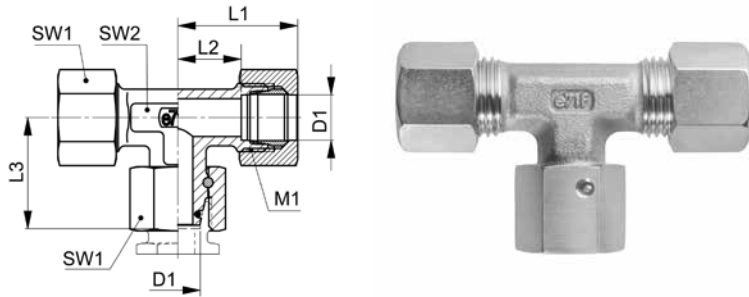

20

**ETKO-..L/S**

Type -D1	Mat.-Nr.	PN	M1	L1	L2	L3	SW1	SW2	g/Stk
ETKO-06L	708.3670.060.20	500	12x1.5	27.0	12.0	26.0	14	12	54
ETKO-08L	708.3670.080.20	500	14x1.5	29.0	14.0	27.5	17	12	76
ETKO-10L	708.3670.100.20	500	16x1.5	30.5	15.0	29.0	19	14	107
ETKO-12L	708.3670.120.20	400	18x1.5	32.5	17.0	29.5	22	17	135
ETKO-15L	708.3670.150.20	400	22x1.5	37.0	21.0	32.5	27	19	223
ETKO-18L	708.3670.180.20	400	26x1.5	40.5	23.5	35.5	32	24	332
ETKO-22L	708.3670.220.20	250	30x2.0	44.5	27.5	38.5	36	27	439
ETKO-28L	708.3670.280.20	250	36x2.0	47.5	30.5	41.5	41	36	659
ETKO-35L	708.3670.350.20	250	45x2.0	57.0	34.5	51.0	50	41	915
ETKO-42L	708.3670.420.20	250	52x2.0	63.5	40.0	56.0	60	50	1536
ETKO-06S	708.3670.060.30	800	14x1.5	31.0	16.0	27.0	17	12	87
ETKO-08S	708.3670.080.30	800	16x1.5	32.0	17.0	27.5	19	14	109
ETKO-10S	708.3670.100.30	800	18x1.5	34.5	17.5	30.0	22	17	169
ETKO-12S	708.3670.120.30	630	20x1.5	38.5	21.5	31.0	24	17	212
ETKO-14S	708.3670.140.30	630	22x1.5	40.5	22.0	35.0	27	19	281
ETKO-16S	708.3670.160.30	420	24x1.5	44.0	24.5	36.5	30	24	382
ETKO-20S	708.3670.200.30	420	30x2.0	49.5	26.5	44.5	36	27	542
ETKO-25S	708.3670.250.30	420	36x2.0	55.5	30.0	50.0	46	36	1050
ETKO-30S	708.3670.300.30	320	42x2.0	63.5	35.5	55.0	50	41	1349
ETKO-38S	708.3670.380.30	320	52x2.0	74.0	41.0	63.0	60	50	2061

Baumaße sind Ungefährmaße bei angezogener Überwurfmutter.

Sizes are approximate dimensions at tightened nut.

尺寸为上紧螺母处的概略大小。

Dichtungsmaterial: FKM (andere Werkstoffe auf Anfrage)

Sealing material: FKM (other materials on request)

密封材料: FKM (其他材料可咨询)

**ISO 8434-1-SWOBTC**

D1=Rohr außen-Ø  
M1=metrisches Anschlussgewinde

D1=tube outside diameter  
M1=metric connecting thread

D1=管外径  
M1=公制连接管螺纹

Dichtkegelverschraubungen

Tapered seal fittings

带锥度密封接头

### Einstellbare L-Stutzen mit Dichtkegel und O-Ring

dichtkegelseitig vormontiert

### Adjustable L connectors with taper and O-ring

pre-assembled on tapered nipple side

### 可调式外螺纹三通主路组合接头体 (带24度锥旋转螺母及O型圈)

锥形螺纹接头侧已预装

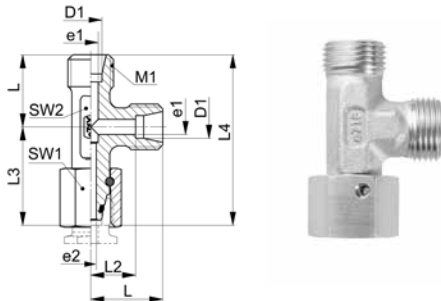

## XELKO-..L/S M

Type-D1	Mat.-Nr.	PN	M1	L	L2	L3	L4	SW1	SW2	e1	e2	g/Stk
XELKO-06L M	707.3671.060.20	500	12x1.5	19.0	12.0	26.0	38.0	14	12	4.0	3.0	43
XELKO-08L M	707.3671.080.20	500	14x1.5	21.0	14.0	27.5	41.5	17	12	6.0	4.0	56
XELKO-10L M	707.3671.100.20	500	16x1.5	22.0	15.0	29.0	44.0	19	14	8.0	6.0	71
XELKO-12L M	707.3671.120.20	400	18x1.5	24.0	17.0	29.5	46.5	22	17	10.0	8.0	92
XELKO-15L M	707.3671.150.20	400	22x1.5	28.0	21.0	32.5	53.5	27	19	12.0	10.0	159
XELKO-18L M	707.3671.180.20	400	26x1.5	31.0	23.5	35.5	59.0	32	24	15.0	13.0	221
XELKO-22L M	707.3671.220.20	250	30x2.0	35.0	27.5	38.5	66.0	36	27	19.0	17.0	310
XELKO-28L M	707.3671.280.20	250	36x2.0	38.0	30.5	41.5	72.0	41	36	24.0	22.0	469
XELKO-35L M	707.3671.350.20	250	45x2.0	45.0	34.5	51.0	85.5	50	41	30.0	28.0	700
XELKO-42L M	707.3671.420.20	250	52x2.0	51.0	40.0	56.0	96.0	60	50	36.0	34.0	1047
XELKO-06S M	707.3671.060.30	800	14x1.5	23.0	16.0	27.0	43.0	17	12	4.0	3.0	67
XELKO-08S M	707.3671.080.30	800	16x1.5	24.0	17.0	27.5	44.5	19	14	5.0	4.0	87
XELKO-10S M	707.3671.100.30	800	18x1.5	25.0	17.5	30.0	47.5	22	17	7.0	6.0	116
XELKO-12S M	707.3671.120.30	630	20x1.5	29.0	21.5	31.0	52.5	24	17	8.0	8.0	150
XELKO-14S M	707.3671.140.30	630	22x1.5	30.0	22.0	35.0	57.0	27	19	10.0	9.0	194
XELKO-16S M	707.3671.160.30	420	24x1.5	33.0	24.5	36.5	61.0	30	24	12.0	11.0	251
XELKO-20S M	707.3671.200.30	420	30x2.0	37.0	26.5	44.5	71.0	36	27	16.0	14.0	396
XELKO-25S M	707.3671.250.30	420	36x2.0	42.0	30.0	50.0	80.0	46	36	20.0	18.0	725
XELKO-30S M	707.3671.300.30	320	42x2.0	49.0	35.5	55.0	90.5	50	41	25.0	23.0	974
XELKO-38S M	707.3671.380.30	320	52x2.0	57.0	41.0	63.0	104.0	60	50	32.0	30.0	1496

Dichtungsmaterial: FKM (andere Werkstoffe auf Anfrage)

Sealing material: FKM (other materials on request)

密封材料: FKM (其他材料可咨询)

#### ISO 8434-1-SWORT

D1=Rohr außen-Ø  
M1=metrisches Anschlussgewinde  
e1/e2=kleinste Innen-Ø

D1=tube outside diameter  
M1=metric connecting thread  
e1/e2=minimum inside diameters

D1=管外径  
M1=公制连接管螺纹  
e1/e2=最小内径

**Einstellbare L-Verschraubungen mit Dichtkegel und O-Ring**

**Adjustable L fittings with taper and O-ring**

可调式外螺纹三通主路组合接头总成 (带24度锥旋转螺母及O型圈)

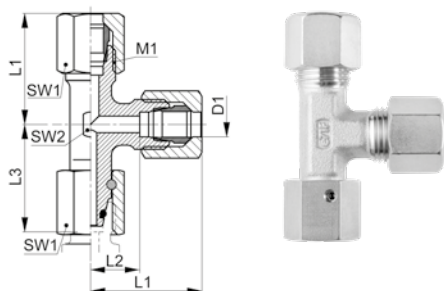

20

**ELKO-..L/S**

Type -D1	Mat.-Nr.	PN	M1	L1	L2	L3	SW1	SW2	g/Stk
ELKO-06L	708.3671.060.20	500	12x1.5	27.0	12.0	26.0	14	12	53
ELKO-08L	708.3671.080.20	500	14x1.5	29.0	14.0	27.5	17	12	80
ELKO-10L	708.3671.100.20	500	16x1.5	30.0	15.0	29.0	19	14	109
ELKO-12L	708.3671.120.20	400	18x1.5	32.0	17.0	29.5	22	17	132
ELKO-15L	708.3671.150.20	400	22x1.5	36.0	21.0	32.5	27	19	223
ELKO-18L	708.3671.180.20	400	26x1.5	40.0	23.5	35.5	32	24	337
ELKO-22L	708.3671.220.20	250	30x2.0	44.0	27.5	38.5	36	27	439
ELKO-28L	708.3671.280.20	250	36x2.0	47.0	30.5	41.5	41	36	667
ELKO-35L	708.3671.350.20	250	45x2.0	56.0	34.5	51.0	50	41	1004
ELKO-42L	708.3671.420.20	250	52x2.0	63.0	40.0	56.0	60	50	1344
ELKO-06S	708.3671.060.30	800	14x1.5	31.0	16.0	27.0	17	12	89
ELKO-08S	708.3671.080.30	800	16x1.5	32.0	17.0	27.5	19	14	109
ELKO-10S	708.3671.100.30	800	18x1.5	34.0	17.5	30.0	22	17	170
ELKO-12S	708.3671.120.30	630	20x1.5	38.0	21.5	31.0	24	17	212
ELKO-14S	708.3671.140.30	630	22x1.5	40.0	22.0	35.0	27	19	277
ELKO-16S	708.3671.160.30	420	24x1.5	43.0	24.5	36.5	30	24	345
ELKO-20S	708.3671.200.30	420	30x2.0	48.0	26.5	44.5	36	27	548
ELKO-25S	708.3671.250.30	420	36x2.0	54.0	30.0	50.0	46	36	1036
ELKO-30S	708.3671.300.30	320	42x2.0	62.0	35.5	55.0	50	41	1341
ELKO-38S	708.3671.380.30	320	52x2.0	72.0	41.0	63.0	60	50	1964

Baumaße sind Ungefährmaße bei angezogener Überwurfmutter.

Sizes are approximate dimensions at tightened nut.

尺寸为上紧螺母处的概略大小。

Dichtungsmaterial: FKM (andere Werkstoffe auf Anfrage)

Sealing material: FKM (other materials on request)

密封材料: FKM (其他材料可咨询)

ISO 8434-1-SWORTC

D1=Rohraußen-Ø  
M1=metrisches Anschlussgewinde

D1=tube outside diameter  
M1=metric connecting thread

D1=管外径  
M1=公制连接管螺纹

## Einstellbare Manometerverschraubungen mit Dichtkegel und O-Ring

Abdichtung mit metallischem Dichtkantenring

## Adjustable manometer fittings with taper and O-ring

sealing with metal seal-edge ring

## 可调式压力表接头 (带24度锥旋转螺母及O型圈)

带金属密封圈

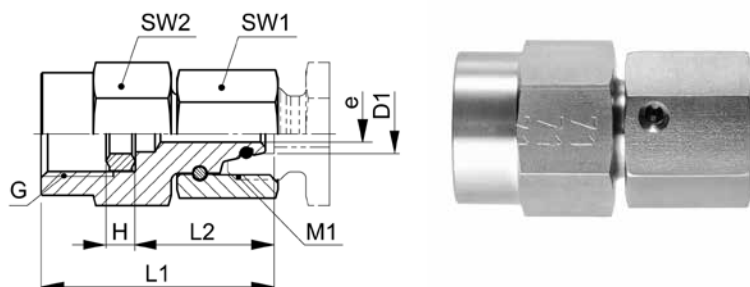

### EMAKO-..LR/SR DKR

Type-D1 G	Mat.-Nr.	PN	G	M1	H	L1	L2	SW1	SW2	e	g/Stk
G=Rohrgewinde (zylindrisch)		G=BSP thread (parallel)				G=英制平行管螺纹标准					
EMAKO-06LR 1.4 DKR	708.0245.110.20	500	1/4	12x1.5	4.5	35.5	21.5	14	19	2.5	45
EMAKO-08LR 1.4 DKR	708.0245.170.20	500	1/4	14x1.5	4.5	35.5	21.5	17	19	4.0	57
EMAKO-10LR 1.4 DKR	708.0245.270.20	500	1/4	16x1.5	4.5	36.0	21.5	19	19	5.5	63
EMAKO-12LR 1.4 DKR	708.0245.380.20	400	1/4	18x1.5	4.5	36.0	21.5	22	19	5.5	75
EMAKO-06SR 1.4 DKR	708.0245.110.30	800	1/4	14x1.5	4.5	36.0	21.5	17	19	2.5	54
EMAKO-06SR 1.2 DKR	708.0245.125.30	800	1/2	14x1.5	5.0	42.5	23.0	17	27	2.5	110
EMAKO-08SR 1.4 DKR	708.0245.170.30	800	1/4	16x1.5	4.5	37.5	23.0	19	19	4.0	62
EMAKO-08SR 1.2 DKR	708.0245.185.30	800	1/2	16x1.5	5.0	43.0	23.5	19	27	4.0	112
EMAKO-10SR 1.4 DKR	708.0245.270.30	800	1/4	18x1.5	4.5	37.5	27.5	22	19	7.0	76
EMAKO-10SR 1.2 DKR	708.0245.285.30	800	1/2	18x1.5	5.0	43.5	24.0	22	27	6.0	123
EMAKO-12SR 1.4 DKR	708.0245.380.30	630	1/4	20x1.5	4.5	39.5	25.0	24	19	7.0	120
EMAKO-12SR 1.2 DKR	708.0245.400.30	630	1/2	20x1.5	5.0	45.0	25.5	24	27	7.0	139

Baumaße sind Ungefährmaße bei angezogener Überwurfmutter.

Sizes are approximate dimensions at tightened nut.

尺寸为上紧螺母处的概略大小。

Dichtungsmaterial: FKM (andere Werkstoffe auf Anfrage)

Sealing material: FKM (other materials on request)

密封材料: FKM (其他材料可咨询)

D1=Rohr außen-Ø  
M1=metrisches Anschlussgewinde  
e=kleinster Innen-Ø

D1=tube outside diameter  
M1=metric connecting thread  
e=minimum inside diameter

D1=管外径  
M1=公制连接管螺纹  
e=最小内径

## EXMAR CAD Bibliothek –

- technische Daten und Zeichnungen von Katalogartikel
- kostenfreie Downloads
- im benötigten CAD-Format

## EXMAR CAD Library –

- technical data and drawings of catalog items
- free downloads
- in the desired CAD format

## EXMAR CAD 图库 –

- 目录中所有商品的技术数据和图纸
- 免费下载
- 你所需要的CAD文件格式

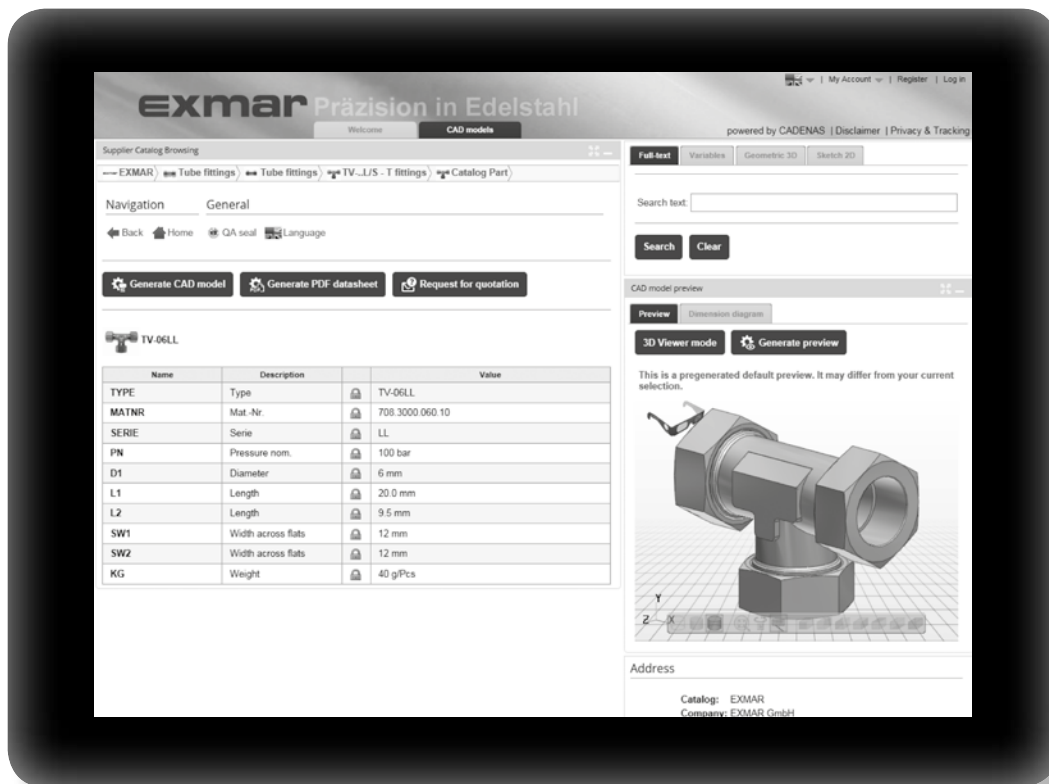

[exmar.partcommunity.com](http://exmar.partcommunity.com)

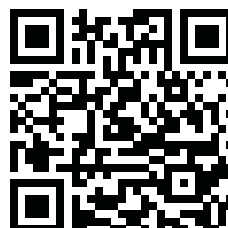

## Reduzierstutzen mit Dichtkegel und O-Ring

dichtkegelseitig vormontiert

## Reducing connectors with taper and O-ring

pre-assembled on tapered nipple side

## 直通变径接头体 (带24度旋转螺母及O型圈)

24°旋转螺母已预装

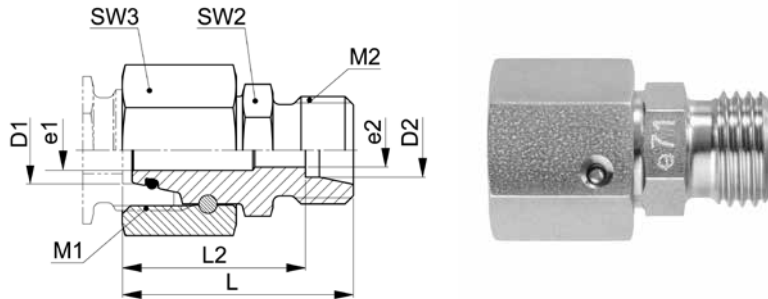

### XGRKO-..L M

Type-D1 /D2	Mat.-Nr.	PN	M1	M2	L	L2	SW2	SW3	e1	e2	g/Stk
XGRKO-08/06L M	707.1871.140.20	500	14x1.5	12x1.5	30.5	23.5	12	17	4.0	4.0	30
XGRKO-10/06L M	707.1871.175.20	500	16x1.5	12x1.5	32.0	25.0	14	19	6.0	4.0	42
XGRKO-10/08L M	707.1871.190.20	500	16x1.5	14x1.5	32.0	25.0	14	19	6.0	6.0	40
XGRKO-12/06L M	707.1871.215.20	400	18x1.5	12x1.5	32.0	25.0	17	22	8.0	4.0	56
XGRKO-12/08L M	707.1871.225.20	400	18x1.5	14x1.5	32.0	25.0	17	22	8.0	6.0	56
XGRKO-12/10L M	707.1871.240.20	400	18x1.5	16x1.5	33.0	26.0	17	22	8.0	8.0	52
XGRKO-15/06L M	707.1871.391.20	400	22x1.5	12x1.5	35.5	28.5	22	27	10.0	4.0	88
XGRKO-15/08L M	707.1871.400.20	400	22x1.5	14x1.5	35.5	28.5	22	27	10.0	6.0	100
XGRKO-15/10L M	707.1871.410.20	400	22x1.5	16x1.5	36.0	29.0	22	27	10.0	8.0	96
XGRKO-15/12L M	707.1871.420.20	400	22x1.5	18x1.5	36.0	29.0	22	27	10.0	10.0	94
XGRKO-18/06L M	707.1871.563.20	400	26x1.5	12x1.5	35.0	28.0	24	32	13.0	4.0	112
XGRKO-18/08L M	707.1871.570.20	400	26x1.5	14x1.5	35.0	28.0	24	32	13.0	6.0	116
XGRKO-18/10L M	707.1871.575.20	400	26x1.5	16x1.5	36.0	29.0	24	32	13.0	8.0	128
XGRKO-18/12L M	707.1871.580.20	400	26x1.5	18x1.5	36.0	29.0	24	32	13.0	10.0	124
XGRKO-18/15L M	707.1871.610.20	400	26x1.5	22x1.5	37.0	30.0	24	32	13.0	12.0	126
XGRKO-22/06L M	707.1871.723.20	250	30x2.0	12x1.5	39.0	32.0	27	36	17.0	4.0	166
XGRKO-22/08L M	707.1871.724.20	250	30x2.0	14x1.5	39.0	32.0	27	36	17.0	6.0	164
XGRKO-22/10L M	707.1871.725.20	250	30x2.0	16x1.5	40.0	33.0	27	36	17.0	8.0	166
XGRKO-22/12L M	707.1871.730.20	250	30x2.0	18x1.5	40.0	33.0	27	36	17.0	10.0	166
XGRKO-22/15L M	707.1871.745.20	250	30x2.0	22x1.5	41.0	34.0	27	36	17.0	12.0	190
XGRKO-22/18L M	707.1871.755.20	250	30x2.0	26x1.5	41.0	33.5	27	36	17.0	15.0	180
XGRKO-28/06L M	707.1871.828.20	250	36x2.0	12x1.5	41.0	34.0	36	41	22.0	4.0	310
XGRKO-28/08L M	707.1871.829.20	250	36x2.0	14x1.5	41.0	34.0	36	41	22.0	6.0	306
XGRKO-28/10L M	707.1871.830.20	250	36x2.0	16x1.5	42.0	35.0	36	41	22.0	8.0	300
XGRKO-28/12L M	707.1871.835.20	250	36x2.0	18x1.5	42.0	35.0	36	41	22.0	10.0	300
XGRKO-28/15L M	707.1871.865.20	250	36x2.0	22x1.5	43.0	36.0	36	41	22.0	12.0	304
XGRKO-28/18L M	707.1871.870.20	250	36x2.0	26x1.5	43.0	35.5	36	41	22.0	15.0	247
XGRKO-28/22L M	707.1871.900.20	250	36x2.0	30x2.0	45.0	37.5	36	41	22.0	19.0	332

Fortsetzung auf nächster linker Seite

To be continued on next left page

续下页左

D1/D2=Rohr außen-Ø  
M1/M2=metrische Anschlussgewinde  
e1/e2=kleinste Innen-Ø

D1/D2=tube outside diameters  
M1/M2=metric connecting threads  
e1/e2=minimum inside diameters

D1/D2=管外径  
M1/M2=公制连接管螺纹  
e1/e2=最小内径



**Reduzierschraubungen mit Dichtkegel und O-Ring**

**Reducing fittings with taper and O-ring**

直通变径接头总成 (带24度旋转螺母及O型圈)

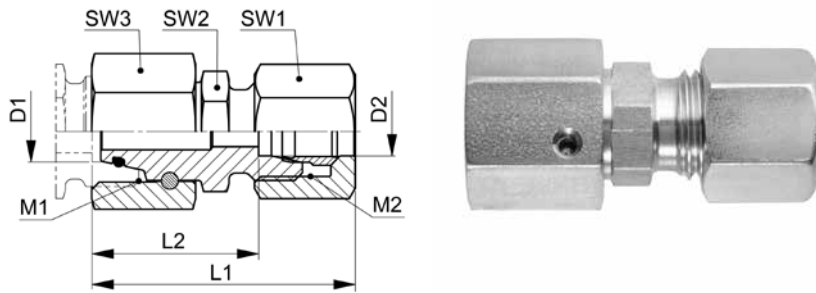

20

**GRKO-..L**

Type-D1 /D2	Mat.-Nr.	PN	M1	M2	L1	L2	SW1	SW2	SW3	g/Stk
GRKO-08/06L	708.1870.140.20	500	14x1.5	12x1.5	38.5	23.5	14	12	17	42
GRKO-10/06L	708.1870.175.20	500	16x1.5	12x1.5	40.0	25.0	14	14	19	54
GRKO-10/08L	708.1870.190.20	500	16x1.5	14x1.5	40.0	25.0	17	14	19	56
GRKO-12/06L	708.1870.215.20	400	18x1.5	12x1.5	40.0	25.0	14	17	22	68
GRKO-12/08L	708.1870.225.20	400	18x1.5	14x1.5	40.0	25.0	17	17	22	72
GRKO-12/10L	708.1870.240.20	400	18x1.5	16x1.5	41.0	26.0	19	17	22	74
GRKO-15/06L	708.1870.391.20	400	22x1.5	12x1.5	43.5	28.5	14	22	27	100
GRKO-15/08L	708.1870.400.20	400	22x1.5	14x1.5	43.5	28.5	17	22	27	118
GRKO-15/10L	708.1870.410.20	400	22x1.5	16x1.5	44.0	29.0	19	22	27	118
GRKO-15/12L	708.1870.420.20	400	22x1.5	18x1.5	44.0	29.0	22	22	27	122
GRKO-18/06L	708.1870.563.20	400	26x1.5	12x1.5	43.0	28.0	14	24	32	122
GRKO-18/08L	708.1870.570.20	400	26x1.5	14x1.5	43.0	28.0	17	24	32	132
GRKO-18/10L	708.1870.575.20	400	26x1.5	16x1.5	44.0	29.0	19	24	32	150
GRKO-18/12L	708.1870.580.20	400	26x1.5	18x1.5	44.0	29.0	22	24	32	152
GRKO-18/15L	708.1870.610.20	400	26x1.5	22x1.5	45.0	30.0	27	24	32	170
GRKO-22/06L	708.1870.723.20	250	30x2.0	12x1.5	47.0	32.0	14	27	36	178
GRKO-22/08L	708.1870.724.20	250	30x2.0	14x1.5	47.0	32.0	17	27	36	180
GRKO-22/10L	708.1870.725.20	250	30x2.0	16x1.5	48.0	33.0	19	27	36	186
GRKO-22/12L	708.1870.730.20	250	30x2.0	18x1.5	48.0	33.0	22	27	36	194
GRKO-22/15L	708.1870.745.20	250	30x2.0	22x1.5	49.0	34.0	27	27	36	236
GRKO-22/18L	708.1870.755.20	250	30x2.0	26x1.5	50.0	33.5	32	27	36	250
GRKO-28/06L	708.1870.828.20	250	36x2.0	12x1.5	49.0	34.0	14	36	41	322
GRKO-28/08L	708.1870.829.20	250	36x2.0	14x1.5	49.0	34.0	17	36	41	315
GRKO-28/10L	708.1870.830.20	250	36x2.0	16x1.5	50.0	35.0	19	36	41	320
GRKO-28/12L	708.1870.835.20	250	36x2.0	18x1.5	50.0	35.0	22	36	41	328
GRKO-28/15L	708.1870.865.20	250	36x2.0	22x1.5	51.0	36.0	27	36	41	350
GRKO-28/18L	708.1870.870.20	250	36x2.0	26x1.5	52.0	35.5	32	36	41	317
GRKO-28/22L	708.1870.900.20	250	36x2.0	30x2.0	54.0	37.5	36	36	41	420

Fortsetzung auf nächster rechter Seite

To be continued on next right page

续下页右

### Reduzierstutzen mit Dichtkegel und O-Ring

dichtkegelseitig vormontiert

### Reducing connectors with taper and O-ring

pre-assembled on tapered nipple side

### 直通变径接头体 (带24度旋转螺母及O型圈)

24°旋转螺母已预装

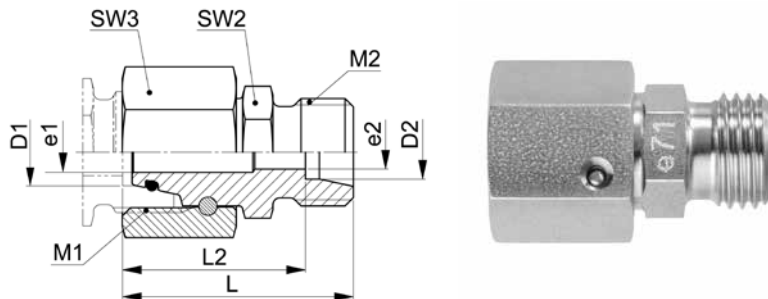

## XGRKO-..L M

Type-D1 /D2	Mat.-Nr.	PN	M1	M2	L	L2	SW2	SW3	e1	e2	g/Stk
XGRKO-35/06L M	707.1871.951.20	250	45x2.0	12x1.5	44.0	37.0	46	50	28.0	4.0	349
XGRKO-35/08L M	707.1871.952.20	250	45x2.0	14x1.5	44.0	37.0	46	50	28.0	6.0	352
XGRKO-35/10L M	707.1871.953.20	250	45x2.0	16x1.5	45.0	38.0	46	50	28.0	8.0	355
XGRKO-35/12L M	707.1871.954.20	250	45x2.0	18x1.5	45.0	38.0	46	50	28.0	10.0	350
XGRKO-35/15L M	707.1871.946.20	250	45x2.0	22x1.5	46.0	39.0	46	50	28.0	12.0	358
XGRKO-35/18L M	707.1871.947.20	250	45x2.0	26x1.5	46.0	38.5	46	50	28.0	15.0	364
XGRKO-35/22L M	707.1871.948.20	250	45x2.0	30x2.0	48.0	40.5	46	50	28.0	19.0	362
XGRKO-35/28L M	707.1871.949.20	250	45x2.0	36x2.0	48.0	40.5	46	50	28.0	24.0	394
XGRKO-42/06L M	707.1871.986.20	250	52x2.0	12x1.5	47.5	40.5	50	60	34.0	4.0	536
XGRKO-42/08L M	707.1871.987.20	250	52x2.0	14x1.5	47.5	40.5	50	60	34.0	6.0	542
XGRKO-42/10L M	707.1871.988.20	250	52x2.0	16x1.5	48.5	41.5	50	60	34.0	8.0	548
XGRKO-42/12L M	707.1871.989.20	250	52x2.0	18x1.5	48.5	41.5	50	60	34.0	10.0	552
XGRKO-42/15L M	707.1871.991.20	250	52x2.0	22x1.5	49.5	42.5	50	60	34.0	12.0	554
XGRKO-42/18L M	707.1871.992.20	250	52x2.0	26x1.5	49.5	42.0	50	60	34.0	15.0	560
XGRKO-42/22L M	707.1871.993.20	250	52x2.0	30x2.0	51.5	44.0	50	60	34.0	19.0	528
XGRKO-42/28L M	707.1871.994.20	250	52x2.0	36x2.0	51.5	44.0	50	60	34.0	24.0	528
XGRKO-42/35L M	707.1871.996.20	250	52x2.0	45x2.0	53.5	43.0	50	60	34.0	30.0	592

Dichtungsmaterial: FKM (andere Werkstoffe auf Anfrage)

Sealing material: FKM (other materials on request)

密封材料: FKM (其他材料可咨询)

ISO 8434-1-RDSW

D1/D2=Rohr außen-Ø  
M1/M2=metrische Anschlussgewinde  
e1/e2=kleinste Innen-Ø

D1/D2=tube outside diameters  
M1/M2=metric connecting threads  
e1/e2=minimum inside diameters

D1/D2=管外径  
M1/M2=公制连接管螺纹  
e1/e2=最小内径

**Reduzierschraubungen mit Dichtkegel und O-Ring**

**Reducing fittings with taper and O-ring**

**直通变径接头总成 (带24度旋转螺母及O型圈)**

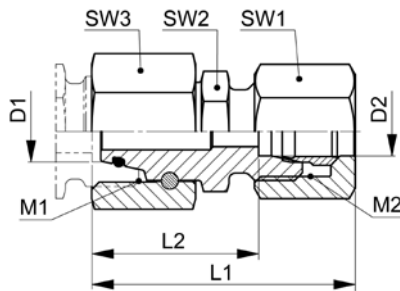

20

**GRKO-..L**

Type-D1 /D2	Mat.-Nr.	PN	M1	M2	L1	L2	SW1	SW2	SW3	g/Stk
GRKO-35/06L	708.1870.951.20	250	45x2.0	12x1.5	52.0	37.0	14	46	50	372
GRKO-35/08L	708.1870.952.20	250	45x2.0	14x1.5	52.0	37.0	17	46	50	388
GRKO-35/10L	708.1870.953.20	250	45x2.0	16x1.5	53.0	38.0	19	46	50	362
GRKO-35/12L	708.1870.954.20	250	45x2.0	18x1.5	53.0	38.0	22	46	50	378
GRKO-35/15L	708.1870.946.20	250	45x2.0	22x1.5	54.0	39.0	27	46	50	404
GRKO-35/18L	708.1870.947.20	250	45x2.0	26x1.5	55.0	38.5	32	46	50	432
GRKO-35/22L	708.1870.948.20	250	45x2.0	30x2.0	57.0	40.5	36	46	50	454
GRKO-35/28L	708.1870.949.20	250	45x2.0	36x2.0	57.0	40.5	41	46	50	504
GRKO-42/06L	708.1870.986.20	250	52x2.0	12x1.5	55.5	40.5	14	50	60	552
GRKO-42/08L	708.1870.987.20	250	52x2.0	14x1.5	55.5	40.5	17	50	60	558
GRKO-42/10L	708.1870.988.20	250	52x2.0	16x1.5	56.5	41.5	19	50	60	570
GRKO-42/12L	708.1870.989.20	250	52x2.0	18x1.5	56.5	41.5	22	50	60	582
GRKO-42/15L	708.1870.991.20	250	52x2.0	22x1.5	57.5	42.5	27	50	60	600
GRKO-42/18L	708.1870.992.20	250	52x2.0	26x1.5	58.5	42.0	32	50	60	628
GRKO-42/22L	708.1870.993.20	250	52x2.0	30x2.0	60.5	44.0	36	50	60	618
GRKO-42/28L	708.1870.994.20	250	52x2.0	36x2.0	60.5	44.0	41	50	60	636
GRKO-42/35L	708.1870.996.20	250	52x2.0	45x2.0	64.5	43.0	50	50	60	756

Baumaße sind Ungefährmaße bei angezogener Überwurfmutter.

Sizes are approximate dimensions at tightened nut.

尺寸为上紧螺母处的概略大小。

Dichtungsmaterial: FKM (andere Werkstoffe auf Anfrage)

Sealing material: FKM (other materials on request)

密封材料: FKM (其他材料可咨询)

**ISO 8434-1-RDSWC**

## Reduzierstutzen mit Dichtkegel und O-Ring

dichtkegelseitig vormontiert

## Reducing connectors with taper and O-ring

pre-assembled on tapered nipple side

## 直通变径接头体 (带24度旋转螺母及O型圈)

24°旋转螺母已预装

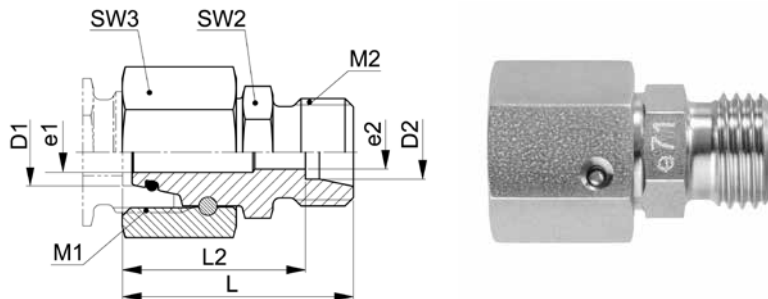

### XGRKO-..S M

Type-D1 /D2	Mat.-Nr.	PN	M1	M2	L	L2	SW2	SW3	e1	e2	g/Stk
XGRKO-08/06S M	707.1871.140.30	800	16x1.5	14x1.5	34.0	27.0	14	19	4.0	4.0	46
XGRKO-10/06S M	707.1871.175.30	800	18x1.5	14x1.5	34.5	27.5	17	22	6.0	4.0	60
XGRKO-10/08S M	707.1871.190.30	800	18x1.5	16x1.5	34.5	27.5	17	22	6.0	5.0	62
XGRKO-12/06S M	707.1871.215.30	630	20x1.5	14x1.5	37.0	30.0	19	24	8.0	4.0	79
XGRKO-12/08S M	707.1871.225.30	630	20x1.5	16x1.5	37.0	30.0	19	24	8.0	5.0	80
XGRKO-12/10S M	707.1871.240.30	630	20x1.5	18x1.5	37.0	29.5	19	24	8.0	7.0	78
XGRKO-14/06S M	707.1871.296.30	630	22x1.5	14x1.5	38.5	31.5	22	27	9.0	4.0	114
XGRKO-14/08S M	707.1871.300.30	630	22x1.5	16x1.5	38.5	31.5	22	27	9.0	5.0	114
XGRKO-14/10S M	707.1871.320.30	630	22x1.5	18x1.5	38.5	31.0	22	27	9.0	7.0	110
XGRKO-14/12S M	707.1871.340.30	630	22x1.5	20x1.5	38.5	31.0	22	27	9.0	8.0	112
XGRKO-16/06S M	707.1871.466.30	420	24x1.5	14x1.5	39.0	32.0	22	30	11.0	4.0	110
XGRKO-16/08S M	707.1871.468.30	420	24x1.5	16x1.5	39.0	32.0	22	30	11.0	5.0	112
XGRKO-16/10S M	707.1871.470.30	420	24x1.5	18x1.5	39.0	31.5	22	30	11.0	7.0	121
XGRKO-16/12S M	707.1871.480.30	420	24x1.5	20x1.5	39.0	31.5	22	30	11.0	8.0	124
XGRKO-16/14S M	707.1871.500.30	420	24x1.5	22x1.5	41.0	33.0	22	30	11.0	10.0	128
XGRKO-20/06S M	707.1871.650.30	420	30x2.0	14x1.5	43.0	36.0	27	36	14.0	4.0	188
XGRKO-20/08S M	707.1871.655.30	420	30x2.0	16x1.5	43.0	36.0	27	36	14.0	5.0	176
XGRKO-20/10S M	707.1871.660.30	420	30x2.0	18x1.5	43.0	35.5	27	36	14.0	7.0	178
XGRKO-20/12S M	707.1871.665.30	420	30x2.0	20x1.5	43.0	35.5	27	36	14.0	8.0	200
XGRKO-20/14S M	707.1871.675.30	420	30x2.0	22x1.5	45.0	37.0	27	36	14.0	10.0	202
XGRKO-20/16S M	707.1871.685.30	420	30x2.0	24x1.5	45.0	36.5	27	36	14.0	12.0	294
XGRKO-25/06S M	707.1871.788.30	420	36x2.0	14x1.5	45.5	38.5	36	46	18.0	4.0	338
XGRKO-25/08S M	707.1871.787.30	420	36x2.0	16x1.5	45.5	38.5	36	46	18.0	5.0	340
XGRKO-25/10S M	707.1871.789.30	420	36x2.0	18x1.5	45.5	38.0	36	46	18.0	7.0	318
XGRKO-25/12S M	707.1871.791.30	420	36x2.0	20x1.5	45.5	38.0	36	46	18.0	10.0	320
XGRKO-25/14S M	707.1871.790.30	420	36x2.0	22x1.5	47.5	39.5	36	46	18.0	8.0	322
XGRKO-25/16S M	707.1871.800.30	420	36x2.0	24x1.5	47.5	39.0	36	46	18.0	12.0	324
XGRKO-25/20S M	707.1871.820.30	420	36x2.0	30x2.0	49.5	39.0	36	46	18.0	16.0	346

Fortsetzung auf nächster linker Seite

To be continued on next left page

续下页左

D1/D2=Rohr außen-Ø  
M1/M2=metrische Anschlussgewinde  
e1/e2=kleinste Innen-Ø

D1/D2=tube outside diameters  
M1/M2=metric connecting threads  
e1/e2=minimum inside diameters

D1/D2=管外径  
M1/M2=公制连接管螺纹  
e1/e2=最小内径

**Reduzierschraubungen mit Dichtkegel und O-Ring**

**Reducing fittings with taper and O-ring**

直通变径接头总成 (带24度旋转螺母及O型圈)

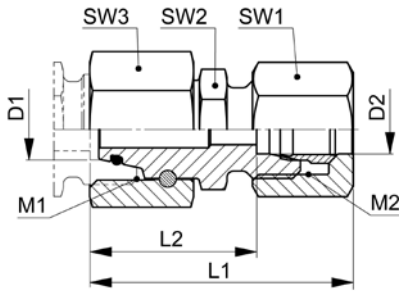

20

**GRKO-..S**

Type-D1 /D2	Mat.-Nr.	PN	M1	M2	L1	L2	SW1	SW2	SW3	g/Stk
GRKO-08/06S	708.1870.140.30	800	16x1.5	14x1.5	42.0	27.0	17	14	19	64
GRKO-10/06S	708.1870.175.30	800	18x1.5	14x1.5	43.5	27.5	17	17	22	78
GRKO-10/08S	708.1870.190.30	800	18x1.5	16x1.5	42.5	27.5	19	17	22	82
GRKO-12/06S	708.1870.215.30	630	20x1.5	14x1.5	45.0	30.0	17	19	24	98
GRKO-12/08S	708.1870.225.30	630	20x1.5	16x1.5	45.0	30.0	19	19	24	100
GRKO-12/10S	708.1870.240.30	630	20x1.5	18x1.5	46.0	29.5	22	19	24	112
GRKO-14/06S	708.1870.296.30	630	22x1.5	14x1.5	46.5	31.5	17	22	27	132
GRKO-14/08S	708.1870.300.30	630	22x1.5	16x1.5	46.5	31.5	19	22	27	136
GRKO-14/10S	708.1870.320.30	630	22x1.5	18x1.5	47.5	31.0	22	22	27	146
GRKO-14/12S	708.1870.340.30	630	22x1.5	20x1.5	47.5	31.0	24	22	27	148
GRKO-16/06S	708.1870.466.30	420	24x1.5	14x1.5	47.0	32.0	17	22	30	128
GRKO-16/08S	708.1870.468.30	420	24x1.5	16x1.5	47.0	32.0	19	22	30	134
GRKO-16/10S	708.1870.470.30	420	24x1.5	18x1.5	48.0	31.5	22	22	30	156
GRKO-16/12S	708.1870.480.30	420	24x1.5	20x1.5	48.0	31.5	24	22	30	160
GRKO-16/14S	708.1870.500.30	420	24x1.5	22x1.5	51.0	33.0	27	22	30	184
GRKO-20/06S	708.1870.650.30	420	30x2.0	14x1.5	51.0	36.0	17	27	36	206
GRKO-20/08S	708.1870.655.30	420	30x2.0	16x1.5	51.0	36.0	19	27	36	198
GRKO-20/10S	708.1870.660.30	420	30x2.0	18x1.5	52.0	35.5	22	27	36	210
GRKO-20/12S	708.1870.665.30	420	30x2.0	20x1.5	52.0	35.5	24	27	36	238
GRKO-20/14S	708.1870.675.30	420	30x2.0	22x1.5	55.0	37.0	27	27	36	258
GRKO-20/16S	708.1870.685.30	420	30x2.0	24x1.5	55.0	36.5	30	27	36	264
GRKO-25/06S	708.1870.788.30	420	36x2.0	14x1.5	53.5	38.5	17	36	46	356
GRKO-25/08S	708.1870.787.30	420	36x2.0	16x1.5	53.5	38.5	19	36	46	362
GRKO-25/10S	708.1870.789.30	420	36x2.0	18x1.5	54.5	38.0	22	36	46	352
GRKO-25/12S	708.1870.791.30	420	36x2.0	20x1.5	54.5	38.0	24	36	46	356
GRKO-25/14S	708.1870.790.30	420	36x2.0	22x1.5	57.5	39.5	27	36	46	374
GRKO-25/16S	708.1870.800.30	420	36x2.0	24x1.5	57.5	39.0	30	36	46	394
GRKO-25/20S	708.1870.820.30	420	36x2.0	30x2.0	60.5	39.0	36	36	46	458

Fortsetzung auf nächster rechter Seite

To be continued on next right page

续下页右

D1/D2=Rohr außen-Ø  
M1/M2=metrische Anschlussgewinde

D1/D2=tube outside diameters  
M1/M2=metric connecting threads

D1/D2=管外径  
M1/M2=公制连接管螺纹

### Reduzierstutzen mit Dichtkegel und O-Ring

dichtkegelseitig vormontiert

### Reducing connectors with taper and O-ring

pre-assembled on tapered nipple side

### 直通变径接头体 (带24度旋转螺母及O型圈)

24°旋转螺母已预装

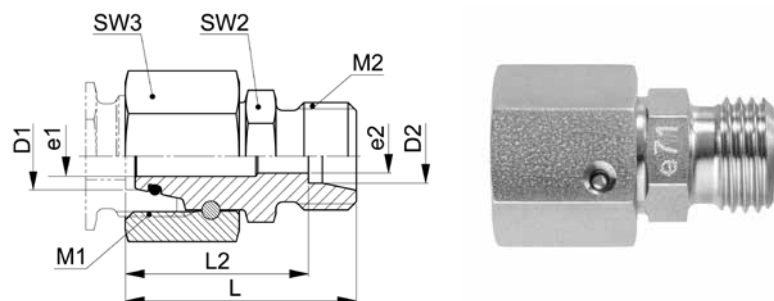

## XGRKO-..S M

Type-D1 /D2	Mat.-Nr.	PN	M1	M2	L	L2	SW2	SW3	e1	e2	g/Stk
XGRKO-30/06S M	707.1871.937.30	320	42x2.0	14x1.5	51.0	44.0	41	50	23.0	5.0	378
XGRKO-30/08S M	707.1871.936.30	320	42x2.0	16x1.5	51.0	44.0	41	50	23.0	4.0	384
XGRKO-30/10S M	707.1871.939.30	320	42x2.0	18x1.5	51.0	43.5	41	50	23.0	7.0	390
XGRKO-30/12S M	707.1871.940.30	320	42x2.0	20x1.5	51.0	43.5	41	50	23.0	8.0	396
XGRKO-30/14S M	707.1871.941.30	320	42x2.0	22x1.5	53.0	45.0	41	50	23.0	10.0	424
XGRKO-30/16S M	707.1871.942.30	320	42x2.0	24x1.5	53.0	44.5	41	50	23.0	12.0	398
XGRKO-30/20S M	707.1871.943.30	320	42x2.0	30x2.0	55.0	44.5	41	50	23.0	16.0	418
XGRKO-30/25S M	707.1871.945.30	320	42x2.0	36x2.0	57.0	45.0	41	50	23.0	20.0	446
XGRKO-38/06S M	707.1871.965.30	320	52x2.0	14x1.5	54.5	47.5	50	60	30.0	4.0	550
XGRKO-38/08S M	707.1871.966.30	320	52x2.0	16x1.5	54.5	47.5	50	60	30.0	5.0	552
XGRKO-38/10S M	707.1871.967.30	320	52x2.0	18x1.5	54.5	47.0	50	60	30.0	7.0	555
XGRKO-38/12S M	707.1871.968.30	320	52x2.0	20x1.5	54.5	47.0	50	60	30.0	8.0	556
XGRKO-38/14S M	707.1871.969.30	320	52x2.0	22x1.5	56.5	48.5	50	60	30.0	10.0	600
XGRKO-38/16S M	707.1871.970.30	320	52x2.0	24x1.5	56.5	48.0	50	60	30.0	12.0	602
XGRKO-38/20S M	707.1871.971.30	320	52x2.0	30x2.0	58.5	48.0	50	60	30.0	16.0	570
XGRKO-38/25S M	707.1871.972.30	320	52x2.0	36x2.0	60.5	48.5	50	60	30.0	20.0	592
XGRKO-38/30S M	707.1871.975.30	320	52x2.0	42x2.0	62.5	49.0	50	60	30.0	25.0	662

Dichtungsmaterial: FKM (andere Werkstoffe auf Anfrage)

Sealing material: FKM (other materials on request)

密封材料: FKM (其他材料可咨询)

ISO 8434-1-RDSW

D1/D2=Rohr außen-Ø  
M1/M2=metrische Anschlussgewinde  
e1/e2=kleinste Innen-Ø

D1/D2=tube outside diameters  
M1/M2=metric connecting threads  
e1/e2=minimum inside diameters

D1/D2=管外径  
M1/M2=公制连接管螺纹  
e1/e2=最小内径

**Reduzierschraubungen mit Dichtkegel und O-Ring**

**Reducing fittings with taper and O-ring**

**直通变径接头总成 (带24度旋转螺母及O型圈)**

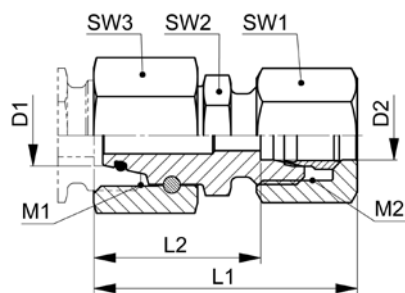

20

**GRKO-..S**

Type-D1 /D2	Mat.-Nr.	PN	M1	M2	L1	L2	SW1	SW2	SW3	g/Stk
GRKO-30/06S	708.1870.937.30	320	42x2.0	14x1.5	59.0	44.0	17	41	50	412
GRKO-30/08S	708.1870.936.30	320	42x2.0	16x1.5	59.0	44.0	19	41	50	416
GRKO-30/10S	708.1870.939.30	320	42x2.0	18x1.5	60.0	43.5	22	41	50	424
GRKO-30/12S	708.1870.940.30	320	42x2.0	20x1.5	60.0	43.5	24	41	50	432
GRKO-30/14S	708.1870.941.30	320	42x2.0	22x1.5	63.0	45.0	27	41	50	480
GRKO-30/16S	708.1870.942.30	320	42x2.0	24x1.5	63.0	44.5	30	41	50	468
GRKO-30/20S	708.1870.943.30	320	42x2.0	30x2.0	66.0	44.5	36	41	50	528
GRKO-30/25S	708.1870.945.30	320	42x2.0	36x2.0	69.0	45.0	46	41	50	672
GRKO-38/06S	708.1870.965.30	320	52x2.0	14x1.5	62.0	47.5	17	50	60	574
GRKO-38/08S	708.1870.966.30	320	52x2.0	16x1.5	62.0	47.5	19	50	60	578
GRKO-38/10S	708.1870.967.30	320	52x2.0	18x1.5	63.0	47.0	22	50	60	632
GRKO-38/12S	708.1870.968.30	320	52x2.0	20x1.5	63.0	47.0	24	50	60	638
GRKO-38/14S	708.1870.969.30	320	52x2.0	22x1.5	66.0	48.5	27	50	60	652
GRKO-38/16S	708.1870.970.30	320	52x2.0	24x1.5	66.0	48.0	30	50	60	672
GRKO-38/20S	708.1870.971.30	320	52x2.0	30x2.0	69.0	48.0	36	50	60	682
GRKO-38/25S	708.1870.972.30	320	52x2.0	36x2.0	72.0	48.5	46	50	60	818
GRKO-38/30S	708.1870.975.30	320	52x2.0	42x2.0	75.0	49.0	50	50	60	914

Baumaße sind Ungefährmaße bei angezogener Überwurfmutter.

Sizes are approximate dimensions at tightened nut.

尺寸为上紧螺母处的概略大小。

Dichtungsmaterial: FKM (andere Werkstoffe auf Anfrage)

Sealing material: FKM (other materials on request)

密封材料: FKM (其他材料可咨询)

**ISO 8434-1-RDSWC**

**Gerade Verschraubungen mit Dichtkegel und O-Ring**

**Straight fittings with taper and O-ring**

直通接头总成 (带24度锥旋转螺母及O型圈)

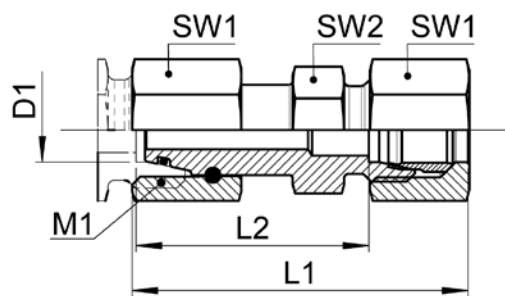

**NC-GKO-..L**

Type-D1	Mat.-Nr.	PN	M1	L1	L2	SW1	SW2	g/Stk
NC-GKO-06L	718.1050.060.20	250	12x1.5	52.5	36.0	14	12	44
NC-GKO-08L	718.1050.080.20	250	14x1.5	52.5	36.0	17	14	62
NC-GKO-10L	718.1050.100.20	250	16x1.5	53.0	36.0	19	17	79
NC-GKO-12L	718.1050.120.20	250	18x1.5	53.0	36.0	22	19	98
NC-GKO-15L	718.1050.150.20	250	22x1.5	53.0	36.0	27	24	170
NC-GKO-18L	718.1050.180.20	160	26x1.5	53.5	36.0	32	27	224
NC-GKO-22L	718.1050.220.20	160	30x2.0	59.5	40.0	36	32	317

Baumaße sind Ungefährmaße bei angezogener Überwurfmutter.

Sizes are approximate dimensions at tightened nut.

尺寸为上紧螺母处的概略大小。

Dichtungsmaterial: FKM (andere Werkstoffe auf Anfrage)

Sealing material: FKM (other materials on request)

密封材料: FKM (其他材料可咨询)



**Einstellbare Winkelverschraubungen 45° mit Dichtkegel und O-Ring**

**Adjustable elbow fittings 45° with taper and O-ring**

可调式45度弯头总成 (带锥体及O型圈)

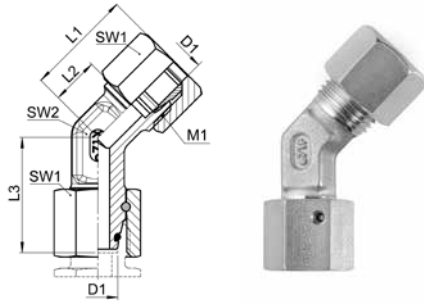

20

**NC-EWKO-..L 45°**

Type -D1	Mat.-Nr.	PN	M1	L1	L2	L3	SW1	SW2	g/Stk
NC-EWKO-06L 45°	718.2660.060.20	250	12x1.5	24.5	9.0	26.0	14	12	63
NC-EWKO-08L 45°	718.2660.080.20	250	14x1.5	28.0	12.0	27.5	17	12	63
NC-EWKO-10L 45°	718.2660.100.20	500	16x1.5	29.5	12.0	29.0	19	14	82
NC-EWKO-12L 45°	718.2660.120.20	250	18x1.5	31.0	14.0	29.5	22	17	112
NC-EWKO-15L 45°	718.2660.150.20	250	22x1.5	35.5	17.0	32.5	27	19	181
NC-EWKO-18L 45°	718.2660.180.20	160	26x1.5	34.0	16.5	32.5	32	24	253
NC-EWKO-22L 45°	718.2660.220.20	160	30x2.0	39.5	18.5	38.5	36	27	340

Baumaße sind Ungefährmaße bei angezogener Überwurfmutter.

Sizes are approximate dimensions at tightened nut.

尺寸为上紧螺母处的概略大小。

Dichtungsmaterial: FKM (andere Werkstoffe auf Anfrage)

Sealing material: FKM (other materials on request)

密封材料: FKM (其他材料可咨询)

D1=Rohr außen-Ø  
M1=metrisches Anschlussgewinde

D1=tube outside diameter  
M1=metric connecting thread

D1 = 管外径  
M1=公制连接管螺纹

**Einstellbare Winkelverschraubungen mit Dichtkegel und O-Ring**  
**Adjustable elbow fittings with taper and O-ring**  
 可调式直角组合接头总成 (带24度锥旋转螺母及O型圈)

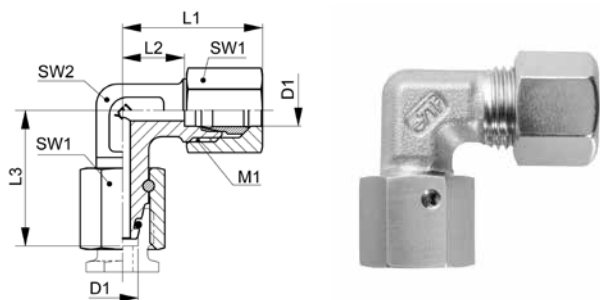

**NC-EWKO-..L/S**

Type -D1	Mat.-Nr.	PN	M1	L1	L2	L3	SW1	SW2	g/Stk
NC-EWKO-06L	718.2670.060.20	250	12x1.5	28.0	12.0	26.0	14	12	43
NC-EWKO-08L	718.2670.080.20	250	14x1.5	30.0	14.0	27.5	17	12	59
NC-EWKO-10L	718.2670.100.20	250	16x1.5	32.5	15.0	29.0	19	14	80
NC-EWKO-12L	718.2670.120.20	250	18x1.5	33.5	17.0	29.5	22	17	105
NC-EWKO-15L	718.2670.150.20	250	22x1.5	38.0	21.0	32.5	27	19	175
NC-EWKO-18L	718.2670.180.20	160	26x1.5	40.5	23.5	35.5	32	24	248
NC-EWKO-22L	718.2670.220.20	160	30x2.0	47.0	27.5	38.5	36	27	344
NC-EWKO-06S	718.2670.060.30	500	14x1.5	32.0	16.0	27.0	17	12	64
NC-EWKO-08S	718.2670.080.30	500	16x1.5	33.0	17.0	27.5	19	14	86
NC-EWKO-10S	718.2670.100.30	400	18x1.5	36.0	17.5	30.0	22	17	120
NC-EWKO-12S	718.2670.120.30	400	20x1.5	40.5	21.5	31.0	24	17	143
NC-EWKO-14S	718.2670.140.30	300	22x1.5	42.5	22.0	35.0	27	19	188
NC-EWKO-16S	718.2670.160.30	200	24x1.5	46.0	24.5	36.5	30	24	265
NC-EWKO-20S	718.2670.200.30	200	30x2.0	51.5	26.5	44.5	36	27	412
NC-EWKO-25S	718.2670.250.30	100	36x2.0	57.0	30.0	50.0	46	36	763

Baumaße sind Ungefährmaße bei angezogener Überwurfmutter.

Sizes are approximate dimensions at tightened nut.

尺寸为上紧螺母处的概略大小。

Dichtungsmaterial: FKM (andere Werkstoffe auf Anfrage)

Sealing material: FKM (other materials on request)

密封材料: FKM (其他材料可咨询)

## Einstellbare Winkel-Einschraubverschraubungen mit Dichtkegel und O-Ring

mit Einschraubstutzen, Abdichtung durch Dichtkante Form B nach ISO 1179-4

## Adjustable male adaptor elbow fittings with taper and O-ring

with male adaptor connector, sealing edge form B acc. ISO 1179-4

## 英制外螺纹可调式直角组合接头 (带24度锥旋转螺母及O型圈)

带螺柱适配器, 带符合ISO1179-4标准的金属面密封

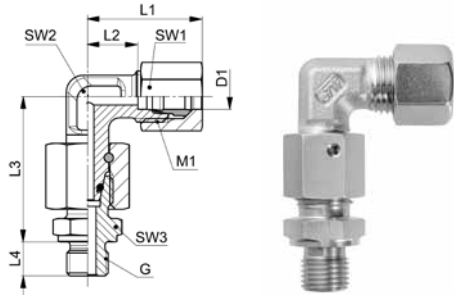

20

### NC-EWKO-..LR/SR

Type-D1 G	Mat.-Nr.	PN	G	M1	L1	L2	L3	L4	SW1	SW2	SW3	g/Stk
G=Rohrgewinde (zylindrisch)		G=BSP thread (parallel)			G=英制平行管螺纹标准							
NC-EWKO-06LR 1.8	718.2671.100.20	250	1/8	12x1.5	28.0	12.0	34.5	8.0	14	12	14	57
NC-EWKO-08LR 1.4	718.2671.170.20	250	1/4	14x1.5	30.0	14.0	37.0	12.0	17	12	19	87
NC-EWKO-10LR 1.4	718.2671.270.20	250	1/4	16x1.5	32.5	15.0	39.5	12.0	19	14	19	109
NC-EWKO-12LR 1.4	718.2671.380.20	250	1/4	18x1.5	33.5	17.0	41.5	12.0	22	17	19	137
NC-EWKO-12LR 3.8	718.2671.390.20	250	3/8	18x1.5	33.5	17.0	42.0	12.0	22	17	22	147
NC-EWKO-12LR 1.2	718.2671.400.20	250	1/2	18x1.5	33.5	17.0	42.5	14.0	22	17	27	175
NC-EWKO-15LR 1.2	718.2671.534.20	250	1/2	22x1.5	38.0	21.0	46.5	14.0	27	19	27	248
NC-EWKO-18LR 1.2	718.2671.646.20	160	1/2	26x1.5	40.5	23.5	50.0	14.0	32	24	27	320
NC-EWKO-22LR 3.4	718.2671.768.20	160	3/4	30x2.0	47.0	27.5	55.0	16.0	36	27	32	450
NC-EWKO-06SR 1.4	718.2671.110.30	500	1/4	14x1.5	32.0	16.0	40.0	12.0	17	12	19	98
NC-EWKO-08SR 1.4	718.2671.170.30	500	1/4	16x1.5	33.0	17.0	42.0	12.0	19	14	19	128
NC-EWKO-10SR 3.8	718.2671.280.30	400	3/8	18x1.5	36.0	17.5	45.0	12.0	22	17	22	178
NC-EWKO-12SR 3.8	718.2671.390.30	400	3/8	20x1.5	40.5	21.5	48.0	12.0	24	17	22	207
NC-EWKO-12SR 1.2	718.2671.400.30	400	1/2	20x1.5	40.5	21.5	48.5	14.0	24	17	27	242
NC-EWKO-14SR 1.2	718.2671.504.30	300	1/2	22x1.5	42.5	22.0	54.0	14.0	27	19	27	287
NC-EWKO-16SR 1.2	718.2671.566.30	200	1/2	24x1.5	46.0	24.5	55.0	14.0	30	24	27	359
NC-EWKO-20SR 3.4	718.2671.704.30	200	3/4	30x2.0	51.5	26.5	65.0	14.0	36	27	32	567
NC-EWKO-25SR 1.1	718.2671.810.30	100	1	36x2.0	57.0	30.0	73.0	18.0	46	36	41	1036

Baumaße sind Ungefährmaße bei angezogener Überwurfmutter.

Sizes are approximate dimensions at tightened nut.

尺寸为上紧螺母处的概略大小。

Dichtungsmaterial: FKM (andere Werkstoffe auf Anfrage)

Sealing material: FKM (other materials on request)

密封材料: FKM (其他材料可咨询)

D1=Rohr außen-Ø  
M1=metrisches Anschlussgewinde

D1=tube outside diameter  
M1=metric connecting thread

D1 = 管外径  
M1=公制连接管螺纹

## Einstellbare Winkel-Einschraubverschraubungen mit Dichtkegel und O-Ring

mit Einschraubstutzen, Abdichtung durch Profildichtring Form E nach ISO 1179-2

## Adjustable male adaptor elbow fittings with taper and O-ring

with male adaptor connector, profile sealing ring form E acc. ISO 1179-2

## 英制外螺纹可调式直角组合接头 (带24度锥旋转螺母及O型圈)

带螺柱适配器, 带符合ISO1179-2标准的ED圈密封

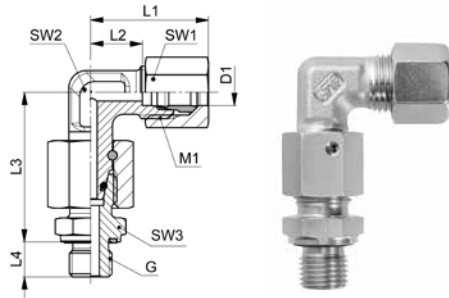

### NC-EWKO-..LR WD/SR WD

Type-D1 G	Mat.-Nr.	PN	G	M1	L1	L2	L3	L4	SW1	SW2	SW3	g/Stk
G=Rohrgewinde (zylindrisch)		G=BSP thread (parallel)			G=英制平行管螺纹标准							
NC-EWKO-06LR 1.8 WD	718.2672.100.20	250	1/8	12x1.5	28.0	12.0	34.0	8.0	14	12	14	57
NC-EWKO-08LR 1.4 WD	718.2672.170.20	250	1/4	14x1.5	30.0	14.0	37.0	12.0	17	12	19	86
NC-EWKO-10LR 1.4 WD	718.2672.270.20	250	1/4	16x1.5	32.5	15.0	40.0	12.0	19	14	19	108
NC-EWKO-12LR 1.4 WD	718.2672.380.20	250	1/4	18x1.5	33.5	17.0	41.5	12.0	22	17	19	134
NC-EWKO-12LR 3.8 WD	718.2672.390.20	250	3/8	18x1.5	33.5	17.0	42.0	12.0	22	17	22	147
NC-EWKO-12LR 1.2 WD	718.2672.400.20	250	1/2	18x1.5	33.5	17.0	42.5	14.0	22	17	27	175
NC-EWKO-15LR 1.2 WD	718.2672.534.20	250	1/2	22x1.5	38.0	21.0	43.5	14.0	27	19	27	248
NC-EWKO-18LR 1.2 WD	718.2672.646.20	160	1/2	26x1.5	40.5	23.5	50.0	14.0	32	24	27	320
NC-EWKO-22LR 3.4 WD	718.2672.768.20	160	3/4	30x2.0	47.0	27.5	55.0	16.0	36	27	32	448
NC-EWKO-06SR 1.4 WD	718.2672.110.30	500	1/4	14x1.5	32.0	16.0	39.0	12.0	17	12	19	100
NC-EWKO-08SR 1.4 WD	718.2672.170.30	500	1/4	16x1.5	33.0	17.0	41.5	12.0	19	14	19	127
NC-EWKO-10SR 3.8 WD	718.2672.280.30	400	3/8	18x1.5	36.0	17.5	45.0	12.0	22	17	22	176
NC-EWKO-12SR 3.8 WD	718.2672.390.30	400	3/8	20x1.5	40.5	21.5	48.0	12.0	24	17	22	207
NC-EWKO-12SR 1.2 WD	718.2672.400.30	400	1/2	20x1.5	40.5	21.5	48.5	14.0	24	17	27	241
NC-EWKO-14SR 1.2 WD	718.2672.504.30	300	1/2	22x1.5	42.5	22.0	54.0	14.0	27	19	27	287
NC-EWKO-16SR 1.2 WD	718.2672.566.30	200	1/2	24x1.5	46.0	24.5	55.0	14.0	30	24	27	359
NC-EWKO-20SR 3.4 WD	718.2672.704.30	200	3/4	30x2.0	51.5	26.5	65.0	18.0	36	27	32	564
NC-EWKO-25SR 1.1 WD	718.2672.810.30	100	1	36x2.0	57.0	30.0	72.5	18.0	46	36	41	1033

Baumaße sind Ungefährmaße bei angezogener Überwurfmutter.

Sizes are approximate dimensiones at tightened nut.

尺寸为上紧螺母处的概略大小。

Dichtungsmaterial: FKM (andere Werkstoffe auf Anfrage)

Sealing material: FKM (other materials on request)

密封材料: FKM (其他材料可咨询)

**Einstellbare T-Verschraubungen mit Dichtkegel und O-Ring**

**Adjustable T fittings with taper and O-ring**

**可调式三通组合接头总成 (带24度锥旋转螺母及O型圈)**

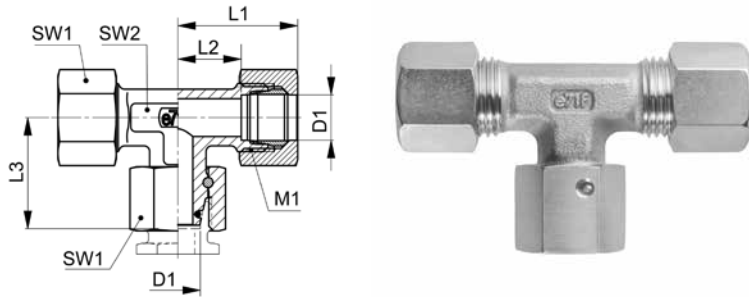

20

**NC-ETKO-..L/S**

Type -D1	Mat.-Nr.	PN	M1	L1	L2	L3	SW1	SW2	SW3	g/Stk
NC-ETKO-06L	718.3670.060.20	250	12x1.5	28.0	12.0	26.0	14	12	14	54
NC-ETKO-08L	718.3670.080.20	250	14x1.5	30.0	14.0	27.5	17	12	17	76
NC-ETKO-10L	718.3670.100.20	250	16x1.5	32.5	15.0	29.0	19	14	19	107
NC-ETKO-12L	718.3670.120.20	250	18x1.5	34.0	17.0	29.5	22	17	22	135
NC-ETKO-15L	718.3670.150.20	250	22x1.5	39.0	21.0	32.5	27	19	22	223
NC-ETKO-18L	718.3670.180.20	160	26x1.5	41.0	23.5	35.5	32	24	32	332
NC-ETKO-22L	718.3670.220.20	160	30x2.0	47.5	27.5	38.5	36	27	36	439
NC-ETKO-06S	718.3670.060.30	500	14x1.5	32.0	16.0	27.0	17	12	17	87
NC-ETKO-08S	718.3670.080.30	500	16x1.5	33.0	17.0	27.5	19	14	19	109
NC-ETKO-10S	718.3670.100.30	400	18x1.5	36.5	17.5	30.0	22	17	22	169
NC-ETKO-12S	718.3670.120.30	400	20x1.5	41.0	21.5	31.0	24	17	24	212
NC-ETKO-14S	718.3670.140.30	300	22x1.5	43.0	22.0	35.0	27	19	27	281
NC-ETKO-16S	718.3670.160.30	200	24x1.5	47.0	24.5	36.5	30	24	30	382
NC-ETKO-20S	718.3670.200.30	200	30x2.0	53.0	26.5	44.5	36	27	36	542
NC-ETKO-25S	718.3670.250.30	100	36x2.0	58.0	30.0	50.0	46	36	46	1050

Baumaße sind Ungefährmaße bei angezogener Überwurfmutter.

Sizes are approximate dimensions at tightened nut.

尺寸为上紧螺母处的概略大小。

Dichtungsmaterial: FKM (andere Werkstoffe auf Anfrage)

Sealing material: FKM (other materials on request)

密封材料: FKM (其他材料可咨询)

D1=Rohr außen-Ø  
M1=metrisches Anschlussgewinde

D1=tube outside diameter  
M1=metric connecting thread

D1 = 管外径  
M1=公制连接管螺纹

**Einstellbare L-Verschraubungen mit Dichtkegel und O-Ring**

**Adjustable L fittings with taper and O-ring**

**可调式外螺纹三通主路组合接头总成 (带24度锥旋转螺母及O型圈)**

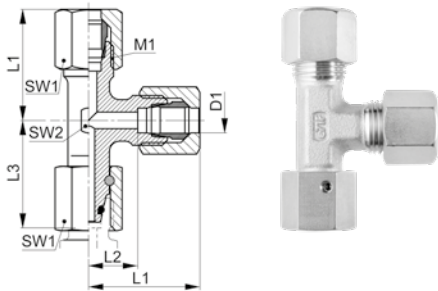

**NC-ELKO-..L/S**

Type -D1	Mat.-Nr.	PN	M1	L1	L2	L3	SW1	SW2	SW3	g/Stk
NC-ELKO-06L	718.3671.060.20	250	12x1.5	28.0	12.0	26.0	14	12	14	53
NC-ELKO-08L	718.3671.080.20	250	14x1.5	30.0	14.0	27.5	17	12	17	80
NC-ELKO-10L	718.3671.100.20	250	16x1.5	32.0	15.0	29.0	19	14	19	109
NC-ELKO-12L	718.3671.120.20	250	18x1.5	33.5	17.0	29.5	22	17	22	132
NC-ELKO-15L	718.3671.150.20	250	22x1.5	38.0	21.0	32.5	27	19	27	223
NC-ELKO-18L	718.3671.180.20	160	26x1.5	40.5	23.5	35.5	32	24	32	337
NC-ELKO-22L	718.3671.220.20	160	30x2.0	47.0	27.5	38.5	36	27	36	439
NC-ELKO-06S	718.3671.060.30	500	14x1.5	32.0	16.0	25.5	17	12	17	89
NC-ELKO-08S	718.3671.080.30	500	16x1.5	33.0	17.0	25.5	19	14	19	109
NC-ELKO-10S	718.3671.100.30	400	18x1.5	36.0	17.5	28.0	22	17	22	170
NC-ELKO-12S	718.3671.120.30	400	20x1.5	40.5	21.5	29.5	24	17	24	212
NC-ELKO-14S	718.3671.140.30	300	22x1.5	42.5	22.0	33.0	27	19	27	277
NC-ELKO-16S	718.3671.160.30	200	24x1.5	46.0	24.5	33.0	30	24	30	345
NC-ELKO-20S	718.3671.200.30	200	30x2.0	51.5	26.5	41.5	36	27	36	548
NC-ELKO-25S	718.3671.250.30	100	36x2.0	57.0	30.0	45.5	46	36	46	1036

Baumaße sind Ungefährmaße bei angezogener Überwurfmutter.

Sizes are approximate dimensions at tightened nut.

尺寸为上紧螺母处的概略大小。

Dichtungsmaterial: FKM (andere Werkstoffe auf Anfrage)

Sealing material: FKM (other materials on request)

密封材料: FKM (其他材料可咨询)

**Reduzierschraubungen mit Dichtkegel und O-Ring**

**Reducing fittings with taper and O-ring**

**直通变径接头总成 (带24度旋转螺母及O型圈)**

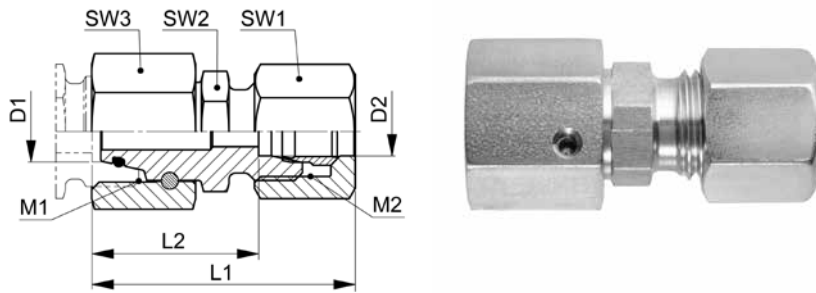

20

**NC-GRKO-..L**

Type-D1 /D2	Mat.-Nr.	PN	M1	M2	L1	L2	SW1	SW2	SW3	g/Stk
NC-GRKO-08/06L	718.1870.140.20	250	14x1.5	12x1.5	39.5	23.0	14	12	17	42
NC-GRKO-10/06L	718.1870.175.20	250	16x1.5	12x1.5	41.0	25.0	14	14	19	54
NC-GRKO-10/08L	718.1870.190.20	250	16x1.5	14x1.5	41.0	25.0	17	14	19	56
NC-GRKO-12/06L	718.1870.215.20	250	18x1.5	12x1.5	41.0	25.0	14	17	22	68
NC-GRKO-12/08L	718.1870.225.20	250	18x1.5	14x1.5	41.0	25.0	17	17	22	72
NC-GRKO-12/10L	718.1870.240.20	250	18x1.5	16x1.5	43.0	26.0	19	17	22	74
NC-GRKO-15/06L	718.1870.391.20	250	22x1.5	12x1.5	44.5	28.5	14	22	27	100
NC-GRKO-15/08L	718.1870.400.20	250	22x1.5	14x1.5	44.5	28.5	17	22	27	118
NC-GRKO-15/10L	718.1870.410.20	250	22x1.5	16x1.5	46.0	29.0	19	22	27	118
NC-GRKO-15/12L	718.1870.420.20	250	22x1.5	18x1.5	45.5	29.0	22	22	27	122
NC-GRKO-18/06L	718.1870.563.20	250	26x1.5	12x1.5	44.0	28.0	14	24	32	122
NC-GRKO-18/08L	718.1870.570.20	250	26x1.5	14x1.5	44.0	28.0	17	24	32	132
NC-GRKO-18/10L	718.1870.575.20	250	26x1.5	16x1.5	46.0	29.0	19	24	32	150
NC-GRKO-18/12L	718.1870.580.20	250	26x1.5	18x1.5	45.5	29.0	22	24	32	152
NC-GRKO-18/15L	718.1870.610.20	250	26x1.5	22x1.5	47.0	30.0	27	24	32	170
NC-GRKO-22/06L	718.1870.723.20	250	30x2.0	12x1.5	48.0	32.0	14	27	36	178
NC-GRKO-22/08L	718.1870.724.20	250	30x2.0	14x1.5	48.0	32.0	17	27	36	180
NC-GRKO-22/10L	718.1870.725.20	250	30x2.0	16x1.5	50.0	33.0	19	27	36	186
NC-GRKO-22/12L	718.1870.730.20	250	30x2.0	18x1.5	49.5	33.0	22	27	36	194
NC-GRKO-22/15L	718.1870.745.20	500	30x2.0	22x1.5	51.0	34.0	27	27	36	236
NC-GRKO-22/18L	718.1870.755.20	160	30x2.0	26x1.5	50.5	33.5	32	27	36	250
NC-GRKO-28/06L	718.1870.828.20	250	36x2.0	12x1.5	50.0	34.0	14	36	41	322
NC-GRKO-28/08L	718.1870.829.20	250	36x2.0	14x1.5	50.0	34.0	17	36	41	315
NC-GRKO-28/10L	718.1870.830.20	250	36x2.0	16x1.5	52.0	35.0	19	36	41	320
NC-GRKO-28/12L	718.1870.835.20	250	36x2.0	18x1.5	51.5	35.0	22	36	41	328
NC-GRKO-28/15L	718.1870.865.20	250	36x2.0	22x1.5	53.0	36.0	27	36	41	350
NC-GRKO-28/18L	718.1870.870.20	160	36x2.0	26x1.5	52.5	35.5	32	36	41	317
NC-GRKO-28/22L	718.1870.900.20	160	36x2.0	30x2.0	57.0	37.5	36	36	41	420

Fortsetzung nächste Seite

Continued on next page

接下页

D1/D2=Rohr außen-Ø  
M1/M2=metrische Anschlussgewinde

D1/D2=tube outside diameter  
M1/M2=metric connecting threads

D1/D2 = 管外径  
M1/M2=公制连接管螺纹

### Reduzierschraubungen mit Dichtkegel und O-Ring

### Reducing fittings with taper and O-ring

### 直通变径接头总成 (带24度旋转螺母及O型圈)

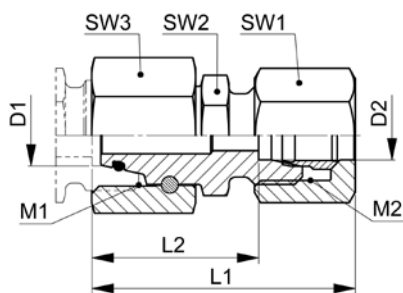

### NC-GRKO..L

Type-D1 /D2	Mat.-Nr.	PN	M1	M2	L1	L2	SW1	SW2	SW3	g/Stk
NC-GRKO-35/06L	718.1870.951.20	250	45x2.0	12x1.5	53.0	37.0	14	46	50	372
NC-GRKO-35/08L	718.1870.952.20	250	45x2.0	14x1.5	53.0	37.0	17	46	50	388
NC-GRKO-35/10L	718.1870.953.20	250	45x2.0	16x1.5	55.0	38.0	19	46	50	362
NC-GRKO-35/12L	718.1870.954.20	250	45x2.0	18x1.5	54.5	38.0	22	46	50	378
NC-GRKO-35/15L	718.1870.946.20	250	45x2.0	22x1.5	56.0	39.0	27	46	50	404
NC-GRKO-35/18L	718.1870.947.20	160	45x2.0	26x1.5	55.5	38.5	32	46	50	432
NC-GRKO-35/22L	718.1870.948.20	160	45x2.0	30x2.0	60.0	40.5	36	46	50	454
NC-GRKO-42/06L	718.1870.949.20	250	52x2.0	12x1.5	56.5	40.5	14	46	50	504
NC-GRKO-42/08L	718.1870.986.20	250	52x2.0	14x1.5	56.5	40.5	17	50	60	552
NC-GRKO-42/10L	718.1870.987.20	250	52x2.0	16x1.5	58.5	41.5	19	50	60	558
NC-GRKO-42/12L	718.1870.988.20	250	52x2.0	18x1.5	58.0	41.5	22	50	60	570
NC-GRKO-42/15L	718.1870.989.20	250	52x2.0	22x1.5	59.5	42.5	27	50	60	582
NC-GRKO-42/18L	718.1870.991.20	160	52x2.0	26x1.5	59.0	42.0	32	50	60	600
NC-GRKO-42/22L	718.1870.993.20	160	52x2.0	30x2.0	63.5	44.0	36	50	60	628

Baumaße sind Ungefährmaße bei angezogener Überwurfmutter.

Sizes are approximate dimensions at tightened nut.

尺寸为上紧螺母处的概略大小。

Dichtungsmaterial: FKM (andere Werkstoffe auf Anfrage)

Sealing material: FKM (other materials on request)

密封材料: FKM (其他材料可咨询)



**Reduzierschraubungen mit Dichtkegel und O-Ring**

**Reducing fittings with taper and O-ring**

**直通变径接头总成 (带24度旋转螺母及O型圈)**

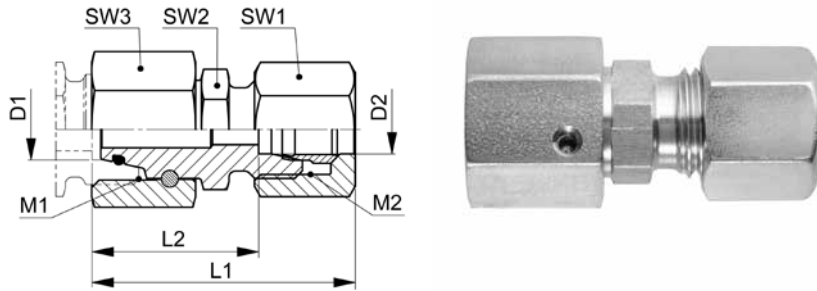

20

**NC-GRKO-..S**

Type-D1 /D2	Mat.-Nr.	PN	M1	M2	L1	L2	SW1	SW2	SW3	g/Stk
NC-GRKO-08/06S	718.1870.140.30	500	16x1.5	14x1.5	43.0	27.0	17	14	19	64
NC-GRKO-10/06S	718.1870.175.30	500	18x1.5	14x1.5	44.5	27.0	17	17	22	78
NC-GRKO-10/08S	718.1870.190.30	500	18x1.5	16x1.5	43.5	27.0	19	17	22	82
NC-GRKO-12/06S	718.1870.215.30	500	20x1.5	14x1.5	46.0	30.0	17	19	24	98
NC-GRKO-12/08S	718.1870.225.30	500	20x1.5	16x1.5	46.0	30.0	19	19	24	100
NC-GRKO-12/10S	718.1870.240.30	400	20x1.5	18x1.5	48.0	29.0	22	19	24	112
NC-GRKO-14/06S	718.1870.296.30	500	22x1.5	14x1.5	47.5	31.0	17	22	27	132
NC-GRKO-14/08S	718.1870.300.30	500	22x1.5	16x1.5	47.5	31.5	19	22	27	136
NC-GRKO-14/10S	718.1870.320.30	400	22x1.5	18x1.5	49.5	31.0	22	22	27	146
NC-GRKO-14/12S	718.1870.340.30	400	22x1.5	20x1.5	50.0	31.0	24	22	27	148
NC-GRKO-16/06S	718.1870.466.30	400	24x1.5	14x1.5	48.0	32.0	17	22	30	128
NC-GRKO-16/08S	718.1870.468.30	400	24x1.5	16x1.5	48.0	32.0	19	22	30	134
NC-GRKO-16/10S	718.1870.470.30	400	24x1.5	18x1.5	50.0	31.0	22	22	30	156
NC-GRKO-16/12S	718.1870.480.30	400	24x1.5	20x1.5	50.5	31.0	24	22	30	160
NC-GRKO-16/14S	718.1870.500.30	300	24x1.5	22x1.5	53.5	33.0	27	22	30	184
NC-GRKO-20/06S	718.1870.650.30	400	30x2.0	14x1.5	52.0	36.0	17	27	36	206
NC-GRKO-20/08S	718.1870.655.30	400	30x2.0	16x1.5	52.0	36.0	19	27	36	198
NC-GRKO-20/10S	718.1870.660.30	400	30x2.0	18x1.5	54.0	35.5	22	27	36	210
NC-GRKO-20/12S	718.1870.665.30	400	30x2.0	20x1.5	54.5	35.5	24	27	36	238
NC-GRKO-20/14S	718.1870.675.30	300	30x2.0	22x1.5	57.5	37.0	27	27	36	258
NC-GRKO-20/16S	718.1870.685.30	200	30x2.0	24x1.5	58.0	36.5	30	27	36	264
NC-GRKO-25/06S	718.1870.788.30	400	36x2.0	14x1.5	54.5	38.5	17	36	46	356
NC-GRKO-25/08S	718.1870.787.30	400	36x2.0	16x1.5	54.5	38.5	19	36	46	362
NC-GRKO-25/10S	718.1870.789.30	400	36x2.0	18x1.5	56.5	38.0	22	36	46	352
NC-GRKO-25/12S	718.1870.791.30	400	36x2.0	20x1.5	57.0	38.0	24	36	46	356
NC-GRKO-25/14S	718.1870.790.30	300	36x2.0	22x1.5	60.0	39.5	27	36	46	374
NC-GRKO-25/16S	718.1870.800.30	200	36x2.0	24x1.5	60.5	39.0	30	36	46	394
NC-GRKO-25/20S	718.1870.820.30	200	36x2.0	30x2.0	64.0	39.0	36	36	46	458

Fortsetzung nächste Seite

Continued on next page

接下页

D1/D2=Rohr außen-Ø  
M1/M2=metrische Anschlussgewinde

D1/D2=tube outside diameter  
M1/M2=metric connecting threads

D1/D2 = 管外径  
M1/M2=公制连接管螺纹

**Reduzierschraubungen mit Dichtkegel und O-Ring**

**Reducing fittings with taper and O-ring**

**直通变径接头总成 (带24度旋转螺母及O型圈)**

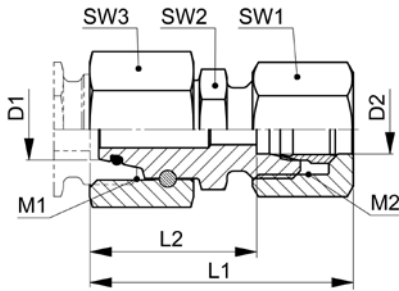

**NC-GRKO..S**

Type -D1 /D2	Mat.-Nr.	PN	M1	M2	L1	L2	SW1	SW2	SW3	g/Stk
NC-GRKO-30/06S	718.1870.937.30	300	42x2.0	14x1.5	60.0	43.5	17	41	50	412
NC-GRKO-30/08S	718.1870.936.30	300	42x2.0	16x1.5	60.0	43.5	19	41	50	416
NC-GRKO-30/10S	718.1870.939.30	300	42x2.0	18x1.5	62.0	43.0	22	41	50	424
NC-GRKO-30/12S	718.1870.940.30	320	42x2.0	20x1.5	62.5	43.0	24	41	50	432
NC-GRKO-30/14S	718.1870.941.30	300	42x2.0	22x1.5	65.5	44.5	27	41	50	480
NC-GRKO-30/16S	718.1870.942.30	200	42x2.0	24x1.5	66.0	44.0	30	41	50	468
NC-GRKO-30/20S	718.1870.943.30	200	42x2.0	30x2.0	69.5	44.0	36	41	50	528
NC-GRKO-30/25S	718.1870.945.30	100	42x2.0	36x2.0	72.0	44.5	46	41	50	672
NC-GRKO-38/06S	718.1870.965.30	300	52x2.0	14x1.5	63.0	47.0	17	50	60	574
NC-GRKO-38/08S	718.1870.966.30	300	52x2.0	16x1.5	63.0	47.0	19	50	60	578
NC-GRKO-38/10S	718.1870.967.30	300	52x2.0	18x1.5	65.0	46.5	22	50	60	632
NC-GRKO-38/12S	718.1870.968.30	300	52x2.0	20x1.5	65.5	46.5	24	50	60	638
NC-GRKO-38/14S	718.1870.969.30	300	52x2.0	22x1.5	68.5	48.0	27	50	60	652
NC-GRKO-38/16S	718.1870.970.30	200	52x2.0	24x1.5	69.0	47.5	30	50	60	672
NC-GRKO-38/20S	718.1870.971.30	200	52x2.0	30x2.0	72.5	47.5	36	50	60	682
NC-GRKO-38/25S	718.1870.972.30	200	52x2.0	36x2.0	75.0	48.5	46	50	60	818

Baumaße sind Ungefährmaße bei angezogener Überwurfmutter.

Sizes are approximate dimensions at tightened nut.

尺寸为上紧螺母处的概略大小。

Dichtungsmaterial: FKM (andere Werkstoffe auf Anfrage)

Sealing material: FKM (other materials on request)

密封材料: FKM (其他材料可咨询)