

EXMAR

艾克斯玛

30

NC-Klemmring-
verschraubungen

NC clamping ring
fittings

NC 夹紧环接头

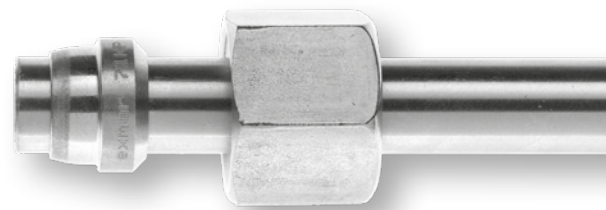
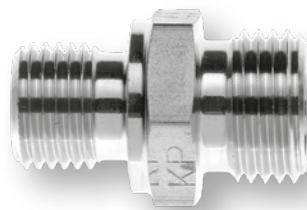

Übersicht

Overview

综述

Seite / Page / 页

Seite / Page / 页

Seite / Page / 页

NC-Rohrverschraubungen

NC Tube fittings

NC 管接头

NC-Einschraubverschraubungen

NC Male adaptor fittings

NC 外螺纹螺柱接头

NC-Schwenkverschraubungen

NC Banjo fittings

NC 铰接接头

Gerade Verschraubungen
Straight fittings
直通接头总成



30.6

NC-GV

Gerade Einschraubverschraubungen
Straight male adaptor fittings
英制外螺纹端直通接头总成



30.13-30.26

NC-GEV

Winkel-Schwenkverschraubungen
Banjo elbow fittings
铰接式直角接头总成



30.41-30.44

NC-ESWV

Winkelverschraubungen
Elbow fittings
直角弯头总成



30.7

NC-WV

Winkel-Einschraubverschraubungen
Male adaptor elbow fittings
英制外螺纹直角弯通接头总成



30.27-30.32

NC-WEV

NC-Aufschraub-/Manometerverschr.
NC Female adaptor/Manometer fitt.
NC 内螺纹螺柱 / 压力计接头

T-Verschraubungen
T fittings
等径三通接头总成



30.8

NC-TV

T-Einschraubverschraubungen
Male adaptor T fittings
英制外螺纹三通接头总成



30.33-30.35

NC-TEV

Gerade Aufschraubverschraubungen
Straight female adaptor fittings
英制直通内螺纹接头总成



30.45-30.47

NC-GAV

Kreuz-Verschraubungen
Cross fittings
等径四通接头总成



30.9

NC-KV

L-Einschraubverschraubungen
Male adaptor L fittings
英制外螺纹三通主路接头总成



30.36-30.38

NC-LEV

Manometer-Anschlussverschraubungen
Manometer fittings
压力表接头总成



30.48-30.49

NC-MAV

Verschlussverschraubungen
Locking fittings
管端堵头



30.10

NC-VSA

NC-Einstellbare Verschraubungen
NC Adjustable fittings
NC 可调式接头

Gerade Messverschraubungen
Straight fittings with test gauge
带测试点的直通接头总成



30.50

NC-EMV-GV

Gerade Schottverschraubungen
Bulkhead fittings
直通隔板式接头总成



30.11

NC-GSV

Einstellbare Winkel-Einschraubversch.
Adjustable male adaptor elbow fittings
可调式直角弯头总成



30.39-30.40

NC-WEE

NC-Reduzierschraubungen
NC Reducing fittings
NC 异径接头

Winkel-Schottverschraubungen
Bulkhead elbow fittings
直角隔板式接头总成



30.12

NC-WSV

Gerade Reduzierschraubungen
Straight reducing fittings
直通变径接头总成



30.51-30.52

NC-GR

Seite / Page / 页

30.53
 T-Reduzierschraubungen
 Reducing T fittings
 三通变径接头总成

**NC-TR**

NC-Anschweißverschraubungen
NC Weldable fittings
 NC 可焊连接

30.54
 Gerade Anschweißverschraubungen
 Straight weld-on fittings
 直通焊接式接头总成

**NC-GAS**

30.55
 Winkelanschweißverschraubungen
 Elbow weld-on fittings
 直角焊接式接头总成

**NC-WAS**

30.56
 Einschweiß-Schottverschraubungen
 Weld-in bulkhead fittings
 隔板式焊接式接头总成

**NC-ESV**

NC-Einzelteile
NC Single parts
 NC 单件零件

30.57
 Überwurfmuttern
 Nuts
 螺母

**UEM-VS**

30.58
 NC-Klemmringe
 NC clamping rings
 NC 夹紧环

**NC-R**

NC-Klemmringverschraubungen

NC Clamping ring fittings

NC 夹紧环接头

Technische Information

Technical information

技术信息

NC-Klemmringverschraubungen

NC Clamping ring fittings

NC 夹紧环接头

Eigenschaften, Besonderheiten

- angelehnt an ISO 8434-1/DIN 2353
- Baureihen L und S
- korrosionsbeständig
- große Sortimentsvielfalt
- Überwurfmutter innen versilbert

Characteristics, specialities

- based on ISO 8434-1/DIN 2353
- series L and S
- corrosion resistant
- extensive product range
- nuts silver-plated inside

属性, 特性

- 基于 ISO 8434-1/DIN 2353
- 轻系列, 重系列
- 耐腐蚀
- 产品种类繁多
- 螺母内部镀银处理

Funktionsprinzip

Die Abkürzung **NC** verweist auf die Eigenschaften der Verschraubung: **Non-Cutting**, **Non-Corrosive** = nicht schneidend, nicht rostend.

Operating principle

The abbreviation **NC** stands for the characteristics of the fittings: **Non-Cutting**, **Non-Corrosive**.

工作原理

缩写词 **NC** 代表的是接头的特性: 无切削、无腐蚀。

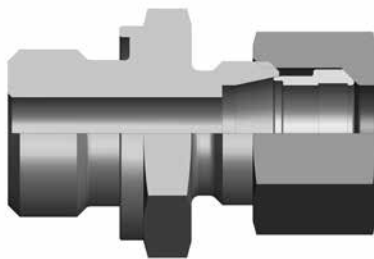

Vor der Montage
Before assembly
组装前

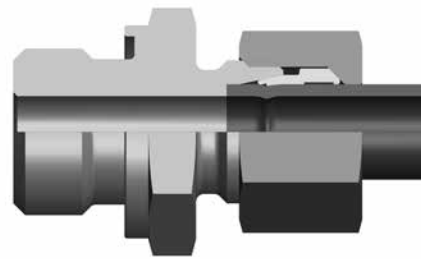

Nach der Montage
After assembly
组装后

Werkstoff

Edelstahl 1.4571
Legierung X 6 CrNiMoTi 17 12 2
≈ AISI 316 Ti
Andere hochwertige Werkstoffqualitäten (Hastelloy®, Monel®, Titan, etc.) sind möglich.

Material

Stainless steel 1.4571
alloy X 6 CrNiMoTi 17 12 2
≈ AISI 316 Ti
Other high quality materials (Hastelloy®, Monel®, Titan, etc.) also available.

材质

不锈钢 1.4571
合金 X 6 CrNiMoTi 17 12 2
≈ AISI 316 Ti
也可以使用其他材质 (Hastelloy®, Monel®, 钛等) 和其他高合金不锈钢。

Nenndruck PN

bis 500 bar
Sicherheitsfaktor: 4-fach
Ausnahme: Schwenkverschraubungen 1.5-fach

Pressure nominal PN

up to 500 bar
Safety factor: 4 times
Exception: Banjo fittings 1.5 times

公称压力 PN

最高 500 bar
安全系数: 4倍
例外: 铰接1.5倍

Druckbereiche für
NC-Klemmringverschraubungen

Baureihe	Rohr	Nenndruck
L: leicht	6 - 15 mm	PN 250 (bar)
	18 - 22 mm	PN 160 (bar)
S: schwer	6 - 8 mm	PN 500 (bar)
	10 - 12 mm	PN 400 (bar)
	14 mm	PN 300 (bar)
	16 - 20 mm	PN 200 (bar)
	25 mm	PN 100 (bar)

Pressure range for
NC Clamping ring fittings

Serie	Tube	Pressure nom.
L: light	6 - 15 mm	PN 250 (bar)
	18 - 22 mm	PN 160 (bar)
S: heavy	6 - 8 mm	PN 500 (bar)
	10 - 12 mm	PN 400 (bar)
	14 mm	PN 300 (bar)
	16 - 20 mm	PN 200 (bar)
	25 mm	PN 100 (bar)

压力范围NC 夹紧环接头

系列	管件	公称压力
L: 轻	6 - 15 mm	PN 250 (巴)
	18 - 22 mm	PN 160 (巴)
S: 重	6 - 8 mm	PN 500 (巴)
	10 - 12 mm	PN 400 (巴)
	14 mm	PN 300 (巴)
	16 - 20 mm	PN 200 (巴)
	25 mm	PN 100 (巴)

NC-Klemmringverschraubungen NC Clamping ring fittings NC 夹紧环接头

Technische Information **Technical information** **技术信息**
 NC-Klemmringverschraubungen (Fort.) NC Clamping ring fittings (cont.) NC 夹紧环接头 (续)

Druckauswertungsgrad in % des PN

Pressure coefficient in % of PN

压力系数 (PN 的百分比)

°C									
-196°	-110°	-60°	0°	20°	50°	100°	200°	300°	400°
50 %	70 %	100 %	100 %	95.5 %	89 %	80 %	71 %	67 %	

Temperaturbereich

-196°C bis +400°C

Achtung: Ausnahmen bilden mit FKM weichgedichtete Verschraubungen (Zusatz "WD"), die nur in einem Bereich von -20°C bis +200°C eingesetzt werden können.

Temperature range

-196°C to +400°C

Attention: Excepted are FKM-sealed fittings (suppl. "WD"), which can be used from -20°C up to +200°C.

温度范围

-196°C 至 +400°C

注意: 软密封接头 ("WD") 例外, 这两种接头只能用于 -20°C 到 +200°C 的范围。

Helium-Leckrate

mind. 10⁸ mbar • l/s bei fachgerechter Montage; siehe Kapitel i für Montageanleitung.

Leak rate with helium

10⁸ mbar • l/s min. when professionally assembled; see chapter i for installation instructions.

氦气泄漏率

在正确组装下最小 10⁸ mbar • l/s; 有关组装说明, 请参见 i 部分。

Vakuum

bis 10⁻⁴ mbar, tiefere Werte möglich

Vacuum

up to 10⁻⁴ mbar, lower values are possible

真空

最高 10⁻⁴ mbar, 低值也可行

Anzuschließende Rohre

Nahtlose, gezogene Präzisionsrohre aus Edelstahl (DIN EN 10216-5/EN ISO 1127, Toleranzkl. D4/T3) mit sauberer, glatter Oberfläche oder Kunststoffrohre. Außendurchmesser innerhalb ± 0,1 mm; Ausnahme: Kunststoffrohre. Bitte beachten Sie die empfohlenen Rohrwandstärken (Kapitel i).

Tubes to use

Seamless, cold-drawn, high precision stainless steel tubes (according to DIN EN 10216-5/EN ISO 1127 tolerance class D4/T3) with clean, smooth surface or plastic tubes. Outer diameter within ± 0,1 mm; exception: plastic tubes. Please note the recommended tube wall thicknesses (chapter i).

用于连接的管材

高精度的冷拔无缝不锈钢管 (DIN EN 10216-5/EN ISO 1127, 公差级数 D4/T3), 表面整洁光滑; 或塑料管。外径在 ±0.1 mm 内; 例外: 塑料管。参见“硬管和软管”一节。请注意推荐的管壁厚度 (章节i)。

Werkzeugnis

Werden Bescheinigungen über Materialprüfungen nach DIN EN 10 204 gewünscht, so ist dies bei Bestellung anzugeben (Abnahmeprüfzeugnis 3.1 gegen Berechnung).

Material certificates

Any request for documents on material tests according to DIN EN 10 204 should be made when placing the order (charges apply to inspection certificates 3.1).

材质认证

如需按照 DIN EN 10204 进行材料测试认证, 请在订单中告知我们 (将收取检查认证 3.1 或更高版本的相关费用)。

Gerade Verschraubungen

Straight fittings

直通接头总成

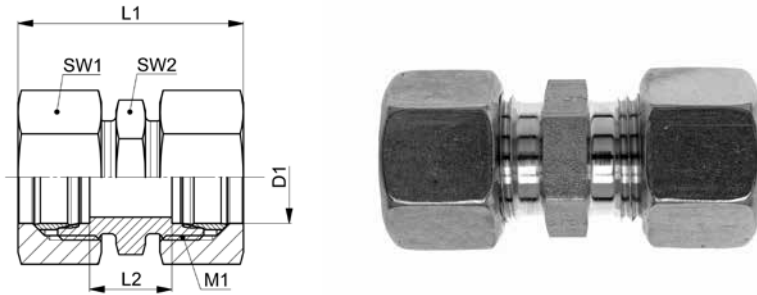

NC-GV-..L/S

Type -D1	Mat.-Nr.	PN	M1	L1	L2	SW1	SW2	g/Stk
NC-GV-06L	718.1020.060.20	250	12x1.5	42.0	10.0	14	12	35
NC-GV-08L	718.1020.080.20	250	14x1.5	43.0	11.0	17	14	50
NC-GV-10L	718.1020.100.20	250	16x1.5	48.0	13.0	19	17	65
NC-GV-12L	718.1020.120.20	250	18x1.5	48.0	14.0	22	19	85
NC-GV-15L	718.1020.150.20	250	22x1.5	52.0	16.0	27	24	140
NC-GV-18L	718.1020.180.20	160	26x1.5	51.0	16.0	32	27	201
NC-GV-22L	718.1020.220.20	160	30x2.0	60.0	20.0	36	32	274
NC-GV-06S	718.1020.060.30	500	14x1.5	48.0	16.0	17	14	65
NC-GV-08S	718.1020.080.30	500	16x1.5	50.0	18.0	19	17	83
NC-GV-10S	718.1020.100.30	400	18x1.5	55.0	17.0	22	19	110
NC-GV-12S	718.1020.120.30	400	20x1.5	58.0	19.0	24	22	135
NC-GV-14S	718.1020.140.30	300	22x1.5	64.0	22.0	27	24	187
NC-GV-16S	718.1020.160.30	200	24x1.5	66.0	21.0	30	27	229
NC-GV-20S	718.1020.200.30	200	30x2.0	76.0	23.0	36	32	350
NC-GV-25S	718.1020.250.30	100	36x2.0	83.0	26.0	46	41	672

Baumaße sind Ungefährmaße bei angezogener Überwurfmutter.

Sizes are approximate dimensions at tightened nut.

尺寸为上紧螺母处的概略大小。

Winkelverschraubungen

Elbow fittings

直角弯头总成

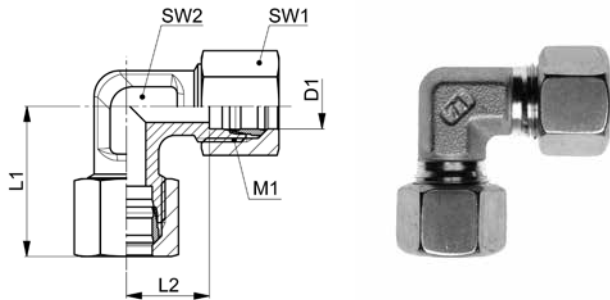

NC-WV-..L/S

Type -D1	Mat.-Nr.	PN	M1	L1	L2	SW1	SW2	g/Stk
NC-WV-06L	718.2000.060.20	250	12x1.5	28.0	12.0	14	12	42
NC-WV-08L	718.2000.080.20	250	14x1.5	30.0	14.0	17	12	59
NC-WV-10L	718.2000.100.20	250	16x1.5	32.5	15.0	19	14	74
NC-WV-12L	718.2000.120.20	250	18x1.5	34.0	17.0	22	17	103
NC-WV-15L	718.2000.150.20	250	22x1.5	39.0	21.0	27	19	169
NC-WV-18L	718.2000.180.20	160	26x1.5	41.0	23.5	32	24	248
NC-WV-22L	718.2000.220.20	160	30x2.0	47.5	27.5	36	27	320
NC-WV-06S	718.2000.060.30	500	14x1.5	32.0	16.0	17	12	74
NC-WV-08S	718.2000.080.30	500	16x1.5	33.0	17.0	19	14	95
NC-WV-10S	718.2000.100.30	400	18x1.5	36.5	17.5	22	17	128
NC-WV-12S	718.2000.120.30	400	20x1.5	41.0	21.5	24	17	159
NC-WV-14S	718.2000.140.30	300	22x1.5	43.0	22.0	27	19	210
NC-WV-16S	718.2000.160.30	200	24x1.5	47.0	24.5	30	24	260
NC-WV-20S	718.2000.200.30	200	30x2.0	53.0	26.5	36	27	410
NC-WV-25S	718.2000.250.30	100	36x2.0	58.5	30.0	46	36	776

Baumaße sind Ungefährmaße bei angezogener Überwurfmutter.

Sizes are approximate dimensions at tightened nut.

尺寸为上紧螺母处的概略大小。

D1=Rohr außen-Ø
M1=metrisches Anschlussgewinde

D1=tube outside diameter
M1=metric connecting thread

D1 = 管外径
M1=公制连接管螺纹

T-Verschraubungen

T fittings

等径三通接头总成

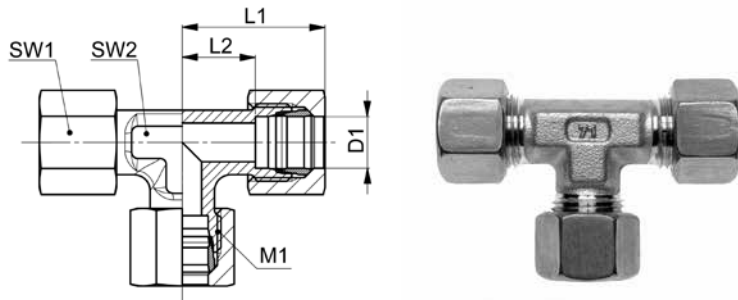

NC-TV-..L/S

Type -D1	Mat.-Nr.	PN	M1	L1	L2	SW1	SW2	g/Stk
NC-TV-06L	718.3000.060.20	250	12x1.5	28.0	12.0	14	12	51
NC-TV-08L	718.3000.080.20	250	14x1.5	30.0	14.0	17	12	85
NC-TV-10L	718.3000.100.20	250	16x1.5	32.5	15.0	19	14	106
NC-TV-12L	718.3000.120.20	250	18x1.5	34.0	17.0	22	17	140
NC-TV-15L	718.3000.150.20	250	22x1.5	39.0	21.0	27	19	240
NC-TV-18L	718.3000.180.20	160	26x1.5	41.0	23.5	32	24	348
NC-TV-22L	718.3000.220.20	160	30x2.0	47.5	27.5	36	27	468
NC-TV-06S	718.3000.060.30	500	14x1.5	32.0	16.0	17	12	110
NC-TV-08S	718.3000.080.30	500	16x1.5	33.0	17.0	19	14	134
NC-TV-10S	718.3000.100.30	400	18x1.5	36.5	17.5	22	17	190
NC-TV-12S	718.3000.120.30	400	20x1.5	41.0	21.5	24	17	227
NC-TV-14S	718.3000.140.30	300	22x1.5	43.0	22.0	27	19	300
NC-TV-16S	718.3000.160.30	200	24x1.5	47.0	24.5	30	24	390
NC-TV-20S	718.3000.200.30	200	30x2.0	53.0	26.5	36	27	590
NC-TV-25S	718.3000.250.30	100	36x2.0	58.5	30.0	46	36	1180

Baumaße sind Ungefährmaße bei angezogener Überwurfmutter.

Sizes are approximate dimensions at tightened nut.

尺寸为上紧螺母处的概略大小。

Kreuz-Verschraubungen

Cross fittings

等径四通接头总成

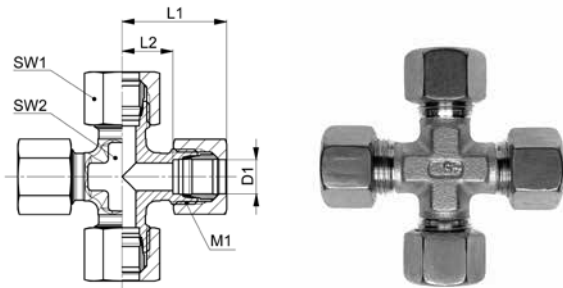

NC-KV-..L/S

Type -D1	Mat.-Nr.	PN	M1	L1	L2	SW1	SW2	g/Stk
NC-KV-06L	718.4000.060.20	250	12x1.5	28.0	12.0	14	12	80
NC-KV-08L	718.4000.080.20	250	14x1.5	30.0	14.0	17	12	109
NC-KV-10L	718.4000.100.20	250	16x1.5	32.0	15.0	19	14	158
NC-KV-12L	718.4000.120.20	250	18x1.5	33.5	17.0	22	17	185
NC-KV-15L	718.4000.150.20	250	22x1.5	38.0	21.0	27	19	338
NC-KV-18L	718.4000.180.20	160	26x1.5	40.5	23.5	32	24	445
NC-KV-22L	718.4000.220.20	160	30x2.0	47.0	27.5	36	27	600
NC-KV-06S	718.4000.060.30	500	14x1.5	32.0	16.0	17	12	140
NC-KV-08S	718.4000.080.30	500	16x1.5	33.0	17.0	19	14	175
NC-KV-10S	718.4000.100.30	400	18x1.5	36.0	17.5	22	17	235
NC-KV-12S	718.4000.120.30	400	20x1.5	40.5	21.5	24	17	315
NC-KV-14S	718.4000.140.30	300	22x1.5	42.5	22.0	27	19	385
NC-KV-16S	718.4000.160.30	200	24x1.5	46.0	24.5	30	24	500
NC-KV-20S	718.4000.200.30	200	30x2.0	51.5	26.5	36	27	857
NC-KV-25S	718.4000.250.30	100	36x2.0	57.0	30.0	46	36	1250

Baumaße sind Ungefährmaße bei angezogener Überwurfmutter.

Sizes are approximate dimensions at tightened nut.

尺寸为上紧螺母处的概略大小。

D1=Rohr außen-Ø
M1=metrisches Anschlussgewinde

D1=tube outside diameter
M1=metric connecting thread

D1 = 管外径
M1=公制连接管螺纹

Verschlussverschraubungen

Locking fittings

管端堵头

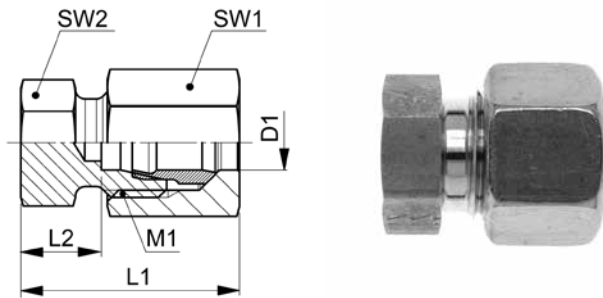

NC-VSA-..L/S

Type -D1	Mat.-Nr.	PN	M1	L1	L2	L3	SW1	SW2	g/Stk
NC-VSA-06L	718.1205.060.20	250	12x1.5	25.0	16.0	16.0	14	12	22
NC-VSA-08L	718.1205.080.20	250	14x1.5	27.0	16.0	16.0	17	14	30
NC-VSA-10L	718.1205.100.20	250	16x1.5	29.5	17.5	19.0	19	17	38
NC-VSA-12L	718.1205.120.20	250	18x1.5	29.0	17.0	19.0	22	19	50
NC-VSA-15L	718.1205.150.20	250	22x1.5	33.0	18.0	22.0	27	24	84
NC-VSA-18L	718.1205.180.20	160	26x1.5	32.0	17.5	22.0	32	27	124
NC-VSA-22L	718.1205.220.20	160	30x2.0	38.5	20.0	26.0	36	32	166
NC-VSA-06S	718.1205.060.30	500	14x1.5	27.0	16.0	18.0	17	14	36
NC-VSA-08S	718.1205.080.30	500	16x1.5	29.0	16.0	20.0	19	17	42
NC-VSA-10S	718.1205.100.30	400	18x1.5	31.5	19.0	20.0	22	19	64
NC-VSA-12S	718.1205.120.30	400	20x1.5	32.0	19.5	20.0	24	22	78
NC-VSA-14S	718.1205.140.30	300	22x1.5	37.0	21.0	24.0	27	24	118
NC-VSA-16S	718.1205.160.30	200	24x1.5	38.0	22.5	24.0	30	27	142
NC-VSA-20S	718.1205.200.30	200	30x2.0	44.0	26.5	28.0	36	32	236
NC-VSA-25S	718.1205.250.30	100	36x2.0	46.5	28.5	30.0	46	41	448

Baumaße sind Ungefährmaße bei angezogener Überwurfmutter.

Sizes are approximate dimensions at tightened nut.

尺寸为上紧螺母处的概略大小。

Gerade Schottverschraubungen

Bulkhead fittings

直通隔板式接头总成

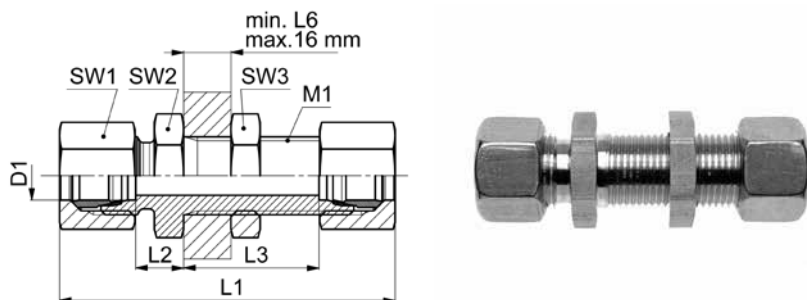

NC-GSV-..L/S

Type -D1	Mat.-Nr.	PN	M1	L1	L2	L3	SW1	SW2	SW3	g/Stk
NC-GSV-06L	718.1500.060.20	250	12x1.5	66.0	7.0	27.0	14	17	17	72
NC-GSV-08L	718.1500.080.20	250	14x1.5	67.0	8.0	27.0	17	19	19	83
NC-GSV-10L	718.1500.100.20	250	16x1.5	72.0	10.0	28.0	19	22	22	125
NC-GSV-12L	718.1500.120.20	250	18x1.5	72.0	10.0	29.0	22	24	24	135
NC-GSV-15L	718.1500.150.20	250	22x1.5	77.0	12.0	31.0	27	27	30	230
NC-GSV-18L	718.1500.180.20	160	26x1.5	80.0	13.5	32.5	32	32	36	345
NC-GSV-22L	718.1500.220.20	160	30x2.0	90.0	16.5	34.5	36	36	41	435
NC-GSV-06S	718.1500.060.30	500	14x1.5	73.0	12.0	29.0	17	19	19	112
NC-GSV-08S	718.1500.080.30	500	16x1.5	74.0	13.0	29.0	19	22	22	132
NC-GSV-10S	718.1500.100.30	400	18x1.5	81.0	14.5	29.5	22	24	24	170
NC-GSV-12S	718.1500.120.30	400	20x1.5	83.0	14.5	30.5	24	27	27	215
NC-GSV-14S	718.1500.140.30	300	22x1.5	90.0	17.0	32.0	27	30	30	322
NC-GSV-16S	718.1500.160.30	200	24x1.5	91.0	16.5	31.5	30	32	32	345
NC-GSV-20S	718.1500.200.30	200	30x2.0	104.0	17.5	33.5	36	41	41	575
NC-GSV-25S	718.1500.250.30	100	36x2.0	112.0	20.0	35.0	46	46	46	949

Baumaße sind Ungefährmaße bei angezogener Überwurfmutter.

für D1 ≤ 18 mm L6 = 3 mm
für D1 > 18 mm L6 = 4 mm

Sizes are approximate dimensions at tightened nut.

for D1 ≤ 18 mm L6 = 3 mm
for D1 > 18 mm L6 = 4 mm

尺寸为上紧螺母处的概略大小。

当D1 ≤ 18 mm时, L6 = 3 mm
当D1 > 18 mm时, L6 = 4 mm

Winkel-Schottverschraubungen

Bulkhead elbow fittings

直角隔板式接头总成

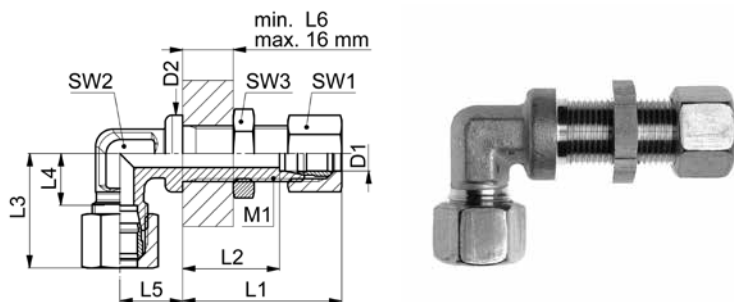

NC-WSV-..L/S

Type -D1	Mat.-Nr.	PN	D2	M1	L1	L2	L3	L4	L5	SW1	SW2	SW3	g/Stk
NC-WSV-06L	718.2700.060.20	250	17.0	12x1.5	43.0	28.0	27.0	12.0	14.0	14	12	17	73
NC-WSV-08L	718.2700.080.20	250	19.0	14x1.5	43.0	30.0	29.0	14.0	17.0	17	12	19	92
NC-WSV-10L	718.2700.100.20	250	22.0	16x1.5	45.5	32.5	30.5	15.0	18.0	19	14	22	172
NC-WSV-12L	718.2700.120.20	250	24.0	18x1.5	46.0	34.0	32.0	17.0	20.0	22	17	24	215
NC-WSV-15L	718.2700.150.20	250	27.0	22x1.5	49.0	39.0	36.5	21.0	23.0	27	19	30	262
NC-WSV-18L	718.2700.180.20	160	32.0	26x1.5	50.0	41.0	40.0	23.5	24.0	32	24	36	380
NC-WSV-22L	718.2700.220.20	160	36.0	30x2.0	54.5	47.5	44.0	27.5	30.0	36	27	41	490
NC-WSV-06S	718.2700.060.30	500	19.0	14x1.5	45.0	32.0	31.0	29.0	17.0	17	12	19	117
NC-WSV-08S	718.2700.080.30	500	22.0	16x1.5	45.0	33.5	32.5	29.0	18.0	19	14	22	185
NC-WSV-10S	718.2700.100.30	400	24.0	18x1.5	48.5	36.5	35.0	29.5	20.0	22	17	24	195
NC-WSV-12S	718.2700.120.30	400	27.0	20x1.5	50.0	41.0	38.0	30.5	21.0	24	17	27	245
NC-WSV-14S	718.2700.140.30	300	27.0	22x1.5	53.0	43.0	38.0	32.0	23.0	27	19	30	375
NC-WSV-16S	718.2700.160.30	200	30.0	24x1.5	54.0	47.0	43.0	31.5	24.0	30	24	32	395
NC-WSV-20S	718.2700.200.30	200	36.0	30x2.0	60.0	53.0	50.0	33.5	30.0	36	27	41	606
NC-WSV-25S	718.2700.250.30	100	42.0	36x2.0	63.5	58.5	56.0	35.0	34.0	46	36	46	1050

Baumaße sind Ungefährmaße bei angezogener Überwurfmutter.

für D1 ≤ 18 mm L6 = 3 mm
für D1 > 18 mm L6 = 4 mm

Sizes are approximate dimensions at tightened nut.

for D1 ≤ 18 mm L6 = 3 mm
for D1 > 18 mm L6 = 4 mm

尺寸为上紧螺母处的概略大小。

当D1 ≤ 18 mm时, L6 = 3 mm
当D1 > 18 mm时, L6 = 4 mm

Gerade Einschraubverschraubungen

Abdichtung durch Dichtkante Form B nach ISO 1179-4

Straight male adaptor fittings

sealing edge form B acc. ISO 1179-4

英制外螺纹端直通过接头总成

带符合ISO1179-4标准的金属面密封

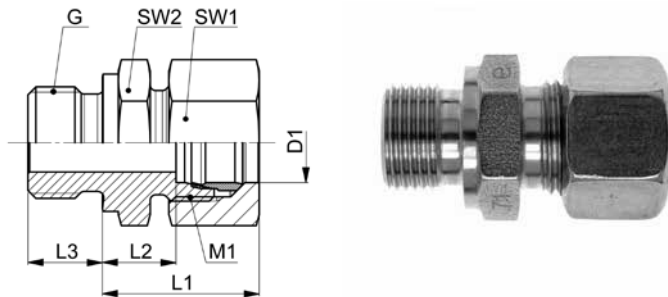

NC-GEV-..LR

Type-D1 G	Mat.-Nr.	PN	G	M1	L1	L2	L3	SW1	SW2	g/Stk
G=Rohrgewinde (zylindrisch)		G=BSP thread (parallel)			G=英制平行管螺纹标准					
NC-GEV-06LR 1.8	718.1141.100.20	250	1/8	12x1.5	24.5	8.5	8.0	14	14	25
NC-GEV-06LR 1.4	718.1141.110.20	250	1/4	12x1.5	26.0	10.0	12.0	14	19	40
NC-GEV-06LR 3.8	718.1141.120.20	250	3/8	12x1.5	27.5	11.5	12.0	14	22	58
NC-GEV-06LR 1.2	718.1141.125.20	250	1/2	12x1.5	29.0	13.0	14.0	14	27	100
NC-GEV-08LR 1.8	718.1141.160.20	250	1/8	14x1.5	24.5	8.5	8.0	17	14	32
NC-GEV-08LR 1.4	718.1141.170.20	250	1/4	14x1.5	26.0	10.0	12.0	17	19	43
NC-GEV-08LR 3.8	718.1141.180.20	250	3/8	14x1.5	28.5	12.5	12.0	17	19	59
NC-GEV-08LR 1.2	718.1141.185.20	250	1/2	14x1.5	29.0	13.0	14.0	17	27	99
NC-GEV-10LR 1.8	718.1141.265.20	250	1/8	16x1.5	27.5	10.5	8.0	19	17	43
NC-GEV-10LR 1.4	718.1141.270.20	250	1/4	16x1.5	28.0	11.0	12.0	19	19	50
NC-GEV-10LR 3.8	718.1141.280.20	250	3/8	16x1.5	29.5	12.5	12.0	19	22	64
NC-GEV-10LR 1.2	718.1141.285.20	250	1/2	16x1.5	31.0	14.0	14.0	19	27	102
NC-GEV-10LR 3.4	718.1141.290.20	250	3/4	16x1.5	31.0	14.0	16.0	19	32	124
NC-GEV-10LR 1.1	718.1141.295.20	250	1	16x1.5	34.0	17.0	18.0	19	41	194
NC-GEV-12LR 1.8	718.1141.375.20	250	1/8	18x1.5	28.0	11.5	8.0	22	19	58
NC-GEV-12LR 1.4	718.1141.380.20	250	1/4	18x1.5	28.5	12.0	12.0	22	19	62
NC-GEV-12LR 3.8	718.1141.390.20	250	3/8	18x1.5	29.0	12.5	12.0	22	22	70
NC-GEV-12LR 1.2	718.1141.400.20	250	1/2	18x1.5	29.5	13.0	14.0	22	27	101
NC-GEV-12LR 3.4	718.1141.405.20	250	3/4	18x1.5	30.5	14.0	16.0	22	32	153
NC-GEV-12LR 1.1	718.1141.408.20	250	1	18x1.5	33.5	17.0	18.0	22	41	208
NC-GEV-15LR 1.4	718.1141.528.20	250	1/4	22x1.5	30.0	13.0	12.0	27	24	98
NC-GEV-15LR 3.8	718.1141.532.20	250	3/8	22x1.5	30.5	13.5	12.0	27	24	102
NC-GEV-15LR 1.2	718.1141.534.20	250	1/2	22x1.5	31.0	14.0	14.0	27	27	114
NC-GEV-15LR 3.4	718.1141.536.20	250	3/4	22x1.5	32.0	15.0	16.0	27	32	172
NC-GEV-15LR 1.1	718.1141.541.20	250	1	22x1.5	35.0	18.0	18.0	27	41	228
NC-GEV-18LR 1.2	718.1141.646.20	160	1/2	26x1.5	31.5	14.5	14.0	32	27	142
NC-GEV-18LR 3.8	718.1141.644.20	160	3/8	26x1.5	31.5	14.5	12.0	32	27	136
NC-GEV-18LR 3.4	718.1141.648.20	160	3/4	26x1.5	31.5	14.5	16.0	32	32	185
NC-GEV-18LR 1.1	718.1141.652.20	160	1	26x1.5	35.0	17.5	18.0	32	41	254
NC-GEV-22LR 3.8	718.1141.763.20	160	3/8	30x2.0	35.5	16.0	12.0	36	32	180
NC-GEV-22LR 1.2	718.1141.764.20	160	1/2	30x2.0	36.0	16.5	14.0	36	32	200
NC-GEV-22LR 3.4	718.1141.768.20	160	3/4	30x2.0	36.0	16.5	16.0	36	32	196
NC-GEV-22LR 1.1	718.1141.770.20	160	1	30x2.0	37.0	17.5	18.0	36	41	289
NC-GEV-22LR 5.4	718.1141.771.20	160	1 1/4	30x2.0	38.0	18.5	20.0	36	50	368

Baumaße sind Ungefährmaße bei angezogener Überwurfmutter.

Sizes are approximate dimensions at tightened nut.

尺寸为上紧螺母处的概略大小。

D1=Rohr außen-Ø
M1=metrisches Anschlussgewinde

D1=tube outside diameter
M1=metric connecting thread

D1 = 管外径
M1=公制连接管螺纹

Gerade Einschraubverschraubungen

Abdichtung durch Profildichtring Form E nach ISO 1179-2

Straight male adaptor fittings

profile sealing ring form E acc. ISO 1179-2

英制外螺纹端直通接头总成

带符合ISO1179-2标准的ED圈密封

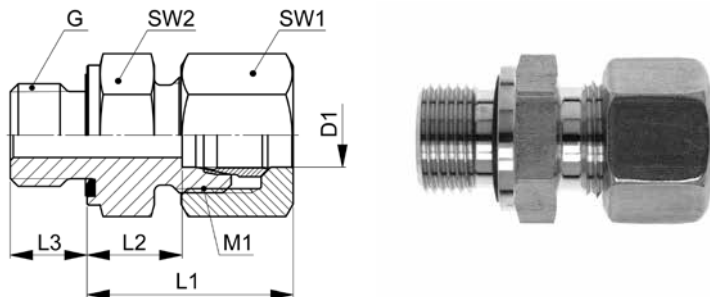

NC-GEV-..LR WD

Type-D1 G	Mat.-Nr.	PN	G	M1	L1	L2	L3	SW1	SW2	g/Stk
G=Rohrgewinde (zylindrisch)		G=BSP thread (parallel)				G=英制平行管螺纹标准				
NC-GEV-06LR 1.8 WD	718.1171.100.20	250	1/8	12x1.5	24.5	8.5	8.0	14	14	25
NC-GEV-06LR 1.4 WD	718.1171.110.20	250	1/4	12x1.5	26.0	10.0	12.0	14	19	40
NC-GEV-06LR 3.8 WD	718.1171.120.20	250	3/8	12x1.5	27.5	11.5	12.0	14	22	58
NC-GEV-06LR 1.2 WD	718.1171.125.20	250	1/2	12x1.5	29.0	13.0	14.0	14	27	100
NC-GEV-08LR 1.8 WD	718.1171.160.20	250	1/8	14x1.5	25.5	8.5	8.0	17	14	37
NC-GEV-08LR 1.4 WD	718.1171.170.20	250	1/4	14x1.5	26.0	10.0	12.0	17	19	63
NC-GEV-08LR 3.8 WD	718.1171.180.20	250	3/8	14x1.5	27.5	12.5	12.0	17	22	59
NC-GEV-08LR 1.2 WD	718.1171.185.20	250	1/2	14x1.5	29.0	13.0	14.0	17	27	99
NC-GEV-10LR 1.8 WD	718.1171.265.20	250	1/8	16x1.5	27.5	10.5	8.0	19	17	43
NC-GEV-10LR 1.4 WD	718.1171.270.20	250	1/4	16x1.5	28.0	11.0	12.0	19	19	50
NC-GEV-10LR 3.8 WD	718.1171.280.20	250	3/8	16x1.5	29.5	12.5	12.0	19	22	64
NC-GEV-10LR 1.2 WD	718.1171.285.20	250	1/2	16x1.5	31.0	14.0	14.0	19	27	102
NC-GEV-12LR 1.8 WD	718.1171.375.20	250	1/8	18x1.5	26.0	11.5	8.0	22	19	54
NC-GEV-12LR 1.4 WD	718.1171.380.20	250	1/4	18x1.5	28.5	12.0	12.0	22	19	62
NC-GEV-12LR 3.8 WD	718.1171.390.20	250	3/8	18x1.5	29.0	12.5	12.0	22	22	70
NC-GEV-12LR 1.2 WD	718.1171.400.20	250	1/2	18x1.5	29.5	13.0	14.0	22	27	101
NC-GEV-12LR 3.4 WD	718.1171.405.20	250	3/4	18x1.5	30.5	14.0	16.0	22	32	102
NC-GEV-15LR 1.4 WD	718.1171.528.20	250	1/4	22x1.5	30.0	13.0	12.0	27	24	98
NC-GEV-15LR 3.8 WD	718.1171.532.20	250	3/8	22x1.5	30.5	13.5	12.0	27	24	102
NC-GEV-15LR 1.2 WD	718.1171.534.20	250	1/2	22x1.5	31.0	14.0	14.0	27	27	114
NC-GEV-15LR 3.4 WD	718.1171.536.20	250	3/4	22x1.5	32.0	15.0	16.0	27	32	172
NC-GEV-18LR 3.8 WD	718.1171.644.20	160	3/8	26x1.5	31.5	14.5	12.0	32	27	136
NC-GEV-18LR 1.2 WD	718.1171.646.20	160	1/2	26x1.5	31.5	14.5	14.0	32	27	142
NC-GEV-18LR 3.4 WD	718.1171.648.20	160	3/4	26x1.5	31.5	14.5	16.0	32	32	185
NC-GEV-18LR 1.1 WD	718.1171.652.20	160	1	26x1.5	35.0	17.5	18.0	32	41	254
NC-GEV-22LR 1.2 WD	718.1171.764.20	160	1/2	30x2.0	35.5	16.5	14.0	36	32	200
NC-GEV-22LR 3.4 WD	718.1171.768.20	160	3/4	30x2.0	36.0	16.5	16.0	36	32	196
NC-GEV-22LR 1.1 WD	718.1171.770.20	160	1	30x2.0	37.0	17.5	18.0	36	41	289
NC-GEV-22LR 5.4 WD	718.1171.771.20	160	1 1/4	30x2.0	38.0	18.5	20.0	36	50	382

Baumaße sind Ungefährmaße bei angezogener Überwurfmutter.

Sizes are approximate dimensiones at tightened nut.

尺寸为上紧螺母处的概略大小。

Dichtungsmaterial: FKM (andere Werkstoffe auf Anfrage)

Sealing material: FKM (other materials on request)

密封材料: FKM (其他材料可咨询)

D1=Rohr außen-Ø
M1=metrisches Anschlussgewinde

D1=tube outside diameter
M1=metric connecting thread

D1 = 管外径
M1=公制连接管螺纹

Gerade Einschraubverschraubungen

Abdichtung durch Dichtkante Form B nach ISO 1179-4

Straight male adaptor fittings

sealing edge form B acc. ISO 1179-4

英制外螺纹端直通接头总成

带符合ISO1179-4标准的金属面密封

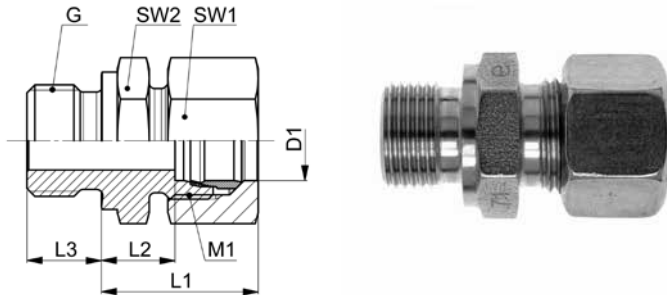

NC-GEV-..SR

Type-D1 G	Mat.-Nr.	PN	G	M1	L1	L2	L3	SW1	SW2	g/Stk
G=Rohrgewinde (zylindrisch)		G=BSP thread (parallel)			G=英制平行管螺纹标准					
NC-GEV-06SR 1.8	718.1141.100.30	500	1/8	14x1.5	28.5	12.5	8.0	17	14	40
NC-GEV-06SR 1.4	718.1141.110.30	500	1/4	14x1.5	29.0	13.0	12.0	17	19	54
NC-GEV-06SR 3.8	718.1141.120.30	500	3/8	14x1.5	31.5	15.5	12.0	17	22	63
NC-GEV-06SR 1.2	718.1141.125.30	500	1/2	14x1.5	34.0	18.0	12.0	17	27	107
NC-GEV-06SR 3.4	718.1141.126.30	500	3/4	14x1.5	36.0	20.0	12.0	17	32	152
NC-GEV-08SR 1.8	718.1141.160.30	500	1/8	16x1.5	30.5	14.5	12.0	19	17	58
NC-GEV-08SR 1.4	718.1141.170.30	500	1/4	16x1.5	31.0	15.0	12.0	19	19	63
NC-GEV-08SR 3.8	718.1141.180.30	500	3/8	16x1.5	31.5	15.5	12.0	19	22	82
NC-GEV-08SR 1.2	718.1141.185.30	500	1/2	16x1.5	34.0	18.0	14.0	19	27	108
NC-GEV-10SR 1.8	718.1141.265.30	400	1/8	18x1.5	32.5	14.0	8.0	22	19	77
NC-GEV-10SR 1.4	718.1141.270.30	400	1/4	18x1.5	33.0	14.5	12.0	22	19	73
NC-GEV-10SR 3.8	718.1141.280.30	400	3/8	18x1.5	33.5	15.0	12.0	22	22	89
NC-GEV-10SR 1.2	718.1141.285.30	400	1/2	18x1.5	36.0	17.5	14.0	22	27	125
NC-GEV-10SR 3.4	718.1141.290.30	400	3/4	18x1.5	38.0	19.5	16.0	22	32	208
NC-GEV-12SR 1.4	718.1141.380.30	400	1/4	20x1.5	35.5	16.5	12.0	24	22	91
NC-GEV-12SR 3.8	718.1141.390.30	400	3/8	20x1.5	36.0	17.0	12.0	24	22	100
NC-GEV-12SR 1.2	718.1141.400.30	400	1/2	20x1.5	36.5	17.5	14.0	24	27	135
NC-GEV-12SR 3.4	718.1141.405.30	400	3/4	20x1.5	36.5	17.5	16.0	24	32	192
NC-GEV-14SR 1.4	718.1141.500.30	300	1/4	22x1.5	36.5	16.0	12.0	27	24	118
NC-GEV-14SR 3.8	718.1141.502.30	300	3/8	22x1.5	39.0	18.5	12.0	27	24	130
NC-GEV-14SR 1.2	718.1141.504.30	300	1/2	22x1.5	39.5	19.0	14.0	27	27	154
NC-GEV-14SR 3.4	718.1141.506.30	300	3/4	22x1.5	41.5	21.0	16.0	27	32	195
NC-GEV-14SR 1.1	718.1141.510.30	300	1	22x1.5	43.5	23.0	18.0	27	41	350
NC-GEV-16SR 3.8	718.1141.564.30	200	3/8	24x1.5	39.5	18.0	12.0	30	27	156
NC-GEV-16SR 1.2	718.1141.566.30	200	1/2	24x1.5	40.0	18.5	14.0	30	27	161
NC-GEV-16SR 3.4	718.1141.568.30	200	3/4	24x1.5	42.0	20.5	16.0	30	32	240
NC-GEV-16SR 1.1	718.1141.570.30	200	1	24x1.5	44.0	22.5	18.0	30	41	359
NC-GEV-20SR 1.2	718.1141.706.30	200	1/2	30x2.0	45.5	20.5	14.0	36	32	245
NC-GEV-20SR 3.4	718.1141.708.30	200	3/4	30x2.0	45.5	20.5	16.0	36	32	277
NC-GEV-20SR 1.1	718.1141.712.30	200	1	30x2.0	47.5	22.5	18.0	36	41	387
NC-GEV-20SR 5.4	718.1141.715.30	200	1 1/4	30x2.0	47.5	22.5	20.0	36	50	574
NC-GEV-20SR 3.2	718.1141.717.30	200	1 1/2	30x2.0	50.5	25.5	22.0	36	55	778

Fortsetzung nächste Seite

Continued on next page

接下页

D1=Rohr außen-Ø
M1=metrisches Anschlussgewinde

D1=tube outside diameter
M1=metric connecting thread

D1 = 管外径
M1=公制连接管螺纹

Gerade Einschraubverschraubungen

Abdichtung durch Dichtkante Form B nach ISO 1179-4

Straight male adaptor fittings

sealing edge form B acc. ISO 1179-4

英制外螺纹端直通接头总成

带符合ISO1179-4标准的金属面密封

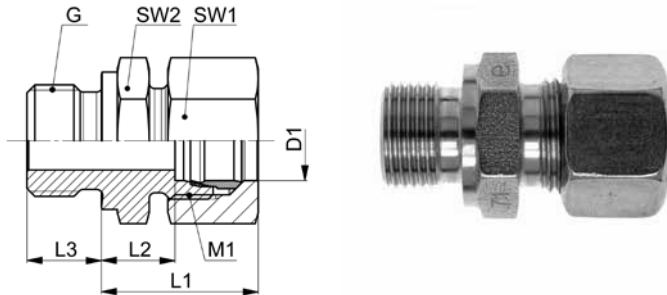

NC-GEV-..SR

Type-D1 G	Mat.-Nr.	PN	G	M1	L1	L2	L3	SW1	SW2	g/Stk
G=Rohrgewinde (zylindrisch)		G=BSP thread (parallel)				G=英制平行管螺纹标准				
NC-GEV-25SR 1.2	718.1141.800.30	100	1/2	36x2.0	47.0	20.0	14.0	46	41	444
NC-GEV-25SR 3.4	718.1141.805.30	100	3/4	36x2.0	50.0	23.0	16.0	46	41	455
NC-GEV-25SR 1.1	718.1141.810.30	100	1	36x2.0	50.0	23.0	18.0	46	41	494
NC-GEV-25SR 5.4	718.1141.815.30	100	1 1/4	36x2.0	50.0	23.0	20.0	46	50	674
NC-GEV-25SR 3.2	718.1141.820.30	100	1 1/2	36x2.0	53.0	26.0	22.0	46	55	582

Baumaße sind Ungefährmaße bei angezogener Überwurfmutter.

Sizes are approximate dimensions at tightened nut.

尺寸为上紧螺母处的概略大小。

D1=Rohr außen-Ø
M1=metrisches Anschlussgewinde

D1=tube outside diameter
M1=metric connecting thread

D1 = 管外径
M1=公制连接管螺纹

Gerade Einschraubverschraubungen

Abdichtung durch Profildichtring Form E nach ISO 1179-2

Straight male adaptor fittings

profile sealing ring form E acc. ISO 1179-2

英制外螺纹端直通接头总成

带符合ISO1179-2标准的ED圈密封

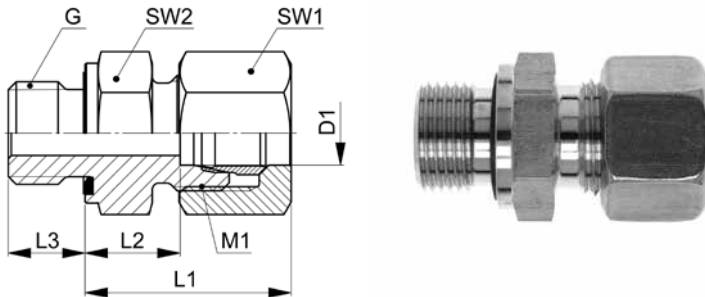

NC-GEV-..SR WD

Type-D1 G	Mat.-Nr.	PN	G	M1	L1	L2	L3	SW1	SW2	g/Stk
G=Rohrgewinde (zylindrisch)		G=BSP thread (parallel)				G=英制平行管螺纹标准				
NC-GEV-06SR 1.8 WD	718.1171.100.30	500	1/8	14x1.5	28.5	12.5	8.0	17	14	40
NC-GEV-06SR 1.4 WD	718.1171.110.30	500	1/4	14x1.5	29.0	13.0	12.0	17	19	54
NC-GEV-06SR 3.8 WD	718.1171.120.30	500	3/8	14x1.5	31.5	15.5	12.0	17	22	63
NC-GEV-06SR 1.2 WD	718.1171.125.30	500	1/2	14x1.5	34.0	18.0	14.0	17	27	107
NC-GEV-06SR 3.4 WD	718.1171.126.30	500	3/4	14x1.5	35.0	20.0	16.0	17	32	184
NC-GEV-08SR 1.8 WD	718.1171.160.30	500	1/8	16x1.5	30.5	14.5	8.0	19	17	57
NC-GEV-08SR 1.4 WD	718.1171.170.30	500	1/4	16x1.5	31.0	15.0	12.0	19	19	63
NC-GEV-08SR 3.8 WD	718.1171.180.30	500	3/8	16x1.5	31.5	15.5	12.0	19	22	82
NC-GEV-08SR 1.2 WD	718.1171.185.30	500	1/2	16x1.5	34.0	18.0	14.0	19	27	108
NC-GEV-10SR 1.8 WD	718.1171.265.30	400	1/8	18x1.5	32.5	14.0	8.0	22	19	48
NC-GEV-10SR 1.4 WD	718.1171.270.30	400	1/4	18x1.5	33.0	14.5	12.0	22	19	73
NC-GEV-10SR 3.8 WD	718.1171.280.30	400	3/8	18x1.5	34.5	15.0	12.0	22	22	89
NC-GEV-10SR 1.2 WD	718.1171.285.30	400	1/2	18x1.5	36.0	17.5	14.0	22	27	125
NC-GEV-10SR 3.4 WD	718.1171.290.30	400	3/4	18x1.5	38.0	19.5	16.0	22	32	166
NC-GEV-12SR 1.4 WD	718.1171.380.30	400	1/4	20x1.5	35.5	16.5	12.0	24	22	91
NC-GEV-12SR 3.8 WD	718.1171.390.30	400	3/8	20x1.5	36.0	17.0	12.0	24	22	100
NC-GEV-12SR 1.2 WD	718.1171.400.30	400	1/2	20x1.5	36.5	17.5	14.0	24	27	135
NC-GEV-12SR 3.4 WD	718.1171.405.30	400	3/4	20x1.5	36.5	17.5	16.0	24	32	192
NC-GEV-14SR 1.4 WD	718.1171.500.30	300	1/4	22x1.5	36.5	16.0	12.0	27	24	120
NC-GEV-14SR 3.8 WD	718.1171.502.30	300	3/8	22x1.5	39.0	18.5	12.0	27	24	130
NC-GEV-14SR 1.2 WD	718.1171.504.30	300	1/2	22x1.5	39.5	19.0	14.0	27	27	154
NC-GEV-14SR 3.4 WD	718.1171.506.30	300	3/4	22x1.5	41.5	21.0	16.0	27	32	195
NC-GEV-16SR 1.4 WD	718.1171.562.30	200	1/4	24x1.5	38.0	17.5	12.0	30	27	156
NC-GEV-16SR 3.8 WD	718.1171.564.30	200	3/8	24x1.5	39.5	18.0	12.0	30	27	156
NC-GEV-16SR 1.2 WD	718.1171.566.30	200	1/2	24x1.5	40.0	18.5	14.0	30	27	161
NC-GEV-16SR 3.4 WD	718.1171.568.30	200	3/4	24x1.5	42.0	20.5	16.0	30	32	226
NC-GEV-16SR 1.1 WD	718.1171.570.30	200	1	24x1.5	44.0	22.5	18.0	30	41	348
NC-GEV-20SR 1.2 WD	718.1171.706.30	200	1/2	30x2.0	45.5	20.5	14.0	36	32	245
NC-GEV-20SR 3.4 WD	718.1171.708.30	200	3/4	30x2.0	45.5	20.5	16.0	36	32	277
NC-GEV-20SR 1.1 WD	718.1171.712.30	200	1	30x2.0	47.5	22.5	18.0	36	41	387
NC-GEV-20SR 5.4 WD	718.1171.715.30	200	1 1/4	30x2.0	47.5	22.5	20.0	36	50	574
NC-GEV-20SR 3.2 WD	718.1171.717.30	200	1 1/2	30x2.0	50.5	25.5	22.0	36	55	782

Fortsetzung nächste Seite

Continued on next page

接下页

D1=Rohr außen-Ø
M1=metrisches Anschlussgewinde

D1=tube outside diameter
M1=metric connecting thread

D1 = 管外径
M1=公制连接管螺纹

Gerade Einschraubverschraubungen

Abdichtung durch Profildichtring Form E nach ISO 1179-2

Straight male adaptor fittings

profile sealing ring form E acc. ISO 1179-2

英制外螺纹端直通过接头总成

带符合ISO1179-2标准的ED圈密封

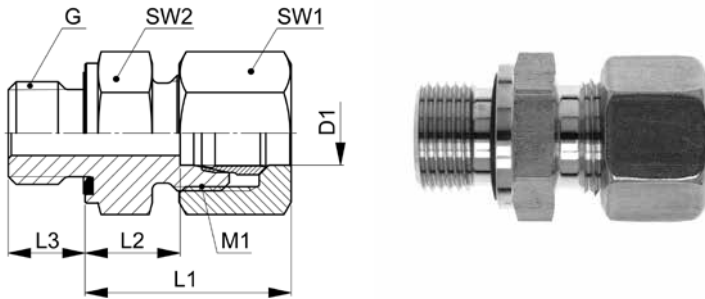

NC-GEV-..SR WD

Type-D1 G	Mat.-Nr.	PN	G	M1	L1	L2	L3	SW1	SW2	g/Stk
G=Rohrgewinde (zylindrisch)		G=BSP thread (parallel)				G=英制平行管螺纹标准				
NC-GEV-25SR 1.2 WD	718.1171.800.30	100	1/2	36x2.0	47.0	20.0	14.0	46	41	456
NC-GEV-25SR 3.4 WD	718.1171.805.30	100	3/4	36x2.0	50.0	23.0	16.0	46	41	455
NC-GEV-25SR 1.1 WD	718.1171.810.30	100	1	36x2.0	50.0	23.0	18.0	46	41	494
NC-GEV-25SR 5.4 WD	718.1171.815.30	100	1 1/4	36x2.0	50.0	23.0	20.0	46	50	674
NC-GEV-25SR 3.2 WD	718.1171.820.30	100	1 1/2	36x2.0	53.0	26.0	22.0	46	55	872

Baumaße sind Ungefährmaße bei angezogener Überwurfmutter.

Sizes are approximate dimensions at tightened nut.

尺寸为上紧螺母处的概略大小。

Dichtungsmaterial: FKM (andere Werkstoffe auf Anfrage)

Sealing material: FKM (other materials on request)

密封材料: FKM (其他材料可咨询)

D1=Rohr außen-Ø
M1=metrisches Anschlussgewinde

D1=tube outside diameter
M1=metric connecting thread

D1 = 管外径
M1=公制连接管螺纹

Gerade Einschraubverschraubungen

Abdichtung durch Dichtkante Form B nach ISO 9974-3

Straight male adaptor fittings

sealing edge form B acc. ISO 9974-3

公制外螺纹端直通接头总成

带符合ISO9974-3标准的金属面密封

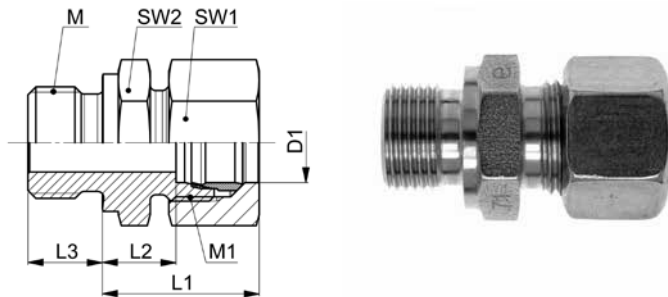

NC-GEV-..LM

Type-D1 M	Mat.-Nr.	PN	M	M1	L1	L2	L3	SW1	SW2	g/Stk
M=metrisches Gewinde (zylindrisch)	M=metric thread (parallel)	M=公制平行管螺纹标准								
NC-GEV-06LM 10x1,0	718.1143.180.20	250	10x1.0	12x1.5	24.5	8.5	8.0	14	14	27
NC-GEV-06LM 12x1,5	718.1143.190.20	250	12x1.5	12x1.5	26.0	10.0	12.0	14	17	36
NC-GEV-08LM 12x1,5	718.1143.240.20	250	12x1.5	14x1.5	26.0	10.0	12.0	17	17	39
NC-GEV-08LM 14x1,5	718.1143.245.20	250	14x1.5	14x1.5	26.0	10.0	12.0	17	19	45
NC-GEV-08LM 18x1,5	718.1143.255.20	250	18x1.5	14x1.5	27.5	11.5	12.0	17	24	71
NC-GEV-10LM 10x1,0	718.1143.270.20	250	10x1.0	16x1.5	27.5	10.5	8.0	19	17	44
NC-GEV-10LM 12x1,5	718.1143.275.20	250	12x1.5	16x1.5	28.0	11.0	12.0	19	17	46
NC-GEV-10LM 14x1,5	718.1143.280.20	250	14x1.5	16x1.5	28.0	11.0	12.0	19	19	52
NC-GEV-10LM 16x1,5	718.1143.285.20	250	16x1.5	16x1.5	29.5	12.5	12.0	19	22	66
NC-GEV-10LM 18x1,5	718.1143.288.20	250	18x1.5	16x1.5	29.5	12.5	12.0	19	24	72
NC-GEV-10LM 22x1,5	718.1143.290.20	250	22x1.5	16x1.5	30.0	14.0	14.0	19	27	86
NC-GEV-12LM 14x1,5	718.1143.327.20	250	14x1.5	18x1.5	28.5	12.0	12.0	22	19	61
NC-GEV-12LM 16x1,5	718.1143.330.20	250	16x1.5	18x1.5	29.0	12.5	12.0	22	22	67
NC-GEV-12LM 18x1,5	718.1143.333.20	250	18x1.5	18x1.5	29.0	12.5	12.0	22	24	77
NC-GEV-12LM 22x1,5	718.1143.338.20	250	22x1.5	18x1.5	30.5	14.0	14.0	22	27	107
NC-GEV-15LM 18x1,5	718.1143.390.20	250	18x1.5	22x1.5	30.5	13.5	12.0	27	24	95
NC-GEV-15LM 22x1,5	718.1143.395.20	250	22x1.5	22x1.5	32.0	15.0	14.0	27	27	121
NC-GEV-18LM 18x1,5	718.1143.455.20	160	18x1.5	26x1.5	32.0	15.0	12.0	32	27	169
NC-GEV-18LM 22x1,5	718.1143.460.20	160	22x1.5	26x1.5	31.5	14.5	14.0	32	27	143
NC-GEV-18LM 26x1,5	718.1143.465.20	160	26x1.5	26x1.5	31.5	14.5	16.0	32	32	155
NC-GEV-22LM 22x1,5	718.1143.530.20	160	22x1.5	30x2.0	38.0	18.5	14.0	36	32	204
NC-GEV-22LM 18x1,5	718.1143.525.20	160	18x1.5	30x2.0	37.5	18.0	12.0	36	32	211
NC-GEV-22LM 26x1,5	718.1143.535.20	160	26x1.5	30x2.0	35.0	16.5	16.0	36	32	191

Baumaße sind Ungefährmaße bei angezogener Überwurfmutter.

Sizes are approximate dimensions at tightened nut.

尺寸为上紧螺母处的概略大小。

D1=Rohr außen-Ø
M1=metrisches Anschlussgewinde

D1=tube outside diameter
M1=metric connecting thread

D1 = 管外径
M1=公制连接管螺纹

Gerade Einschraubverschraubungen

Abdichtung durch Profildichtring Form E nach ISO 9974-2

Straight male adaptor fittings

profile sealing ring form E acc. ISO 9974-2

公制外螺纹端直通接头总成

带符合ISO9974-2标准的ED圈密封

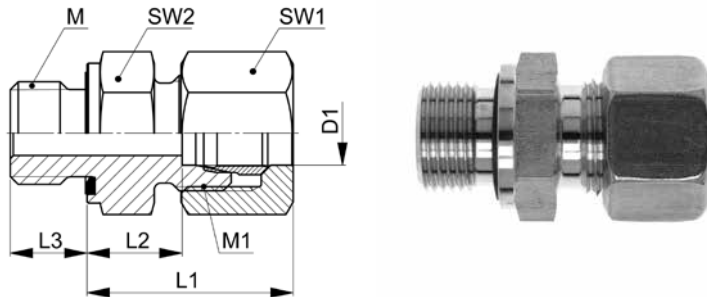

NC-GEV-..LM WD

Type-D1 M	Mat.-Nr.	PN	M	M1	L1	L2	L3	SW1	SW2	g/Stk
M=metrisches Gewinde (zylindrisch)		M=metric thread (parallel)				M=公制平行管螺纹标准				
NC-GEV-06LM 10x1,0 WD	718.1173.180.20	250	10x1.0	12x1.5	24.5	8.5	8.0	14	14	24
NC-GEV-06LM 12x1,5 WD	718.1173.190.20	250	12x1.5	12x1.5	26.0	10.0	12.0	14	17	34
NC-GEV-08LM 12x1,5 WD	718.1173.240.20	250	12x1.5	14x1.5	26.0	10.0	12.0	17	17	37
NC-GEV-08LM 14x1,5 WD	718.1173.245.20	250	14x1.5	14x1.5	26.0	10.0	12.0	17	19	45
NC-GEV-08LM 18x1,5 WD	718.1173.255.20	250	18x1.5	14x1.5	27.5	11.5	12.0	17	24	79
NC-GEV-10LM 10x1,0 WD	718.1173.270.20	250	10x1.0	16x1.5	27.5	10.5	8.0	19	17	66
NC-GEV-10LM 12x1,5 WD	718.1173.275.20	250	12x1.5	16x1.5	28.0	11.0	12.0	19	17	46
NC-GEV-10LM 14x1,5 WD	718.1173.280.20	250	14x1.5	16x1.5	28.0	11.0	12.0	19	19	50
NC-GEV-10LM 16x1,5 WD	718.1173.285.20	250	16x1.5	16x1.5	29.5	12.5	12.0	19	22	64
NC-GEV-10LM 18x1,5 WD	718.1173.288.20	250	18x1.5	16x1.5	29.5	12.5	12.0	19	24	94
NC-GEV-10LM 22x1,5 WD	718.1173.290.20	250	22x1.5	16x1.5	32.0	14.0	14.0	19	27	86
NC-GEV-12LM 12x1,5 WD	718.1173.324.20	250	12x1.5	18x1.5	28.5	12.0	12.0	22	19	60
NC-GEV-12LM 14x1,5 WD	718.1173.327.20	250	14x1.5	18x1.5	28.5	12.0	12.0	22	19	62
NC-GEV-12LM 16x1,5 WD	718.1173.330.20	250	16x1.5	18x1.5	29.0	12.5	12.0	22	22	67
NC-GEV-12LM 18x1,5 WD	718.1173.333.20	250	18x1.5	18x1.5	29.5	12.5	12.0	22	24	79
NC-GEV-12LM 22x1,5 WD	718.1173.338.20	250	22x1.5	18x1.5	30.5	14.0	14.0	22	27	117
NC-GEV-15LM 16x1,5 WD	718.1173.388.20	250	16x1.5	22x1.5	30.0	13.0	12.0	27	24	95
NC-GEV-15LM 18x1,5 WD	718.1173.390.20	250	18x1.5	22x1.5	30.5	13.5	12.0	27	24	95
NC-GEV-15LM 22x1,5 WD	718.1173.395.20	250	22x1.5	22x1.5	32.0	15.0	14.0	27	27	121
NC-GEV-18LM 18x1,5 WD	718.1173.455.20	160	18x1.5	26x1.5	32.0	13.0	12.0	32	27	143
NC-GEV-18LM 22x1,5 WD	718.1173.460.20	160	22x1.5	26x1.5	32.0	14.5	14.0	32	27	141
NC-GEV-18LM 26x1,5 WD	718.1173.465.20	160	26x1.5	26x1.5	32.0	14.5	14.0	32	32	169
NC-GEV-22LM 22x1,5 WD	718.1173.530.20	160	22x1.5	30x2.0	36.0	16.5	14.0	36	32	190
NC-GEV-22LM 26x1,5 WD	718.1173.535.20	160	26x1.5	30x2.0	36.0	16.5	16.0	36	32	189

Baumaße sind Ungefährmaße bei angezogener Überwurfmutter.

Sizes are approximate dimensions at tightened nut.

尺寸为上紧螺母处的概略大小。

Dichtungsmaterial: FKM (andere Werkstoffe auf Anfrage)

Sealing material: FKM (other materials on request)

密封材料: FKM (其他材料可咨询)

D1=Rohr außen-Ø
M1=metrisches Anschlussgewinde

D1=tube outside diameter
M1=metric connecting thread

D1 = 管外径
M1=公制连接管螺纹

Gerade Einschraubverschraubungen

Abdichtung durch Dichtkante Form B nach ISO 9974-3

Straight male adaptor fittings

sealing edge form B acc. ISO 9974-3

公制外螺纹端直通接头总成

带符合ISO9974-3标准的金属面密封

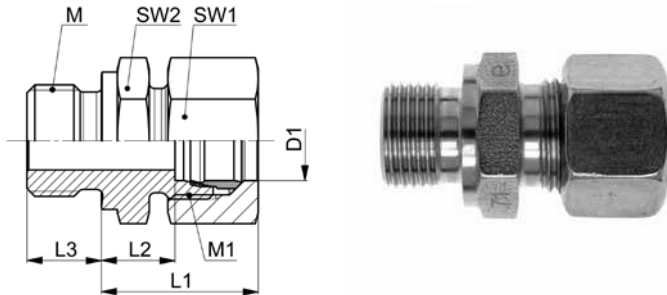

NC-GEV-..SM

Type-D1 M	Mat.-Nr.	PN	M	M1	L1	L2	L3	SW1	SW2	g/Stk
M=metrisches Gewinde (zylindrisch)		M=metric thread (parallel)				M=公制平行管螺纹标准				
NC-GEV-06SM 12x1,5	718.1143.195.30	500	12x1.5	14x1.5	29.0	13.0	12.0	17	17	48
NC-GEV-06SM 14x1,5	718.1143.198.30	500	14x1.5	14x1.5	31.0	15.0	12.0	17	19	56
NC-GEV-08SM 14x1,5	718.1143.245.30	500	14x1.5	16x1.5	31.0	15.0	12.0	19	19	64
NC-GEV-10SM 16x1,5	718.1143.285.30	400	16x1.5	18x1.5	33.5	15.0	12.0	22	22	88
NC-GEV-12SM 14x1,5	718.1143.327.30	400	14x1.5	20x1.5	35.5	15.0	12.0	24	22	97
NC-GEV-12SM 18x1,5	718.1143.333.30	400	18x1.5	20x1.5	36.0	17.0	12.0	24	24	110
NC-GEV-14SM 20x1,5	718.1143.382.30	300	20x1.5	22x1.5	39.5	19.0	14.0	27	27	150
NC-GEV-16SM 22x1,5	718.1143.410.30	200	22x1.5	24x1.5	40.0	18.5	14.0	30	27	165
NC-GEV-20SM 27x2,0	718.1143.506.30	200	27x2.0	30x2.0	45.5	20.5	16.0	36	32	265
NC-GEV-25SM 33x2,0	718.1143.550.30	100	33x2.0	36x2.0	50.0	23.0	18.0	46	41	490

Baumaße sind Ungefährmaße bei angezogener Überwurfmutter.

Sizes are approximate dimensions at tightened nut.

尺寸为上紧螺母处的概略大小。

D1=Rohr außen-Ø
M1=metrisches Anschlussgewinde

D1=tube outside diameter
M1=metric connecting thread

D1 = 管外径
M1=公制连接管螺纹

Gerade Einschraubverschraubungen

Abdichtung durch Profildichtring Form E nach ISO 9974-2

Straight male adaptor fittings

profile sealing ring form E acc. ISO 9974-2

公制外螺纹端直通接头总成

带符合ISO9974-2标准的ED圈密封

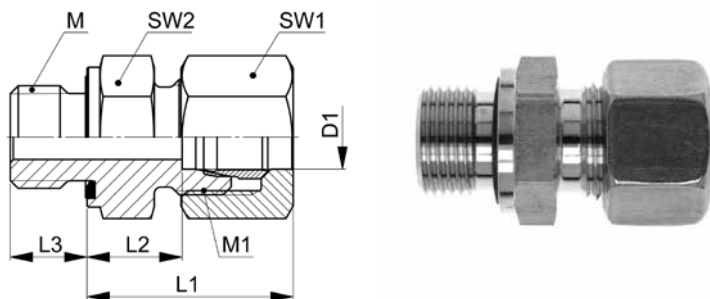

NC-GEV-..SM WD

Type-D1 M	Mat.-Nr.	PN	M	M1	L1	L2	L3	SW1	SW2	g/Stk
M=metrisches Gewinde (zylindrisch)		M=metric thread (parallel)				M=公制平行管螺纹标准				
NC-GEV-06SM 12x1,5 WD	718.1173.195.30	500	12x1.5	14x1.5	29.0	13.0	12.0	17	17	48
NC-GEV-06SM 14x1,5 WD	718.1173.198.30	500	14x1.5	14x1.5	31.0	15.0	12.0	17	19	58
NC-GEV-08SM 14x1,5 WD	718.1173.245.30	500	14x1.5	16x1.5	31.0	15.0	12.0	19	19	62
NC-GEV-10SM 16x1,5 WD	718.1173.285.30	400	16x1.5	18x1.5	33.5	15.0	12.0	22	22	88
NC-GEV-12SM 14x1,5 WD	718.1173.327.30	400	14x1.5	20x1.5	35.5	16.5	12.0	24	22	90
NC-GEV-12SM 18x1,5 WD	718.1173.333.30	400	18x1.5	20x1.5	36.0	17.0	12.0	24	24	110
NC-GEV-14SM 20x1,5 WD	718.1173.382.30	300	20x1.5	22x1.5	39.5	19.0	14.0	27	27	150
NC-GEV-16SM 22x1,5 WD	718.1173.410.30	200	22x1.5	24x1.5	40.0	18.5	14.0	30	27	165
NC-GEV-20SM 27x2,0 WD	718.1173.506.30	200	27x2.0	30x2.0	45.5	20.5	16.0	36	32	265
NC-GEV-25SM 33x2,0 WD	718.1173.550.30	100	33x2.0	36x2.0	50.0	23.0	18.0	46	41	490

Baumaße sind Ungefährmaße bei angezogener Überwurfmutter.

Sizes are approximate dimensiones at tightened nut.

尺寸为上紧螺母处的概略大小。

Dichtungsmaterial: FKM (andere Werkstoffe auf Anfrage)

Sealing material: FKM (other materials on request)

密封材料: FKM (其他材料可咨询)

Gerade Einschraubverschraubungen

Abdichtung durch Kegeligwinde Form C nach DIN 3852-2

Straight male adaptor fittings

taper thread sealing form C acc. DIN 3852-2

英制锥螺纹端直通接头总成
带符合DIN3852-2标准的圆锥螺纹C型密封

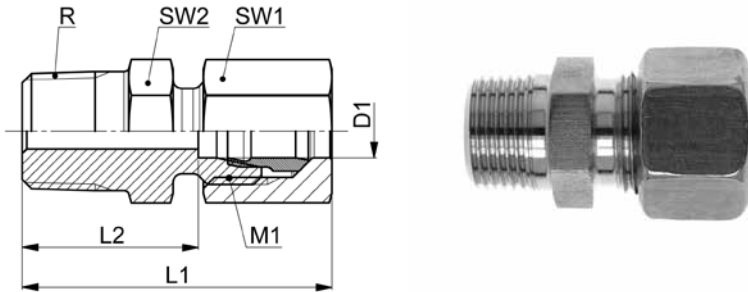

NC-GEV-..LRK

Type-D1 R	Mat.-Nr.	PN	R	M1	L1	L2	SW1	SW2	g/Stk
R=Rohrgewinde (kegelig)		R=BSP thread (tapered)				R=英制锥形管螺纹标准			
NC-GEV-06LRK 1.8	718.1101.100.20	250	1/8	12x1.5	32.0	16.0	14	12	28
NC-GEV-06LRK 1.4	718.1101.110.20	250	1/4	12x1.5	36.0	20.0	14	14	27
NC-GEV-06LRK 3.8	718.1101.120.20	250	3/8	12x1.5	35.0	19.0	14	19	34
NC-GEV-06LRK 1.2	718.1101.125.20	250	1/2	12x1.5	37.0	21.0	14	22	60
NC-GEV-08LRK 1.8	718.1101.160.20	250	1/8	14x1.5	32.0	16.0	17	14	32
NC-GEV-08LRK 1.4	718.1101.170.20	250	1/4	14x1.5	36.0	20.0	17	17	40
NC-GEV-08LRK 3.8	718.1101.180.20	250	3/8	14x1.5	36.0	20.0	17	19	46
NC-GEV-08LRK 1.2	718.1101.185.20	250	1/2	14x1.5	38.0	22.0	17	22	60
NC-GEV-10LRK 1.8	718.1101.265.20	250	1/8	16x1.5	34.5	17.0	19	17	38
NC-GEV-10LRK 1.4	718.1101.270.20	250	1/4	16x1.5	38.5	21.0	19	17	44
NC-GEV-10LRK 3.8	718.1101.280.20	250	3/8	16x1.5	38.5	21.0	19	17	57
NC-GEV-10LRK 1.2	718.1101.285.20	250	1/2	16x1.5	40.5	23.0	19	22	70
NC-GEV-12LRK 1.4	718.1101.380.20	250	1/4	18x1.5	39.0	22.0	27	19	58
NC-GEV-12LRK 3.8	718.1101.390.20	250	3/8	18x1.5	39.0	22.0	22	19	62
NC-GEV-12LRK 1.2	718.1101.400.20	250	1/2	18x1.5	41.5	24.5	22	22	80
NC-GEV-15LRK 3.8	718.1101.532.20	250	3/8	22x1.5	41.0	23.0	27	24	94
NC-GEV-15LRK 1.2	718.1101.534.20	250	1/2	22x1.5	43.0	25.0	27	24	105
NC-GEV-18LRK 1.2	718.1101.646.20	160	1/2	26x1.5	43.0	25.5	32	27	145
NC-GEV-18LRK 3.4	718.1101.648.20	160	3/4	26x1.5	45.0	27.5	32	27	162
NC-GEV-22LRK 1.2	718.1101.764.20	160	1/2	30x2.0	47.5	27.5	36	32	188
NC-GEV-22LRK 3.4	718.1101.768.20	160	3/4	30x2.0	49.5	29.5	36	32	192

Druckangaben gelten in Verbindung mit zylindrischem Innengewinde.

Pressure information applies in connection with parallel female thread.

压力等级取决于与之连接的平行管内螺纹。

Baumaße sind Ungefährmaße bei angezogener Überwurfmutter.

Sizes are approximate dimensions at tightened nut.

尺寸为上紧螺母处的概略大小。

D1=Rohraußen-Ø
M1=metrisches Anschlussgewinde

D1=tube outside diameter
M1=metric connecting thread

D1 = 管外径
M1=公制连接管螺纹

Gerade Einschraubverschraubungen

Abdichtung durch Kegelfwinde Form C nach DIN 3852-1

Straight male adaptor fittings

taper thread sealing form C acc. DIN 3852-1

公制锥螺纹端直通接头总成
带符合DIN3852-1标准的圆锥螺纹C型密封

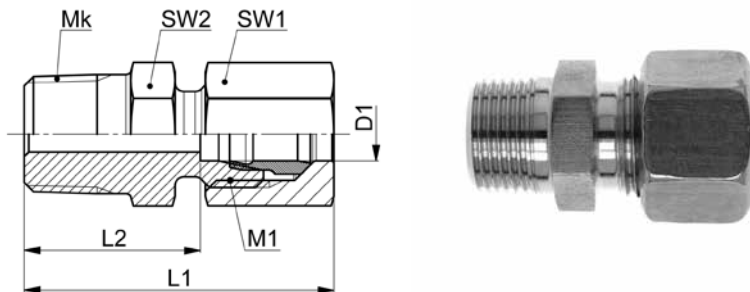

NC-GEV-..LMK

Type-D1 Mk	Mat.-Nr.	PN	Mk	M1	L1	L2	SW1	SW2	g/Stk
Mk=metrisches Gewinde (kegelig)		Mk=metric thread (tapered)				Mk=公制锥螺纹标准			
NC-GEV-06LMK 08x1,0	718.1103.170.20	250	08x1.0	12x1.5	31.0	16.0	14	12	22
NC-GEV-06LMK 10x1,0	718.1103.180.20	250	10x1.0	12x1.5	32.0	16.0	14	14	26
NC-GEV-06LMK 12x1,5	718.1103.195.20	250	12x1.5	12x1.5	36.0	20.0	14	14	32
NC-GEV-08LMK 12x1,5	718.1103.240.20	250	12x1.5	14x1.5	36.0	20.0	17	14	35
NC-GEV-08LMK 14x1,5	718.1103.245.20	250	14x1.5	14x1.5	36.0	20.0	17	17	39
NC-GEV-10LMK 14x1,5	718.1103.280.20	250	14x1.5	16x1.5	38.0	21.0	19	17	46
NC-GEV-10LMK 16x1,5	718.1103.285.20	250	16x1.5	16x1.5	38.0	21.0	19	17	50
NC-GEV-12LMK 16x1,5	718.1103.330.20	250	16x1.5	18x1.5	38.5	22.0	22	19	59
NC-GEV-12LMK 18x1,5	718.1103.333.20	250	18x1.5	18x1.5	38.5	22.0	22	19	77
NC-GEV-15LMK 18x1,5	718.1103.390.20	250	18x1.5	22x1.5	40.0	23.0	27	24	91
NC-GEV-18LMK 22x1,5	718.1103.460.20	160	22x1.5	26x1.5	42.5	25.5	32	27	156

Druckangaben gelten in Verbindung mit zylindrischem Innengewinde.

Pressure information applies in connection with parallel female thread.

压力等级取决于与之连接的平行管内螺纹。

Baumaße sind Ungefährmaße bei angezogener Überwurfmutter.

Sizes are approximate dimensions at tightened nut.

尺寸为上紧螺母处的概略大小。

Gerade Einschraubverschraubungen NPT
Straight male adaptor fittings NPT
 美制锥形外螺纹端直通接头总成

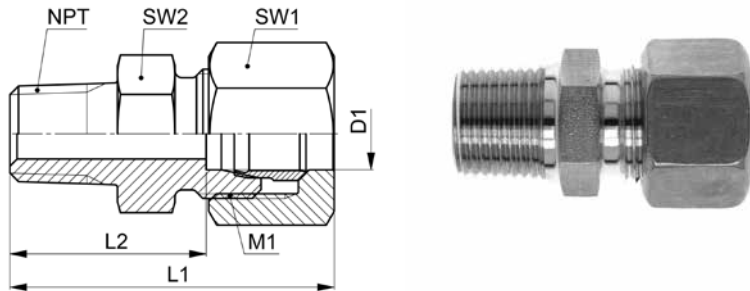

NC-GEV-..LNPT

Type-D1 NPT	Mat.-Nr.	PN	NPT	M1	L1	L2	SW1	SW2	g/Stk
NPT=Einschraubgewinde NPT NPT=tapered male adaptor thread NPT NPT=美制一般用途圆锥管螺纹标准									
NC-GEV-06LNPT 1.8	718.1102.100.20	250	1/8	12x1.5	33.0	17.0	14	12	25
NC-GEV-06LNPT 1.4	718.1102.110.20	250	1/4	12x1.5	39.0	23.0	14	17	42
NC-GEV-06LNPT 3.8	718.1102.120.20	250	3/8	12x1.5	40.0	24.0	14	19	51
NC-GEV-06LNPT 1.2	718.1102.125.20	250	1/2	12x1.5	45.0	29.0	14	22	82
NC-GEV-08LNPT 1.8	718.1102.160.20	250	1/8	14x1.5	34.0	18.0	17	14	37
NC-GEV-08LNPT 1.4	718.1102.170.20	250	1/4	14x1.5	39.0	23.0	17	17	43
NC-GEV-08LNPT 3.8	718.1102.180.20	250	3/8	14x1.5	40.0	24.0	17	19	60
NC-GEV-08LNPT 1.2	718.1102.185.20	250	1/2	14x1.5	45.0	29.0	17	22	85
NC-GEV-10LNPT 1.8	718.1102.265.20	250	1/8	16x1.5	36.0	19.0	19	17	40
NC-GEV-10LNPT 1.4	718.1102.270.20	250	1/4	16x1.5	41.0	24.0	19	17	55
NC-GEV-10LNPT 3.8	718.1102.280.20	250	3/8	16x1.5	42.0	25.0	19	19	65
NC-GEV-10LNPT 1.2	718.1102.285.20	250	1/2	16x1.5	47.0	30.0	19	22	85
NC-GEV-10LNPT 3.4	718.1102.290.20	250	3/4	16x1.5	48.0	31.0	19	27	120
NC-GEV-12LNPT 1.8	718.1102.375.20	250	1/8	18x1.5	36.5	20.0	22	19	56
NC-GEV-12LNPT 1.4	718.1102.380.20	250	1/4	18x1.5	41.5	25.0	22	19	59
NC-GEV-12LNPT 3.8	718.1102.390.20	250	3/8	18x1.5	41.5	25.0	22	19	66
NC-GEV-12LNPT 1.2	718.1102.400.20	250	1/2	18x1.5	46.5	30.0	22	22	89
NC-GEV-12LNPT 3.4	718.1102.405.20	250	3/4	18x1.5	47.5	31.0	22	27	134
NC-GEV-15LNPT 1.4	718.1102.528.20	250	1/4	22x1.5	43.0	26.0	27	24	90
NC-GEV-15LNPT 3.8	718.1102.532.20	250	3/8	22x1.5	43.0	26.0	27	24	96
NC-GEV-15LNPT 1.2	718.1102.534.20	250	1/2	22x1.5	48.0	31.0	27	24	115
NC-GEV-15LNPT 3.4	718.1102.536.20	250	3/4	22x1.5	49.0	32.0	27	27	154
NC-GEV-15LNPT 1.1	718.1102.541.20	250	1	22x1.5	55.0	38.0	27	36	178
NC-GEV-18LNPT 3.8	718.1102.644.20	160	3/8	26x1.5	43.5	26.5	32	27	138
NC-GEV-18LNPT 1.2	718.1102.646.20	160	1/2	26x1.5	48.5	31.5	32	27	135
NC-GEV-18LNPT 3.4	718.1102.648.20	160	3/4	26x1.5	48.5	31.5	32	27	170
NC-GEV-18LNPT 1.1	718.1102.652.20	160	1	26x1.5	54.5	37.5	32	36	262
NC-GEV-22LNPT 3.8	718.1102.763.20	160	3/8	30x2.0	48.0	28.5	36	32	200
NC-GEV-22LNPT 1.2	718.1102.764.20	160	1/2	30x2.0	53.0	33.5	36	32	194
NC-GEV-22LNPT 3.4	718.1102.768.20	160	3/4	30x2.0	53.0	33.5	36	32	196
NC-GEV-22LNPT 1.1	718.1102.770.20	160	1	30x2.0	59.0	39.5	36	36	282

Baumaße sind Ungefährmaße bei angezogener Überwurfmutter.

Sizes are approximate dimensions at tightened nut.

尺寸为上紧螺母处的概略大小。

D1=Rohr außen-Ø
 M1=metrisches Anschlussgewinde

D1=tube outside diameter
 M1=metric connecting thread

D1 = 管外径
 M1=公制连接管螺纹

Gerade Einschraubverschraubungen NPT
Straight male adaptor fittings NPT
 美制锥形外螺纹端直通接头总成

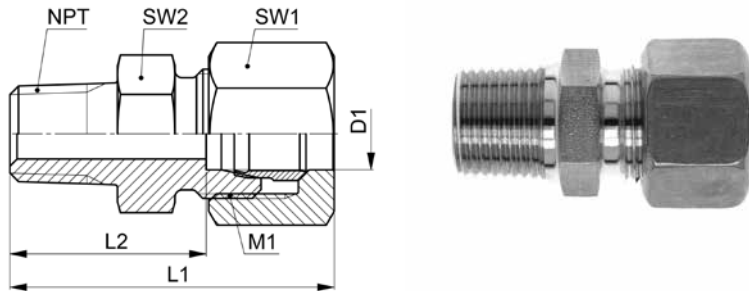

NC-GEV-..SNPT

Type-D1 NPT	Mat.-Nr.	PN	NPT	M1	L1	L2	SW1	SW2	g/Stk
NPT=Einschraubgewinde NPT NPT=tapered male adaptor thread NPT NPT=美制一般用途圆锥管螺纹标准									
NC-GEV-06SNPT 1.8	718.1102.100.30	500	1/8	14x1.5	36.0	21.0	17	14	45
NC-GEV-06SNPT 1.4	718.1102.110.30	500	1/4	14x1.5	44.0	28.0	17	17	55
NC-GEV-06SNPT 3.8	718.1102.120.30	500	3/8	14x1.5	44.0	28.0	17	19	70
NC-GEV-06SNPT 1.2	718.1102.125.30	500	1/2	14x1.5	51.0	35.0	17	22	93
NC-GEV-08SNPT 1.8	718.1102.160.30	500	1/8	16x1.5	39.0	23.0	19	17	48
NC-GEV-08SNPT 1.4	718.1102.170.30	500	1/4	16x1.5	44.0	28.0	19	17	60
NC-GEV-08SNPT 3.8	718.1102.180.30	500	3/8	16x1.5	44.0	28.0	19	19	74
NC-GEV-08SNPT 1.2	718.1102.185.30	500	1/2	16x1.5	51.0	35.0	19	22	108
NC-GEV-10SNPT 1.4	718.1102.270.30	400	1/4	18x1.5	46.0	27.5	22	19	71
NC-GEV-10SNPT 3.8	718.1102.280.30	400	3/8	18x1.5	46.0	27.5	22	19	86
NC-GEV-10SNPT 1.2	718.1102.285.30	400	1/2	18x1.5	53.0	34.5	22	22	104
NC-GEV-10SNPT 3.4	718.1102.290.30	400	3/4	18x1.5	53.0	34.5	22	27	154
NC-GEV-12SNPT 1.4	718.1102.380.30	400	1/4	20x1.5	48.5	29.5	24	22	96
NC-GEV-12SNPT 3.8	718.1102.390.30	400	3/8	20x1.5	48.5	29.5	24	22	100
NC-GEV-12SNPT 1.2	718.1102.400.30	400	1/2	20x1.5	53.5	34.5	24	22	121
NC-GEV-12SNPT 3.4	718.1102.405.30	400	3/4	20x1.5	53.5	34.5	24	27	170
NC-GEV-14SNPT 3.8	718.1102.502.30	300	3/8	22x1.5	51.5	31.0	27	24	125
NC-GEV-14SNPT 1.2	718.1102.504.30	300	1/2	22x1.5	56.5	36.0	27	24	160
NC-GEV-14SNPT 3.4	718.1102.506.30	300	3/4	22x1.5	56.5	36.0	27	27	180
NC-GEV-14SNPT 1.1	718.1102.510.30	300	1	22x1.5	63.5	43.0	27	36	230
NC-GEV-16SNPT 3.8	718.1102.564.30	200	3/8	24x1.5	52.0	30.5	30	27	152
NC-GEV-16SNPT 1.2	718.1102.566.30	200	1/2	24x1.5	57.0	35.5	30	27	170
NC-GEV-16SNPT 3.4	718.1102.568.30	200	3/4	24x1.5	57.0	35.5	30	27	196
NC-GEV-16SNPT 1.1	718.1102.570.30	200	1	24x1.5	64.0	42.5	30	36	324
NC-GEV-20SNPT 1.2	718.1102.706.30	200	1/2	30x2.0	62.5	37.5	36	32	246
NC-GEV-20SNPT 3.4	718.1102.708.30	200	3/4	30x2.0	62.5	37.5	36	32	268
NC-GEV-20SNPT 1.1	718.1102.712.30	200	1	30x2.0	67.5	42.5	36	36	360
NC-GEV-25SNPT 1.2	718.1102.800.30	100	1/2	36x2.0	67.5	40.0	46	41	421
NC-GEV-25SNPT 3.4	718.1102.805.30	100	3/4	36x2.0	67.0	40.0	46	41	474
NC-GEV-25SNPT 1.1	718.1102.810.30	100	1	36x2.0	72.0	45.0	46	41	503
NC-GEV-25SNPT 5.4	718.1102.815.30	100	1 1/4	36x2.0	73.0	46.0	46	46	654
NC-GEV-25SNPT 3.2	718.1102.820.30	100	1 1/2	36x2.0	73.0	46.0	46	50	714

Baumaße sind Ungefährmaße bei angezogener Überwurfmutter.

Sizes are approximate dimensions at tightened nut.

尺寸为上紧螺母处的概略大小。

D1=Rohr außen-Ø
 M1=metrisches Anschlussgewinde

D1=tube outside diameter
 M1=metric connecting thread

D1 = 管外径
 M1=公制连接管螺纹

Winkel-Einschraubverschraubungen

Abdichtung durch Dichtkante Form B nach ISO 1179-4

Male adaptor elbow fittings

sealing edge form B acc. ISO 1179-4

英制外螺纹直角弯通接头总成

带符合ISO1179-4标准的金属面密封

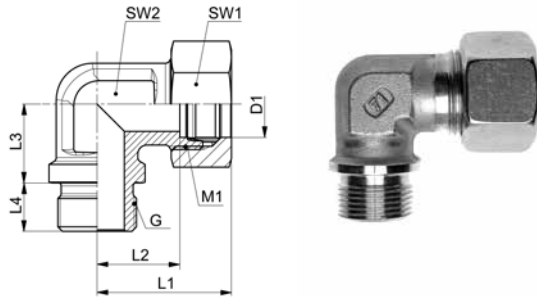

30

NC-WEV-..LR/SR

Type-D1 G	Mat.-Nr.	PN	G	M1	L1	L2	L3	L4	SW1	SW2	g/Stk
G=Rohrgewinde (zylindrisch)		G=BSP thread (parallel)									
			G=英制平行管螺纹标准								
NC-WEV-22LR 3.4	718.2406.768.20	160	3/4	30x2.0	47.0	27.5	26.0	16.0	36	27	267
NC-WEV-20SR 3.4	718.2406.704.30	200	3/4	30x2.0	51.5	26.5	26.0	16.0	36	27	329
NC-WEV-25SR 1.1	718.2406.810.30	100	1	36x2.0	57.0	30.0	30.0	18.0	46	36	631

Baumaße sind Ungefährmaße bei angezogener Überwurfmutter.

Sizes are approximate dimensions at tightened nut.

尺寸为上紧螺母处的概略大小。

D1=Rohr außen-Ø
M1=metrisches Anschlussgewinde

D1=tube outside diameter
M1=metric connecting thread

D1 = 管外径
M1=公制连接管螺纹

Winkel-Einschraubverschraubungen

Abdichtung im Kegelgewinde Form C nach DIN 3852-2

Male adaptor elbow fittings

taper thread sealing form C acc. DIN 3852-2

英制锥形外螺纹直角弯通接头总成

带符合DIN3852-2标准的圆锥螺纹C型密封

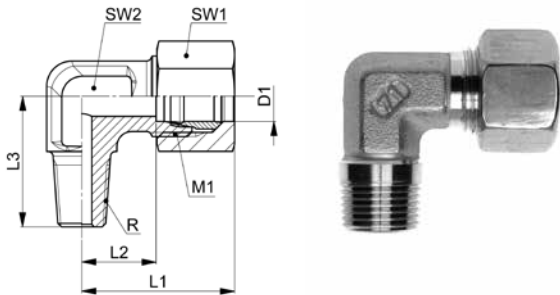

NC-WEV-..LRK

Type-D1 R	Mat.-Nr.	PN	R	M1	L1	L2	L3	SW1	SW2	g/Stk
R=Rohrgewinde (kegelig)		R=BSP thread (tapered)								
										R=英制锥形管螺纹标准
NC-WEV-06LRK 1.8	718.2401.100.20	250	1/8	12x1.5	28.0	12.0	20.0	14	12	34
NC-WEV-06LRK 1.4	718.2401.110.20	250	1/4	12x1.5	28.0	12.0	26.0	14	12	57
NC-WEV-06LRK 3.8	718.2401.120.20	250	3/8	12x1.5	30.0	14.0	28.0	14	14	58
NC-WEV-08LRK 1.8	718.2401.160.20	250	1/8	14x1.5	30.0	14.0	26.0	17	12	53
NC-WEV-08LRK 1.4	718.2401.170.20	250	1/4	14x1.5	30.0	14.0	26.0	17	12	60
NC-WEV-08LRK 3.8	718.2401.180.20	250	3/8	14x1.5	31.0	15.0	27.0	17	14	82
NC-WEV-08LRK 1.2	718.2401.185.20	250	1/2	14x1.5	35.0	19.0	30.0	17	17	95
NC-WEV-10LRK 1.8	718.2401.265.20	250	1/8	16x1.5	32.5	15.0	26.0	19	14	64
NC-WEV-10LRK 1.4	718.2401.270.20	250	1/4	16x1.5	32.5	15.0	27.0	19	14	66
NC-WEV-10LRK 3.8	718.2401.280.20	250	3/8	16x1.5	32.5	15.0	27.0	19	14	70
NC-WEV-10LRK 1.2	718.2401.285.20	250	1/2	16x1.5	38.5	21.0	32.0	19	19	90
NC-WEV-12LRK 1.4	718.2401.380.20	250	1/4	18x1.5	34.0	17.0	28.0	22	17	74
NC-WEV-12LRK 3.8	718.2401.390.20	250	3/8	18x1.5	34.0	17.0	28.0	22	17	75
NC-WEV-12LRK 1.2	718.2401.400.20	250	1/2	18x1.5	38.0	21.0	32.0	22	19	110
NC-WEV-15LRK 3.8	718.2401.532.20	250	3/8	22x1.5	39.0	21.0	28.0	27	19	134
NC-WEV-15LRK 1.2	718.2401.534.20	250	1/2	22x1.5	39.5	21.0	34.0	27	19	216
NC-WEV-18LRK 1.2	718.2401.646.20	160	1/2	26x1.5	41.0	23.5	36.0	32	24	273
NC-WEV-18LRK 3.4	718.2401.648.20	160	3/4	26x1.5	41.0	23.5	34.0	32	24	233
NC-WEV-22LRK 3.4	718.2401.768.20	160	3/4	30x2.0	47.5	27.5	42.0	36	27	295

Druckangaben gelten in Verbindung mit zylindrischem Innengewinde.

Pressure information applies in connection with parallel female thread.

压力等级取决于与之连接的平行管内螺纹。

Baumaße sind Ungefährmaße bei angezogener Überwurfmutter.

Sizes are approximate dimensions at tightened nut.

尺寸为上紧螺母处的概略大小。

D1=Rohr außen-Ø
M1=metrisches Anschlussgewinde

D1=tube outside diameter
M1=metric connecting thread

D1 = 管外径
M1=公制连接管螺纹

Winkel-Einschraubverschraubungen

Abdichtung im Kegelfgewinde Form C nach DIN 3852-2

Male adaptor elbow fittings

taper thread sealing form C acc. DIN 3852-2

英制锥形外螺纹直角弯通接头总成

带符合DIN3852-2标准的圆锥螺纹C型密封

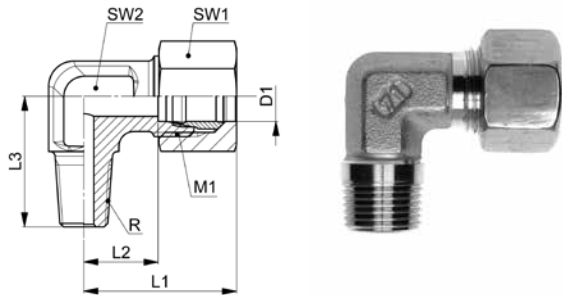

NC-WEV-..SRK

Type-D1 R	Mat.-Nr.	PN	R	M1	L1	L2	L3	SW1	SW2	g/Stk
R=Rohrgewinde (kegelig)		R=BSP thread (tapered)								
										R=英制锥形管螺纹标准
NC-WEV-06SRK 1.8	718.2401.100.30	500	1/8	14x1.5	32.0	16.0	26.0	17	12	59
NC-WEV-06SRK 1.4	718.2401.110.30	500	1/4	14x1.5	32.0	16.0	26.0	17	12	61
NC-WEV-06SRK 3.8	718.2401.120.30	500	3/8	14x1.5	32.0	16.0	28.0	17	14	80
NC-WEV-06SRK 1.2	718.2401.125.30	500	1/2	14x1.5	32.0	16.0	30.0	17	17	101
NC-WEV-08SRK 1.4	718.2401.170.30	500	1/4	16x1.5	33.0	17.0	27.0	19	14	79
NC-WEV-08SRK 3.8	718.2401.180.30	500	3/8	16x1.5	33.0	17.0	27.0	19	14	85
NC-WEV-08SRK 1.2	718.2401.185.30	500	1/2	16x1.5	35.0	19.0	30.0	19	17	102
NC-WEV-10SRK 1.4	718.2401.270.30	400	1/4	18x1.5	36.5	17.5	27.0	22	17	92
NC-WEV-10SRK 3.8	718.2401.280.30	400	3/8	18x1.5	36.5	17.5	28.0	22	17	95
NC-WEV-10SRK 1.2	718.2401.285.30	400	1/2	18x1.5	36.5	17.5	32.0	22	17	131
NC-WEV-12SRK 3.8	718.2401.390.30	400	3/8	20x1.5	41.0	21.5	28.0	24	17	115
NC-WEV-12SRK 1.2	718.2401.400.30	400	1/2	20x1.5	41.0	21.5	32.0	24	17	130
NC-WEV-14SRK 3.8	718.2401.502.30	300	3/8	22x1.5	43.0	22.0	32.0	27	19	147
NC-WEV-14SRK 1.2	718.2401.504.30	300	1/2	22x1.5	43.0	22.0	32.0	27	19	158
NC-WEV-16SRK 1.2	718.2401.566.30	200	1/2	24x1.5	47.0	24.5	32.0	30	24	200

Druckangaben gelten in Verbindung mit zylindrischem Innengewinde.

Pressure information applies in connection with parallel female thread.

压力等级取决于与之连接的平行管内螺纹。

Baumaße sind Ungefährmaße bei angezogener Überwurfmutter.

Sizes are approximate dimensions at tightened nut.

尺寸为上紧螺母处的概略大小。

D1=Rohr außen-Ø
M1=metrisches Anschlussgewinde

D1=tube outside diameter
M1=metric connecting thread

D1 = 管外径
M1=公制连接管螺纹

Winkel-Einschraubverschraubungen

Abdichtung im Kegeltgewinde Form C nach DIN 3852-1

Male adaptor elbow fittings

taper thread sealing form C acc. DIN 3852-1

公制锥形外螺纹直角弯通接头总成

带符合DIN3852-1标准的圆锥螺纹C型密封

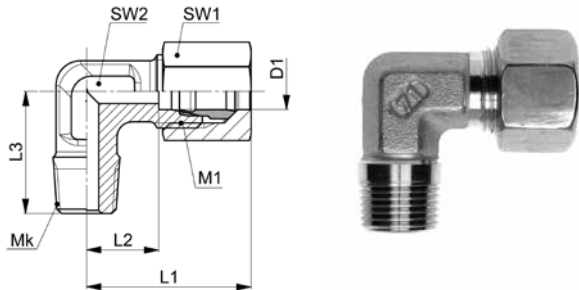

NC-WEV-..LMK/SMK

Type-D1 Mk	Mat.-Nr.	PN	Mk	M1	L1	L2	L3	SW1	SW2	g/Stk
Mk=metrisches Gewinde (kegelig)	Mk=metric thread (tapered)									
										Mk=公制锥螺纹标准
NC-WEV-06LMK 10x1,0	718.2403.180.20	250	10x1.0	12x1.5	28.0	12.0	20.0	14	12	32
NC-WEV-08LMK 12x1,5	718.2403.240.20	250	10x1.0	14x1.5	30.0	14.0	26.0	17	12	43
NC-WEV-10LMK 14x1,5	718.2403.278.20	250	14x1.5	16x1.5	32.5	15.0	27.0	19	14	61
NC-WEV-12LMK 16x1,5	718.2403.330.20	250	16x1.5	18x1.5	34.0	17.0	28.0	22	17	80
NC-WEV-15LMK 18x1,5	718.2403.390.20	250	18x1.5	22x1.5	39.0	21.0	32.0	27	19	136
NC-WEV-18LMK 22x1,5	718.2403.460.20	160	22x1.5	26x1.5	41.0	23.5	36.0	32	24	188
NC-WEV-06SMK 12x1,5	718.2403.190.30	500	12x1.5	14x1.5	32.0	16.0	26.0	17	12	55
NC-WEV-08SMK 14x1,5	718.2403.245.30	500	14x1.5	16x1.5	33.0	17.0	27.0	19	14	70
NC-WEV-10SMK 16x1,5	718.2403.285.30	400	16x1.5	18x1.5	36.5	17.5	28.0	22	17	98
NC-WEV-12SMK 18x1,5	718.2403.333.30	400	18x1.5	20x1.5	41.0	21.5	28.0	24	17	118
NC-WEV-14SMK 20x1,5	718.2403.382.30	300	20x1.5	22x1.5	43.0	22.0	32.0	27	19	154

Druckangaben gelten in Verbindung mit zylindrischem Innengewinde.

Pressure information applies in connection with parallel female thread.

压力等级取决于与之连接的平行管内螺纹。

Baumaße sind Ungefährmaße bei angezogener Überwurfmutter.

Sizes are approximate dimensions at tightened nut.

尺寸为上紧螺母处的概略大小。

Winkel-Einschraubverschraubungen NPT

Male adaptor elbow fittings NPT

美制锥形外螺纹直角弯通接头总成

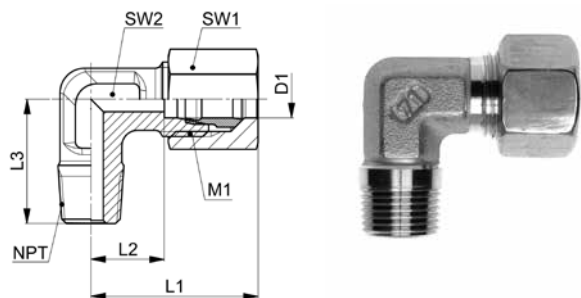

NC-WEV-..LNPT

Type-D1 NPT	Mat.-Nr.	PN	NPT	M1	L1	L2	L3	SW1	SW2	g/Stk
NPT=Einschraubgewinde NPT		NPT=tapered male adaptor thread NPT			NPT=美制一般用途圆锥管螺纹标准					
NC-WEV-06LNPT 1.8	718.2402.100.20	250	1/8	12x1.5	28.0	12.0	20.0	14	12	32
NC-WEV-06LNPT 1.4	718.2402.110.20	250	1/4	12x1.5	26.0	12.0	26.0	14	12	36
NC-WEV-06LNPT 3.8	718.2402.120.20	250	3/8	12x1.5	30.0	14.0	28.0	14	14	52
NC-WEV-08LNPT 1.8	718.2402.160.20	250	1/8	14x1.5	30.0	14.0	24.0	17	12	42
NC-WEV-08LNPT 1.4	718.2402.170.20	250	1/4	14x1.5	30.0	14.0	26.0	17	12	44
NC-WEV-08LNPT 3.8	718.2402.180.20	250	3/8	14x1.5	31.0	15.0	28.0	17	14	71
NC-WEV-08LNPT 1.2	718.2402.185.20	250	1/2	14x1.5	35.0	19.0	34.0	17	17	104
NC-WEV-10LNPT 1.4	718.2402.270.20	250	1/4	16x1.5	32.0	15.0	26.0	19	14	56
NC-WEV-10LNPT 3.8	718.2402.280.20	250	3/8	16x1.5	32.0	15.0	28.0	19	14	60
NC-WEV-10LNPT 1.2	718.2402.285.20	250	1/2	16x1.5	38.5	21.0	30.0	19	17	100
NC-WEV-12LNPT 1.4	718.2402.380.20	250	1/4	18x1.5	33.5	17.0	26.0	22	17	76
NC-WEV-12LNPT 3.8	718.2402.390.20	250	3/8	18x1.5	33.5	17.0	28.0	22	17	76
NC-WEV-12LNPT 1.2	718.2402.400.20	250	1/2	18x1.5	38.0	21.0	34.0	22	17	118
NC-WEV-15LNPT 1.2	718.2402.534.20	250	1/2	22x1.5	38.0	21.0	34.0	27	19	138
NC-WEV-18LNPT 1.2	718.2402.646.20	160	1/2	26x1.5	40.5	23.5	36.0	32	24	184
NC-WEV-18LNPT 3.4	718.2402.648.20	160	3/4	26x1.5	40.5	23.5	36.0	32	24	200
NC-WEV-22LNPT 3.4	718.2402.768.20	160	3/4	30x2.0	47.0	27.5	42.0	36	27	252

Baumaße sind Ungefährmaße bei angezogener Überwurfmutter.

Sizes are approximate dimensions at tightened nut.

尺寸为上紧螺母处的概略大小。

D1=Rohr außen-Ø
M1=metrisches Anschlussgewinde

D1=tube outside diameter
M1=metric connecting thread

D1 = 管外径
M1=公制连接管螺纹

Winkel-Einschraubverschraubungen NPT
Male adaptor elbow fittings NPT
 美制锥形外螺纹直角弯通接头总成

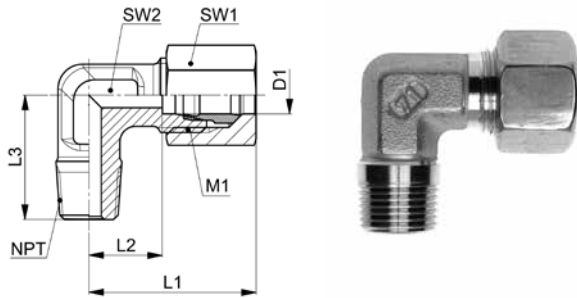

NC-WEV-..SNPT

Type-D1 NPT	Mat.-Nr.	PN	NPT	M1	L1	L2	L3	SW1	SW2	g/Stk
NPT=Einschraubgewinde NPT		NPT=tapered male adaptor thread NPT			NPT=美制一般用途圆锥管螺纹标准					
NC-WEV-06SNPT 1.4	718.2402.110.30	500	1/4	14x1.5	32.0	16.0	26.0	17	12	54
NC-WEV-06SNPT 3.8	718.2402.120.30	500	3/8	14x1.5	32.0	16.0	28.0	17	14	70
NC-WEV-06SNPT 1.2	718.2402.125.30	500	1/2	14x1.5	32.0	16.0	33.0	17	17	99
NC-WEV-08SNPT 1.4	718.2402.170.30	500	1/4	16x1.5	33.0	17.0	26.0	19	14	68
NC-WEV-08SNPT 3.8	718.2402.180.30	500	3/8	16x1.5	34.0	18.0	28.0	19	17	76
NC-WEV-08SNPT 1.2	718.2402.185.30	500	1/2	16x1.5	37.0	21.0	34.0	19	17	133
NC-WEV-10SNPT 1.4	718.2402.270.30	400	1/4	18x1.5	36.5	17.5	26.0	22	17	88
NC-WEV-10SNPT 3.8	718.2402.280.30	400	3/8	18x1.5	36.5	17.5	28.0	22	17	98
NC-WEV-12SNPT 1.4	718.2402.380.30	400	1/4	20x1.5	40.5	21.5	27.0	24	17	104
NC-WEV-12SNPT 1.2	718.2402.400.30	400	1/2	20x1.5	41.5	21.5	33.0	24	17	132
NC-WEV-12SNPT 3.8	718.2402.390.30	400	3/8	20x1.5	40.5	21.5	28.0	24	17	112
NC-WEV-14SNPT 3.8	718.2402.502.30	300	3/8	22x1.5	43.0	22.0	28.0	27	19	148
NC-WEV-14SNPT 1.2	718.2402.504.30	300	1/2	22x1.5	42.5	22.0	34.0	27	19	158
NC-WEV-16SNPT 1.2	718.2402.655.30	200	1/2	24x1.5	46.0	24.5	36.0	30	24	206
NC-WEV-20SNPT 3.4	718.2402.708.30	200	3/4	30x2.0	53.0	26.5	42.0	36	27	318
NC-WEV-25SNPT 1.1	718.2402.810.30	100	1	36x2.0	58.5	30.0	48.0	46	36	616

Baumaße sind Ungefährmaße bei angezogener Überwurfmutter.

Sizes are approximate dimensions at tightened nut.

尺寸为上紧螺母处的概略大小。

T-Einschraubverschraubungen

Abdichtung durch Dichtkante Form B nach ISO 1179-4

Male adaptor T fittings

sealing edge form B acc. ISO 1179-4

英制外螺纹三通接头总成

带符合ISO1179-4标准的金属面密封

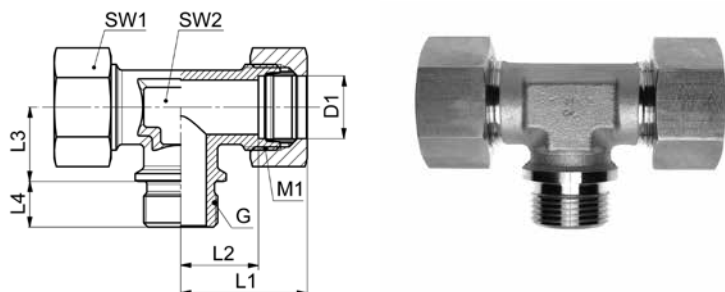

30

NC-TEV-..LR/SR

Type-D1 G	Mat.-Nr.	PN	G	M1	L1	L2	L3	L4	SW1	SW2	g/Stk
G=Rohrgewinde (zylindrisch)		G=BSP thread (parallel)									
			G=英制平行管螺纹标准								
NC-TEV-22LR 3.4	718.3702.768.20	160	3/4	30x2.0	47.5	27.5	26.0	16.0	36	27	381
NC-TEV-20SR 3.4	718.3702.704.30	200	3/4	30x2.0	53.0	26.5	26.0	16.0	36	27	499

Baumaße sind Ungefährmaße bei angezogener Überwurfmutter.

Sizes are approximate dimensions at tightened nut.

尺寸为上紧螺母处的概略大小。

D1=Rohr außen-Ø
M1=metrisches Anschlussgewinde

D1=tube outside diameter
M1=metric connecting thread

D1 = 管外径
M1=公制连接管螺纹

T-Einschraubverschraubungen

Abdichtung im Kegelgewinde Form C nach DIN 3852-2

Male adaptor T fittings

taper thread sealing form C acc. DIN 3852-2

英制锥形外螺纹三通接头总成

带符合DIN3852-2标准的圆锥螺纹C型密封

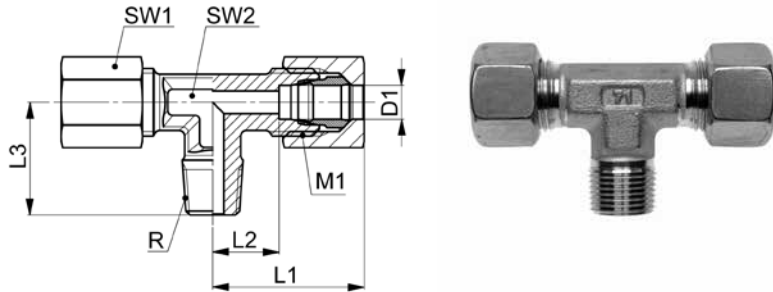

NC-TEV-..LRK/SRK

Type-D1 R	Mat.-Nr.	PN	R	M1	L1	L2	L3	SW1	SW2	g/Stk
R=Rohrgewinde (kegelig)		R=BSP thread (tapered)								
										R=英制锥形管螺纹标准
NC-TEV-06LRK 1.8	718.3701.100.20	250	1/8	12x1.5	28.0	12.0	20.0	14	12	52
NC-TEV-06LRK 1.4	718.3701.110.20	250	1/4	12x1.5	28.0	12.0	20.0	14	12	56
NC-TEV-08LRK 1.4	718.3701.170.20	250	1/4	14x1.5	30.0	14.0	26.0	17	12	72
NC-TEV-10LRK 1.4	718.3701.270.20	250	1/4	16x1.5	32.5	15.0	27.0	19	14	76
NC-TEV-10LRK 3.8	718.3701.280.20	250	3/8	16x1.5	32.5	15.0	27.0	19	14	82
NC-TEV-12LRK 3.8	718.3701.390.20	250	3/8	18x1.5	34.0	17.0	28.0	22	17	102
NC-TEV-12LRK 1.2	718.3701.400.20	250	1/2	18x1.5	38.5	21.0	28.0	22	17	138
NC-TEV-15LRK 1.2	718.3701.534.20	250	1/2	22x1.5	39.0	21.0	34.0	27	19	201
NC-TEV-18LRK 1.2	718.3701.646.20	160	1/2	26x1.5	41.0	23.5	36.0	32	24	296
NC-TEV-06SRK 1.4	718.3701.110.30	400	1/4	14x1.5	32.0	16.0	26.0	17	12	100
NC-TEV-08SRK 1.4	718.3701.170.30	400	1/4	16x1.5	33.0	17.0	27.0	19	14	113
NC-TEV-10SRK 3.8	718.3701.280.30	400	3/8	18x1.5	36.5	17.5	28.0	22	17	135
NC-TEV-12SRK 3.8	718.3701.390.30	400	3/8	20x1.5	41.0	21.5	28.0	24	17	159
NC-TEV-14SRK 1.2	718.3701.504.30	300	1/2	22x1.5	43.0	22.0	32.0	27	19	238
NC-TEV-16SRK 1.2	718.3701.566.30	200	1/2	24x1.5	47.0	24.5	32.0	30	24	339

Druckangaben gelten in Verbindung mit zylindrischem Innengewinde.

Pressure information applies in connection with parallel female thread.

压力等级取决于与之连接的平行管内螺纹。

Baumaße sind Ungefährmaße bei angezogener Überwurfmutter.

Sizes are approximate dimensions at tightened nut.

尺寸为上紧螺母处的概略大小。

D1=Rohr außen-Ø
M1=metrisches Anschlussgewinde

D1=tube outside diameter
M1=metric connecting thread

D1 = 管外径
M1=公制连接管螺纹

T-Einschraubverschraubungen NPT

Male adaptor T fittings NPT

美制锥形外螺纹三通接头总成

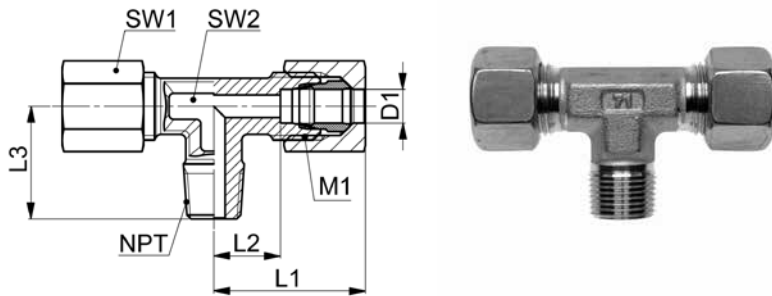

NC-TEV-..LNPT/SNPT

Type-D1 NPT	Mat.-Nr.	PN	NPT	M1	L1	L2	L3	SW1	SW2	g/Stk
NPT=Einschraubgewinde NPT		NPT=tapered male adaptor thread NPT			NPT=美制一般用途圆锥管螺纹标准					
NC-TEV-06LNPT 1.8	718.3704.100.20	250	1/8	12x1.5	28.0	12.0	20.0	14	12	50
NC-TEV-10LNPT 1.4	718.3704.270.20	250	1/4	16x1.5	32.5	15.0	27.0	19	14	90
NC-TEV-12LNPT 3.8	718.3704.390.20	250	3/8	18x1.5	34.0	17.0	28.0	22	17	129
NC-TEV-15LNPT 1.2	718.3704.534.20	250	1/2	22x1.5	39.0	21.0	34.0	27	19	215
NC-TEV-18LNPT 1.2	718.3704.646.20	160	1/2	26x1.5	41.0	23.5	36.0	32	24	295
NC-TEV-22LNPT 3.4	718.3704.768.20	160	3/4	30x2.0	47.5	27.5	42.0	36	27	433
NC-TEV-06SNPT 1.4	718.3704.110.30	500	1/4	14x1.5	32.0	16.0	26.0	17	12	94
NC-TEV-12SNPT 3.8	718.3704.390.30	400	3/8	20x1.5	41.0	21.5	28.0	24	17	184
NC-TEV-16SNPT 1.2	718.3704.566.30	200	1/2	24x1.5	47.0	24.5	36.0	30	24	327

Baumaße sind Ungefährmaße bei angezogener Überwurfmutter.

Sizes are approximate dimensions at tightened nut.

尺寸为上紧螺母处的概略大小。

D1=Rohr außen-Ø
M1=metrisches Anschlussgewinde

D1=tube outside diameter
M1=metric connecting thread

D1 = 管外径
M1=公制连接管螺纹

L-Einschraubverschraubungen

Abdichtung durch Dichtkante Form B nach ISO 1179-4

Male adaptor L fittings

sealing edge form B acc. ISO 1179-4

英制外螺纹三通主路接头总成

带符合ISO1179-4标准的金属面密封

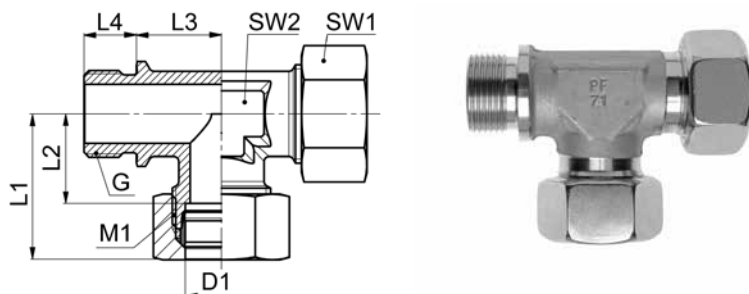

NC-LEV-..LR

Type-D1 G	Mat.-Nr.	PN	G	M1	L1	L2	L3	L4	SW1	SW2	g/Stk
G=Rohrgewinde (zylindrisch)		G=BSP thread (parallel)									
			G=英制平行管螺纹标准								
NC-LEV-22LR 3.4	718.3712.708.20	160	3/4	30x2.0	47.0	27.5	26.0	16.0	36	27	371

Baumaße sind Ungefährmaße bei angezogener Überwurfmutter.

Sizes are approximate dimensions at tightened nut.

尺寸为上紧螺母处的概略大小。

D1=Rohr außen-Ø
M1=metrisches Anschlussgewinde

D1=tube outside diameter
M1=metric connecting thread

D1 = 管外径
M1=公制连接管螺纹

L-Einschraubverschraubungen

Abdichtung im Kegelgewinde Form C nach DIN 3852-2

Male adaptor L fittings

taper thread sealing form C acc. DIN 3852-2

英制锥形外螺纹三通主路接头总成

带符合DIN3852-2标准的圆锥螺纹C型密封

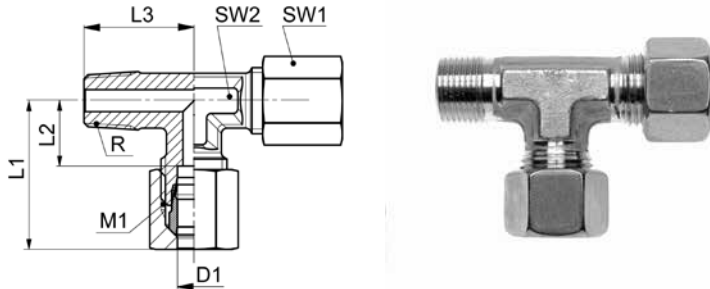

NC-LEV-..LRK/SRK

Type-D1 R	Mat.-Nr.	PN	R	M1	L1	L2	L3	SW1	SW2	g/Stk
R=Rohrgewinde (kegelig)		R=BSP thread (tapered)								
										R=英制锥形管螺纹标准
NC-LEV-06LRK 1.8	718.3711.100.20	250	1/8	12x1.5	28.0	12.0	20.0	14	12	53
NC-LEV-08LRK 1.4	718.3711.170.20	250	1/4	14x1.5	30.0	14.0	26.0	17	12	75
NC-LEV-10LRK 1.4	718.3711.270.20	250	1/4	16x1.5	32.0	15.0	27.0	19	14	100
NC-LEV-12LRK 3.8	718.3711.390.20	250	3/8	18x1.5	33.5	17.0	28.0	22	17	120
NC-LEV-15LRK 1.2	718.3711.534.20	250	1/2	22x1.5	38.0	21.0	34.0	27	19	167
NC-LEV-18LRK 1.2	718.3711.646.20	160	1/2	26x1.5	40.5	23.5	36.0	32	24	296
NC-LEV-06SRK 1.4	718.3711.111.30	400	1/4	14x1.5	32.0	16.0	26.0	17	12	97
NC-LEV-08SRK 1.4	718.3711.170.30	400	1/4	16x1.5	33.0	17.0	27.0	19	14	128
NC-LEV-10SRK 3.8	718.3711.280.30	400	3/8	18x1.5	36.0	17.5	28.0	22	17	172
NC-LEV-12SRK 3.8	718.3711.390.30	400	3/8	20x1.5	40.5	21.5	28.0	24	17	244
NC-LEV-14SRK 1.2	718.3711.504.30	300	1/2	22x1.5	43.5	22.0	32.0	27	19	240
NC-LEV-16SRK 1.2	718.3711.566.30	200	1/2	24x1.5	46.0	24.5	32.0	30	24	320

Druckangaben gelten in Verbindung mit zylindrischem Innengewinde.

Pressure information applies in connection with parallel female thread.

压力等级取决于与之连接的平行管内螺纹。

Baumaße sind Ungefährmaße bei angezogener Überwurfmutter.

Sizes are approximate dimensions at tightened nut.

尺寸为上紧螺母处的概略大小。

D1=Rohr außen-Ø
M1=metrisches Anschlussgewinde

D1=tube outside diameter
M1=metric connecting thread

D1 = 管外径
M1=公制连接管螺纹

L-Einschraubverschraubungen NPT

Male adaptor L fittings NPT

美制锥型外螺纹三通主路接头总成

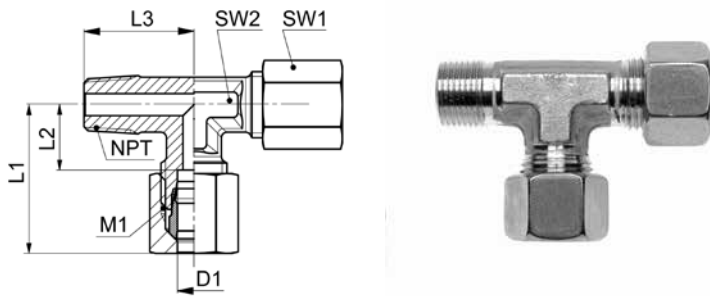

NC-LEV-..LNPT/SNPT

Type -D1 NPT	Mat.-Nr.	PN	NPT	M1	L1	L2	L3	SW1	SW2	g/Stk
NPT=Einschraubgewinde NPT			NPT=tapered male adaptor thread NPT			NPT=美制一般用途圆锥管螺纹标准				
NC-LEV-08LNPT 1.4	718.3755.170.20	250	1/4	14x1.5	30.0	14.0	26.0	17	12	77
NC-LEV-15LNPT 1.2	718.3755.534.20	250	1/2	22x1.5	38.0	21.0	34.0	27	19	191
NC-LEV-22LNPT 3.4	718.3755.768.20	160	3/4	30x2.0	47.0	27.5	42.0	36	27	347
NC-LEV-06SNPT 1.4	718.3755.110.30	500	1/4	14x1.5	32.0	16.0	26.0	17	12	103
NC-LEV-08SNPT 1.4	718.3755.170.30	500	1/4	16x1.5	33.0	17.0	27.0	19	14	133
NC-LEV-16SNPT 1.2	718.3755.566.30	200	1/2	24x1.5	46.0	24.5	32.0	30	24	320

Baumaße sind Ungefährmaße bei angezogener Überwurfmutter.

Sizes are approximate dimensions at tightened nut.

尺寸为上紧螺母处的概略大小。

D1=Rohr außen-Ø
M1=metrisches Anschlussgewinde

D1=tube outside diameter
M1=metric connecting thread

D1 = 管外径
M1=公制连接管螺纹

Einstellbare Winkel-Einschraubverschraubungen

mit Kontermutter, Abdichtung durch gekammerten O-Ring, ISO 1179-3

Adjustable male adaptor elbow fittings

with counter nut, sealing with restraining O-ring, ISO 1179-3

可调式直角弯头总成

带锁紧螺母和符合ISO 1179-3标准的O型圈密封

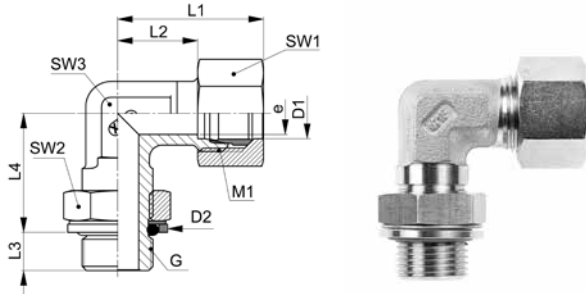

NC-WEE-..LR

Type-D1 G	Mat.-Nr.	PN	G	M1	D2	L1	L2	L3	L4	SW1	SW2	SW3	g/Stk
G=Rohrgewinde (zylindrisch)		G=BSP thread (parallel)											
													G=英制平行管螺纹标准
NC-WEE-06LR 1.8	718.2407.100.20	200	1/8	12x1.5	15.0	28.0	12.0	7.0	19.0	14	14	12	40
NC-WEE-08LR 1.4	718.2407.170.20	200	1/4	14x1.5	19.5	30.0	12.0	9.0	23.0	17	19	12	63
NC-WEE-10LR 1.4	718.2407.270.20	200	1/4	16x1.5	19.5	32.0	12.0	9.0	25.0	19	19	14	77
NC-WEE-12LR 3.8	718.2407.390.20	200	3/8	18x1.5	23.5	33.5	17.0	9.0	28.0	22	22	17	106
NC-WEE-15LR 1.2	718.2407.534.20	200	1/2	22x1.5	28.5	38.0	21.0	13.0	30.0	27	27	19	179
NC-WEE-18LR 1.2	718.2407.646.20	160	1/2	26x1.5	28.5	40.5	24.0	13.0	36.0	32	27	24	246
NC-WEE-22LR 3.4	718.2407.768.20	160	3/4	30x2.0	34.5	47.0	28.0	13.0	36.0	36	36	27	356
NC-WEE-12SR 3.8	718.2407.390.30	200	3/8	20x1.5	23.5	39.5	21.5	9.0	29.0	24	22	17	139
NC-WEE-16SR 1.2	718.2407.566.30	200	1/2	24x1.5	28.5	44.5	24.5	11.0	38.0	30	27	24	259
NC-WEE-20SR 3.4	718.2407.704.30	200	3/4	30x2.0	34.5	50.5	26.5	11.0	49.0	36	36	27	403

Baumaße sind Ungefährmaße bei angezogener Überwurfmutter.
 Dichtungsmaterial: FKM (andere Werkstoffe auf Anfrage)
 Konterscheibe aus Edelstahl 1.4404 / AISI 316L

Sizes are approximate dimensions at tightened nut.
 Sealing material: FKM (other materials on request)
 Counter nut made of stainless steel 1.4404 / AISI 316L

尺寸为上紧螺母处的概略大小。
 密封材料: FKM (其他材料可咨询)
 锁紧垫片材料为1.4404/AISI316L不锈钢

Montageanleitung

Installation instruction

装配说明

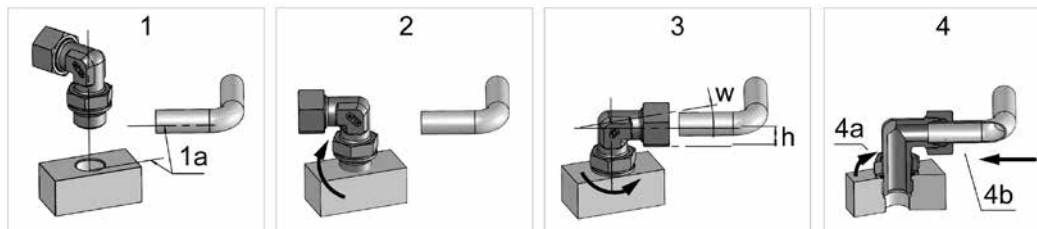

- 1 - Ausgangslage
1a: abweichende Winkel
- 2 - Verschraubung bis zum Anschlag einschrauben
- 3 - Verschraubung ausrichten
Höhe (h) +/- Gewindesteigung
Winkel (w)
- 4 - Fertigmontage
4a: Kontermutter anziehen
4b: Rohr montieren

- 1 - Starting position
1a: different angles
- 2 - Screw fitting until it stops
- 3 - Align fitting
height (h) +/- thread pitch angle (w)
- 4 - Final assembly
4a: Tighten counter nut
4b: Install tube

- 1 - 起始位置
1a: 不同的角度
- 2 - 旋入接头, 直至无法再旋转
- 3 - 对齐接头
高度 (h) +/- 螺距角度 (w)
- 4. 最终组装
4a: 拧紧埋头螺母
4b: 安装管件

D1=Rohr außen-Ø
 M1=metrisches Anschlußgewinde

D1=tube outside diameter
 M1=metric connecting thread

D1 = 管外径
 M1=公制连接管螺纹

Einstellbare Winkel-Einschraubverschraubungen

mit Kontermutter, Abdichtung durch gekammerten O-Ring, angelehnt an ISO 1179-3

Adjustable male adaptor elbow fittings

with counter nut, sealing with restraining O-ring, based on ISO 1179-3

可调式直角弯头总成

带锁紧螺母和符合基于ISO 1179-3标准的O型圈密封

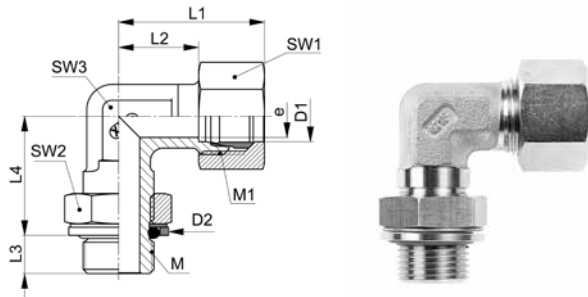

NC-WEE-..LM

Type-D1 M	Mat.-Nr.	PN	M	M1	D2	L1	L2	L3	L4	SW1	SW2	SW3	g/Stk
M=metrisches Gewinde (zylindrisch)		M=metric thread (parallel)											
													M=公制平行管螺纹标准
NC-WEE-08LM 12x1,5	718.2408.240.20	200	12x1.5	14x1.5	17.5	30.0	14.0	10.0	21.0	17	17	12	61
NC-WEE-10LM 14x1,5	718.2408.280.20	200	14x1.5	16x1.5	19.5	32.5	15.0	10.0	24.0	19	19	14	79
NC-WEE-18LM 22x1,5	718.2408.460.20	200	22x1.5	26x1.5	28.5	41.0	24.0	12.0	33.0	32	27	24	236

Baumaße sind Ungefährmaße bei angezogener Überwurfmutter.

Sizes are approximate dimensions at tightened nut.

尺寸为上紧螺母处的概略大小。

Dichtungsmaterial: FKM (andere Werkstoffe auf Anfrage)

Sealing material: FKM (other materials on request)

密封材料: FKM (其他材料可咨询)

Konterscheibe aus Edelstahl 1.4404 / AISI 316L

Counter nut made of stainless steel 1.4404 / AISI 316L

锁紧垫片材料为 1.4404/AISI316L 不锈钢

Montageanleitung

Installation instruction

装配说明

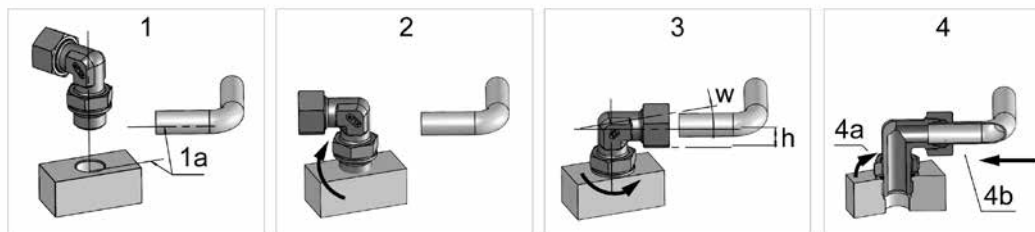

- 1 - Ausgangslage
1a: abweichende Winkel
- 2 - Verschraubung bis zum Anschlag einschrauben
- 3 - Verschraubung ausrichten
Höhe (h) +/- Gewindesteigung
Winkel (w)
- 4 - Fertigmontage
4a: Kontermutter anziehen
4b: Rohr montieren

- 1 - Starting position
1a: different angles
- 2 - Screw fitting until it stops
- 3 - Align fitting
height (h) +/- thread pitch
angle (w)
- 4 - Final assembly
4a: Tighten counter nut
4b: Install tube

- 1 - 起始位置
1a: 不同的角度
- 2 - 旋入接头, 直至无法再旋转
- 3 - 对齐接头
高度 (h) +/- 螺距
角度 (w)
- 4. 最终组装
4a: 拧紧埋头螺母
4b: 安装管件

D1=Rohr außen-Ø
M1=metrisches Anschlussgewinde

D1=tube outside diameter
M1=metric connecting thread

D1 = 管外径
M1=公制连接管螺纹

Winkel-Schwenkverschraubungen

Abdichtung mit metallischem Dichtkantenring

Banjo elbow fittings

sealing with metal seal-edge ring

铰接式直角接头总成

带金属密封圈

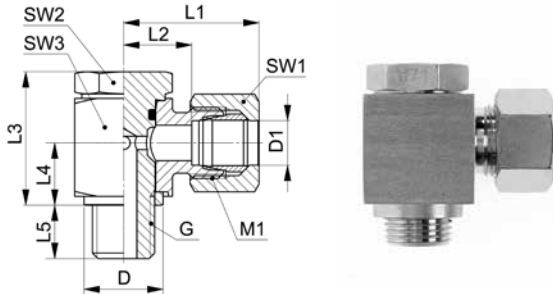

30

NC-ESWV-..LR/SR

Type-D1 G	Mat.-Nr.	PN	G	M1	D	L1	L2	L3	L4	L5	SW1	SW2	SW3	g/Stk
G=Rohrgewinde (zylindrisch)		G=BSP thread (parallel)			G=英制平行管螺纹标准									
NC-ESWV-06LR 1.8	718.2850.100.20	250	1/8	12x1.5	14.0	28.0	12.0	21.0	10.5	8.0	14	14	17	59
NC-ESWV-06LR 1.4	718.2850.110.20	250	1/4	12x1.5	18.0	28.0	12.0	30.0	14.0	12.0	14	19	19	59
NC-ESWV-08LR 1.4	718.2850.170.20	250	1/4	14x1.5	18.0	30.5	14.5	30.0	14.0	12.0	17	19	22	93
NC-ESWV-10LR 1.4	718.2850.270.20	250	1/4	16x1.5	18.0	32.5	15.5	30.0	14.0	12.0	19	19	22	102
NC-ESWV-12LR 1.4	718.2850.380.20	250	1/4	18x1.5	18.0	34.5	18.0	30.0	14.0	12.0	22	19	22	158
NC-ESWV-12LR 3.8	718.2850.390.20	250	3/8	18x1.5	21.0	34.5	18.0	34.5	16.5	12.0	22	22	27	159
NC-ESWV-15LR 1.2	718.2850.534.20	250	1/2	22x1.5	27.0	38.5	21.5	44.0	21.5	14.0	27	27	32	284
NC-ESWV-18LR 1.2	718.2850.646.20	160	1/2	26x1.5	27.0	38.0	21.5	44.0	21.5	14.0	32	27	32	320
NC-ESWV-22LR 3.4	718.2850.768.20	160	3/4	30x2.0	32.0	47.0	27.5	49.0	24.0	16.0	36	32	41	485
NC-ESWV-06SR 1.4	718.2850.110.30	500	1/4	14x1.5	18.0	32.5	16.5	30.0	14.0	12.0	17	19	22	87
NC-ESWV-08SR 1.4	718.2850.170.30	500	1/4	16x1.5	18.0	32.5	16.5	30.0	14.0	12.0	19	19	22	103
NC-ESWV-10SR 3.8	718.2850.280.30	400	3/8	18x1.5	21.0	37.0	18.5	34.5	16.5	12.0	22	22	27	170
NC-ESWV-12SR 3.8	718.2850.390.30	400	3/8	20x1.5	21.0	37.5	18.5	34.5	16.5	12.0	24	22	27	179
NC-ESWV-14SR 1.2	718.2850.504.30	300	1/2	22x1.5	27.0	43.0	22.5	44.0	21.5	14.0	27	27	32	303
NC-ESWV-16SR 1.2	718.2850.566.30	200	1/2	24x1.5	27.0	43.5	22.0	44.0	21.5	14.0	30	27	32	316
NC-ESWV-20SR 3.4	718.2850.704.30	200	3/4	30x2.0	32.0	51.5	26.5	49.0	24.0	16.0	36	32	41	518
NC-ESWV-25SR 1.1	718.2850.810.30	100	1	36x2.0	39.0	58.5	31.5	60.0	30.5	16.0	46	41	46	1030

Baumaße sind Ungefährmaße bei angezogener Überwurfmutter.
 Dichtungsmaterial: FKM (andere Werkstoffe auf Anfrage)
 Vor Montage Dichtkante und Einschraubgewinde der Hohlschraube schmieren.
 Optional auch in rein metallischer Ausführung ohne O-Ring erhältlich.

Sizes are approximate dimensions at tightened nut.
 Sealing material: FKM (other materials on request)
 Lubricate sealing edge and male thread of hollow bolt before assembly.
 Optionally available as pure metallic version without O-ring.

尺寸为上紧螺母处的概略大小。
 密封材料: FKM (其他材料可咨询)
 组装前请对空心螺柱的密封边缘以及螺纹端进行润滑。
 可選用純金屬版本, 無O形圈

G	1/8	1/4	3/8	1/2	3/4	1
[Nm]	15	40	70	110	160	210

Anzugsdrehmoment für Hohlschraube in Nm Tightening torque for hollow bolt in Nm 铰接接头空心螺柱的拧紧力矩 (Nm)

D1=Rohraußen-Ø
 M1=metrisches Anschlussgewinde

D1=tube outside diameter
 M1=metric connecting thread

D1 = 管外径
 M1=公制连接管螺纹

Winkel-Schwenkverschraubungen

Abdichtung mit gekammertem FKM Weichdichtring

Banjo elbow fittings

sealing with restraining seal ring FKM

铰接式直角接头总成

带FKM弹性密封

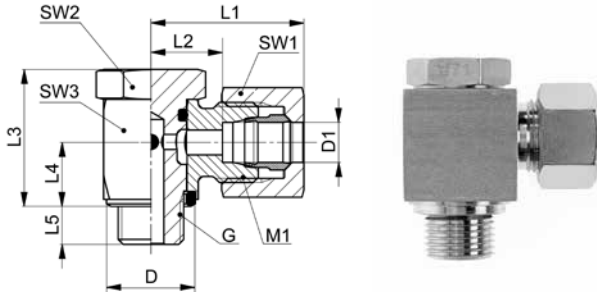

NC-ESWV-..LR WD/SR WD

Type-D1 G	Mat.-Nr.	PN	G	M1	D	L1	L2	L3	L4	L5	SW1	SW2	SW3	g/Stk
G=Rohrgewinde (zylindrisch)		G=BSP thread (parallel)			G=英制平行管螺纹标准									
NC-ESWV-06LR 1.8 WD	718.2851.100.20	250	1/8	12x1.5	15.0	28.0	12.0	21.0	10.5	8.0	14	14	17	59
NC-ESWV-06LR 1.4 WD	718.2851.110.20	250	1/4	12x1.5	19.0	28.0	12.0	30.0	14.0	12.0	14	19	19	59
NC-ESWV-08LR 1.4 WD	718.2851.170.20	250	1/4	14x1.5	19.0	30.5	14.5	30.0	14.0	12.0	17	19	22	93
NC-ESWV-10LR 1.4 WD	718.2851.270.20	250	1/4	16x1.5	19.0	32.5	15.5	30.0	14.0	12.0	19	19	22	102
NC-ESWV-12LR 1.4 WD	718.2851.380.20	250	1/4	18x1.5	19.0	34.5	18.0	30.0	14.0	12.0	22	19	22	158
NC-ESWV-12LR 3.8 WD	718.2851.390.20	250	3/8	18x1.5	22.0	34.5	18.0	34.5	16.5	12.0	22	22	27	159
NC-ESWV-15LR 1.2 WD	718.2851.534.20	250	1/2	22x1.5	27.0	38.5	21.5	44.0	21.5	14.0	27	27	32	284
NC-ESWV-18LR 1.2 WD	718.2851.646.20	160	1/2	26x1.5	27.0	38.0	21.5	44.0	21.5	14.0	32	27	32	320
NC-ESWV-22LR 3.4 WD	718.2851.768.20	160	3/4	30x2.0	33.0	47.0	27.5	49.0	24.0	16.0	36	32	41	485
NC-ESWV-06SR 1.4 WD	718.2851.110.30	500	1/4	14x1.5	19.0	32.5	16.5	30.0	14.0	12.0	17	19	22	87
NC-ESWV-08SR 1.4 WD	718.2851.170.30	500	1/4	16x1.5	19.0	32.5	16.5	30.0	14.0	12.0	19	19	22	103
NC-ESWV-10SR 3.8 WD	718.2851.280.30	400	3/8	18x1.5	22.0	37.0	18.5	34.5	16.5	12.0	22	22	27	170
NC-ESWV-12SR 3.8 WD	718.2851.390.30	400	3/8	20x1.5	22.0	37.5	18.5	34.5	16.5	12.0	24	22	27	179
NC-ESWV-14SR 1.2 WD	718.2851.504.30	300	1/2	22x1.5	27.0	43.0	22.5	44.0	21.5	14.0	27	27	32	303
NC-ESWV-16SR 1.2 WD	718.2851.566.30	200	1/2	24x1.5	27.0	43.5	22.0	44.0	21.5	14.0	30	27	32	316
NC-ESWV-20SR 3.4 WD	718.2851.704.30	200	3/4	30x2.0	33.0	51.5	26.5	49.0	24.0	16.0	36	32	41	518
NC-ESWV-25SR 1.1 WD	718.2851.810.30	100	1	36x2.0	40.0	58.5	31.5	49.0	30.5	18.0	46	41	46	1030

Baumaße sind Ungefährmaße bei angezogener Überwurfmutter.
 Dichtungsmaterial: FKM (andere Werkstoffe auf Anfrage)
 Vor Montage Dichtkante und Einschraubgewinde der Hohlschraube schmieren.

Sizes are approximate dimensions at tightened nut.
 Sealing material: FKM (other materials on request)
 Lubricate sealing edge and male thread of hollow bolt before assembly.

尺寸为上紧螺母处的概略大小。
 密封材料: FKM (其他材料可咨询)
 组装前请对空心螺柱的密封边缘以及螺纹端进行润滑。

G	1/8	1/4	3/8	1/2	3/4	1
[Nm]	15	40	70	110	160	210

Anzugsdrehmoment für Hohlschraube in Nm Tightening torque for hollow bolt in Nm 铰接接头空心螺柱的拧紧力矩 (Nm)

D1=Rohr außen-Ø
 M1=metrisches Anschlussgewinde

D1=tube outside diameter
 M1=metric connecting thread

D1 = 管外径
 M1=公制连接管螺纹

Winkel-Schwenkverschraubungen

Abdichtung mit metallischem Dichtkantenring

Banjo elbow fittings

sealing with metal seal-edge ring

铰接式直角接头总成

带金属密封圈

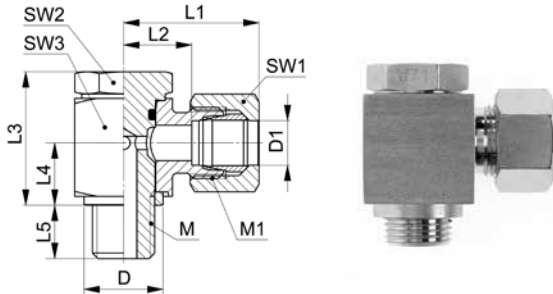

NC-ESWV-..LM/SM

Type-D1 M	Mat.-Nr.	PN	M	M1	D	L1	L2	L3	L4	L5	SW1	SW2	SW3	g/Stk
M=metrisches Gewinde (zylindrisch)		M=metric thread (parallel)			M=公制平行管螺纹标准									
NC-ESWV-06LM 10x1,0	718.2853.180.20	250	10x1.0	12x1.5	14.0	28.0	12.0	21.0	10.5	8.0	14	14	17	59
NC-ESWV-08LM 12x1,5	718.2853.240.20	250	12x1.5	14x1.5	18.0	30.5	14.5	30.0	14.0	12.0	17	19	22	90
NC-ESWV-10LM 14x1,5	718.2853.280.20	250	14x1.5	16x1.5	18.0	32.5	15.5	30.0	14.0	12.0	19	19	22	103
NC-ESWV-12LM 16x1,5	718.2853.330.20	250	16x1.5	18x1.5	21.0	34.5	18.0	34.5	16.5	12.0	22	22	27	158
NC-ESWV-15LM 18x1,5	718.2853.390.20	250	18x1.5	22x1.5	23.0	38.5	21.5	38.5	18.5	12.0	27	24	27	209
NC-ESWV-18LM 22x1,5	718.2853.460.20	160	22x1.5	30x2.0	27.0	38.0	21.0	44.0	21.5	14.0	32	27	32	320
NC-ESWV-22LM 26x1,5	718.2853.535.20	160	26x1.5	30x2.0	32.0	47.0	27.5	49.0	24.0	16.0	36	32	41	485
NC-ESWV-06SM 12x1,5	718.2853.195.30	500	12x1.5	14x1.5	18.0	32.5	16.5	30.0	14.0	12.0	17	19	22	85
NC-ESWV-08SM 14x1,5	718.2853.245.30	500	14x1.5	16x1.5	18.0	32.5	16.5	30.0	14.0	12.0	19	19	22	103
NC-ESWV-10SM 16x1,5	718.2853.285.30	400	16x1.5	18x1.5	21.0	37.0	18.5	34.5	16.5	12.0	22	22	27	170
NC-ESWV-12SM 18x1,5	718.2853.333.30	400	18x1.5	20x1.5	23.0	39.0	20.0	38.5	18.5	12.0	24	24	27	220
NC-ESWV-14SM 20x1,5	718.2853.382.30	300	20x1.5	22x1.5	27.0	43.0	22.5	44.0	21.5	14.0	27	27	32	280
NC-ESWV-16SM 22x1,5	718.2853.410.30	200	22x1.5	24x1.5	27.0	43.5	22.0	44.0	21.5	14.0	30	27	32	320
NC-ESWV-20SM 27x2,0	718.2853.506.30	200	27x2.0	30x2.0	32.0	51.5	26.5	49.0	24.0	16.0	36	32	41	518
NC-ESWV-25SM 33x2,0	718.2853.550.30	100	33x2.0	36x2.0	39.0	58.5	31.5	60.0	30.5	18.0	46	41	46	1030

Baumaße sind Ungefährmaße bei angezogener Überwurfmutter.
 Dichtungsmaterial: FKM (andere Werkstoffe auf Anfrage)
 Vor Montage Dichtkante und Einschraubgewinde der Hohlschraube schmieren.
 Optional auch in rein metallischer Ausführung ohne O-Ring erhältlich.

Sizes are approximate dimensions at tightened nut.
 Sealing material: FKM (other materials on request)
 Lubricate sealing edge and male thread of hollow bolt before assembly.
 Optionally available as pure metallic version without O-ring.

尺寸为上紧螺母处的概略大小。
 密封材料: FKM (其他材料可咨询)
 组装前请对空心螺柱的密封边缘以及螺纹端进行润滑。
 可選用純金屬版本, 無O形圈

M	10x1.0	12/14x1.5	16x1.5	18x1.5	20x1.5	22x1.5	26x1.5	27x2.0	33x2.0
[Nm]	15	25	45	60	110	80	150	160	210

Anzugsdrehmoment für Hohlschraube in Nm Tightening torque for hollow bolt in Nm 铰接接头空心螺柱的拧紧力矩 (Nm)

D1=Rohr außen-Ø
 M1=metrisches Anschlussgewinde

D1=tube outside diameter
 M1=metric connecting thread

D1 = 管外径
 M1=公制连接管螺纹

Winkel-Schwenkverschraubungen

Abdichtung mit gekammertem FKM Weichdichtring

Banjo elbow fittings

sealing with restraining seal ring FKM

铰接式直角接头总成

带FKM弹性密封

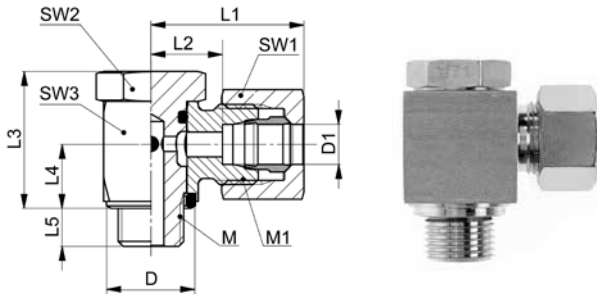

NC-ESWV-..LM WD/SM WD

Type-D1 M	Mat.-Nr.	PN	M	M1	D	L1	L2	L3	L4	L5	SW1	SW2	SW3	g/Stk
M=metrisches Gewinde (zylindrisch)		M=metric thread (parallel)			M=公制平行管螺纹标准									
NC-ESWV-06LM 10x1,0 WD	718.2852.180.20	250	10x1.0	12x1.5	15.0	28.0	12.0	21.0	10.5	8.0	14	14	17	59
NC-ESWV-08LM 12x1,5 WD	718.2852.240.20	250	12x1.5	14x1.5	19.0	30.5	14.5	30.0	14.0	12.0	17	19	22	90
NC-ESWV-10LM 14x1,5 WD	718.2852.280.20	250	14x1.5	16x1.5	19.0	32.5	5.0	30.0	14.0	12.0	19	19	22	103
NC-ESWV-12LM 16x1,5 WD	718.2852.330.20	250	16x1.5	18x1.5	22.0	34.5	18.0	34.5	16.5	12.0	22	22	27	158
NC-ESWV-15LM 18x1,5 WD	718.2852.390.20	250	18x1.5	22x1.5	24.0	38.5	21.5	38.5	18.5	12.0	27	24	27	209
NC-ESWV-18LM 22x1,5 WD	718.2852.460.20	160	22x1.5	26x1.5	27.0	38.0	21.0	44.0	21.5	14.0	32	27	32	320
NC-ESWV-22LM 26x1,5 WD	718.2852.535.20	160	26x1.5	30x2.0	33.0	47.0	27.5	49.0	24.0	16.0	36	32	41	485
NC-ESWV-06SM 12x1,5 WD	718.2852.195.30	500	12x1.5	14x1.5	19.0	32.5	16.5	30.0	14.0	12.0	17	19	22	85
NC-ESWV-08SM 14x1,5 WD	718.2852.245.30	500	14x1.5	16x1.5	19.0	32.5	16.5	30.0	14.0	12.0	19	19	22	103
NC-ESWV-10SM 16x1,5 WD	718.2852.285.30	400	16x1.5	18x1.5	22.0	37.0	18.5	34.5	16.5	12.0	22	22	27	170
NC-ESWV-12SM 18x1,5 WD	718.2852.333.30	400	18x1.5	20x1.5	24.0	39.0	20.0	38.5	18.5	12.0	24	24	27	220
NC-ESWV-14SM 20x1,5 WD	718.2852.382.30	300	20x1.5	22x1.5	27.0	43.0	22.5	44.0	21.5	14.0	27	27	32	280
NC-ESWV-16SM 22x1,5 WD	718.2852.410.30	200	22x1.5	24x1.5	27.0	43.5	22.0	44.0	21.5	14.0	30	27	32	320
NC-ESWV-20SM 27x2,0 WD	718.2852.506.30	200	27x2.0	30x2.0	33.0	51.5	26.5	49.0	24.0	16.0	36	32	41	518
NC-ESWV-25SM 33x2,0 WD	718.2852.550.30	100	33x2.0	36x2.0	40.0	58.5	31.5	60.0	30.5	18.0	46	41	46	1030

Baumaße sind Ungefährmaße bei angezogener Überwurfmutter.

Dichtungsmaterial: FKM (andere Werkstoffe auf Anfrage)

Vor Montage Dichtkante und Einschraubgewinde der Hohlverschraubung schmieren.

Sizes are approximate dimensions at tightened nut.

Sealing material: FKM (other materials on request)

Lubricate sealing edge and male thread of hollow bolt before assembly.

尺寸为上紧螺母处的概略大小。

密封材料: FKM (其他材料可咨询)

组装前请对空心螺柱的密封边缘以及螺纹端进行润滑。

M	10x1.0	12/14x1.5	16x1.5	18x1.5	20x1.5	22x1.5	26x1.5	27x2.0	33x2.0
[Nm]	15	25	45	60	110	80	150	160	210

Anzugsdrehmoment für Hohlverschraubung in Nm

Tightening torque for hollow bolt in Nm

铰接接头空心螺柱的拧紧力矩 (Nm)

Gerade Aufschraubverschraubungen
Straight female adaptor fittings
 英制直通内螺纹接头总成

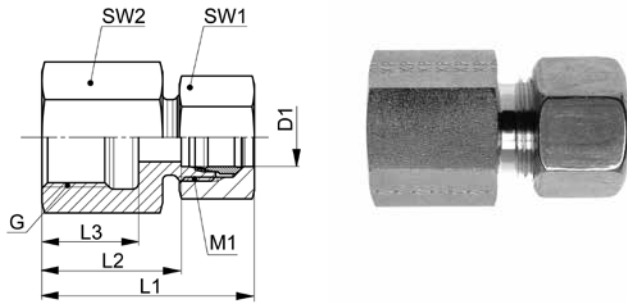

NC-GAV-..LR

Type-D1 G	Mat.-Nr.	PN	G	M1	L1	L2	L3	SW1	SW2	g/Stk
G=Rohrgewinde (zylindrisch)			G=BSP thread (parallel)							
						G=英制平行管螺纹标准				
NC-GAV-06LR 1.8	718.1201.100.20	250	1/8	12x1.5	35.0	19.0	11.0	14	14	27
NC-GAV-06LR 1.4	718.1201.110.20	250	1/4	12x1.5	40.0	24.0	16.0	14	19	48
NC-GAV-08LR 1.4	718.1201.170.20	250	1/4	14x1.5	40.0	24.0	16.0	17	19	50
NC-GAV-08LR 3.8	718.1201.180.20	250	3/8	14x1.5	41.0	25.0	16.0	17	24	78
NC-GAV-08LR 1.2	718.1201.185.20	250	1/2	14x1.5	45.0	29.0	20.0	17	27	84
NC-GAV-10LR 1.4	718.1201.270.20	250	1/4	16x1.5	42.0	25.0	16.0	19	19	60
NC-GAV-10LR 3.8	718.1201.280.20	250	3/8	16x1.5	43.0	26.0	16.0	19	24	68
NC-GAV-10LR 1.2	718.1201.285.20	250	1/2	16x1.5	47.0	30.0	20.0	19	27	102
NC-GAV-12LR 1.4	718.1201.380.20	250	1/4	18x1.5	41.5	25.0	16.0	22	19	68
NC-GAV-12LR 3.8	718.1201.390.20	250	3/8	18x1.5	42.5	26.0	16.0	22	24	88
NC-GAV-12LR 1.2	718.1201.400.20	250	1/2	18x1.5	46.5	30.0	20.0	22	27	106
NC-GAV-15LR 3.8	718.1201.532.20	250	3/8	22x1.5	44.0	27.0	16.0	27	24	114
NC-GAV-15LR 1.2	718.1201.534.20	250	1/2	22x1.5	48.0	31.0	20.0	27	27	113
NC-GAV-18LR 3.8	718.1201.644.20	160	3/8	26x1.5	43.5	26.5	16.0	32	27	168
NC-GAV-18LR 1.2	718.1201.646.20	160	1/2	26x1.5	47.5	30.5	20.0	32	27	151
NC-GAV-22LR 3.4	718.1201.768.20	160	3/4	30x2.0	55.0	35.5	22.0	36	36	270

Baumaße sind Ungefährmaße bei angezogener Überwurfmutter.

Abdichtung einschraubseitig bei konischen Einschraubgewinde mittels Gewindedichtmittel, bei zylindrischen Einschraubgewinde mittels Dichtkante oder Weichdichtung oder generell mit Dichtscheibe zwischen den zu verbindenden Teilen.

Sizes are approximate dimensions at tightened nut.

Sealing on the screw-in side for conical female threads by means of thread sealant, for parallel female threads by means of sealing edge or soft seal or generally with sealing washer between the parts to be connected.

尺寸为上紧螺母处的概略大小。

锥形螺纹的旋入侧通过螺纹密封产品进行密封，平行螺纹的旋入侧通过密封边或软密封进行密封，或者一般在待连接的零件之间使用密封垫圈。

D1=Rohr außen-Ø
 M1=metrisches Anschlussgewinde

D1=tube outside diameter
 M1=metric connecting thread

D1 = 管外径
 M1=公制连接管螺纹

Gerade Aufschraubverschraubungen
Straight female adaptor fittings
 英制直通内螺纹接头总成

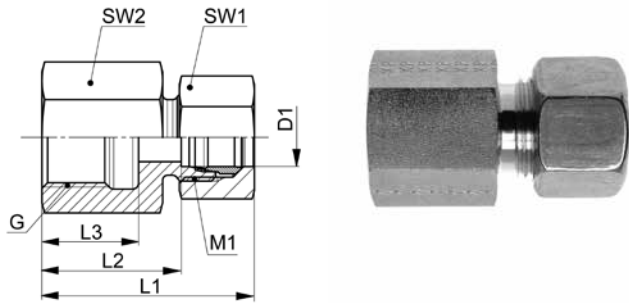

NC-GAV-..SR

Type-D1 G	Mat.-Nr.	PN	G	M1	L1	L2	L3	SW1	SW2	g/Stk
G=Rohrgewinde (zylindrisch)			G=BSP thread (parallel)							
						G=英制平行管螺纹标准				
NC-GAV-06SR 1.8	718.1201.100.30	500	1/8	14x1.5	37.0	21.0	11.0	17	17	50
NC-GAV-06SR 1.4	718.1201.110.30	500	1/4	14x1.5	42.0	26.0	16.0	17	19	49
NC-GAV-08SR 1.4	718.1201.170.30	500	1/4	16x1.5	42.0	26.0	16.0	19	19	59
NC-GAV-10SR 1.4	718.1201.270.30	400	1/4	18x1.5	45.0	26.5	16.0	22	22	114
NC-GAV-10SR 3.8	718.1201.280.30	400	3/8	18x1.5	45.0	26.5	16.0	22	24	100
NC-GAV-12SR 1.4	718.1201.380.30	400	1/4	20x1.5	46.5	27.0	16.0	24	22	106
NC-GAV-12SR 3.8	718.1201.390.30	400	3/8	20x1.5	45.5	26.5	16.0	24	24	112
NC-GAV-12SR 1.2	718.1201.400.30	400	1/2	20x1.5	49.5	30.5	20.0	24	27	122
NC-GAV-14SR 1.2	718.1201.504.30	300	1/2	22x1.5	52.5	32.0	20.0	27	27	148
NC-GAV-16SR 1.2	718.1201.566.30	200	1/2	24x1.5	53.0	31.5	20.0	30	27	175
NC-GAV-20SR 3.8	718.1201.703.30	200	3/8	30x2.0	54.5	27.5	16.0	36	32	245
NC-GAV-20SR 1.2	718.1201.706.30	200	1/2	30x2.0	59.5	34.5	20.0	36	32	248
NC-GAV-20SR 3.4	718.1201.708.30	200	3/4	30x2.0	59.5	34.5	22.0	36	36	300
NC-GAV-25SR 1.1	718.1201.810.30	100	1	36x2.0	65.0	37.5	24.0	46	41	466

Baumaße sind Ungefährmaße bei angezogener Überwurfmutter.

Abdichtung einschraubseitig bei konischen Einschraubgewinde mittels Gewindedichtmittel, bei zylindrischen Einschraubgewinde mittels Dichtkante oder Weichdichtung oder generell mit Dichtscheibe zwischen den zu verbindenden Teilen.

Sizes are approximate dimensions at tightened nut.

Sealing on the screw-in side for conical female threads by means of thread sealant, for parallel female threads by means of sealing edge or soft seal or generally with sealing washer between the parts to be connected.

尺寸为上紧螺母处的概略大小。

锥形螺纹的旋入侧通过螺纹密封产品进行密封，平行螺纹的旋入侧通过密封边或软密封进行密封，或者一般在待连接的零件之间使用密封垫圈。

Gerade Aufschraubverschraubungen
Straight female adaptor fittings
 公制直通内螺纹接头总成

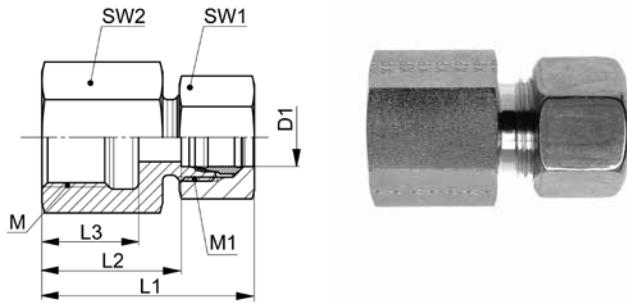

NC-GAV-..LM/SM

Type-D1 M	Mat.-Nr.	PN	M	M1	L1	L2	L3	SW1	SW2	g/Stk
M=metrisches Gewinde (zylindrisch)		M=metric thread (parallel)				M=公制平行管螺纹标准				
NC-GAV-06LM 10x1,0	718.1204.180.20	250	10x1.0	12x1.5	35.5	19.5	11.0	14	14	26
NC-GAV-08LM 12x1,5	718.1204.240.20	250	12x1.5	14x1.5	40.0	24.0	17.0	17	17	50
NC-GAV-10LM 14x1,5	718.1204.280.20	250	14x1.5	16x1.5	42.0	25.0	17.0	19	19	50
NC-GAV-12LM 16x1,5	718.1204.330.20	250	16x1.5	18x1.5	42.5	26.0	17.0	22	22	90
NC-GAV-12LM 18x1,5	718.1204.333.20	250	18x1.5	18x1.5	44.5	28.0	17.0	22	24	95
NC-GAV-12LM 20x1,5	718.1204.335.20	250	20x1.5	18x1.5	44.5	28.0	19.0	22	27	110
NC-GAV-15LM 18x1,5	718.1204.390.20	250	18x1.5	22x1.5	45.0	28.0	17.0	27	24	115
NC-GAV-18LM 22x1,5	718.1204.460.20	160	22x1.5	26x1.5	46.5	29.5	19.0	32	30	157
NC-GAV-22LM 26x1,5	718.1204.535.20	160	26x1.5	30x2.0	54.0	34.5	21.0	36	32	215
NC-GAV-06SM 12x1,5	718.1204.190.30	500	12x1.5	14x1.5	42.0	26.0	17.0	17	17	54
NC-GAV-08SM 14x1,5	718.1204.198.30	500	14x1.5	16x1.5	42.0	26.0	17.0	19	19	69
NC-GAV-10SM 16x1,5	718.1204.285.30	400	16x1.5	18x1.5	45.0	26.5	17.0	22	22	102
NC-GAV-12SM 18x1,5	718.1204.333.30	400	18x1.5	20x1.5	46.5	27.5	17.0	24	24	110
NC-GAV-12SM 20x1,5	718.1204.335.30	400	20x1.5	20x1.5	48.5	29.5	19.0	24	27	125
NC-GAV-14SM 20x1,5	718.1204.382.30	300	20x1.5	22x1.5	51.5	31.0	19.0	27	27	148
NC-GAV-16SM 22x1,5	718.1204.410.30	200	22x1.5	24x1.5	52.0	30.5	19.0	30	30	175
NC-GAV-20SM 27x2,0	718.1204.506.30	200	27x2.0	30x2.0	59.5	34.5	22.0	36	36	307
NC-GAV-25SM 33x2,0	718.1204.550.30	100	33x2.0	36x2.0	64.0	37.0	24.0	46	41	466

Baumaße sind Ungefährmaße bei angezogener Überwurfmutter.

Sizes are approximate dimensions at tightened nut.

尺寸为上紧螺母处的概略大小。

Abdichtung einschraubseitig bei konischen Einschraubgewinde mittels Gewindedichtmittel, bei zylindrischen Einschraubgewinde mittels Dichtkante oder Weichdichtung oder generell mit Dichtscheibe zwischen den zu verbindenden Teilen.

Sealing on the screw-in side for conical female threads by means of thread sealant, for parallel female threads by means of sealing edge or soft seal or generally with sealing washer between the parts to be connected.

锥形螺纹的旋入侧通过螺纹密封产品进行密封, 平行螺纹的旋入侧通过密封边或软密封进行密封, 或者一般在待连接的零件之间使用密封垫圈。

Manometer-Anschlussverschraubungen

Abdichtung mit metallischem Dichtkantenring

Manometer fittings

sealing with metal seal-edge ring

压力表接头总成

带金属密封圈

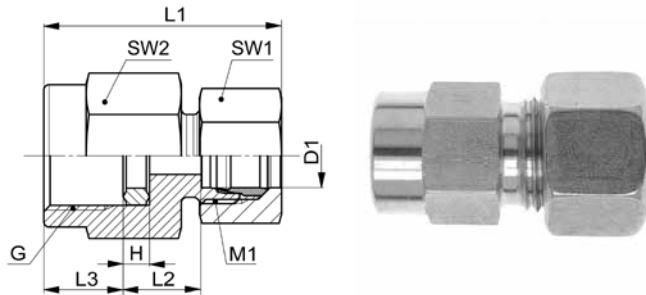

NC-MAV-..LR/SR

Type-D1 G	Mat.-Nr.	PN	G	M1	H	L1	L2	L3	SW1	SW2	g/Stk
G=Rohrgewinde (zylindrisch)		G=BSP thread (parallel)									
											G=英制平行管螺纹标准
NC-MAV-06LR 1.4	718.0230.110.20	250	1/4	12x1.5	4.5	38.0	12.0	10.0	14	19	46
NC-MAV-08LR 1.4	718.0230.170.20	250	1/4	14x1.5	4.5	38.0	12.0	10.0	17	19	53
NC-MAV-10LR 1.4	718.0230.270.20	250	1/4	16x1.5	4.5	40.0	13.0	10.0	19	19	62
NC-MAV-12LR 1.4	718.0230.380.20	250	1/4	18x1.5	4.5	39.5	13.0	10.0	22	19	65
NC-MAV-12LR 1.2	718.0230.400.20	250	1/2	18x1.5	4.5	46.5	15.0	15.5	22	27	105
NC-MAV-06SR 1.4	718.0230.110.30	500	1/4	14x1.5	4.5	40.0	14.0	10.0	17	19	62
NC-MAV-06SR 1.2	718.0230.125.30	500	1/2	14x1.5	5.0	47.0	16.0	15.0	17	27	110
NC-MAV-08SR 1.4	718.0230.170.30	500	1/4	16x1.5	4.5	40.0	16.0	10.0	19	19	68
NC-MAV-08SR 1.2	718.0230.185.30	500	1/2	16x1.5	5.0	47.0	14.0	15.0	19	27	115
NC-MAV-10SR 1.2	718.0230.285.30	400	1/2	18x1.5	5.0	49.0	15.5	15.0	22	27	120
NC-MAV-12SR 1.2	718.0230.400.30	400	1/2	20x1.5	5.0	48.5	15.5	15.0	24	27	136
NC-MAV-14SR 1.2	718.0230.504.30	300	1/2	22x1.5	5.0	50.0	17.0	15.0	27	27	158

Baumaße sind Ungefährmaße bei angezogener Überwurfmutter.

Sizes are approximate dimensions at tightened nut.

尺寸为上紧螺母处的概略大小。

D1=Rohr außen-Ø
M1=metrisches Anschlussgewinde

D1=tube outside diameter
M1=metric connecting thread

D1 = 管外径
M1=公制连接管螺纹

Manometer-Anschlussverschraubungen NPT

Manometer fittings NPT

美制锥螺纹压力表接头总成

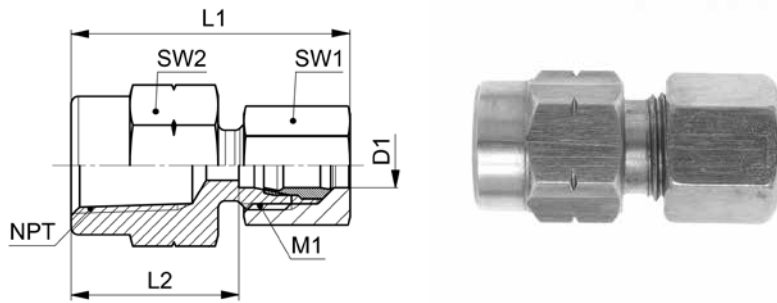

NC-MAV-..LNPT/SNPT

Type-D1 NPT	Mat.-Nr.	PN	NPT	M1	L1	L2	SW1	SW2	g/Stk
NPT=Einschraubgewinde NPT		NPT=tapered male adaptor thread NPT			NPT=美制一般用途圆锥管螺纹标准				
NC-MAV-06LNPT 1.4	718.0231.110.20	250	1/4	12x1.5	39.0	23.0	14	19	50
NC-MAV-06LNPT 1.2	718.0231.125.20	250	1/2	12x1.5	47.0	31.0	14	27	104
NC-MAV-08LNPT 1.4	718.0231.170.20	250	1/4	14x1.5	39.0	23.0	17	19	56
NC-MAV-08LNPT 1.2	718.0231.185.20	250	1/2	14x1.5	47.0	31.0	17	27	110
NC-MAV-10LNPT 1.4	718.0231.270.20	250	1/4	16x1.5	42.0	25.0	19	19	65
NC-MAV-10LNPT 1.2	718.0231.285.20	250	1/2	16x1.5	49.0	32.0	19	27	117
NC-MAV-12LNPT 1.4	718.0231.380.20	250	1/4	18x1.5	41.5	25.0	22	19	73
NC-MAV-12LNPT 1.2	718.0231.400.20	250	1/2	18x1.5	48.5	32.0	22	27	125
NC-MAV-06SNPT 1.2	718.0231.125.30	500	1/2	14x1.5	49.0	33.0	17	27	117
NC-MAV-08SNPT 1.2	718.0231.185.30	500	1/2	16x1.5	49.0	33.0	19	27	122
NC-MAV-12SNPT 1.2	718.0231.400.30	400	1/2	20x1.5	51.5	32.5	24	27	142

Baumaße sind Ungefährmaße bei angezogener Überwurfmutter.

Sizes are approximate dimensions at tightened nut.

尺寸为上紧螺母处的概略大小。

D1=Rohr außen-Ø
M1=metrisches Anschlussgewinde

D1=tube outside diameter
M1=metric connecting thread

D1 = 管外径
M1=公制连接管螺纹

Gerade Messverschraubungen

mit Schraubkupplung M16x2 und O-Ring, Kegelausführung

Straight fittings with test gauge

with threaded connection M16x2 and O-ring, tapered version

带测试点的直通接头总成

连接螺纹M16x2并带有O型圈, 锥形版本

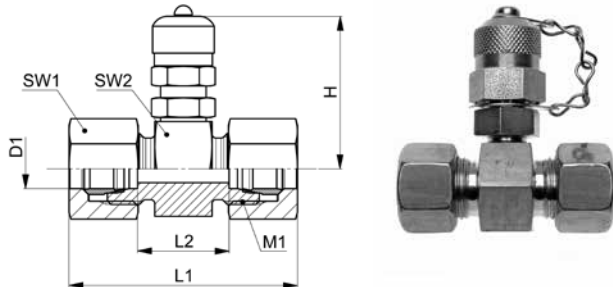

NC-EMV-GV-..L/S

Type-D1	Mat.-Nr.	PN	M1	H	L1	L2	SW1	SW2	g/Stk
NC-EMV-GV-06L	718.0240.060.20	250	12x1.5	49.0	52.5	20.0	14	24	149
NC-EMV-GV-08L	718.0240.080.20	250	14x1.5	49.0	52.5	20.0	17	24	161
NC-EMV-GV-10L	718.0240.100.20	250	16x1.5	49.0	56.5	22.0	19	24	175
NC-EMV-GV-12L	718.0240.120.20	250	18x1.5	49.0	55.5	22.0	22	24	186
NC-EMV-GV-15L	718.0240.150.20	250	22x1.5	52.0	58.5	24.0	27	30	261
NC-EMV-GV-18L	718.0240.180.20	160	26x1.5	53.0	57.5	23.0	32	32	323
NC-EMV-GV-22L	718.0240.220.20	160	30x2.0	55.0	66.5	27.0	36	36	396
NC-EMV-GV-06S	718.0240.060.30	500	14x1.5	49.0	56.5	24.0	17	24	172
NC-EMV-GV-08S	718.0240.080.30	500	16x1.5	49.0	56.5	24.0	19	24	182
NC-EMV-GV-10S	718.0240.100.30	400	18x1.5	49.0	60.5	23.0	22	24	207
NC-EMV-GV-12S	718.0240.120.30	400	20x1.5	49.0	61.5	23.0	24	24	223
NC-EMV-GV-14S	718.0240.140.30	300	22x1.5	50.0	67.5	26.0	27	27	284
NC-EMV-GV-16S	718.0240.160.30	200	24x1.5	52.0	68.5	25.0	30	30	327
NC-EMV-GV-20S	718.0240.200.30	200	30x2.0	55.0	75.5	25.0	36	36	478
NC-EMV-GV-25S	718.0240.250.30	100	36x2.0	57.0	80.5	26.0	46	41	776

Baumaße sind Ungefährmaße bei angezogener Überwurfmutter.

Sizes are approximate dimensions at tightened nut.

尺寸为上紧螺母处的概略大小。

mit O-Ring-Dichtung am Einschraubgewinde
Dichtungsmaterial: FKM (andere Werkstoffe auf Anfrage)

with O-ring-seal on male adaptor thread
Sealing material: FKM (other materials on request)

外螺纹连接处带有O型圈密封
密封材料: FKM (其他材料可咨询)

Gerade Reduzierschraubungen

Straight reducing fittings

直通变径接头总成

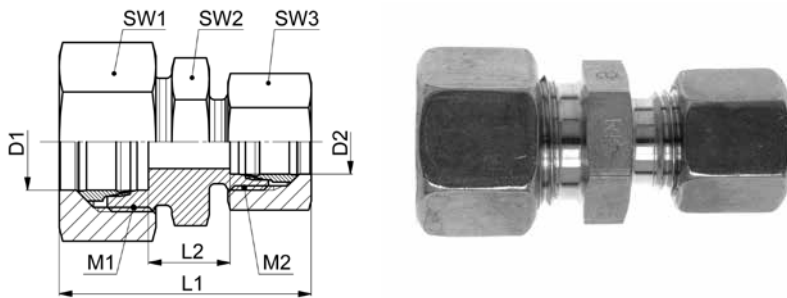

NC-GR-..L

Type-D1 /D2	Mat.-Nr.	PN	M1	M2	L1	L2	SW1	SW2	SW3	g/Stk
NC-GR-08/06L	718.1024.140.20	250	14x1.5	12x1.5	43.0	11.0	17	14	14	51
NC-GR-10/06L	718.1024.175.20	250	16x1.5	12x1.5	45.0	12.0	19	17	14	58
NC-GR-10/08L	718.1024.190.20	250	16x1.5	14x1.5	45.0	12.0	19	17	17	58
NC-GR-12/06L	718.1024.215.20	250	18x1.5	12x1.5	45.5	13.0	22	19	14	63
NC-GR-12/08L	718.1024.225.20	250	18x1.5	14x1.5	45.5	13.0	22	19	17	70
NC-GR-12/10L	718.1024.240.20	250	18x1.5	16x1.5	47.5	14.0	22	19	19	80
NC-GR-15/06L	718.1024.391.20	250	22x1.5	12x1.5	47.0	14.0	27	24	14	100
NC-GR-15/08L	718.1024.400.20	250	22x1.5	14x1.5	47.0	14.0	27	24	17	105
NC-GR-15/10L	718.1024.410.20	250	22x1.5	16x1.5	49.0	15.0	27	24	19	110
NC-GR-15/12L	718.1024.420.20	250	22x1.5	18x1.5	48.5	15.0	27	24	22	132
NC-GR-18/08L	718.1024.570.20	160	26x1.5	14x1.5	47.5	14.5	32	27	17	115
NC-GR-18/10L	718.1024.575.20	160	26x1.5	16x1.5	49.5	15.5	32	27	19	145
NC-GR-18/12L	718.1024.580.20	160	26x1.5	18x1.5	49.0	15.5	32	27	22	175
NC-GR-18/15L	718.1024.610.20	160	26x1.5	22x1.5	50.5	16.5	32	27	27	175
NC-GR-22/08L	718.1024.724.20	160	30x2.0	14x1.5	52.0	16.5	36	32	17	210
NC-GR-22/10L	718.1024.725.20	160	30x2.0	16x1.5	54.0	17.5	36	32	19	198
NC-GR-22/12L	718.1024.730.20	160	30x2.0	18x1.5	53.5	17.5	36	32	22	200
NC-GR-22/15L	718.1024.745.20	160	30x2.0	22x1.5	55.0	18.5	36	32	27	220
NC-GR-22/18L	718.1024.755.20	160	30x2.0	26x1.5	54.5	18.0	36	32	32	274

Baumaße sind Ungefährmaße bei angezogener Überwurfmutter.

Sizes are approximate dimensions at tightened nut.

尺寸为上紧螺母处的概略大小。

D1/D2=Rohr außen-Ø
M1/M2=metrische Anschlussgewinde

D1/D2=tube outside diameter
M1/M2=metric connecting threads

D1/D2 = 管外径
M1/M2=公制连接管螺纹

Gerade Reduzierschraubungen

Straight reducing fittings

直通变径接头总成

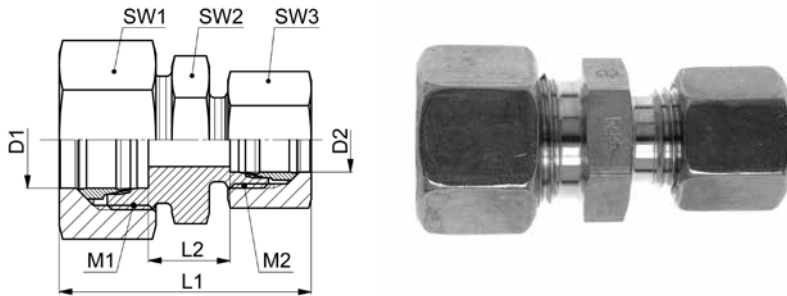

NC-GR-..S

Type-D1 /D2	Mat.-Nr.	PN	M1	M2	L1	L2	SW1	SW2	SW3	g/Stk
NC-GR-08/06S	718.1024.140.30	500	16x1.5	14x1.5	50.0	18.0	19	17	17	85
NC-GR-10/06S	718.1024.175.30	400	18x1.5	14x1.5	52.0	17.5	22	19	17	95
NC-GR-10/08S	718.1024.190.30	400	18x1.5	16x1.5	52.0	17.5	22	19	19	100
NC-GR-12/06S	718.1024.215.30	400	20x1.5	14x1.5	54.5	19.5	24	22	17	105
NC-GR-12/08S	718.1024.225.30	400	20x1.5	16x1.5	54.5	19.5	24	22	19	115
NC-GR-12/10S	718.1024.240.30	400	20x1.5	18x1.5	56.5	19.0	24	22	22	125
NC-GR-14/06S	718.1024.296.30	300	22x1.5	14x1.5	57.5	21.0	27	24	17	125
NC-GR-14/08S	718.1024.300.30	300	22x1.5	16x1.5	57.5	21.0	27	24	19	140
NC-GR-14/10S	718.1024.320.30	300	22x1.5	18x1.5	59.5	20.0	27	24	22	125
NC-GR-14/12S	718.1024.340.30	300	22x1.5	20x1.5	60.0	20.0	27	24	24	165
NC-GR-16/06S	718.1024.466.30	200	24x1.5	14x1.5	58.0	20.5	30	27	17	170
NC-GR-16/08S	718.1024.468.30	200	24x1.5	16x1.5	58.0	20.5	30	27	19	180
NC-GR-16/10S	718.1024.470.30	200	24x1.5	18x1.5	60.0	20.0	30	27	22	185
NC-GR-16/12S	718.1024.480.30	200	24x1.5	20x1.5	60.5	20.0	30	27	24	190
NC-GR-16/14S	718.1024.500.30	200	24x1.5	22x1.5	63.5	21.5	30	27	27	215
NC-GR-20/06S	718.1024.650.30	200	30x2.0	14x1.5	63.5	22.5	36	32	17	230
NC-GR-20/08S	718.1024.655.30	200	30x2.0	16x1.5	63.5	22.5	36	32	19	250
NC-GR-20/10S	718.1024.660.30	200	30x2.0	18x1.5	65.5	22.0	36	32	22	270
NC-GR-20/12S	718.1024.665.30	200	30x2.0	20x1.5	66.0	22.0	36	32	24	280
NC-GR-20/14S	718.1024.675.30	200	30x2.0	22x1.5	69.0	23.5	36	32	27	300
NC-GR-20/16S	718.1024.685.30	200	30x2.0	24x1.5	69.5	23.0	36	32	30	315
NC-GR-25/06S	718.1024.788.30	100	36x2.0	14x1.5	68.0	25.0	46	41	17	491
NC-GR-25/08S	718.1024.787.30	100	36x2.0	16x1.5	68.0	25.0	46	41	19	495
NC-GR-25/10S	718.1024.789.30	100	36x2.0	18x1.5	70.0	24.5	46	41	22	480
NC-GR-25/12S	718.1024.791.30	100	36x2.0	20x1.5	70.5	26.0	46	41	24	500
NC-GR-25/14S	718.1024.790.30	100	36x2.0	22x1.5	73.5	24.5	46	41	27	545
NC-GR-25/16S	718.1024.800.30	100	36x2.0	24x1.5	74.0	25.5	46	41	30	552
NC-GR-25/20S	718.1024.820.30	100	36x2.0	30x2.0	77.5	25.5	46	41	36	564

Baumaße sind Ungefährmaße bei angezogener Überwurfmutter.

Sizes are approximate dimensions at tightened nut.

尺寸为上紧螺母处的概略大小。

T-Reduzierschraubungen

Reducing T fittings

三通变径接头总成

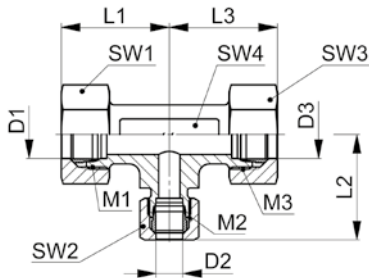

NC-TR-..L/S

Type-D1 /D2 /D3	Mat.-Nr.	PN	M1	M2	M3	L1	L2	L3	SW1	SW2	SW3	SW4	g/Stk
NC-TR-06/08/06L	718.3004.058.20	250	12x1.5	14x1.5	12x1.5	29.5	30.0	29.5	14	17	14	12	82
NC-TR-06/10/06L	718.3004.061.20	250	12x1.5	16x1.5	12x1.5	30.5	32.0	30.5	14	19	14	14	97
NC-TR-08/06/08L	718.3004.093.20	250	14x1.5	12x1.5	14x1.5	30.0	30.0	30.0	17	14	17	12	80
NC-TR-08/10/08L	718.3004.104.20	250	14x1.5	16x1.5	14x1.5	31.0	32.0	31.0	17	19	17	14	109
NC-TR-10/06/10L	718.3004.147.20	250	16x1.5	12x1.5	16x1.5	32.0	30.5	32.5	19	14	19	14	100
NC-TR-10/08/10L	718.3004.153.20	250	16x1.5	14x1.5	16x1.5	32.0	31.0	32.5	19	17	19	14	113
NC-TR-10/10/08L	718.3004.160.20	250	16x1.5	16x1.5	14x1.5	32.0	32.0	31.5	19	19	17	14	113
NC-TR-10/12/10L	718.3004.165.20	250	16x1.5	18x1.5	16x1.5	34.0	33.5	34.0	19	22	19	17	133
NC-TR-10/15/10L	718.3004.175.20	250	16x1.5	22x1.5	16x1.5	38.0	38.0	38.0	19	27	19	19	208
NC-TR-12/06/12L	718.3004.200.20	250	18x1.5	12x1.5	18x1.5	33.5	31.5	33.5	22	14	22	17	134
NC-TR-12/08/12L	718.3004.210.20	250	18x1.5	14x1.5	18x1.5	33.5	33.0	50.0	22	17	22	17	145
NC-TR-12/10/10L	718.3004.220.20	250	18x1.5	16x1.5	16x1.5	33.5	34.0	34.0	22	19	19	17	133
NC-TR-12/10/12L	718.3004.222.20	250	18x1.5	16x1.5	18x1.5	33.5	34.0	33.5	22	19	22	17	150
NC-TR-12/12/10L	718.3004.232.20	250	18x1.5	18x1.5	16x1.5	33.5	33.5	34.0	22	22	19	17	150
NC-TR-12/18/12L	718.3004.258.20	160	18x1.5	26x1.5	18x1.5	40.5	41.0	40.5	22	32	22	24	276
NC-TR-15/10/15L	718.3004.410.20	250	22x1.5	16x1.5	22x1.5	38.0	38.0	38.0	27	19	27	19	222
NC-TR-15/12/12L	718.3004.417.20	250	22x1.5	18x1.5	18x1.5	38.0	37.5	37.5	27	22	22	19	240
NC-TR-15/12/15L	718.3004.422.20	250	22x1.5	18x1.5	22x1.5	38.0	37.5	38.0	27	22	27	19	240
NC-TR-15/15/12L	718.3004.435.20	250	22x1.5	22x1.5	18x1.5	38.0	38.0	37.5	27	27	22	19	227
NC-TR-18/10/10L	718.3004.575.20	250	26x1.5	16x1.5	16x1.5	41.0	41.0	41.0	32	19	19	24	310
NC-TR-18/10/18L	718.3004.584.20	160	26x1.5	16x1.5	26x1.5	41.0	41.0	41.0	32	19	32	24	328
NC-TR-18/12/18L	718.3004.599.20	160	26x1.5	18x1.5	26x1.5	41.0	40.5	41.0	32	22	32	24	341
NC-TR-18/15/18L	718.3004.628.20	160	26x1.5	22x1.5	26x1.5	41.0	41.0	41.0	32	27	32	24	344
NC-TR-18/18/10L	718.3004.637.20	160	26x1.5	26x1.5	16x1.5	41.0	41.0	41.0	32	32	19	24	351
NC-TR-22/10/22L	718.3004.738.20	160	30x2.0	16x1.5	30x2.0	47.0	45.0	47.0	36	19	36	27	486
NC-TR-22/12/22L	718.3004.740.20	160	30x2.0	18x1.5	30x2.0	47.0	44.5	47.0	36	22	36	27	494
NC-TR-22/15/15L	718.3004.790.20	160	30x2.0	22x1.5	22x1.5	47.0	45.0	45.0	36	27	27	27	450
NC-TR-22/15/22L	718.3004.800.20	160	30x2.0	22x1.5	30x2.0	47.0	45.0	47.0	36	27	36	27	513
NC-TR-22/18/18L	718.3004.854.20	160	30x2.0	26x1.5	26x1.5	47.0	45.0	45.0	36	32	32	27	480
NC-TR-22/18/22L	718.3004.862.20	160	30x2.0	26x1.5	30x2.0	47.0	45.0	47.0	36	32	36	27	506
NC-TR-22/22/18L	718.3004.888.20	160	30x2.0	30x2.0	26x1.5	47.0	47.0	45.0	36	36	32	27	477
NC-TR-12/16/12S	718.3004.256.30	200	20x1.5	24x1.5	20x1.5	44.5	45.0	44.5	24	30	24	24	313
NC-TR-16/10/16S	718.3004.454.30	200	24x1.5	18x1.5	24x1.5	45.0	44.0	45.0	30	22	30	24	419
NC-TR-16/12/16S	718.3004.455.30	200	24x1.5	20x1.5	24x1.5	45.0	44.5	45.0	30	24	30	24	314
NC-TR-20/10/20S	718.3004.675.30	200	30x2.0	16x1.5	30x2.0	51.0	48.0	51.0	36	22	36	27	552
NC-TR-20/12/20S	718.3004.680.30	200	30x2.0	20x1.5	30x2.0	51.0	44.5	51.0	36	24	36	27	580
NC-TR-25/16/25S	718.3004.900.30	100	36x2.0	24x1.5	36x2.0	56.5	54.0	56.5	46	30	46	36	1050

Baumaße sind Ungefährmaße bei angezogener Überwurfmutter.

Sizes are approximate dimensions at tightened nut.

尺寸为上紧螺母处的概略大小。

D1/D2/D3=Rohr außen-Ø
M1/M2/M3=metrische Anschlussgewinde

D1/D2/D3=tube outside diameter
M1/M2/M3=metric connecting threads

D1/D2/D3 = 管外径
M1/M2/M3=公制连接管螺纹

Gerade Anschweißverschraubungen
Straight weld-on fittings
 直通焊接式接头总成

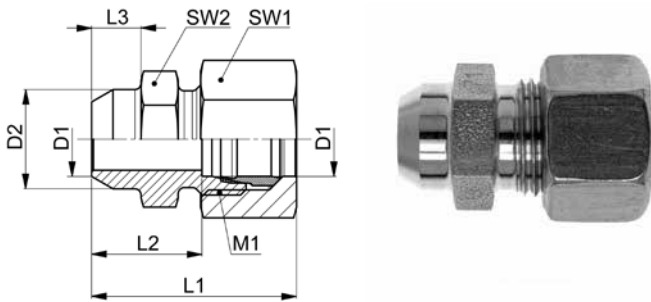

NC-GAS-..L/S

Type -D1	Mat.-Nr.	PN	M1	D2	L1	L2	L3	SW1	SW2	g/Stk
NC-GAS-06L	718.1400.060.20	250	12x1.5	10.0	30.0	14.0	7.0	14	12	25
NC-GAS-08L	718.1400.080.20	250	14x1.5	12.0	32.0	16.0	8.0	17	14	36
NC-GAS-10L	718.1400.100.20	250	16x1.5	14.0	35.0	18.0	8.0	19	17	47
NC-GAS-12L	718.1400.120.20	250	18x1.5	16.0	34.5	18.0	8.0	22	19	55
NC-GAS-15L	718.1400.150.20	250	22x1.5	19.0	39.0	22.0	10.0	27	22	90
NC-GAS-18L	718.1400.180.20	160	26x1.5	22.0	40.5	23.5	10.0	32	27	130
NC-GAS-22L	718.1400.220.20	160	30x2.0	27.0	48.0	28.5	12.0	36	32	190
NC-GAS-06S	718.1400.060.30	500	14x1.5	11.0	35.0	19.0	7.0	17	14	38
NC-GAS-08S	718.1400.080.30	500	16x1.5	13.0	37.0	21.0	8.0	19	17	54
NC-GAS-10S	718.1400.100.30	400	18x1.5	15.0	41.0	22.5	8.0	22	19	70
NC-GAS-12S	718.1400.120.30	400	20x1.5	17.0	43.5	24.5	10.0	24	22	125
NC-GAS-14S	718.1400.140.30	300	22x1.5	19.0	47.5	27.0	10.0	27	24	140
NC-GAS-16S	718.1400.160.30	200	24x1.5	21.0	48.0	26.5	10.0	30	27	156
NC-GAS-20S	718.1400.200.30	200	30x2.0	26.0	54.5	29.5	12.0	36	32	240
NC-GAS-25S	718.1400.250.30	100	36x2.0	31.0	59.0	32.0	12.0	46	41	460

Baumaße sind Ungefährmaße bei angezogener Überwurfmutter.

Sizes are approximate dimensions at tightened nut.

尺寸为上紧螺母处的概略大小。

Nach dem Anschweißen die in der Montageanleitung angegebenen Stellen nochmals mit der ASW Fettpaste schmieren (Klemmring, Gewinde der Mutter).

After welding, coat the parts indicated in the assembly instructions with ASW grease (clamping ring, thread of nut).

焊接后，请按装配说明书用 ASW 润滑脂涂覆零件（NC 夹紧环、螺母的螺纹等）。

Winkelanschweißverschraubungen

Elbow weld-on fittings

直角焊接式接头总成

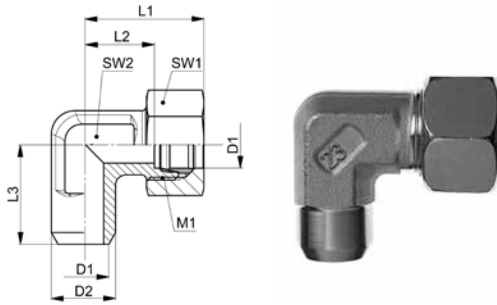

NC-WAS-..L/S

Type -D1	Mat.-Nr.	PN	M1	D2	L1	L2	L3	SW1	SW2	g/Stk
NC-WAS-06L	718.2400.060.20	250	12x1.5	10.0	28.0	15.0	19.0	14	12	34
NC-WAS-08L	718.2400.080.20	250	14x1.5	12.0	30.0	15.0	23.0	17	12	47
NC-WAS-10L	718.2400.100.20	250	16x1.5	14.0	32.5	15.5	24.0	19	14	61
NC-WAS-12L	718.2400.120.20	250	18x1.5	16.0	34.0	15.5	25.0	22	17	78
NC-WAS-15L	718.2400.150.20	250	22x1.5	19.0	39.0	16.0	30.0	27	19	127
NC-WAS-18L	718.2400.180.20	160	26x1.5	22.0	41.0	17.0	33.0	32	24	204
NC-WAS-22L	718.2400.220.20	160	30x2.0	27.0	47.5	17.0	37.0	36	27	261
NC-WAS-06S	718.2400.060.30	500	14x1.5	11.0	32.0	15.0	23.0	17	12	54
NC-WAS-08S	718.2400.080.30	500	16x1.5	13.0	33.0	15.0	24.0	19	14	71
NC-WAS-10S	718.2400.100.30	450	18x1.5	15.0	36.5	17.0	25.0	22	17	96
NC-WAS-12S	718.2400.120.30	400	20x1.5	17.0	41.0	17.0	29.0	24	17	123
NC-WAS-14S	718.2400.140.30	300	22x1.5	19.0	43.0	18.5	30.0	27	19	154
NC-WAS-16S	718.2400.160.30	200	24x1.5	21.0	47.0	19.5	33.0	30	24	230
NC-WAS-20S	718.2400.200.30	200	30x2.0	26.0	53.0	23.0	37.0	36	27	327
NC-WAS-25S	718.2400.250.30	100	36x2.0	31.0	58.5	25.5	42.0	46	36	589

Baumaße sind Ungefährmaße bei angezogener Überwurfmutter.

Nach dem Anschweißen die in der Montageanleitung angegebenen Stellen nochmals mit der ASW Fettpaste schmieren (Klemmring, Gewinde der Mutter).

Sizes are approximate dimensions at tightened nut.

After welding, coat the parts indicated in the assembly instructions with ASW grease (clamping ring, thread of nut).

尺寸为上紧螺母处的概略大小。

焊接后，请按装配说明书用 ASW 润滑脂涂覆零件（NC 夹紧环、螺母的螺纹等）。

D1=Rohr außen-Ø
M1=metrisches Anschlussgewinde

D1=tube outside diameter
M1=metric connecting thread

D1 = 管外径
M1=公制连接管螺纹

Einschweiß-Schottverschraubungen

Weld-in bulkhead fittings

隔板式焊接式接头总成

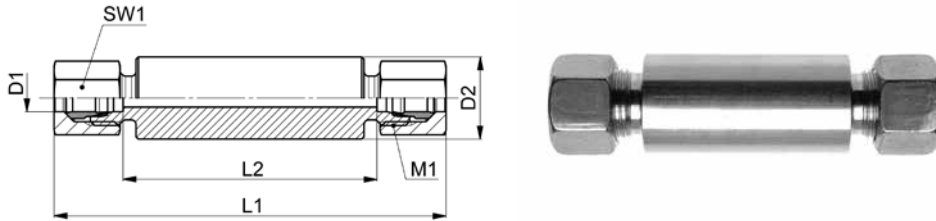

NC-ESV-..L/S

Type -D1	Mat.-Nr.	PN	M1	D2	L1	L2	SW1	g/Stk
NC-ESV-06L	718.1452.060.20	250	12x1.5	18.0	88.0	56.0	14	127
NC-ESV-08L	718.1452.080.20	250	14x1.5	20.0	88.0	56.0	17	155
NC-ESV-10L	718.1452.100.20	250	16x1.5	22.0	92.0	58.0	19	184
NC-ESV-12L	718.1452.120.20	250	18x1.5	25.0	91.0	58.0	22	236
NC-ESV-15L	718.1452.150.20	250	22x1.5	28.0	104.0	70.0	27	360
NC-ESV-18L	718.1452.180.20	160	26x1.5	32.0	103.0	69.0	32	480
NC-ESV-22L	718.1452.220.20	160	30x2.0	36.0	112.0	73.0	36	590
NC-ESV-06S	718.1452.060.30	500	14x1.5	20.0	92.0	60.0	17	177
NC-ESV-08S	718.1452.080.30	500	16x1.5	22.0	92.0	60.0	19	210
NC-ESV-10S	718.1452.100.30	400	18x1.5	25.0	96.0	59.0	22	272
NC-ESV-12S	718.1452.120.30	400	20x1.5	28.0	97.0	59.0	24	333
NC-ESV-14S	718.1452.140.30	300	22x1.5	30.0	113.0	72.0	27	454
NC-ESV-16S	718.1452.160.30	200	24x1.5	35.0	114.0	71.0	30	590
NC-ESV-20S	718.1452.200.30	200	30x2.0	38.0	121.0	71.0	36	748
NC-ESV-25S	718.1452.250.30	100	36x2.0	45.0	126.0	72.0	46	1180

Baumaße sind Ungefährmaße bei angezogener Überwurfmutter.

Sizes are approximate dimensions at tightened nut.

尺寸为上紧螺母处的概略大小。

Nach dem Anschweißen die in der Montageanleitung angegebenen Stellen nochmals mit der ASW Fettpaste schmieren (Klemmring, Gewinde der Mutter).

After welding, coat the parts indicated in the assembly instructions with ASW grease (clamping ring, thread of nut).

焊接后，请按装配说明书用 ASW 润滑脂涂覆零件（NC 夹紧环、螺母的螺纹等）。

Überwurfmuttern

innen versilbert

Nuts

silver-plated inside

螺母
内镀银

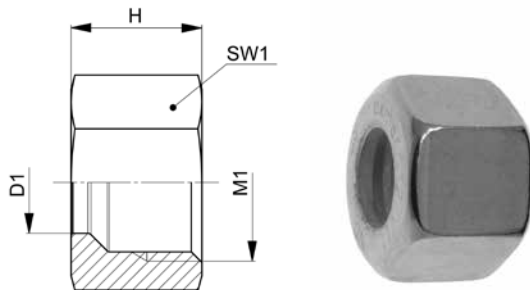

UEM-..L/S-VS

Type-D1	Mat.-Nr.	PN	PN DVGW	M1	H	SW1	g/Stk
M1=metrisches Gewinde (zylindrisch)	M1=metric thread (parallel)	M1=公制平行管螺纹标准					
UEM-06L-VS	716.0201.060.20	250	250	12x1.5	14.5	14	10
UEM-08L-VS	716.0201.080.20	250	250	14x1.5	14.5	17	15
UEM-10L-VS	716.0201.100.20	250	250	16x1.5	15.5	19	19
UEM-12L-VS	716.0201.120.20	250	250	18x1.5	15.5	22	25
UEM-15L-VS	716.0201.150.20	250	250	22x1.5	17.0	27	41
UEM-18L-VS	716.0201.180.20	160	250	26x1.5	18.0	32	63
UEM-22L-VS	716.0201.220.20	160	160	30x2.0	20.0	36	83
UEM-06S-VS	716.0201.060.30	500	250	14x1.5	16.5	17	16
UEM-08S-VS	716.0201.080.30	500	250	16x1.5	16.5	19	19
UEM-10S-VS	716.0201.100.30	400	250	18x1.5	17.5	22	29
UEM-12S-VS	716.0201.120.30	400	250	20x1.5	17.5	24	34
UEM-14S-VS	716.0201.140.30	300	250	22x1.5	20.5	27	50
UEM-16S-VS	716.0201.160.30	200	250	24x1.5	20.5	30	64
UEM-20S-VS	716.0201.200.30	200	250	30x2.0	24.0	36	103
UEM-25S-VS	716.0201.250.30	100	250	36x2.0	27.0	46	212

D1=Rohr außen-Ø
M1=metrisches Anschlussgewinde

D1=tube outside diameter
M1=metric connecting thread

D1 = 管外径
M1=公制连接管螺纹

NC-Klemmringe

NC clamping rings

NC 夹紧环

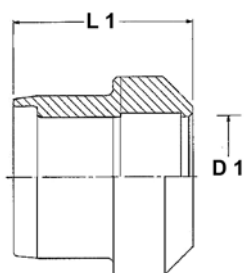

NC-R..L/S

Type -D1	Mat.-Nr.	PN	L1	g/Stk
NC-R-06L/S	716.0010.060.13	500	9.0	2
NC-R-08L/S	716.0010.080.13	500	9.0	3
NC-R-10L/S	716.0010.100.13	400	10.0	3
NC-R-12L/S	716.0010.120.13	400	10.1	4
NC-R-15L	716.0010.150.20	250	10.0	3
NC-R-18L	716.0010.180.20	160	10.4	6
NC-R-22L	716.0010.220.20	160	12.6	9
NC-R-14S	716.0010.140.30	300	10.1	6
NC-R-16S	716.0010.160.30	200	10.6	5
NC-R-20S	716.0010.200.30	200	12.6	11
NC-R-25S	716.0010.250.30	100	12.6	14