

EXMAR

艾克斯玛

50

Adapter

Adaptors

螺纹过渡接头

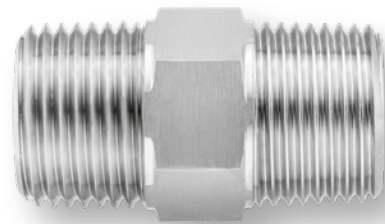

Adapter

Adaptors

螺纹过渡接头

Seite / Page / 页

Seite / Page / 页

Seite / Page / 页

Gerade Adapter
Straight adaptors
直通适配器



Muffe kurz
Threaded socket short
接头 短形



Einschraub-/Aufschraub-Winkel
Male/female threaded elbow
肘形旋入式接头



EA

AD CS 50

AD SE 51

Gerade Reduzieradapter
Straight reducing adaptors
直通异径适配器



Sechskantmuffe
Hexagonal threaded socket
六角套



Aufschraub-T
Female threaded tee
T型旋入式接头



EAR

AD HC 50

AD FT 51

Doppelnippel
Male threaded adaptor
双接头



Sechskantmuffe reduziert
Hexagonal threaded socket reduced
缩减六角套



AD HN 50

AD HRC 50

Rohrdoppelnippel
Tube double threaded nipple
管式双接头



Verschlusschraube
Locking screws
油口端堵头



AD CN 50

VSI/VSS

Gewinde-Reduzierstutzen
Reducing adaptors
变径转接头



Verschlusschraube
Screw plug
螺塞



RS

AD HP 50

Übergangsnippel
Adaptor female - male
转换管接头



Verschlusschraube
Screw plug
螺塞



AD A 50

AD SP 50

Sechskantnippel
Hexagonal nipple
六角接头



Rohrkappe
Hexagonal cap
接头管帽



ADH A 50

AD HCP 50

Muffe lang
Threaded socket long
接头 长形



Aufschraub-Winkel
Female threaded elbow
肘型旋入式接头



AD C 50

AD FE 51

Adapter

Adaptors

螺纹过渡接头

Technische Information

Technical information

技术信息

Adapter

Adaptors

螺纹过渡接头

Eigenschaften, Besonderheiten

- einfache Verbindungselemente mit Innen- und Außengewinden und Abschlusselementen
- zahlreiche Bauformen
- viele Kombinationsmöglichkeiten

Nenndruck PN

Siehe Produkttabellen (4-fache Sicherheit)

Werkstoff

Edelstahl 1.4571 (≈ AISI 316 Ti) oder 1.4401 (≈ AISI 316)

Gewinde

G = Rohrgewinde BSP (zylindrisch) ISO 228
R = Rohrgewinde (kegelig) EN 10226-1
NPT = Rohrgewinde (kegelig) ANSI B 1.20.1

Characteristics, specialities

- simple connecting pieces with internal and external threads and end elements
- large number of design types
- many possible combinations

Pressure nominal PN

See product tables (safety factor 4)

Materials

Stainless steel 1.4571 (≈ AISI 316 Ti) or 1.4401 (≈ AISI 316)

Threads

G = BSP pipe thread (straight) ISO 228
R = BSP pipe thread (tapered) EN 10226-1
NPT = NPT pipe thread (tapered) ANSI B 1.20.1

属性, 特性

- 带有内、外螺纹和末端元件的简单连接件
- 多种结构形式
- 众多组合可能

公称压力 PN

参见产品表 (4 倍安全性)

材质

不锈钢 1.4571 (≈ AISI 316 Ti) / 1.4401 (≈ AISI 316)

螺纹

G = 管螺纹 BSP (圆柱形) ISO 228
R = 管螺纹 (锥形) EN 10226-1
NPT = 管螺纹 (锥形) ANSI B 1.20.1

Gerade Adapter

mit 60° Konus, Abdichtung beidseitig durch Dichtkante Form B nach DIN 3852-2

Straight adaptors

with 60° taper, double-sided sealing edge form B acc. DIN 3852-2

直通适配器

带 60° 锥体且带符合DIN3852-2标准的金属面密封

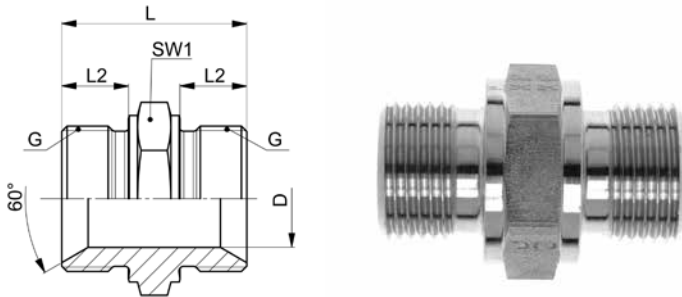

EA

Type-G	Mat.-Nr.	PN	D	G	L	L2	SW1	g/Stk
G=Rohrgewinde (zylindrisch)		G=BSP thread (parallel)						
								G=英制平行管螺纹标准
EA-G 1.8/G 1.8	736.6052.090	400	4.0	1/8	23.0	8.0	14	14
EA-G 1.4/G 1.4	736.6052.091	400	6.0	1/4	29.0	10.0	19	32
EA-G 3.8/G 3.8	736.6052.092	400	8.0	3/8	35.0	12.0	22	56
EA-G 1.2/G 1.2	736.6052.093	400	10.0	1/2	41.0	14.0	27	100
EA-G 5.8/G 5.8	736.6052.094	400	12.0	5/8	43.0	16.0	30	115
EA-G 3.4/G 3.4	736.6052.095	400	15.0	3/4	46.0	16.0	32	151
EA-G 1.1/G 1.1	736.6052.096	400	19.0	1	52.0	18.0	41	250
EA-G 5.4/G 5.4	736.6052.097	200	30.0	1 1/4	58.0	20.0	50	371
EA-G 3.2/G 3.2	736.6052.098	200	32.0	1 1/2	61.0	22.0	55	511
EA-G 4.2/G 4.2	736.6052.099	100	39.0	2	61.0	22.0	70	771

Gerade Reduzieradapter

mit 60° Konus, Abdichtung beidseitig durch Dichtkante Form B nach DIN 3852-2

Straight reducing adaptors

with 60° taper, double-sided sealing edge form B acc. DIN 3852-2

直通异径适配器

带 60° 锥体且带符合DIN3852-2标准的金属面密封

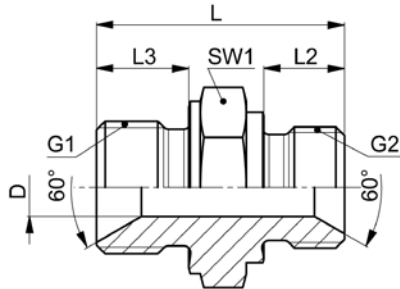

EAR

Type-G1 /G2	Mat.-Nr.	PN	D	G1	G2	L	L2	L3	SW1	g/Stk
G1=Rohrgewinde (zylindrisch)		G1=BSP thread (parallel)				G1=英制平行管螺纹标准				
G2=Rohrgewinde (zylindrisch)		G2=BSP thread (parallel)				G2=英制平行管螺纹标准				
EAR-G 1.4/G 1.8	736.6053.600	400	4.0	1/4	1/8	30.0	8.0	12.0	19	33
EAR-G 3.8/G 1.8	736.6053.601	400	4.0	3/8	1/8	30.5	8.0	12.0	22	47
EAR-G 3.8/G 1.4	736.6053.602	400	6.0	3/8	1/4	35.0	12.0	12.0	22	53
EAR-G 1.2/G 1.4	736.6053.603	400	6.0	1/2	1/4	39.0	12.0	14.0	27	88
EAR-G 1.2/G 3.8	736.6053.604	400	8.0	1/2	3/8	39.5	12.0	14.0	27	93
EAR-G 5.8/G 3.8	736.6053.605	400	8.0	5/8	3/8	40.5	12.0	16.0	30	110
EAR-G 5.8/G 1.2	736.6053.606	400	10.0	5/8	1/2	43.0	14.0	16.0	30	120
EAR-G 3.4/G 3.8	736.6053.607	400	8.0	3/4	3/8	42.5	12.0	16.0	32	142
EAR-G 3.4/G 1.2	736.6053.608	400	10.0	3/4	1/2	45.0	14.0	16.0	32	153
EAR-G 3.4/G 5.8	736.6053.609	400	12.0	3/4	5/8	45.5	16.0	16.0	32	152
EAR-G 1.1/G 3.8	736.6053.610	400	8.0	1	3/8	48.0	12.0	18.0	41	236
EAR-G 1.1/G 1.2	736.6053.611	400	10.0	1	1/2	54.0	14.0	18.0	41	233
EAR-G 1.1/G 3.4	736.6053.612	400	15.0	1	3/4	54.0	16.0	18.0	41	252
EAR-G 5.4/G 3.4	736.6053.613	200	15.0	1 1/4	3/4	56.0	16.0	20.0	50	404
EAR-G 5.4/G 1.1	736.6053.614	200	20.0	1 1/4	1	61.0	18.0	20.0	50	394
EAR-G 3.2/G 1.1	736.6053.615	200	20.0	1 1/2	1	63.0	18.0	22.0	55	557
EAR-G 3.2/G 5.4	736.6053.616	200	22.0	1 1/2	1 1/4	63.5	20.0	22.0	55	608
EAR-G 4.2/G 5.4	736.6053.617	100	22.0	2	1 1/4	65.5	20.0	24.0	70	547
EAR-G 4.2/G 3.2	736.6053.618	100	32.0	2	1 1/2	67.5	22.0	24.0	70	935

Adapter

Adaptors

螺纹过渡接头

Doppelnippel G-R

60° Innenkonus / kegeliges Aussengewinde

Male threaded adaptor G-R

60° inner cone / tapered male thread

双接头 G-R

内锥度 60° / 锥形外螺纹

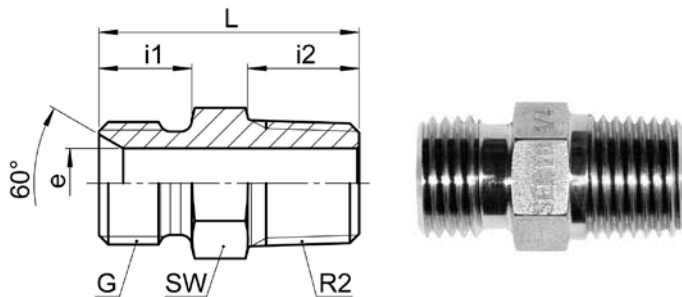
**ADH HNIC 50**

Type-G-R2	Mat.-Nr.	PN	SW	L	i1	i2	e	kg/100
G=Rohrgewinde (zylindrisch)		G=BSP thread (parallel)						
R2=Rohrgewinde (kegelig)		R2=BSP thread (tapered)						
ADH HNIC 50-1/8 -1/8	496.5210.042	400	10	22.0	9.0	8.0	4.0	0.760
ADH HNIC 50-1/4 -1/4	496.5210.104	400	14	28.0	11.0	12.0	7.5	1.120
ADH HNIC 50-3/8 -3/8	496.5210.166	400	17	30.0	11.5	12.0	10.0	3.280
ADH HNIC 50-1/2 -1/2	496.5210.228	400	22	34.0	12.0	14.0	12.0	5.480
ADH HNIC 50-3/4 -3/4	496.5210.292	160	27	38.0	13.0	16.0	17.0	9.000

Doppelnippel R-R

Male threaded adaptor R-R

双接头 R-R

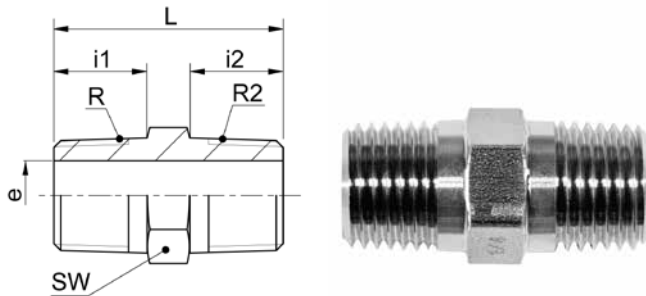

AD HN 50 R

Type -R -R2	Mat.-Nr.	PN	SW	L	i1	i2	e	kg/100
R=Rohrgewinde (kegelig)		R=BSP thread (tapered)						
R2=Rohrgewinde (kegelig)		R2=BSP thread (tapered)						
AD HN 50-1/8-1/8	TAD.5110.042	400	12	25.0	9.5	9.5	6.0	1.050
AD HN 50-1/8-1/4	TAD.5110.044	400	14	28.0	9.5	12.5	6.0	1.910
AD HN 50-1/8-3/8	TAD.5110.046	400	17	30.0	9.5	12.5	6.0	3.340
AD HN 50-1/8-1/2	TAD.5110.048	400	22	35.0	9.5	17.5	6.0	6.640
AD HN 50-1/4-1/4	TAD.5110.104	400	14	31.0	12.5	12.5	8.0	2.070
AD HN 50-1/4-3/8	TAD.5110.106	400	17	33.0	12.5	12.5	8.0	3.460
AD HN 50-1/4-1/2	TAD.5110.108	400	22	38.0	12.5	17.5	8.0	6.680
AD HN 50-3/8-3/8	TAD.5110.166	400	17	33.0	12.5	12.5	10.5	3.330
AD HN 50-3/8-1/2	TAD.5110.168	400	22	38.0	12.5	17.5	10.5	6.390
AD HN 50-1/2-1/2	TAD.5110.228	400	22	43.0	17.5	17.5	13.0	7.060
AD HN 50-1/2-3/4	TAD.5110.232	160	27	46.5	17.5	19.0	13.0	12.090
AD HN 50-1/2-1	TAD.5110.236	100	36	48.5	17.5	21.0	13.0	21.120
AD HN 50-3/4-3/4	TAD.5110.292	160	27	48.0	19.0	19.0	21.0	7.620
AD HN 50-3/4-1	TAD.5110.296	100	36	50.0	19.0	21.0	21.0	16.340
AD HN 50-1-1	TAD.5110.414	100	36	52.0	21.0	21.0	26.0	14.470

50

Doppelnippel R-NPT

Male threaded adaptor R-NPT

双接头 R-NPT

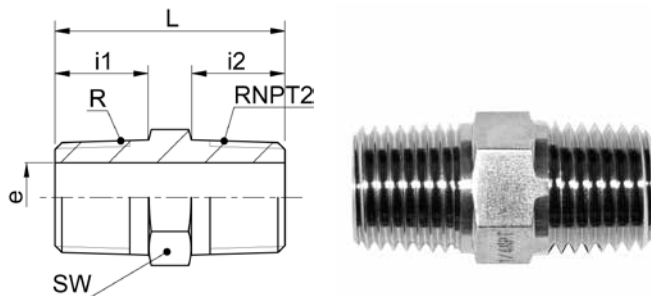

AD HN 50 R-NPT

Type -R -RNPT2	Mat.-Nr.	PN	SW	L	i1	i2	e	kg/100
R=Rohrgewinde (kegelig)		R=BSP thread (tapered)						
RNPT2=NPT Gewinde		RNPT2=NPT thread						
					R=英制锥形管螺纹标准			
					RNPT2=美制一般用途圆锥管螺纹标准			
AD HN 50-1/8-1/8 NPT	TAD.5114.042	400	12	25.0	9.5	9.5	6.0	1.060
AD HN 50-1/4-1/4 NPT	TAD.5114.104	400	14	31.0	12.5	12.5	8.0	2.060
AD HN 50-3/8-3/8 NPT	TAD.5114.166	400	17	33.0	12.5	12.5	10.5	3.260
AD HN 50-1/2-1/2 NPT	TAD.5114.228	400	22	43.0	17.5	17.5	13.0	6.850
AD HN 50-3/4-3/4 NPT	TAD.5114.292	160	27	48.0	19.0	19.0	21.0	7.370
AD HN 50-1-1 NPT	TAD.5114.414	100	36	52.0	21.0	21.0	26.0	13.760

Doppelnippel NPT-NPT

Male threaded adaptor NPT-NPT

双接头 NPT-NPT

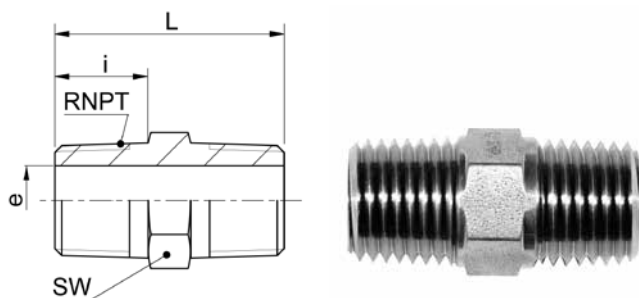

AD HN 50 NPT-NPT

Type -RNPT	Mat.-Nr.	PN	SW	L	i	e	kg/100
RNPT=NPT Gewinde		RNPT=NPT thread					
					RNPT=美制一般用途圆锥管螺纹标准		
AD HN 50-1/8 NPT-1/8 NPT	TAD.5111.042	800	12	25.0	9.5	6.0	1.110
AD HN 50-1/4 NPT-1/4 NPT	TAD.5111.104	800	14	31.0	12.5	8.0	2.140
AD HN 50-3/8 NPT-3/8 NPT	TAD.5111.166	800	17	33.0	12.5	10.5	3.340
AD HN 50-1/2 NPT-1/2 NPT	TAD.5111.228	800	22	43.0	17.5	13.0	6.940
AD HN 50-3/4 NPT-3/4 NPT	TAD.5111.292	800	27	48.0	19.0	21.0	7.450
AD HN 50-1 NPT-1 NPT	TAD.5111.414	630	36	52.0	21.0	26.0	13.690

Rohrdoppelnippel R

Tube double threaded nipple R

管式双接头 R

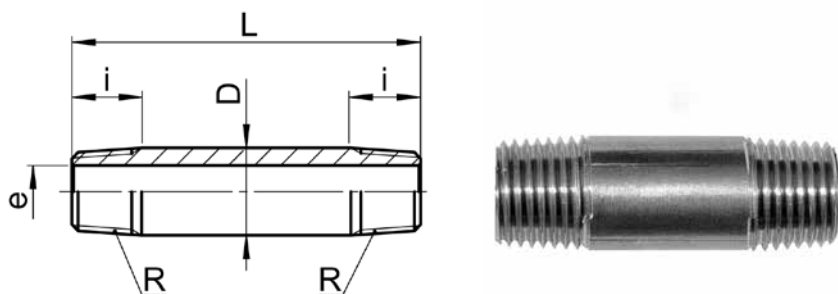

AD CN 50

Type -R xL	Mat.-Nr.	PN	L	D	i	e	kg/100	
R=Rohrgewinde (kegelig)	R=BSP thread (tapered)	R=英制锥形管螺纹标准						
AD CN 50-1/8 x40	TAD.5150.021	400	40.0	10.0	8.0	6.0	1.400	
AD CN 50-1/4 x40	TAD.5150.042	400	40.0	14.0	9.0	9.0	2.400	
AD CN 50-3/8 x60	TAD.5150.060	400	60.0	17.0	12.0	12.0	4.000	
AD CN 50-1/2 x60	TAD.5150.084	400	60.0	21.0	13.0	16.0	5.970	
AD CN 50-3/4 x80	TAD.5150.126	160	80.0	27.0	17.0	22.0	10.850	

Gewinde-Reduzierstutzen

Abdichtung durch Dichtkante Form B nach DIN 3852-2

Reducing adaptors

sealing edge form B acc. DIN 3852-2

变径转接头

带符合DIN3852-2标准的金属面密封

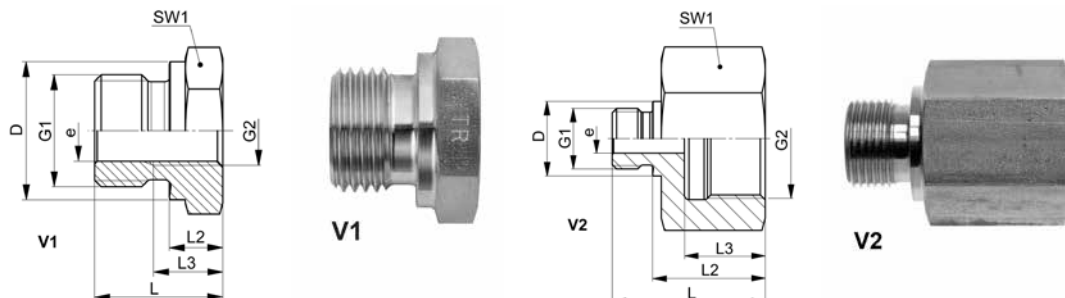

RS-..

Type-G1 /G2	Mat.-Nr.	PN	Vers.	D	G1	G2	L	L2	L3	SW1	e	g/Stk
G1=Rohrgewinde (zylindrisch)		G1=BSP thread (parallel)					G1=英制平行管螺纹标准					
G2=Rohrgewinde (zylindrisch)		G2=BSP thread (parallel)					G2=英制平行管螺纹标准					
RS-1.8/1.4	706.0411.044	800	V2	14.0	1/8	1/4	31.0	23.0	18.0	19	4.0	30
RS-1.8/3.8	706.0411.046	800	V2	14.0	1/8	3/8	32.0	24.0	16.0	24	4.0	65
RS-1.4/1.8	706.0411.102	800	V2	18.0	1/4	1/8	29.0	17.0	11.0	19	5.0	38
RS-1.4/3.8	706.0411.106	800	V2	18.0	1/4	3/8	36.0	24.0	16.0	24	5.0	68
RS-1.4/1.2	706.0411.108	800	V2	18.0	1/4	1/2	40.0	28.0	20.0	27	5.0	80
RS-1.4/3.4	706.0411.110	800	V2	18.0	1/4	3/4	43.0	31.0	22.0	36	5.0	175
RS-3.8/1.8	706.0411.162	800	V1	22.0	3/8	1/8	22.5	10.5	9.0	22	8.5	40
RS-3.8/1.4	706.0411.164	800	V2	22.0	3/8	1/4	36.0	24.0	18.0	22	8.0	70
RS-3.8/1.2	706.0411.168	800	V2	22.0	3/8	1/2	41.0	29.0	20.0	27	8.0	95
RS-3.8/3.4	706.0411.170	800	V2	22.0	3/8	3/4	44.0	32.0	22.0	36	8.0	185
RS-1.2/1.8	706.0411.221	800	V1	26.0	1/2	1/8	24.0	10.0	9.0	27	8.5	65
RS-1.2/1.4	706.0411.224	800	V1	26.0	1/2	1/4	24.0	10.0	12.0	27	11.4	57
RS-1.2/3.8	706.0411.226	800	V2	26.0	1/2	3/8	37.0	23.0	16.0	27	12.0	100
RS-1.2/3.4	706.0411.232	800	V2	26.0	1/2	3/4	46.0	32.0	22.0	36	12.0	186
RS-1.2/1.1	706.0411.236	630	V2	26.0	1/2	1	49.0	35.0	24.0	41	12.0	220
RS-1.2/5.4	706.0411.237	420	V2	26.0	1/2	1 1/4	53.0	39.0	28.0	55	10.0	487
RS-3.4/1.4	706.0411.284	800	V1	32.0	3/4	1/4	26.0	10.0	12.0	32	11.4	105
RS-3.4/3.8	706.0411.286	800	V1	32.0	3/4	3/8	26.0	10.0	12.0	32	15.0	94
RS-3.4/1.2	706.0411.288	800	V2	32.0	3/4	1/2	43.0	27.0	20.0	32	16.0	145
RS-3.4/1.1	706.0411.296	630	V2	32.0	3/4	1	51.0	35.0	24.0	41	16.0	240
RS-3.4/5.4	706.0411.297	420	V2	32.0	3/4	1 1/4	55.0	39.0	28.0	55	16.0	525
RS-3.4/3.2	706.0411.298	420	V2	32.0	3/4	1 1/2	57.0	41.0	30.0	60	16.0	620
RS-1.1/1.4	706.0411.406	630	V1	39.0	1	1/4	29.0	11.0	12.0	41	11.4	195
RS-1.1/3.8	706.0411.407	630	V1	39.0	1	3/8	29.0	11.0	12.0	41	15.0	177
RS-1.1/1.2	706.0411.408	630	V1	39.0	1	1/2	29.0	11.0	14.0	41	18.6	155
RS-1.1/3.4	706.0411.412	630	V2	39.0	1	3/4	49.0	31.0	22.0	41	20.0	275
RS-1.1/5.4	706.0411.416	420	V2	39.0	1	1 1/4	57.0	39.0	28.0	55	20.0	520
RS-1.1/3.2	706.0411.417	420	V2	39.0	1	1 1/2	59.0	41.0	30.0	60	20.0	600

Fortsetzung auf nächster Seite

To be continued on next page

续下页

Gewinde-Reduzierstutzen

Abdichtung durch Dichtkante Form B nach DIN 3852-2

Reducing adaptors

sealing edge form B acc. DIN 3852-2

变径转接头

带符合DIN3852-2标准的金属面密封

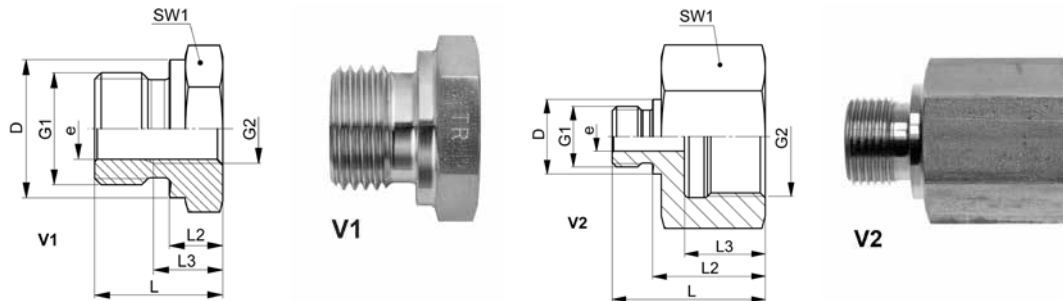

RS-..

Type-G1 /G2	Mat.-Nr.	PN	Vers.	D	G1	G2	L	L2	L3	SW1	e	g/Stk
G1=Rohrgewinde (zylindrisch)		G1=BSP thread (parallel)					G1=英制平行管螺纹标准					
G2=Rohrgewinde (zylindrisch)		G2=BSP thread (parallel)					G2=英制平行管螺纹标准					
RS-5.4/1.2	706.0411.488	420	V1	49.0	1 1/4	1/2	32.0	12.0	14.0	50	18.6	320
RS-5.4/3.4	706.0411.490	420	V1	49.0	1 1/4	3/4	32.0	12.0	16.0	50	24.1	264
RS-5.4/1.1	706.0411.487	420	V2	49.0	1 1/4	1	52.0	32.0	24.0	50	25.0	467
RS-5.4/3.2	706.0411.489	420	V2	49.0	1 1/4	1 1/2	60.0	40.0	30.0	60	25.0	640
RS-3.2/1.2	706.0411.511	420	V1	55.0	1 1/2	1/2	36.0	14.0	14.0	55	18.6	486
RS-3.2/3.4	706.0411.513	420	V1	55.0	1 1/2	3/4	36.0	14.0	16.0	55	24.1	430
RS-3.2/1.1	706.0411.512	420	V1	55.0	1 1/2	1	36.0	14.0	18.0	55	30.3	346
RS-3.2/5.4	706.0411.514	420	V2	55.0	1 1/2	1 1/4	58.0	36.0	28.0	55	32.0	535
RS-4.2/1.1	706.0411.602	420	V1	68.0	2	1	43.0	19.0	18.0	70	30.3	881
RS-4.2/3.2	706.0411.617	420	V1	68.0	2	1 1/2	43.0	19.0	26.0	70	44.8	547

Nenndruck: Sicherheitsfaktor gemäss DNV, siehe Kapitel i

Nominal pressure: Safety factor according to DNV, see chapter i

公称压力: DNV 安全系数, 参见第i章

Gewinde-Reduzierstutzen

Abdichtung durch Profildichtring Form E nach ISO 1179-2

Reducing adaptors

profile sealing ring form E acc. ISO 1179-2

变径转接头

带符合ISO1179-2标准的ED圈密封

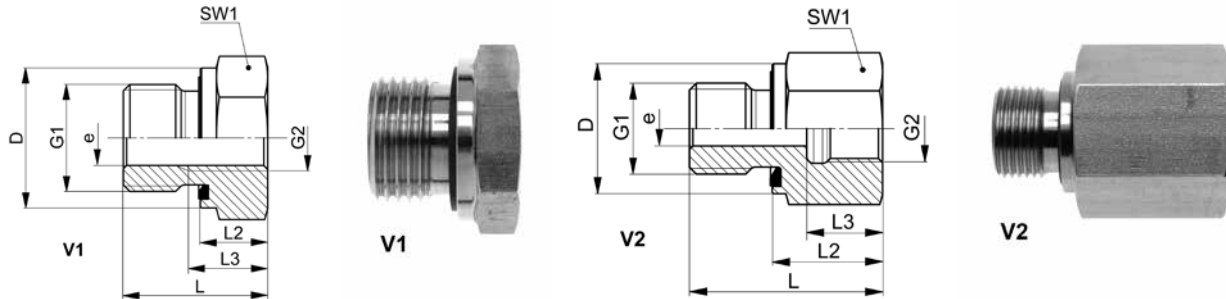

RS..WD

Type-G1 /G2	Mat.-Nr.	PN	Vers.	D	G1	G2	L	L2	L3	SW1	e	g/Stk
G1=Rohrgewinde (zylindrisch)		G1=BSP thread (parallel)					G1=英制平行管螺纹标准					
G2=Rohrgewinde (zylindrisch)		G2=BSP thread (parallel)					G2=英制平行管螺纹标准					
RS-5.4/1.2 WD	708.0416.488	420	V1	50.0	1 1/4	1/2	32.0	12.0	14.0	50	18.6	310
RS-5.4/3.4 WD	708.0416.490	420	V1	50.0	1 1/4	3/4	32.0	12.0	16.0	50	24.1	264
RS-5.4/1.1 WD	708.0416.487	420	V2	50.0	1 1/4	1	52.0	32.0	24.0	50	25.0	458
RS-5.4/3.2 WD	708.0416.489	420	V2	50.0	1 1/4	1 1/2	60.0	40.0	30.0	60	25.0	640
RS-3.2/1.2 WD	708.0416.511	420	V1	55.0	1 1/2	1/2	36.0	14.0	14.0	55	18.6	480
RS-3.2/3.4 WD	708.0416.513	420	V1	55.0	1 1/2	3/4	36.0	14.0	16.0	55	24.1	425
RS-3.2/1.1 WD	708.0416.512	420	V1	55.0	1 1/2	1	36.0	14.0	18.0	55	30.3	344
RS-3.2/5.4 WD	708.0416.514	420	V2	55.0	1 1/2	1 1/4	58.0	36.0	28.0	55	32.0	535
RS-4.2/1.1 WD	708.0416.602	420	V1	75.0	2	1	42.5	18.5	20.0	75	30.5	940
RS-4.2/3.2 WD	708.0416.617	420	V1	75.0	2	1 1/2	42.5	18.5	26.0	75	45.3	535

Dichtungsmaterial: FKM (andere Werkstoffe auf Anfrage)

Sealing material: FKM (other materials on request)

密封材料: FKM (其他材料可咨询)

Nennndruck: Sicherheitsfaktor gemäss DNV, siehe Kapitel i

Nominal pressure: Safety factor according to DNV, see chapter i

公称压力: DNV 安全系数, 参见第i章

Übergangsnippel G-R
Adaptor female G - male R
 转换管接头 G-R

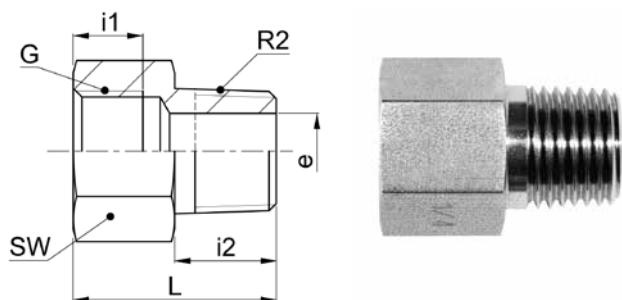

AD A 50 G-R

Type -G -R2	Mat.-Nr.	PN	SW	L	i1	i2	e	kg/100
G=Rohrgewinde (zylindrisch)		G=BSP thread (parallel)						
R2=Rohrgewinde (kegelig)		R2=BSP thread (tapered)						
AD A 50-1/8-1/8	TAD.5120.042	400	14	21.0	8.0	9.5	6.0	1.230
AD A 50-1/8-1/4	TAD.5130.044	400	14	18.5	8.0	12.0	8.7	1.140
AD A 50-1/8-3/8	TAD.5130.046	400	17	20.5	8.0	12.0	8.7	2.460
AD A 50-1/8-1/2	TAD.5130.048	400	22	25.5	8.0	14.0	8.7	5.510
AD A 50-1/4-1/8	TAD.5120.102	400	17	23.0	9.0	9.5	6.0	1.780
AD A 50-1/4-1/4	TAD.5120.104	400	17	26.0	9.0	12.5	8.0	2.200
AD A 50-1/4-3/8	TAD.5130.106	400	17	20.5	9.0	12.0	11.6	1.800
AD A 50-1/4-1/2	TAD.5130.108	400	22	25.5	9.0	14.0	11.6	4.700
AD A 50-1/4-3/4	TAD.5130.110	400	27	29.0	9.0	16.0	11.6	9.580
AD A 50-3/8-1/4	TAD.5120.164	400	22	28.0	9.5	12.5	8.0	3.590
AD A 50-3/8-3/8	TAD.5120.166	400	22	27.0	9.5	12.5	10.5	3.700
AD A 50-3/8-1/2	TAD.5130.168	400	22	25.5	9.5	14.0	15.2	3.940
AD A 50-3/8-3/4	TAD.5130.170	160	27	29.0	9.5	16.0	15.2	7.650
AD A 50-3/8-1	TAD.5130.172	100	36	31.0	9.5	18.0	15.2	16.640
AD A 50-1/2-1/4	TAD.5120.224	400	27	31.0	11.5	12.5	8.0	5.820
AD A 50-1/2-3/8	TAD.5120.226	400	27	30.0	11.5	12.5	10.5	5.790
AD A 50-1/2-1/2	TAD.5120.228	400	27	35.0	11.5	17.5	13.0	7.190
AD A 50-1/2-3/4	TAD.5130.232	160	27	29.0	11.5	16.0	19.0	6.080
AD A 50-1/2-1	TAD.5130.236	100	36	31.0	14.0	20.0	19.0	14.500
AD A 50-3/4-1/2	TAD.5120.288	200	32	39.0	14.0	17.5	13.0	9.670
AD A 50-3/4-3/4	TAD.5120.292	160	32	40.0	14.0	19.0	21.0	9.170
AD A 50-3/4-1	TAD.5130.296	100	36	31.0	14.0	18.0	24.5	10.490
AD A 50-1-1/2	TAD.5120.408	200	41	45.0	17.0	17.5	13.0	18.790
AD A 50-1-3/4	TAD.5120.412	160	41	45.0	17.0	19.0	21.0	17.130
AD A 50-1-1	TAD.5120.414	100	41	45.0	17.0	21.0	26.0	17.530

Nur für kegelige Einschraubgewinde geeignet.

Only suitable for tapered threads.

只适用于锥形外螺纹。

Übergangsnippel G-NPT

Adaptor female G - male NPT

转换管接头 G-NPT

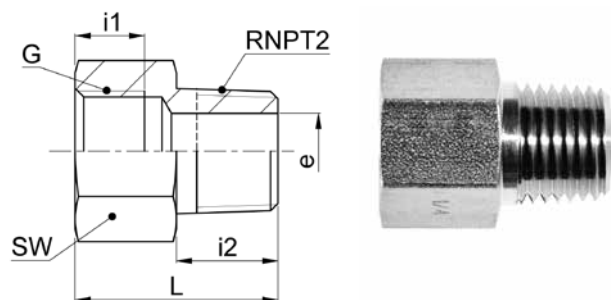

AD A 50 G-NPT

Type-G-RNPT2	Mat.-Nr.	PN	SW	L	i1	i2	e	kg/100
G=Rohrgewinde (zylindrisch)		G=BSP thread (parallel)						
RNPT2=NPT Gewinde		RNPT2=NPT thread						
AD A 50-1/8-1/8 NPT	TAD.5124.042	400	14	21.0	8.0	9.5	6.0	1.280
AD A 50-1/8-1/4 NPT	TAD.5134.044	400	14	18.5	8.0	12.5	8.7	1.220
AD A 50-1/8-3/8 NPT	TAD.5134.046	400	17	20.5	8.0	12.5	8.7	2.670
AD A 50-1/8-1/2 NPT	TAD.5134.048	400	22	25.5	8.0	17.5	8.7	5.900
AD A 50-1/4-1/8 NPT	TAD.5124.102	400	17	23.0	9.0	9.5	6.0	1.830
AD A 50-1/4-1/4 NPT	TAD.5124.104	400	17	26.0	9.0	12.5	8.0	2.280
AD A 50-1/4-3/8 NPT	TAD.5134.106	400	17	20.5	9.0	12.5	11.6	1.880
AD A 50-1/4-1/2 NPT	TAD.5134.108	400	22	25.5	9.0	17.5	11.6	5.050
AD A 50-1/4-3/4 NPT	TAD.5134.110	400	27	29.0	9.0	19.0	11.6	10.200
AD A 50-3/8-1/4 NPT	TAD.5124.164	400	22	28.0	9.5	12.5	8.0	3.670
AD A 50-3/8-3/8 NPT	TAD.5124.166	400	22	27.0	9.5	12.5	10.5	3.790
AD A 50-3/8-1/2 NPT	TAD.5134.168	400	22	25.5	9.5	17.5	15.2	3.490
AD A 50-1/2-1/4 NPT	TAD.5124.224	400	27	31.0	11.5	12.5	8.0	6.150
AD A 50-1/2-3/8 NPT	TAD.5124.226	400	27	30.0	11.5	12.5	10.5	6.130
AD A 50-1/2-1/2 NPT	TAD.5124.228	400	27	35.0	11.5	17.5	13.0	7.280
AD A 50-1/2-3/4 NPT	TAD.5134.232	400	27	29.0	11.5	19.0	19.0	6.170
AD A 50-3/4-1/2 NPT	TAD.5124.288	200	32	39.0	14.0	17.5	13.0	10.180
AD A 50-3/4-3/4 NPT	TAD.5124.292	200	32	40.0	14.0	19.0	21.0	9.650
AD A 50-3/4-1 NPT	TAD.5134.296	200	36	31.0	14.0	21.0	24.5	10.780
AD A 50-1-3/4 NPT	TAD.5124.412	200	41	45.0	17.0	19.0	21.0	18.180
AD A 50-1-1 NPT	TAD.5124.414	200	41	45.0	17.0	21.0	26.0	18.470

Übergangsnippel NPT-R

Adaptor female NPT - male R

转换管接头 NPT-R

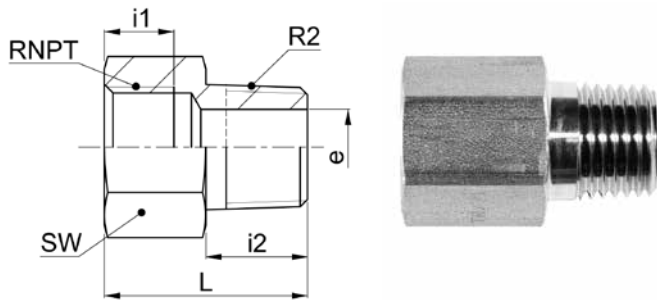

AD A 50 NPT-R

Type -RNPT-R2	Mat.-Nr.	PN	SW	L	i1	i2	e	kg/100
RNPT=NPT Gewinde		RNPT=NPT thread						
R2=Rohrgewinde (kegelig)		R2=BSP thread (tapered)						
AD A 50-1/8 NPT-1/8	TAD.5125.042	400	14	21.0	6.7	9.5	6.0	1.240
AD A 50-1/8 NPT-1/4	TAD.5135.044	400	14	18.5	6.7	12.5	8.4	1.150
AD A 50-1/4 NPT-1/4	TAD.5125.104	400	17	29.0	10.2	12.5	8.0	2.430
AD A 50-1/4 NPT-3/8	TAD.5135.106	400	17	20.5	10.2	12.5	10.8	1.870
AD A 50-1/4 NPT-1/2	TAD.5135.108	400	22	25.5	10.2	17.5	10.8	5.110
AD A 50-3/8 NPT-3/8	TAD.5125.166	400	22	29.0	10.3	12.5	10.5	4.050
AD A 50-1/2 NPT-1/2	TAD.5125.228	400	27	38.0	13.5	17.5	13.0	8.600
AD A 50-1/2 NPT-3/4	TAD.5135.232	160	27	29.0	13.5	19.0	17.7	6.830
AD A 50-3/4 NPT-3/4	TAD.5125.292	160	32	43.0	13.8	19.0	21.0	11.000
AD A 50-1 NPT-1	TAD.5125.414	160	36	45.0	17.4	21.0	26.0	12.830

Übergangsnippel NPT-NPT

Adaptor female NPT - male NPT

转换管接头 NPT-NPT

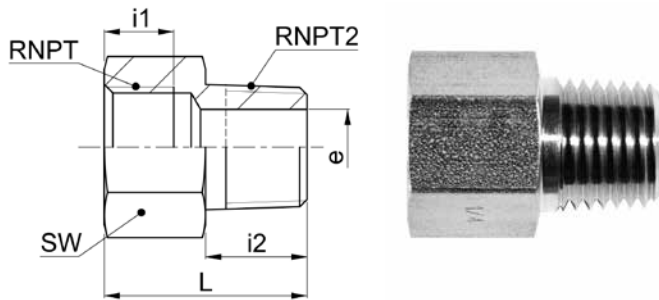

AD A 50 NPT-NPT

Type -RNPT -RNPT2	Mat.-Nr.	PN	SW	L	i1	i2	e	kg/100
RNPT=NPT Gewinde		RNPT=NPT thread						
RNPT2=NPT Gewinde		RNPT2=NPT thread						
AD A 50-1/8 NPT -1/4 NPT	TAD.5131.044	800	14	18.5	6.7	12.5	8.4	1.280
AD A 50-1/8 NPT -3/8 NPT	TAD.5131.046	800	17	20.5	6.7	12.5	8.4	2.660
AD A 50-1/4 NPT -1/8 NPT	TAD.5121.102	800	17	26.0	10.2	9.5	6.0	2.150
AD A 50-1/4 NPT -3/8 NPT	TAD.5131.106	800	17	20.5	10.2	12.5	10.8	2.070
AD A 50-1/4 NPT -1/2 NPT	TAD.5131.108	800	22	25.5	10.2	17.5	10.8	5.150
AD A 50-3/8 NPT -1/4 NPT	TAD.5121.164	800	22	30.0	10.3	12.5	8.0	3.920
AD A 50-3/8 NPT -1/2 NPT	TAD.5131.168	800	22	25.5	10.3	17.5	13.9	3.980
AD A 50-1/2 NPT -1/4 NPT	TAD.5121.224	800	27	35.0	13.5	12.5	8.0	7.510
AD A 50-1/2 NPT -3/8 NPT	TAD.5121.226	800	27	35.0	13.5	12.5	10.5	8.030
AD A 50-1/2 NPT -3/4 NPT	TAD.5131.232	800	27	29.0	13.5	19.0	17.7	6.820
AD A 50-1/2 NPT -1 NPT	TAD.5131.236	630	36	31.0	13.5	21.0	17.7	15.880
AD A 50-3/4 NPT -1/2 NPT	TAD.5121.288	800	32	43.0	13.8	17.5	13.0	12.030
AD A 50-3/4 NPT -1 NPT	TAD.5131.296	630	36	31.0	13.8	21.0	22.5	11.920
AD A 50-1 NPT -1/2 NPT	TAD.5121.408	630	36	48.0	17.4	17.5	13.0	14.540
AD A 50-1 NPT -3/4 NPT	TAD.5121.412	630	36	48.0	17.4	19.0	21.0	13.110

50

Sechskantnippel G-G

60° Innenkonus / Innengewinde

Hexagonal nipple G-G

60° inner cone / female thread

六角接头 G-G

内锥度 60° / 内螺纹

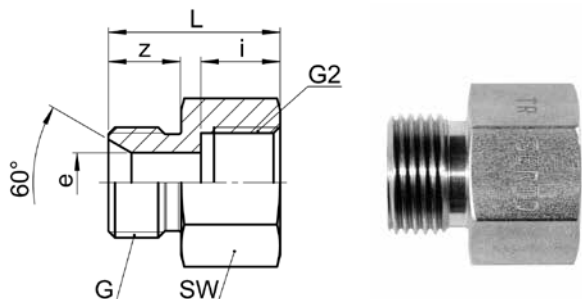

ADH A 50

Type -G -G2	Mat.-Nr.	PN	SW	L	i	z	e	kg/100
G=Rohrgewinde (zylindrisch)		G=BSP thread (parallel)						
G2=Rohrgewinde (zylindrisch)		G2=BSP thread (parallel)						
ADH A 50-3/8 -3/8	496.5320.166	200	22	26.0	12.0	11.0	9.0	3.870
ADH A 50-1/2 -1/2	496.5320.228	200	27	29.0	14.0	12.0	12.0	6.110

Nur für kegelige Einschraubgewinde geeignet.

Only suitable for tapered threads.

只适用于锥形外螺纹。

Muffe lang G

Threaded socket long G

接头长形 G

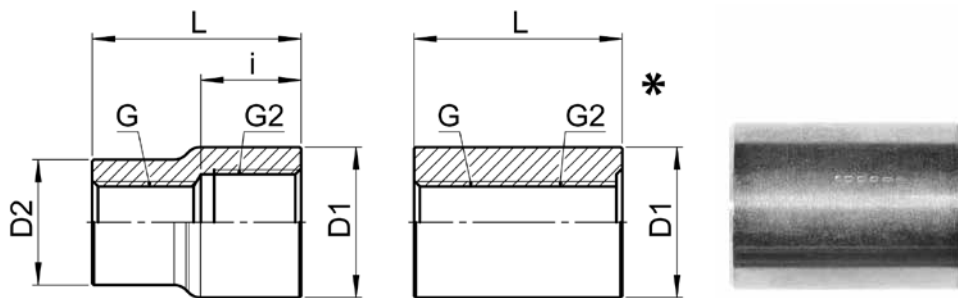

AD C 50

Type -G -G2	Mat.-Nr.	PN	L	D1	D2	i	kg/100
G=Rohrgewinde (zylindrisch)		G=BSP thread (parallel)					
G2=Rohrgewinde (zylindrisch)		G2=BSP thread (parallel)					
						G=英制平行管螺纹标准	
						G2=英制平行管螺纹标准	
AD C 50-1/8-1/8 *	TAD.5140.042	400	17.0	14.0	0.0	0.0	1.150
AD C 50-1/8-1/4	TAD.5140.044	400	25.0	18.0	15.0	17.0	2.540
AD C 50-1/4-1/4 *	TAD.5140.104	400	25.0	18.0	0.0	0.0	2.150
AD C 50-1/4-3/8	TAD.5140.106	400	30.0	22.5	17.5	16.0	5.140
AD C 50-1/4-1/2	TAD.5140.108	400	37.0	28.0	18.0	17.0	8.600
AD C 50-3/8-3/8 *	TAD.5140.166	400	27.0	22.0	0.0	0.0	3.600
AD C 50-3/8-1/2	TAD.5140.168	400	34.0	28.0	22.0	20.0	7.660
AD C 50-1/2-1/2 *	TAD.5140.228	400	34.0	27.0	0.0	0.0	5.760
AD C 50-1/2-3/4	TAD.5140.232	200	39.0	33.0	27.0	18.0	13.860
AD C 50-3/4-3/4 *	TAD.5140.292	200	36.0	33.0	0.0	0.0	8.600
AD C 50-3/4-1	TAD.5140.296	200	45.0	40.0	33.0	21.0	26.340
AD C 50-3/4-1 1/4	TAD.5140.298	200	50.0	50.0	33.0	22.0	29.310
AD C 50-1-1 *	TAD.5140.414	200	43.0	40.0	0.0	0.0	15.250
AD C 50-1-1 1/4	TAD.5140.418	200	50.0	50.0	40.0	30.0	34.420

50

Muffe kurz G**Threaded socket short G**

接头 短形 G

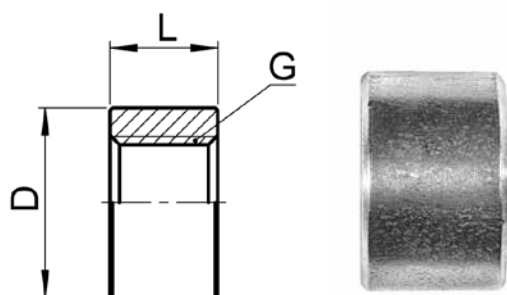
**AD CS 50**

Type -G	Mat.-Nr.	PN	L	D	kg/100
G=Rohrgewinde (zylindrisch)	G=BSP thread (parallel)			G=英制平行管螺纹标准	
AD CS 50-1/8	TAD.5200.042	400	8.0	14.0	0.500
AD CS 50-1/4	TAD.5200.104	400	11.0	17.0	0.900
AD CS 50-3/8	TAD.5200.166	400	12.0	22.0	1.550
AD CS 50-1/2	TAD.5200.228	400	15.0	27.0	2.600
AD CS 50-3/4	TAD.5200.292	200	17.0	32.0	3.670
AD CS 50-1	TAD.5200.414	200	19.0	40.0	6.100

Sechskantmuffe G

Hexagonal threaded socket G

六角套 G

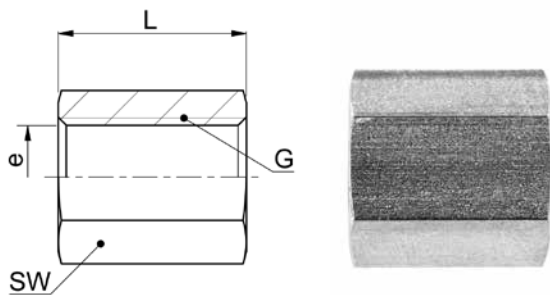

AD HC 50

Type -G	Mat.-Nr.	PN	SW	L	e	kg/100
G=Rohrgewinde (zylindrisch)		G=BSP thread (parallel)			G=英制平行管螺纹标准	
AD HC 50-1/8	TAD.5100.042	400	17	17.0	8.6	2.280
AD HC 50-1/4	TAD.5100.104	400	22	25.0	11.4	5.500
AD HC 50-3/8	TAD.5100.166	400	22	26.0	15.0	4.400
AD HC 50-1/2	TAD.5100.228	400	27	34.0	18.6	8.430
AD HC 50-3/4	TAD.5100.292	200	32	36.0	24.1	10.690
AD HC 50-1	TAD.5100.414	200	46	43.0	30.3	33.200

Sechskantmuffe G reduziert

Hexagonal threaded socket G reduced

缩减六角套 G

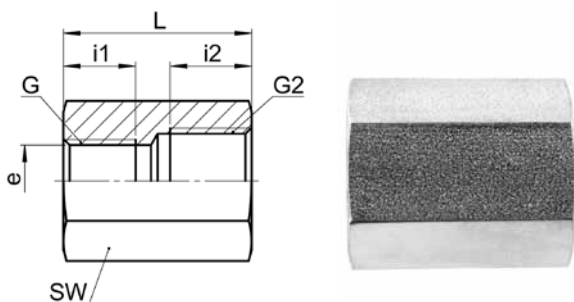

AD HRC 50

Type -G -G2	Mat.-Nr.	PN	SW	L	i1	i2	e	kg/100
G=Rohrgewinde (zylindrisch)		G=BSP thread (parallel)					G=英制平行管螺纹标准	
G2=Rohrgewinde (zylindrisch)		G2=BSP thread (parallel)					G2=英制平行管螺纹标准	
AD HRC 50-1/8-1/4	TAD.5100.044	400	22	25.0	8.0	9.0	8.6	5.940
AD HRC 50-1/8-3/8	TAD.5100.046	400	22	30.0	8.0	9.5	8.6	6.500
AD HRC 50-1/8-1/2	TAD.5100.048	400	27	41.0	8.0	11.5	8.6	14.100
AD HRC 50-1/4-3/8	TAD.5100.106	400	22	29.0	9.0	9.5	11.4	5.750
AD HRC 50-1/4-1/2	TAD.5100.108	400	27	40.0	9.0	11.5	11.4	12.950
AD HRC 50-3/8-1/2	TAD.5100.168	400	27	38.0	9.5	11.5	15.0	10.060
AD HRC 50-1/2-3/4	TAD.5100.232	200	32	41.0	11.5	14.0	18.6	15.200
AD HRC 50-1/2-1	TAD.5100.236	200	46	51.0	11.5	17.0	18.6	48.710

Verschlusschrauben

mit Innensechskant, DIN 908, Abdichtung durch Dichtkante Form B nach DIN 3852-2

Locking screws

with internal hexagon, DIN 908, sealing edge form B acc. DIN 3852-2

油口端堵头

带符合DIN908标准的内六角和符合DIN3852-2标准的金属面密封

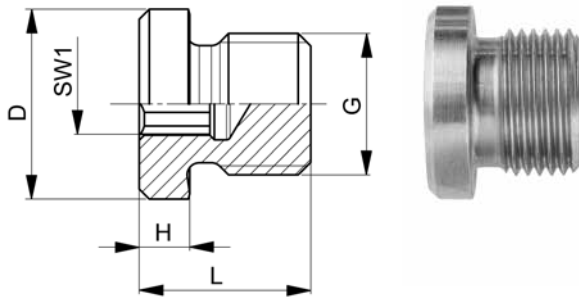

VSI..R

Type-G	Mat.-Nr.	PN	D	G	H	L	SW1	g/Stk
G=Rohrgewinde (zylindrisch)		G=BSP thread (parallel)			G=英制平行管螺纹标准			
VSI-R 1.8	706.0721.020	800	14.0	1/8	4.0	12.0	5	6
VSI-R 1.4	706.0721.040	800	18.0	1/4	5.0	17.0	6	18
VSI-R 3.8	706.0721.060	800	22.0	3/8	5.0	17.0	8	26
VSI-R 1.2	706.0721.080	800	26.0	1/2	5.0	19.0	10	44
VSI-R 3.4	706.0721.120	800	32.0	3/4	5.0	21.0	12	76
VSI-R 1.1	706.0721.160	630	39.0	1	6.5	22.5	17	126
VSI-R 5.4	706.0721.180	420	49.0	1 1/4	6.5	22.5	22	192
VSI-R 3.2	706.0721.200	420	55.0	1 1/2	6.5	22.5	24	268

Verschlusschrauben

mit Innensechskant, DIN 908, Abdichtung durch Profildichtring Form E nach ISO 1179-2

Locking screws

with internal hexagon, DIN 908, profile sealing ring form E acc. ISO 1179-2

油口端堵头

带符合DIN908标准的内六角和符合ISO1179-2标准的ED圈密封

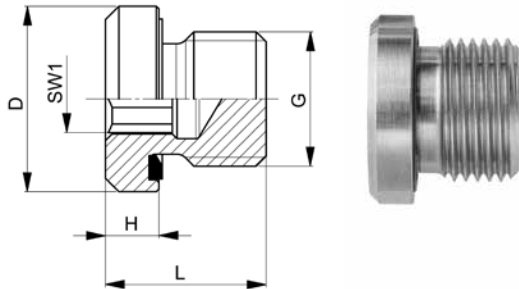

VSI..R WD

Type-G	Mat.-Nr.	PN	D	G	H	L	SW1	g/Stk
G=Rohrgewinde (zylindrisch)		G=BSP thread (parallel)			G=英制平行管螺纹标准			
VSI-R 1.8 WD	708.0722.020	800	14.0	1/8	4.0	12.0	5	6
VSI-R 1.4 WD	708.0722.040	800	19.0	1/4	5.0	17.0	6	16
VSI-R 3.8 WD	708.0722.060	800	22.0	3/8	5.0	17.0	8	29
VSI-R 1.2 WD	708.0722.080	800	27.0	1/2	5.0	19.0	10	42
VSI-R 3.4 WD	708.0722.120	800	32.0	3/4	5.0	21.0	12	76
VSI-R 1.1 WD	708.0722.160	630	40.0	1	6.5	22.5	17	130
VSI-R 5.4 WD	708.0722.180	420	50.0	1 1/4	6.5	22.5	22	186
VSI-R 3.2 WD	708.0722.200	420	55.0	1 1/2	6.5	22.5	24	256

Dichtungsmaterial: FKM (andere Werkstoffe auf Anfrage)

Sealing material: FKM (other materials on request)

密封材料: FKM (其他材料可咨询)

Verschlusschrauben

mit Innensechskant, DIN 908, Abdichtung durch Dichtkante Form B nach DIN 3852-2

Locking screws

with internal hexagon, DIN 908, sealing edge form B acc. DIN 3852-2

油口端堵头

带符合DIN908标准的内六角和符合DIN3852-2标准的金属面密封

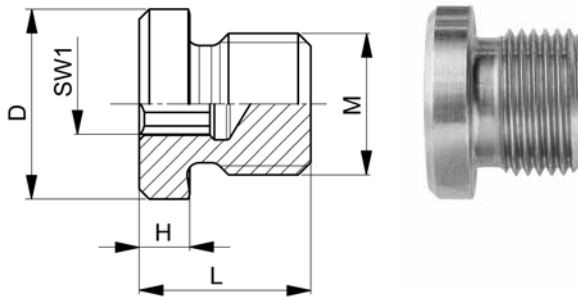

VSI..M

Type-M	Mat.-Nr.	PN	D	M	H	L	SW1	g/Stk
M=metrisches Gewinde (zylindrisch)		M=metric thread (parallel)			M=公制平行管螺纹标准			
VSI-M 10x1,0	706.0723.150	800	14.0	10x1.0	4.0	12.0	5	6
VSI-M 12x1,5	706.0723.195	800	17.0	12x1.5	5.0	17.0	6	12
VSI-M 14x1,5	706.0723.225	800	19.0	14x1.5	5.0	17.0	6	20
VSI-M 16x1,5	706.0723.265	800	21.0	16x1.5	5.0	17.0	8	22
VSI-M 18x1,5	706.0723.305	800	23.0	18x1.5	5.0	17.0	8	32
VSI-M 20x1,5	706.0723.345	800	25.0	20x1.5	5.0	19.0	10	44
VSI-M 22x1,5	706.0723.375	800	27.0	22x1.5	5.0	19.0	10	50
VSI-M 26x1,5	706.0723.435	800	31.0	26x1.5	5.0	21.0	12	80
VSI-M 27x2,0	706.0723.400	800	32.0	27x2.0	5.0	21.0	12	80
VSI-M 33x2,0	706.0723.510	630	39.0	33x2.0	6.5	22.5	17	138
VSI-M 48x2,0	706.0723.748	420	55.0	48x2.0	6.5	22.5	24	210

Nennndruck: Sicherheitsfaktor gemäss DNV, siehe Kapitel i

Nominal pressure: Safety factor according to DNV, see chapter i

公称压力: DNV 安全系数, 参见第i章

Verschlusschrauben

mit Innensechskant, DIN 908, Abdichtung durch Profildichtring Form E nach ISO 1179-2

Locking screws

with internal hexagon, DIN 908, profile sealing ring form E acc. ISO 1179-2

油口端堵头

带符合DIN908标准的内六角和符合ISO1179-2标准的ED圈密封

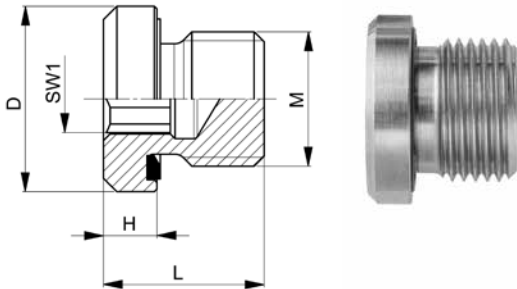

VSI-..M WD

Type-M	Mat.-Nr.	PN	D	M	H	L	SW1	g/Stk
M=metrisches Gewinde (zylindrisch)		M=metric thread (parallel)			M=公制平行管螺纹标准			
VSI-M 10x1,0 WD	708.0724.150	800	14.0	10x1.0	4.0	12.0	5	6
VSI-M 12x1,5 WD	708.0724.195	800	17.0	12x1.5	5.0	17.0	6	12
VSI-M 14x1,5 WD	708.0724.225	800	19.0	14x1.5	5.0	17.0	6	20
VSI-M 16x1,5 WD	708.0724.265	800	22.0	16x1.5	5.0	17.0	8	22
VSI-M 18x1,5 WD	708.0724.305	800	24.0	18x1.5	5.0	17.0	8	32
VSI-M 20x1,5 WD	708.0724.345	800	26.0	20x1.5	5.0	19.0	10	44
VSI-M 22x1,5 WD	708.0724.375	800	27.0	22x1.5	5.0	19.0	10	50
VSI-M 26x1,5 WD	708.0724.435	800	32.0	26x1.5	5.0	21.0	12	80
VSI-M 27x2,0 WD	708.0724.400	630	32.0	27x2.0	5.0	21.0	12	80
VSI-M 33x2,0 WD	708.0724.510	630	40.0	33x2.0	6.5	22.5	17	138
VSI-M 42x2,0 WD	708.0724.642	420	50.0	42x2.0	6.5	22.5	22	208
VSI-M 48x2,0 WD	708.0724.748	420	55.0	48x2.0	6.5	22.5	24	210

Dichtungsmaterial: FKM (andere Werkstoffe auf Anfrage)

Sealing material: FKM (other materials on request)

密封材料: FKM (其他材料可咨询)

Nenndruck: Sicherheitsfaktor gemäss DNV, siehe Kapitel i

Nominal pressure: Safety factor according to DNV, see chapter i

公称压力: DNV 安全系数, 参见第i章

Verschlusschraube

mit Außensechskant und Bund nach DIN 910, Abdichtung durch Dichtring Form A

Locking screws

with external hexagon and shoulder acc. to DIN 910, sealing ring form A

油口端堵头

带符合DIN910标准的外六角和衬肩并带有金属密封圈

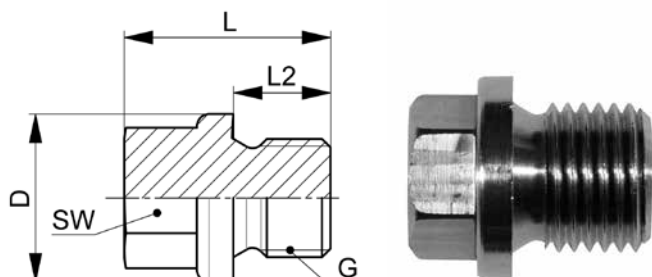
**VSS-..R**

Type-G	Mat.-Nr.	PN	G	D	L	L2	SW1	g/Stk
G=Rohrgewinde (zylindrisch)		G=BSP thread (parallel)			G=英制平行管螺纹标准			
VSS-R 1.8	706.0719.020	800	1/8	14.0	17.0	8.0	10	12
VSS-R 1.4	706.0719.040	800	1/4	18.0	21.0	12.0	13	26
VSS-R 3.8	706.0719.060	800	3/8	22.0	21.0	12.0	17	40
VSS-R 1.2	706.0719.080	800	1/2	26.0	26.5	14.0	19	70
VSS-R 3.4	706.0719.120	800	3/4	32.0	30.0	16.0	24	126
VSS-R 1.1	706.0719.160	630	1	39.0	32.0	16.0	27	199

Nennndruck: Sicherheitsfaktor gemäss DNV, siehe Kapitel i

Nominal pressure: Safety factor according to DNV, see chapter i

公称压力: DNV 安全系数, 参见第i章

Verschlusschraube NPT

mit Außensechskant

Locking screws NPT

with external hexagon

油口端堵头
带外六角

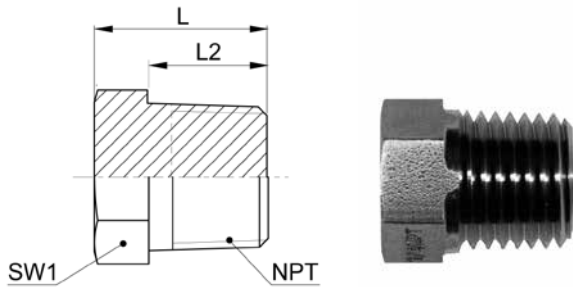

VSS-..NPT

Type -NPT	Mat.-Nr.	PN	L	L2	SW1	g/Stk
NPT=Einschraubgewinde NPT		NPT=tapered male adaptor thread NPT				NPT=美制一般用途圆锥管螺纹标准
VSS-1.8 NPT	706.0720.020.30	800	15.5	9.5	12	10
VSS-1.4 NPT	706.0720.040.30	800	18.5	12.5	14	22
VSS-3.8 NPT	706.0720.060.30	800	20.5	12.5	17	38
VSS-1.2 NPT	706.0720.080.30	800	25.5	17.5	22	75
VSS-3.4 NPT	706.0720.120.30	800	29.0	19.0	27	134
VSS-1.1 NPT	706.0720.160.30	630	31.0	21.0	36	232

Nennndruck: Sicherheitsfaktor gemäss DNV, siehe Kapitel i

Nominal pressure: Safety factor according to DNV, see chapter i

公称压力: DNV 安全系数, 参见第i章

Verschlusschraube R

mit Außensechskant

Screw plug R

with external hexagon

螺塞 R

外六角

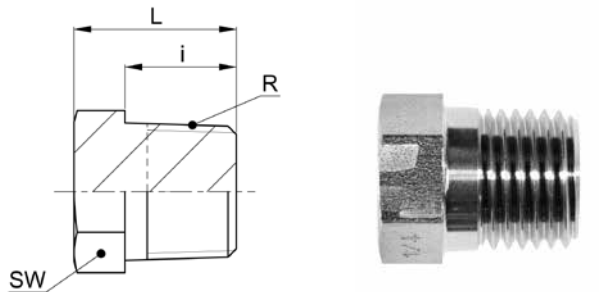

AD HP 50 R

Type-R	Mat.-Nr.	PN	SW	L	i	kg/100
R=Rohrgewinde (kegelig)		R=BSP thread (tapered)			R=英制锥形管螺纹标准	
AD HP 50-1/8	TAD.5020.020	400	12	12.5	8.0	1.020
AD HP 50-1/4	TAD.5020.040	400	14	17.5	12.0	1.900
AD HP 50-3/8	TAD.5020.060	400	17	18.0	12.0	3.290
AD HP 50-1/2	TAD.5020.080	400	22	21.0	14.0	6.550
AD HP 50-3/4	TAD.5020.120	160	27	24.0	16.0	11.680
AD HP 50-1	TAD.5020.160	100	36	28.0	18.0	20.540

Verschlusschraube R

mit Innensechskant

Screw plug R

with internal hexagon

螺塞 R

内六角

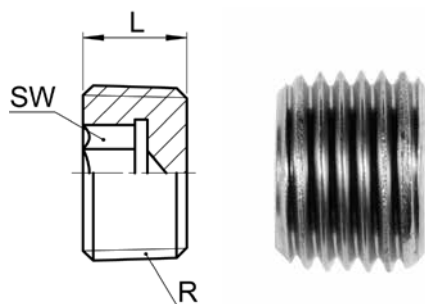

AD SP 50

Type -R	Mat.-Nr.	PN	SW	L	kg/100
R=Rohrgewinde (kegelig)		R=BSP thread (tapered)		R=英制锥形管螺纹标准	
AD SP 50-1/8	TAD.5010.020	400	5	8.0	0.340
AD SP 50-1/4	TAD.5010.040	400	7	10.0	0.740
AD SP 50-3/8	TAD.5010.060	400	8	10.0	1.250
AD SP 50-1/2	TAD.5010.080	400	10	10.0	1.940
AD SP 50-3/4	TAD.5010.110	160	12	12.0	3.800

Rohrkappe G

Hexagonal cap G

接头管帽 G

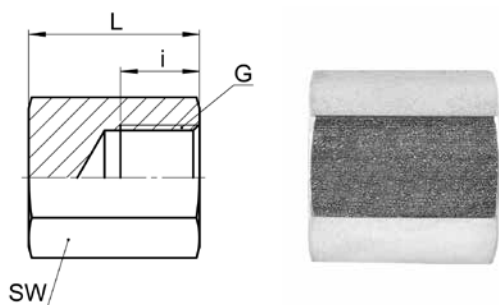

AD HCP 50

Type -G	Mat.-Nr.	PN	SW	L	i	kg/100
G=Rohrgewinde (zylindrisch)		G=BSP thread (parallel)		G=英制平行管螺纹标准		
AD HCP 50-1/8	TAD.5000.020	400	17	19.0	8.0	2.760
AD HCP 50-1/4	TAD.5000.040	400	22	24.0	9.0	5.940
AD HCP 50-3/8	TAD.5000.060	400	22	27.0	9.5	5.880
AD HCP 50-1/2	TAD.5000.080	400	27	37.0	11.5	12.700
AD HCP 50-3/4	TAD.5000.120	200	32	38.0	14.0	16.370
AD HCP 50-1	TAD.5000.160	200	46	44.0	17.0	43.200

Aufschraub-Winkel G

Female threaded elbow G

肘型旋入式接头 G

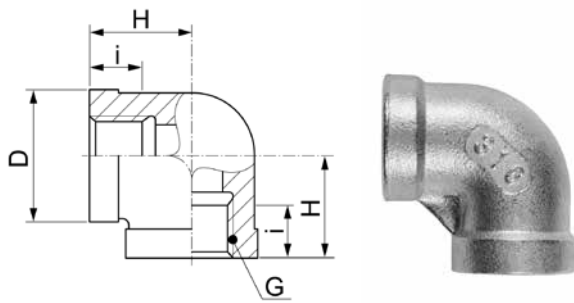

AD FE 51

Type-G	Mat.-Nr.	bar	D	H	i	kg/100
G=Rohrgewinde (zylindrisch)		G=BSP thread (parallel)			G=英制平行管螺纹标准	
AD FE 51-1/8-1/8	TAD.5300.042	10	14.5	17.0	6.0	3.700
AD FE 51-1/4-1/4	TAD.5300.104	10	17.5	19.0	8.0	5.100
AD FE 51-3/8-3/8	TAD.5300.166	10	20.0	23.0	9.0	6.600
AD FE 51-1/2-1/2	TAD.5300.228	10	27.5	27.0	9.5	9.000
AD FE 51-3/4-3/4	TAD.5300.292	10	31.5	31.5	11.5	19.100
AD FE 51-1-1	TAD.5300.414	10	39.0	36.5	14.0	27.800

Alle Angaben verstehen sich als unverbindliche Richtwerte.

All specifications are non-binding standard values.

所有参数都应视为无责任义务的参考值。

Einschraub-/Aufschraub-Winkel G-R
Male/female threaded elbow G-R
 肘形旋入式接头 G-R

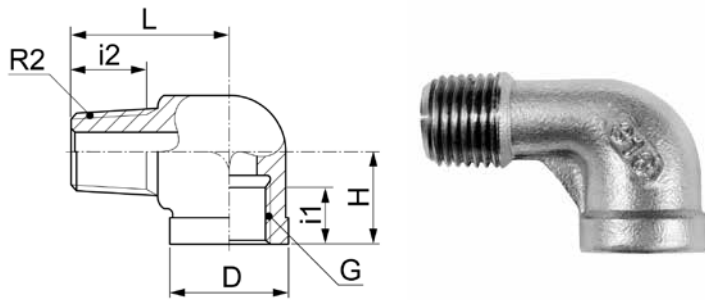

AD SE 51

Type -G -R2	Mat.-Nr.	bar	L	D	H	i1	i2	kg/100
G=Rohrgewinde (zylindrisch)								
R2=Rohrgewinde (kegelig)								
AD SE 51-1/8-1/8	TAD.5320.042	10	24.0	14.5	17.0	6.0	7.0	2.800
AD SE 51-1/4-1/4	TAD.5320.104	10	28.0	17.5	20.0	8.0	10.0	3.600
AD SE 51-3/8-3/8	TAD.5320.166	10	32.0	20.0	23.0	9.0	10.0	6.500
AD SE 51-1/2-1/2	TAD.5320.228	10	37.0	26.0	28.0	9.5	13.0	11.200
AD SE 51-3/4-3/4	TAD.5320.292	10	43.0	31.5	32.0	11.5	15.0	16.100
AD SE 51-1-1	TAD.5320.414	10	52.0	39.0	38.0	14.0	17.0	25.600

Alle Angaben verstehen sich als unverbindliche Richtwerte.

All specifications are non-binding standard values.

所有参数都应视为无责任义务的参考值。

Aufschraub-T G

Female threaded tee G

T型旋入式接头 G

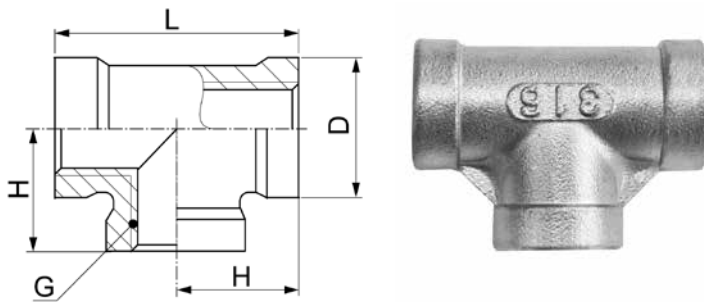

AD FT 51

Type -G	Mat.-Nr.	bar	L	D	H	kg/100
G=Rohrgewinde (zylindrisch)		G=BSP thread (parallel)		G=英制平行管螺纹标准		
AD FT 51-1/8-1/8-1/8	TAD.5400.060	10	34.0	14.5	17.0	3.000
AD FT 51-1/4-1/4-1/4	TAD.5400.160	10	38.0	17.5	19.0	7.300
AD FT 51-3/8-3/8-3/8	TAD.5400.350	10	46.0	20.0	23.0	10.100
AD FT 51-1/2-1/2-1/2	TAD.5400.450	10	54.0	26.0	27.0	16.400
AD FT 51-3/4-3/4-3/4	TAD.5400.520	10	63.0	31.5	31.5	22.500
AD FT 51-1-1-1	TAD.5400.650	10	73.0	39.0	36.5	37.000

Alle Angaben verstehen sich als unverbindliche Richtwerte.

All specifications are non-binding standard values.

所有参数都应视为无责任义务的参考值。